

061

A



PUMP ROTATION:
Clockwise: Firing Order: 1-5-3-6-2-4
DRIVE END:
R. H. Side
TIMED FOR PORT CLOSING
SPECIAL FEATURES:

MACK
MODEL 300 #PLM 450061A

Special Information:

SERVICE PARTS

Following are all parts, part numbers, pump codes and calibrations for the *Model: #PLM 450061A*. The exploded view drawing below is detailed with part numbers

listed on the pages indicated. Refer to the Index Section for explanations of codes and abbreviations.

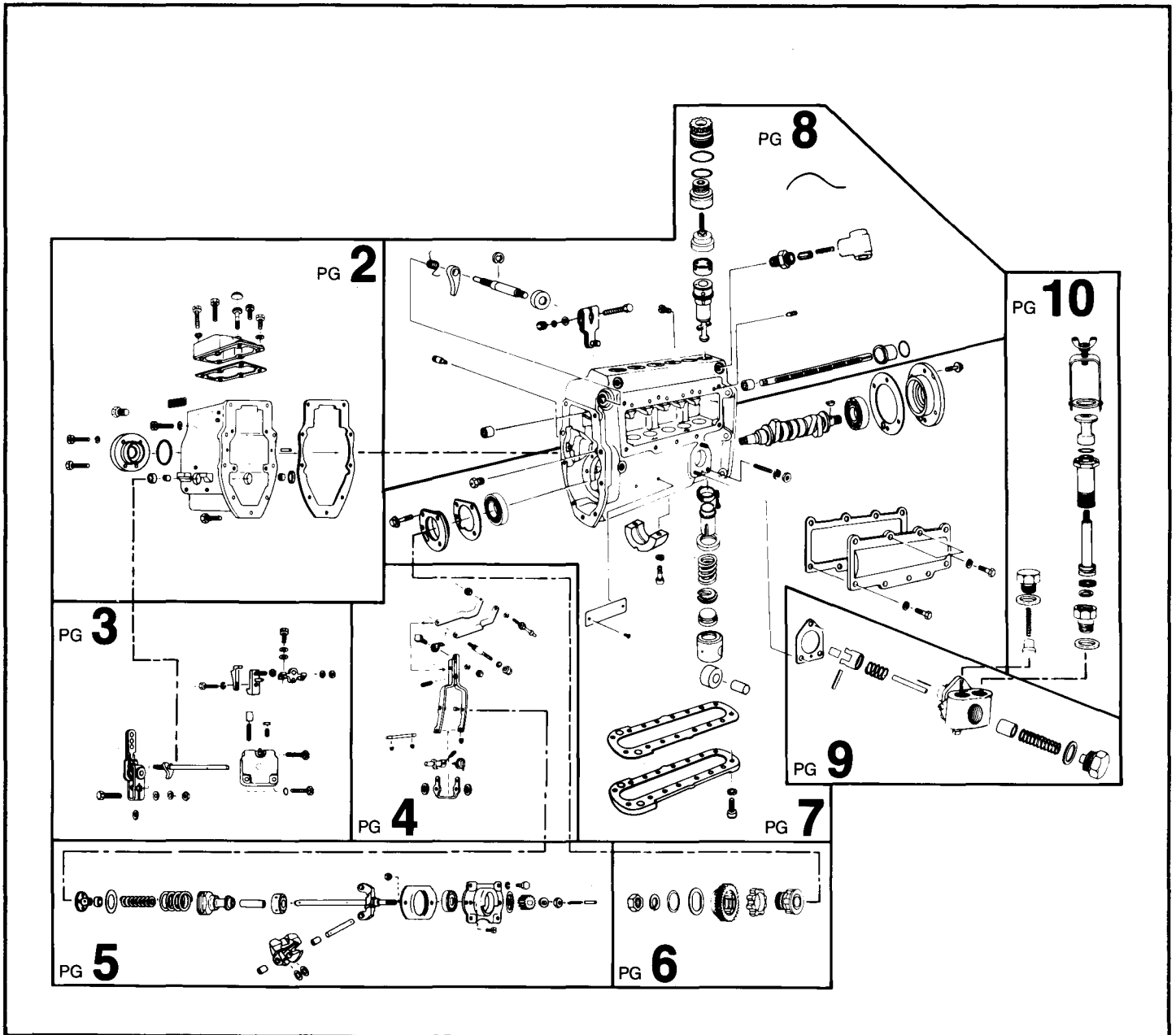

MODEL 300 #PLM 450061A

ASSY GMS 450062
GOVERNOR ASSY

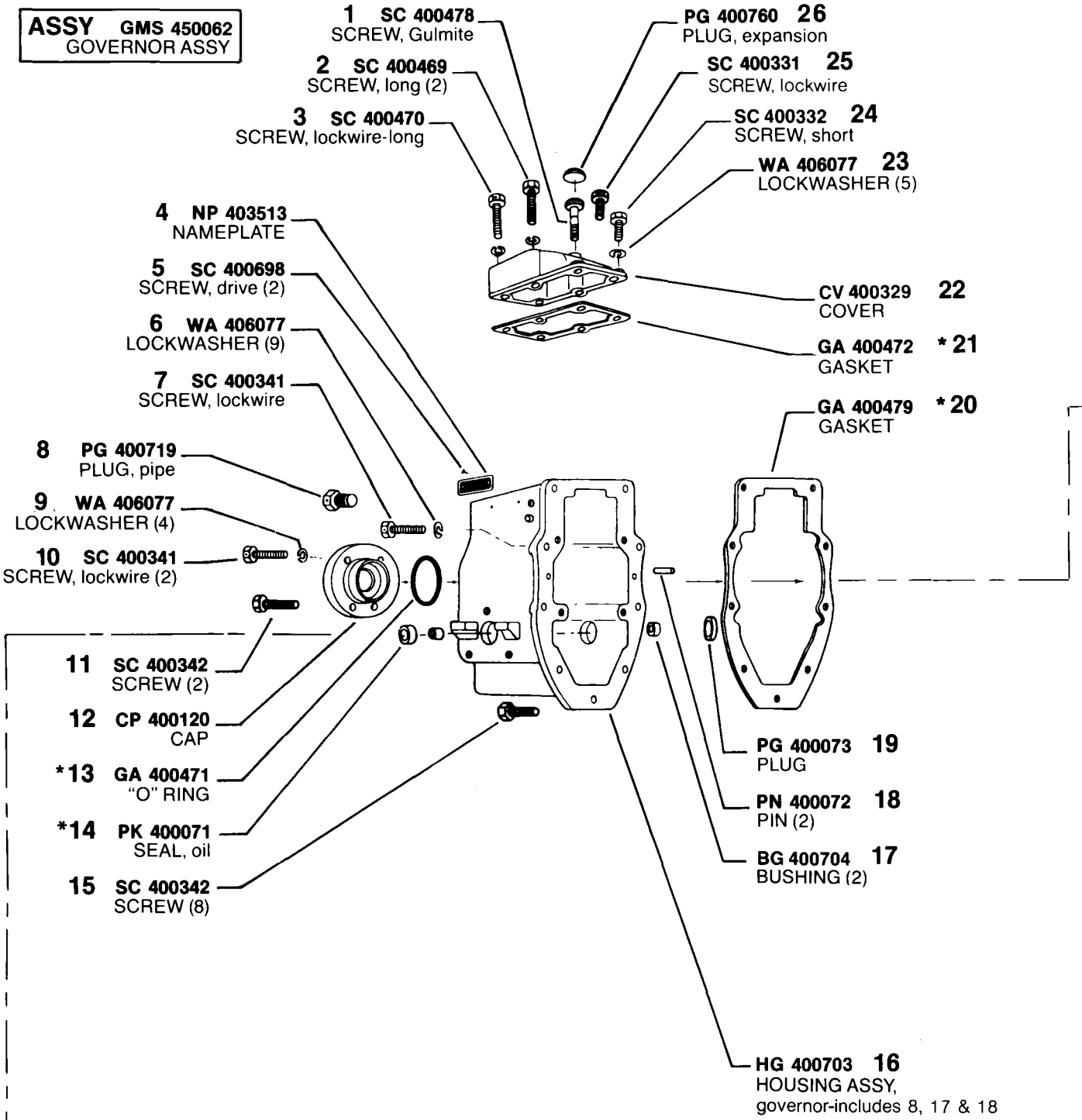

*Quantity used is one, unless otherwise indicated in parenthesis () following description of part.

MODEL 300 #PLM 450061A

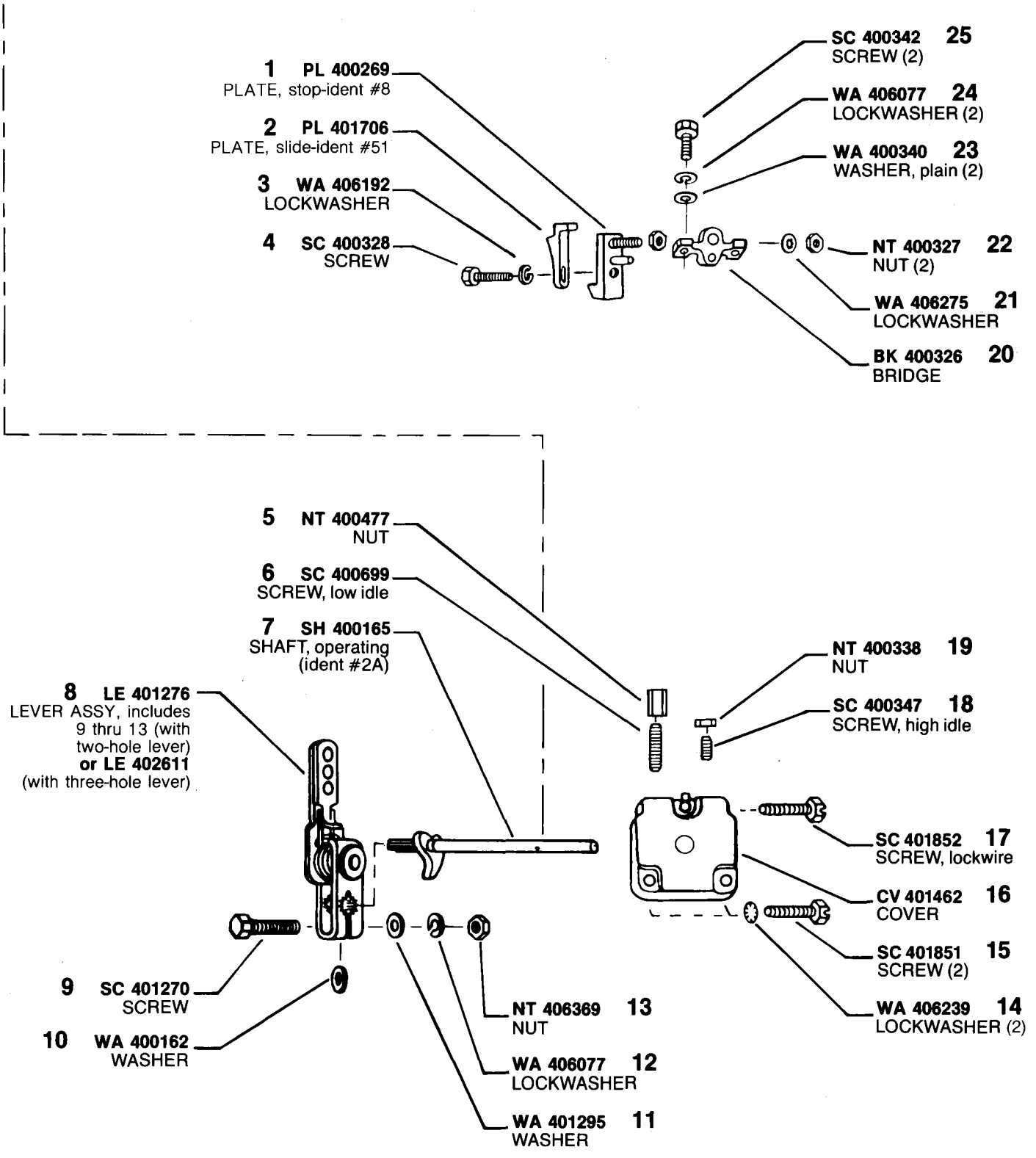

MODEL 300 #PLM 450061A

ASSY LE 400782
LEVER ASSY, fulcrum-
includes 1, 2, 6 thru 9
11 & 16 thru 21

ASSY PL 400177
PLATE ASSY, includes
10 & 12

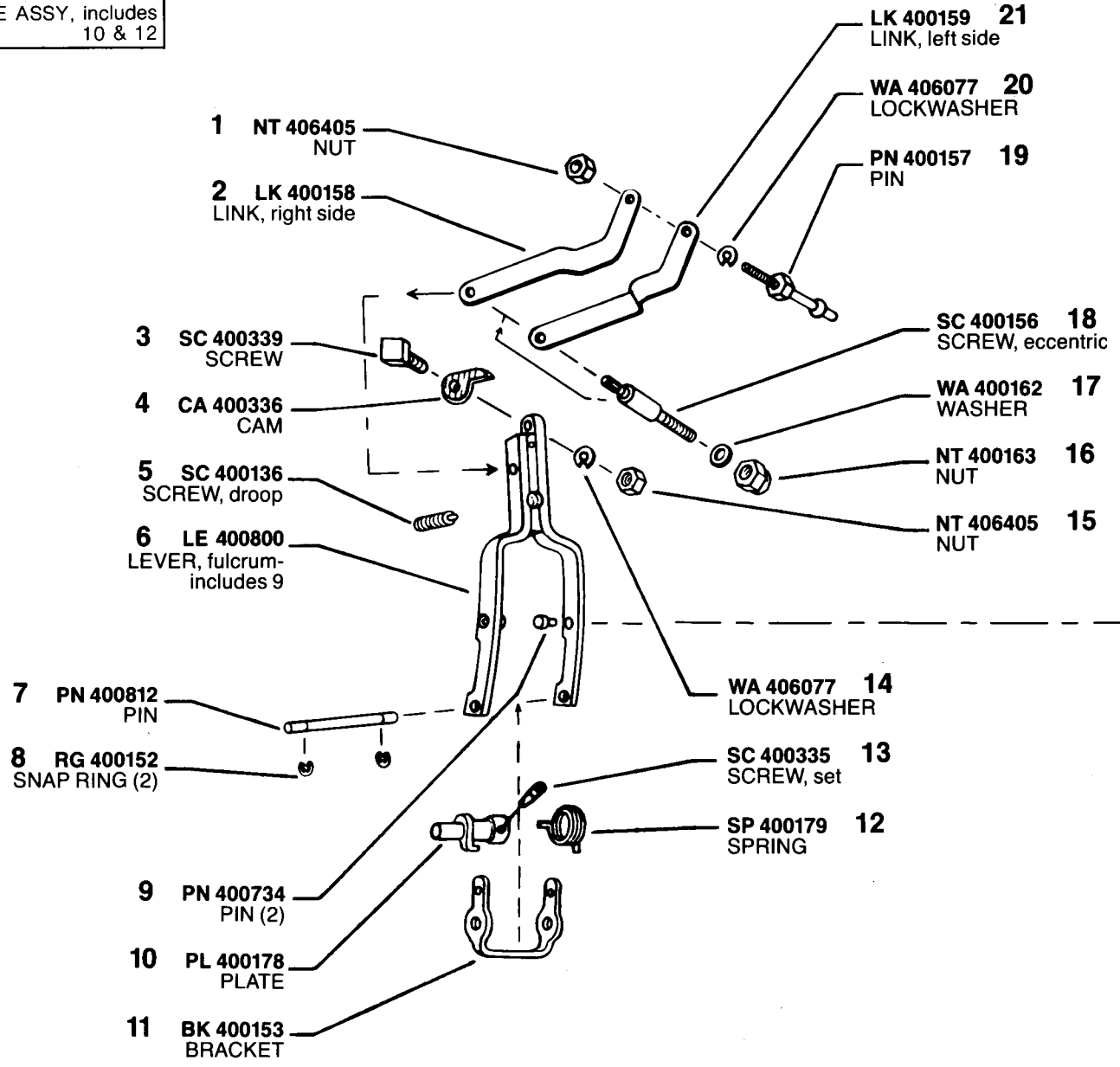

MODEL 300 #PLM 450061A

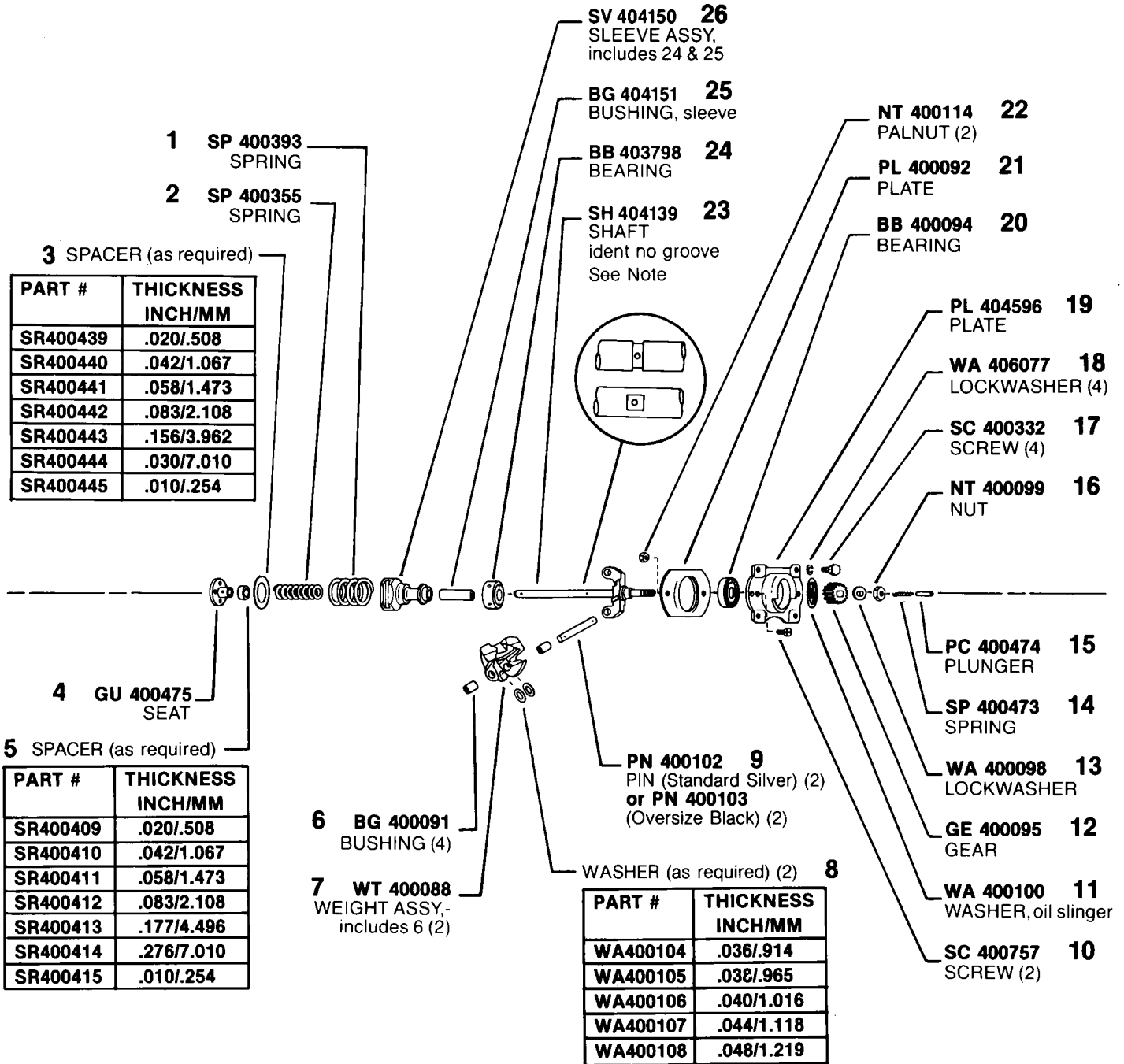

NOTE: When replacing shaft (#23 w/groove) with latest shaft (SH404139 no groove) BG404151 (25) MUST be used. Shaft with groove used BG400118.

MODEL 300 #PLM 450061A

**ASSY GE 400182
or 408663
(RUBBER DRIVE)**
DRIVE ASSY, includes 3 thru 7

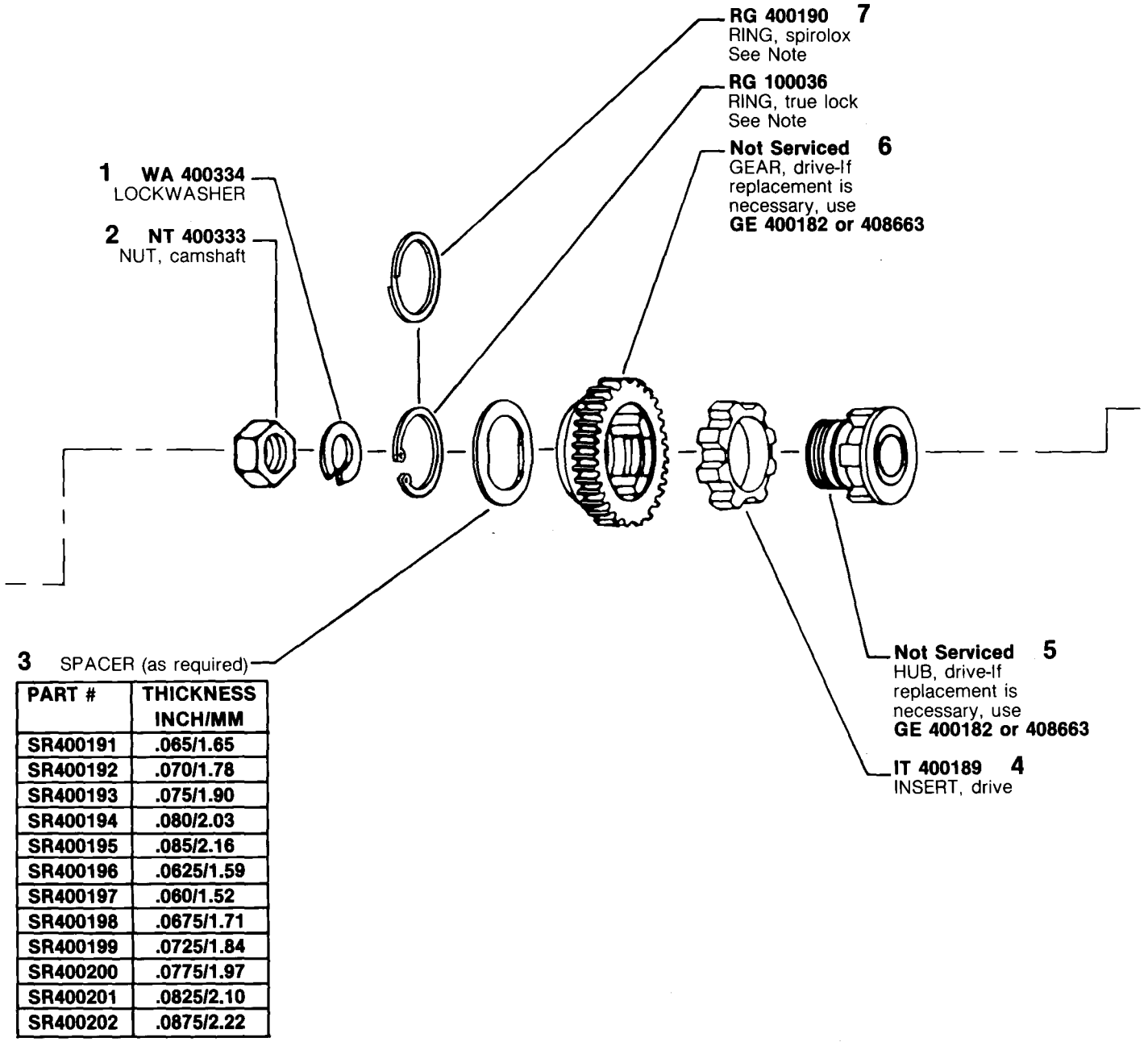

#7 NOTE: Earlier rubber drive assy GE 400182 used RG 400190 (Spirolox ring), later assy GE 408663 using RG 100036 (true lock ring). Spirolox & true lock rings are NOT interchangeable.

ASSY NOTE: Pumps equipped with GE 7992A "Friction Clutch" refer to Service Instructions Model 688T Parts Bulletin P4 for Parts.

MODEL 300 #PLM 450061A

ASSY TP 400513
TAPPET ASSY, includes
9 & 17-19 (6)

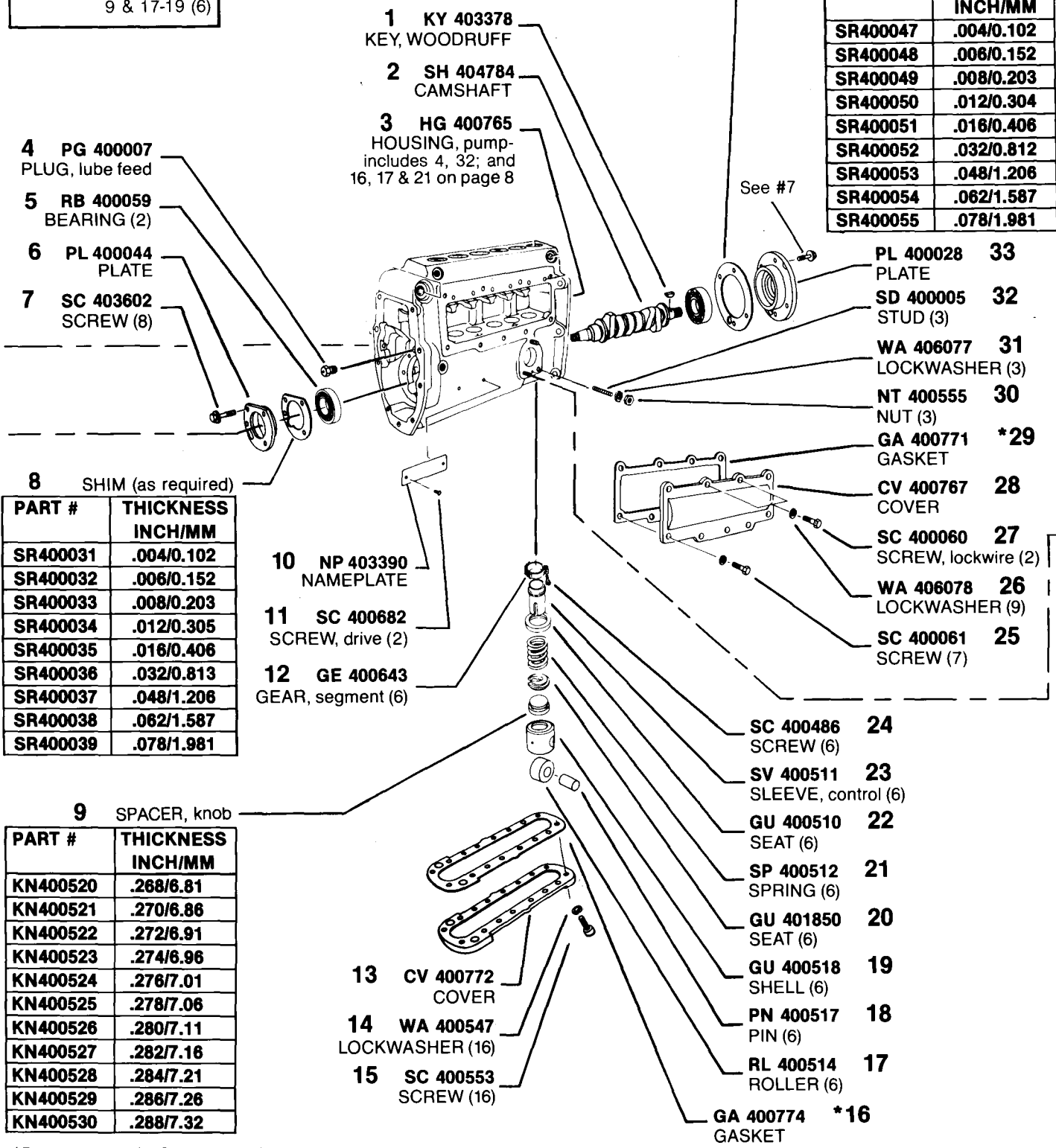

SHIM (as required) **34**

PART #	THICKNESS INCH/MM
SR400047	.004/0.102
SR400048	.006/0.152
SR400049	.008/0.203
SR400050	.012/0.304
SR400051	.016/0.406
SR400052	.032/0.812
SR400053	.048/1.206
SR400054	.062/1.587
SR400055	.078/1.981

- 4 PG 400007**
PLUG, lube feed
- 5 RB 400059**
BEARING (2)
- 6 PL 400044**
PLATE
- 7 SC 403602**
SCREW (8)

- 1 KY 403378**
KEY, WOODRUFF
- 2 SH 404784**
CAMSHAFT
- 3 HG 400765**
HOUSING, pump-
includes 4, 32; and
16, 17 & 21 on page 8

8 SHIM (as required)

PART #	THICKNESS INCH/MM
SR400031	.004/0.102
SR400032	.006/0.152
SR400033	.008/0.203
SR400034	.012/0.305
SR400035	.016/0.406
SR400036	.032/0.813
SR400037	.048/1.206
SR400038	.062/1.587
SR400039	.078/1.981

- 10 NP 403390**
NAMEPLATE
- 11 SC 400682**
SCREW, drive (2)
- 12 GE 400643**
GEAR, segment (6)

See #7

- PL 400028 33**
PLATE
- SD 400005 32**
STUD (3)
- WA 406077 31**
LOCKWASHER (3)
- NT 400555 30**
NUT (3)
- GA 400771 *29**
GASKET
- CV 400767 28**
COVER
- SC 400060 27**
SCREW, lockwire (2)
- WA 406078 26**
LOCKWASHER (9)
- SC 400061 25**
SCREW (7)

9 SPACER, knob

PART #	THICKNESS INCH/MM
KN400520	.268/6.81
KN400521	.270/6.86
KN400522	.272/6.91
KN400523	.274/6.96
KN400524	.276/7.01
KN400525	.278/7.06
KN400526	.280/7.11
KN400527	.282/7.16
KN400528	.284/7.21
KN400529	.286/7.26
KN400530	.288/7.32

- 13 CV 400772**
COVER
- 14 WA 400547**
LOCKWASHER (16)
- 15 SC 400553**
SCREW (16)

- SC 400486 24**
SCREW (6)
- SV 400511 23**
SLEEVE, control (6)
- GU 400510 22**
SEAT (6)
- SP 400512 21**
SPRING (6)
- GU 401850 20**
SEAT (6)
- GU 400518 19**
SHELL (6)
- PN 400517 18**
PIN (6)
- RL 400514 17**
ROLLER (6)
- GA 400774 *16**
GASKET

*Denotes parts in Gasket Kit, KT 401714.

MODEL 300 #PLM 450061A

ASSY VA 400683
OVERFLOW VALVE
 ASSY-includes 22
 thru 25

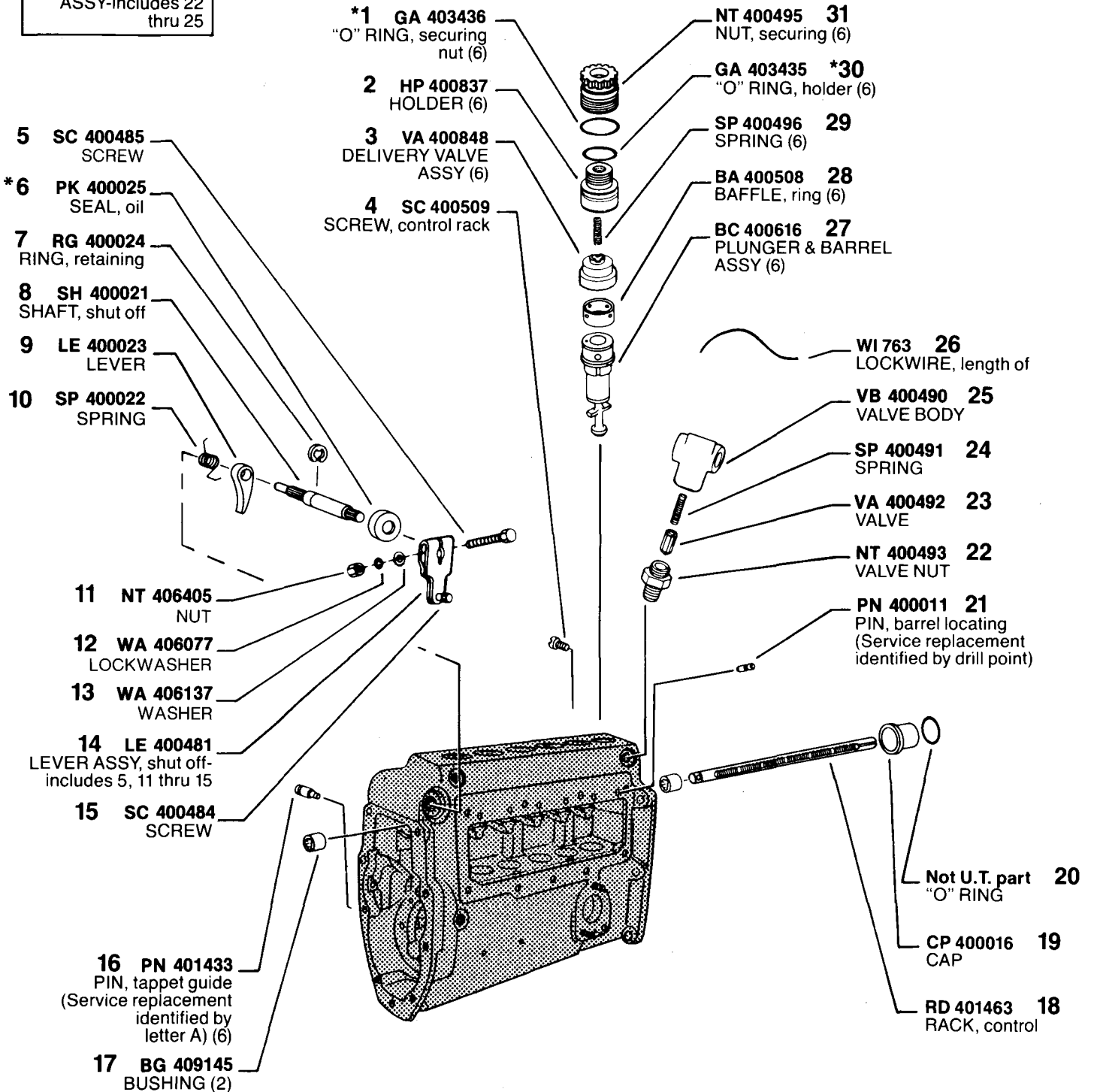

*Denotes parts in Gasket Kit KT 401714.

MODEL 300 #PLM 450061A

ASSY SPT 400710
SUPPLY PUMP ASSY

1 HG 400758
HOUSING ASSY,
includes 8 & 12

2 PN 400605
PIN

3 SP 400708
SPRING

4 GU 400602
TAPPET

5 RL 400603
ROLLER

***6 GA 400554**
GASKET

7 PN 400604
PIN

8 SPINDLE

PLUNGER ASSY **12**

PART #	THICKNESS MM	COLOR CODE
PC400581	24.984/24.989	Two white dots
PC400582	24.986/24.991	Two green dots
PC400583	24.988/24.993	Two yellow dots
PC400584	24.990/24.995	Two red dots
PC400585	24.992/24.997	Two blue dots
PC400586	25.083/25.087	Three black dots
PC400587	25.085/25.089	Two black dots
PC400588	25.089/25.093	Two red & two black dots

PART #	THICKNESS MM	COLOR CODE
SL400581	4.993/4.995	Red one end
SL400582	4.995/4.997	Blue one end
SL400583	4.997/4.999	Yellow one end
SL400743	5.020/5.022	Yellow one end White one end
SL400744	5.044/5.046	Yellow one end Black one end
SL400745	5.067/5.069	White one end Black one end
SL400584	5.087/5.089	White one end
SL400585	5.089/5.091	Black one end
SL400586	5.091/5.093	Green one end
SL400587	5.093/5.095	Alum. one end
SL400746	5.116/5.118	Alum. one end Red one end
SL400747	5.139/5.141	Alum. one end Blue one end
SL400748	5.162/5.164	Alum. one end Yellow one end
SL400589	5.189/5.191	Red both ends
SL400590	5.191/5.193	Blue both ends
SL400591	5.193/5.195	Yellow both ends
SL400592	5.195/5.197	Black both ends

SPINDLE (requires reaming)

PART #	THICKNESS MM	COLOR CODE
SL7912-1	5.557/5.560	Red & blue one end
SL7912-2	5.561/5.564	Red & green one end
SL7912-3	5.565/5.568	Red & yellow one end
SL7912-4	5.569/5.572	Blue & green one end

SC 400753 11
SCREW

GA 400610 10
GASKET

SP 400709 9
SPRING

*Denotes parts in Gasket Kit KT 401714

MODEL 300 #PLM 450061A

ASSY MP 404760
MANUAL PRIMER
ASSY-includes 6
thru 12

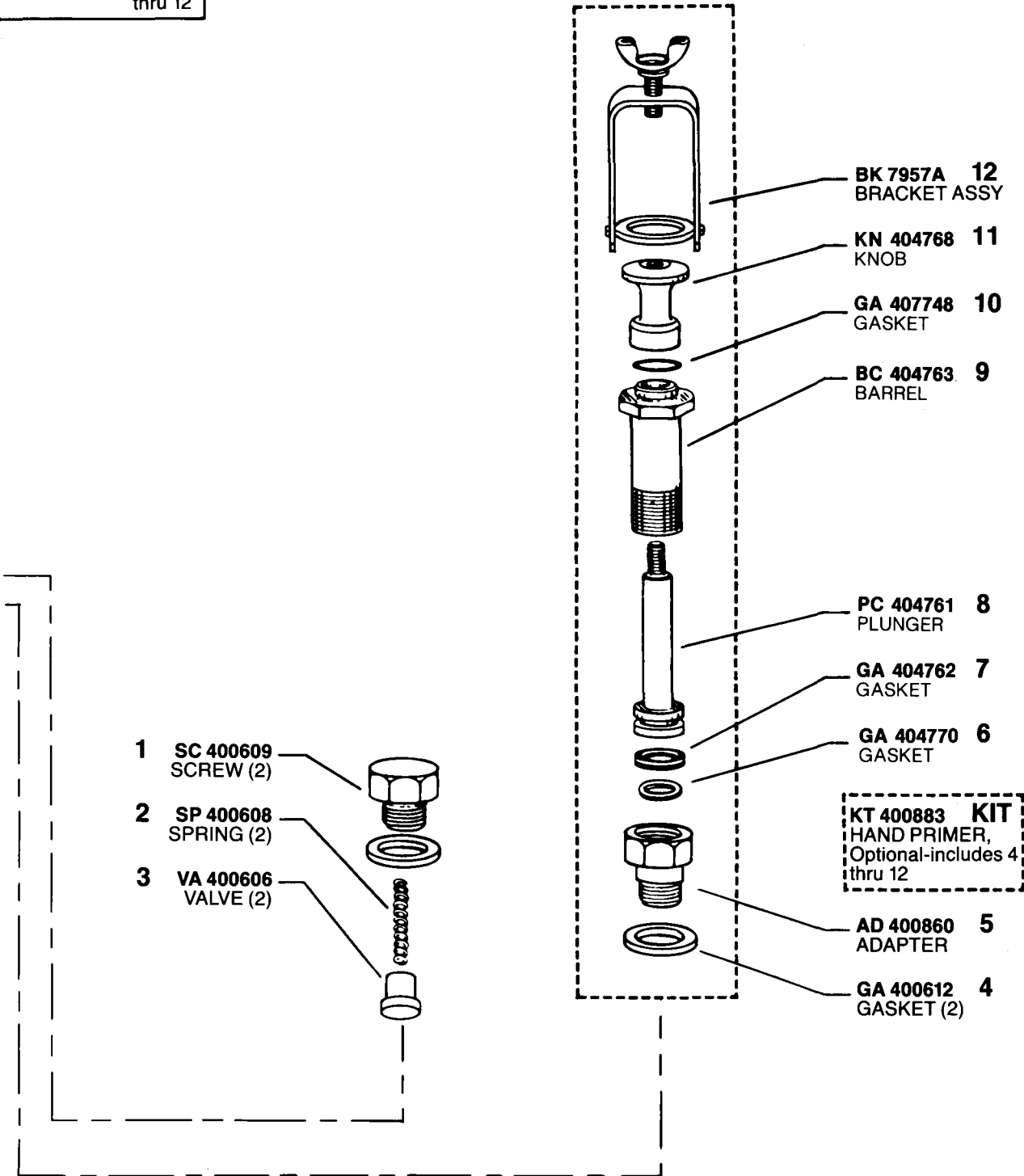

MODEL 300 #PLM 450061A

CALIBRATION SET-UP

Engine Holders HNS 780050
 Opening Pressure 4200-4350 psi
 Engine Nozzles . . NBM770010 (ADB 160M 217-7)
 Engine Nozzle & Holder Assy . . Ref #NHM780000
 High Pressure Tubing 1/4" OD x .067" ID
 x 39" Long

Calibrating Oil Viscor 1487C @ 100°-105°F
 (38-41°C) at pump inlet
 Lube Oil SAE #20 or #30 at 20 psi/1.4 bar
**PROCEDURE . . . Refer to the Service Instructions
 and use figures below**

450061A DATA

Engine Model E6-330
 Engine Static Timing 16°
 Customer No. 313GC5153-P8
 Kit No. KT401584
 Customer Kit No. 313GC5153-P7
 Governor Speeds 250/975
 Cam Nose Angle 97°(±2°)

Governor Outer Spring
 Precompression Flush to 0.5mm (.020")
 Governor Inner Spring Gap . 3.75-4.00mm (.148"-.157")
 Lift to Port Closing 3.00-3.20mm
 (.118"-.126"), cam lift with control rack at
 approximate mid-travel position

STEP	A	B	C	D
	Full Load at 1.250" Rack Ext	Cam Departure	Peak Torque (from actual A delivery)	Drop Screw (from actual A delivery)
RPM	975	1005	800	700
DEL cc/500 str	101.5-106.5	—	+9.5 ± 3.0	+14.0 ± 2.5
DEL cc/300 str	61.0-64.0	—	+5.5 ± 2.0	+8.5 ± 1.5

	E	F	G
	"PLE"	Low Idle	Minimum Delivery
RPM	800	300	75
DEL cc/500 str	52.0-56.0	12-15	—
DEL cc/300 str	31.0-33.5	7- 9	—
DEL cc/100 str	—	—	12.0

SERVICE CHECK—A, C & D are applicable.