

286

A



PUMP ROTATION:
Counterclockwise: Firing Order: 1-5-4-8-6-3-7-2
MOUNT:
Vee
TIMED FOR PORT CLOSING
SPECIAL FEATURES:
3.00:1 Gear Ratio

MACK
APE 8VG PLN 450286

Special Information:

SERVICE PARTS

Following are all parts, part numbers, pump codes and calibrations for the Model: *APE 8VG PLN 450286*. The exploded view drawing below is detailed with part numbers

listed on the pages indicated. Refer to the Index Section for explanations of codes and abbreviations.

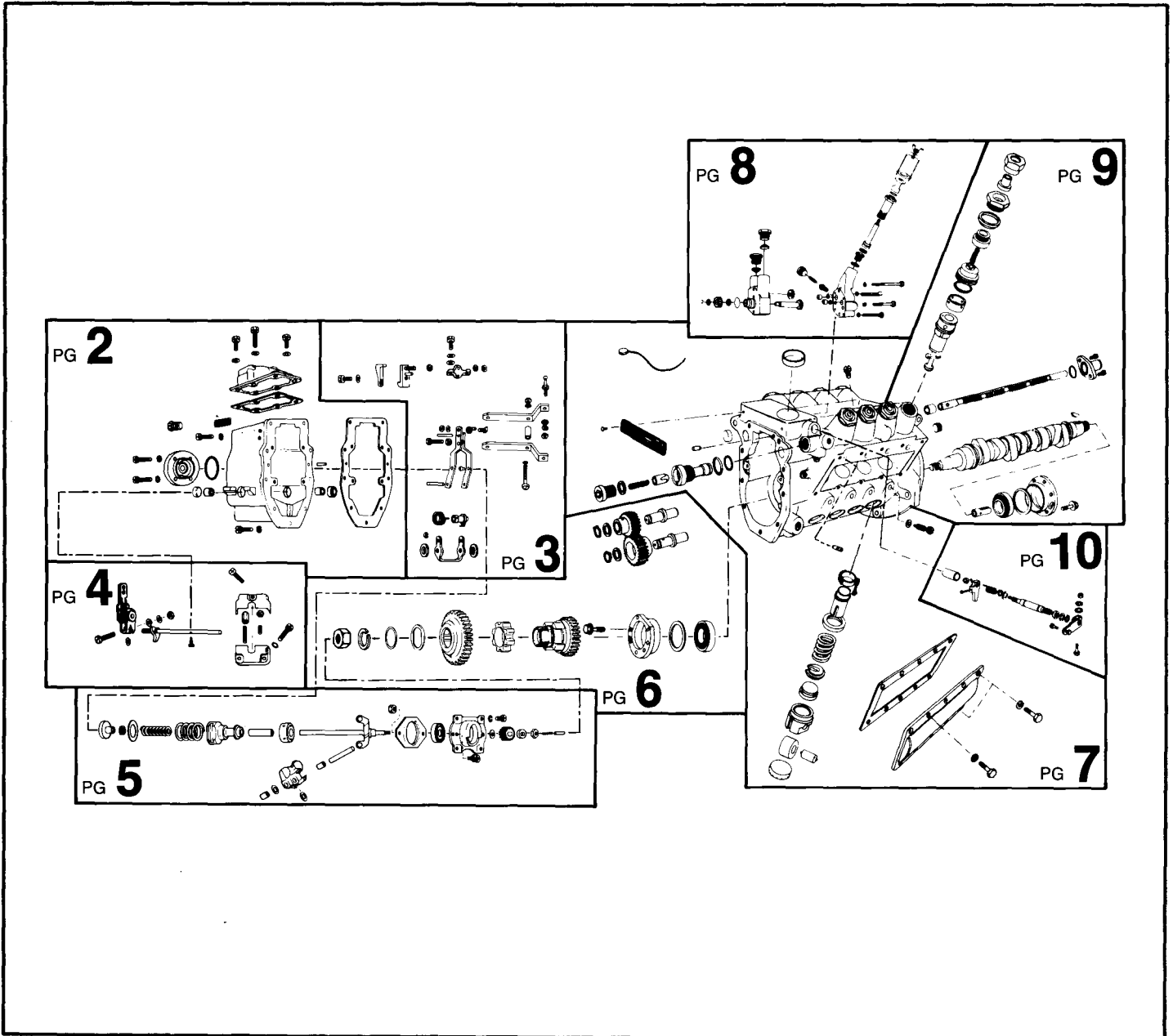

85121

MODEL APE 8VG PLN 450286

ASSY GMS 450287
GOVERNOR ASSY

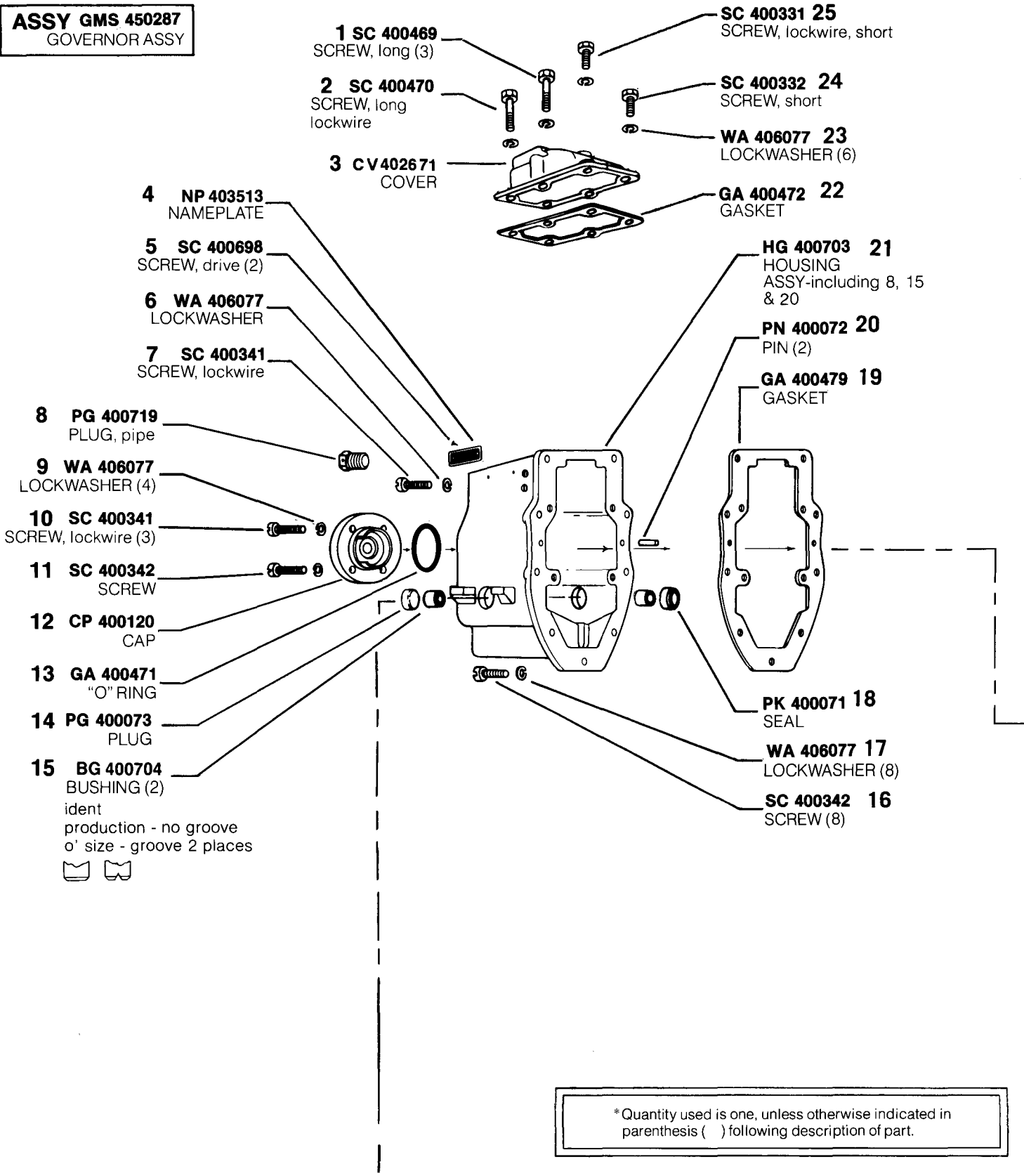

- 1 SC 400469**
SCREW, long (3)
- 2 SC 400470**
SCREW, long
lockwire
- 3 CV402671**
COVER
- 4 NP 403513**
NAMEPLATE
- 5 SC 400698**
SCREW, drive (2)
- 6 WA 406077**
LOCKWASHER
- 7 SC 400341**
SCREW, lockwire
- 8 PG 400719**
PLUG, pipe
- 9 WA 406077**
LOCKWASHER (4)
- 10 SC 400341**
SCREW, lockwire (3)
- 11 SC 400342**
SCREW
- 12 CP 400120**
CAP
- 13 GA 400471**
"O" RING
- 14 PG 400073**
PLUG
- 15 BG 400704**
BUSHING (2)
ident
production - no groove
o' size - groove 2 places

- SC 400331 25**
SCREW, lockwire, short
- SC 400332 24**
SCREW, short
- WA 406077 23**
LOCKWASHER (6)
- GA 400472 22**
GASKET
- HG 400703 21**
HOUSING
ASSY-including 8, 15
& 20
- PN 400072 20**
PIN (2)
- GA 400479 19**
GASKET
- PK 400071 18**
SEAL
- WA 406077 17**
LOCKWASHER (8)
- SC 400342 16**
SCREW (8)

*Quantity used is one, unless otherwise indicated in parenthesis () following description of part.

ASSY LE 402642
LEVER ASSY,
 fulcrum-including 8, 10
 thru 12, 14, 15, 20 thru
 28

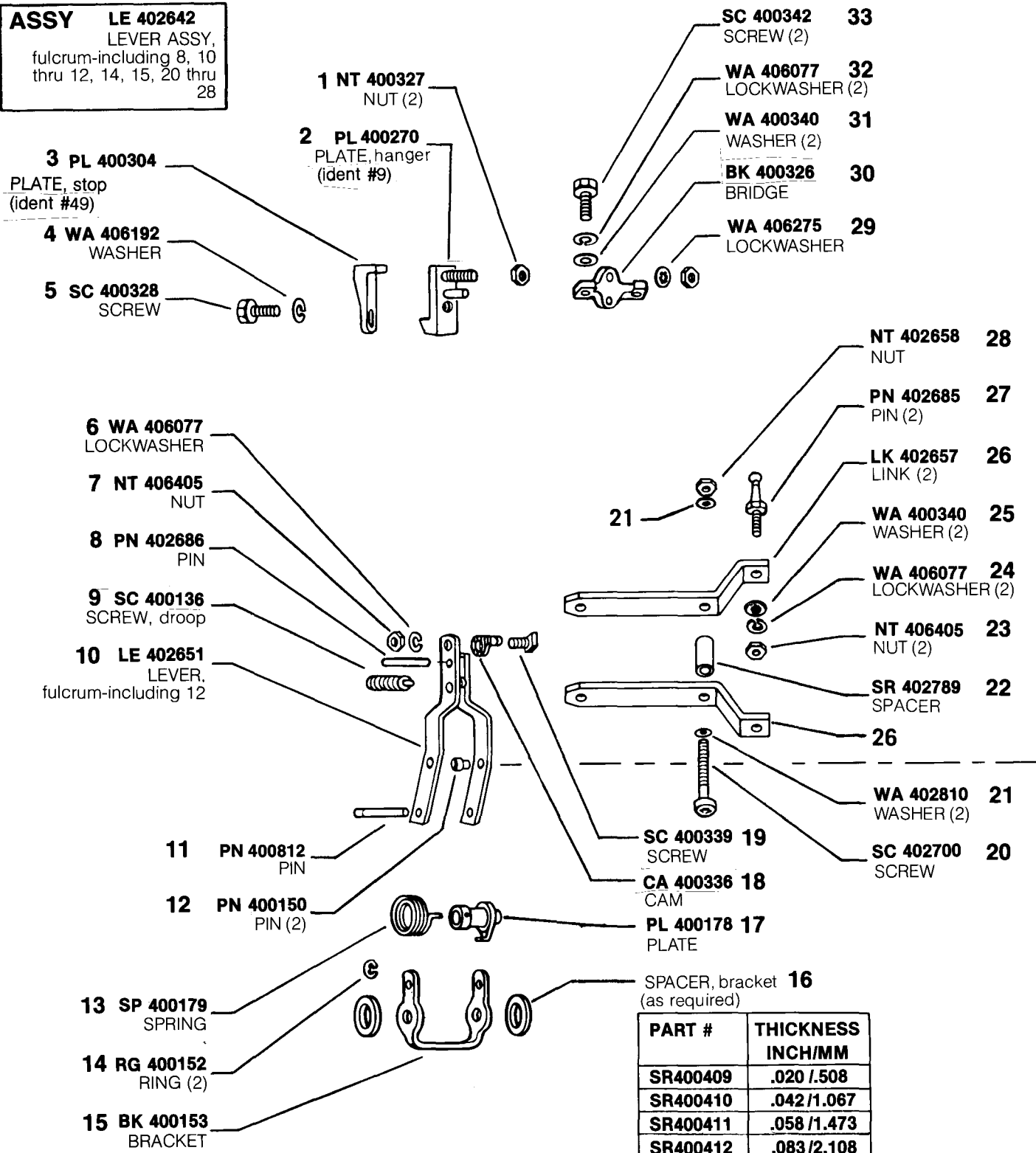

| PART # | THICKNESS INCH/MM |
|----------|----------------------|
| SR400409 | .020 / 1.508 |
| SR400410 | .042 / 1.067 |
| SR400411 | .058 / 1.473 |
| SR400412 | .083 / 2.108 |
| SR400413 | .177 / 4.496 |
| SR400414 | .276 / 7.010 |
| SR400415 | .010 / 1.254 |

MODEL APE 8VG PLN 450286

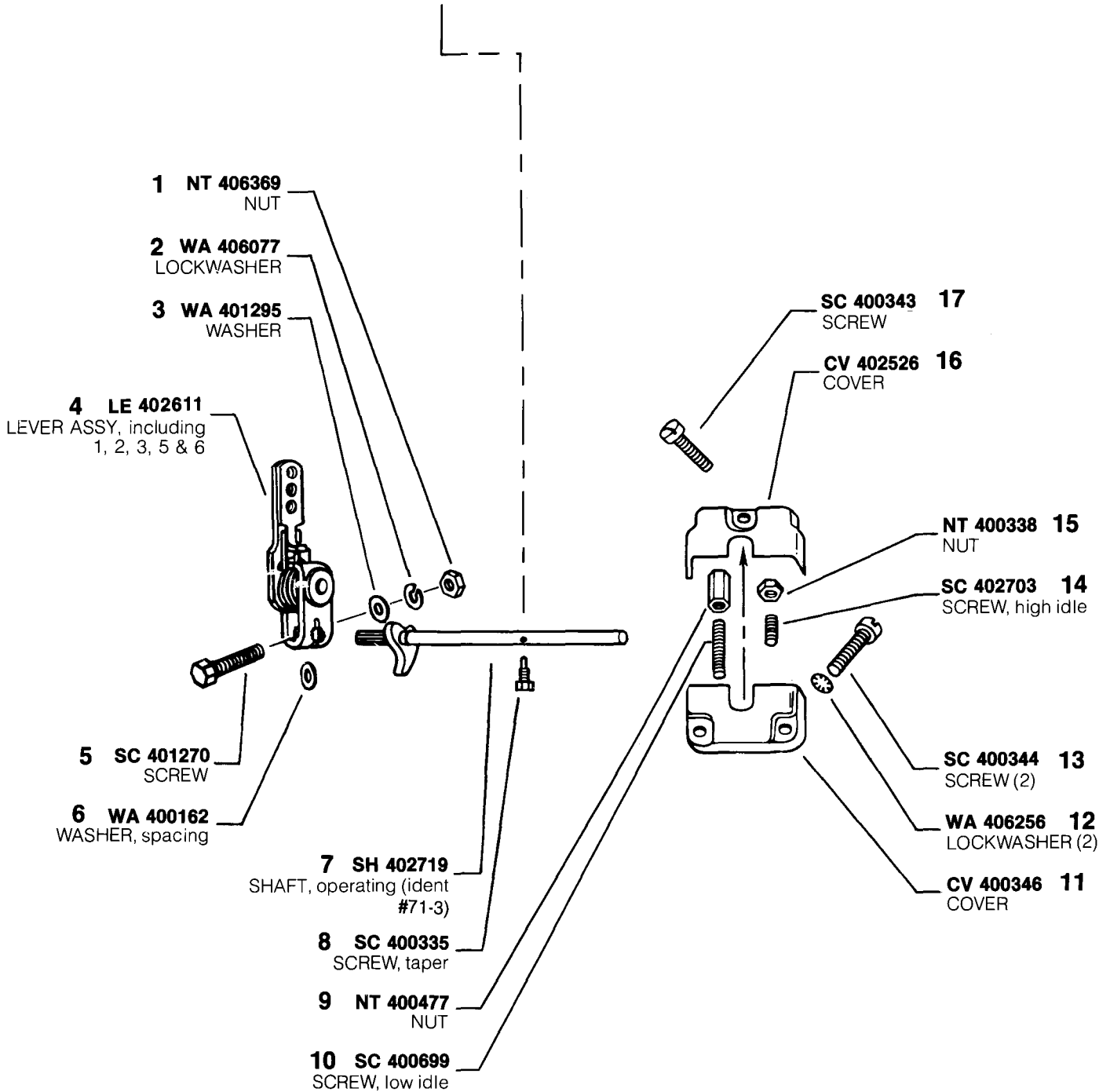

MODEL APE 8VG PLN 450286

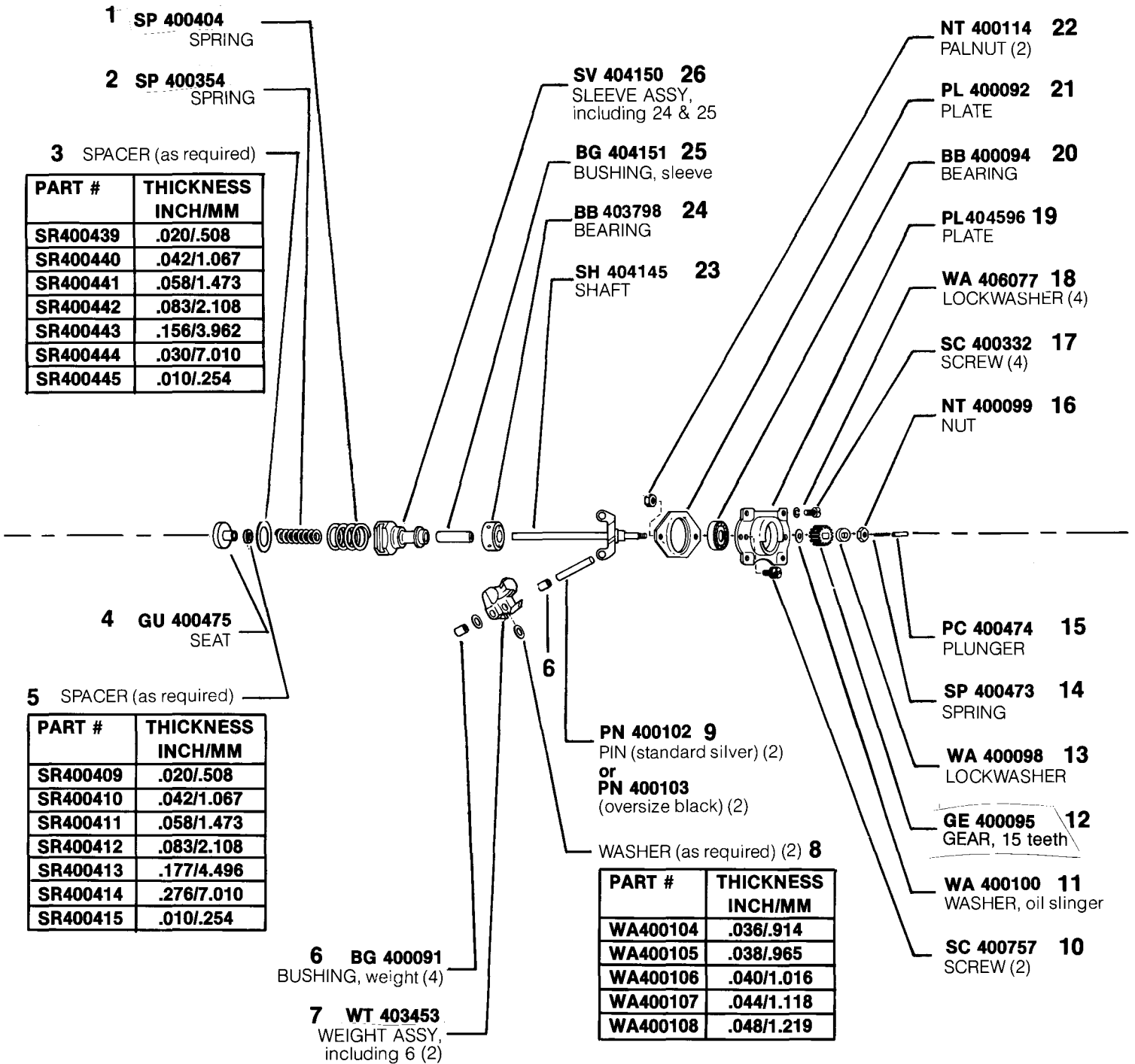

MODEL APE 8VG PLN 450286

ASSY GE 408660
(RUBBER DRIVE)
DRIVE ASSY-including
5, 8 thru 11

PRODUCTION - No Groove
1st 'O' SIZE - One Groove
2nd 'O' SIZE - Two Grooves

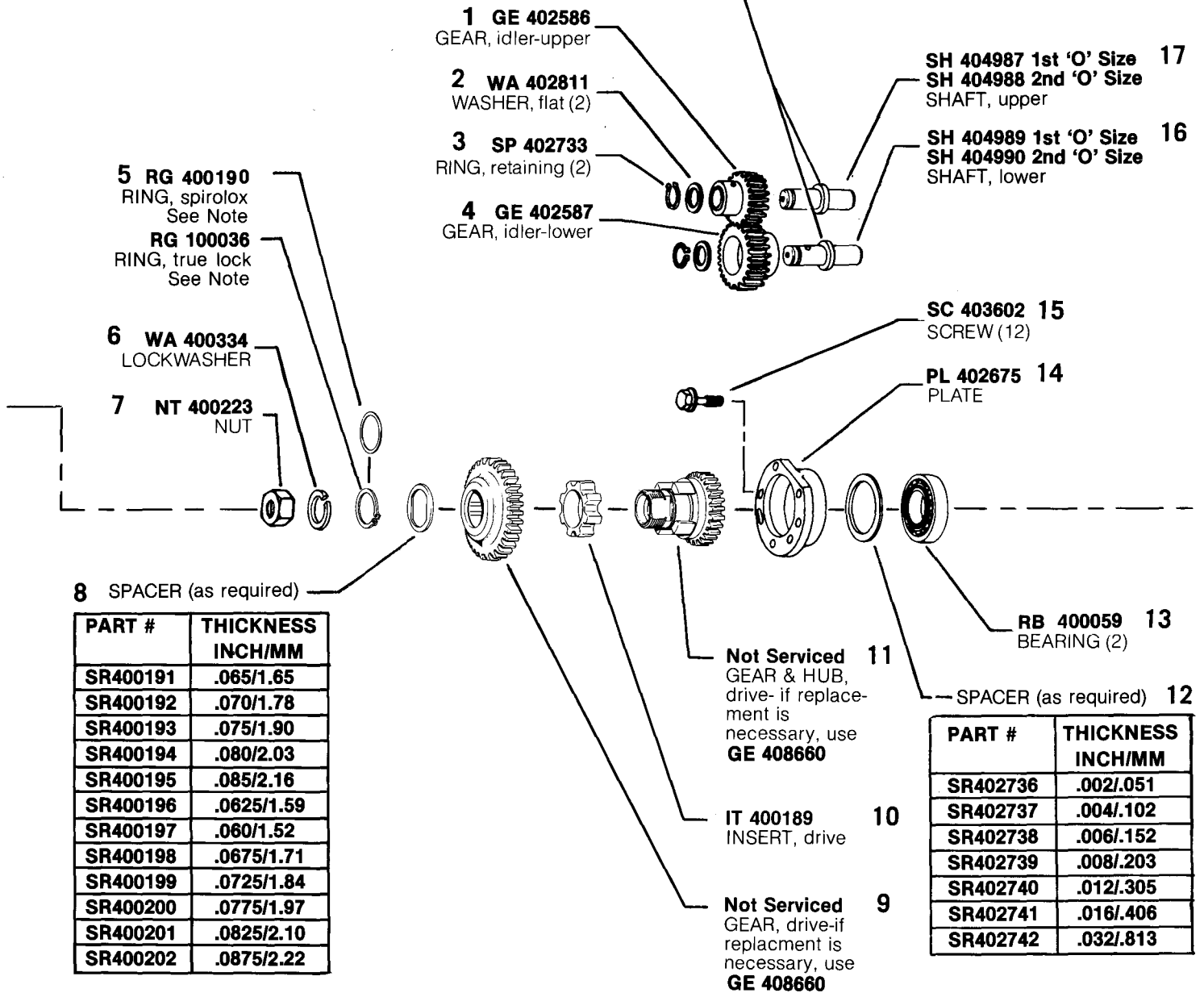
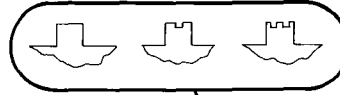

#5 NOTE: Earlier rubber drive assy GE 403794 used RG 400190 (spirolox ring), later assy GE 408660 using RG 100036 (true lock ring). Spirolox & true lock rings are NOT interchangeable.

ASSY VA 402799
VALVE ASSY, overflow -
including 5 thru 11

ASSY TP 402791
TAPPET ASSY-
including 16 & 18 thru
20

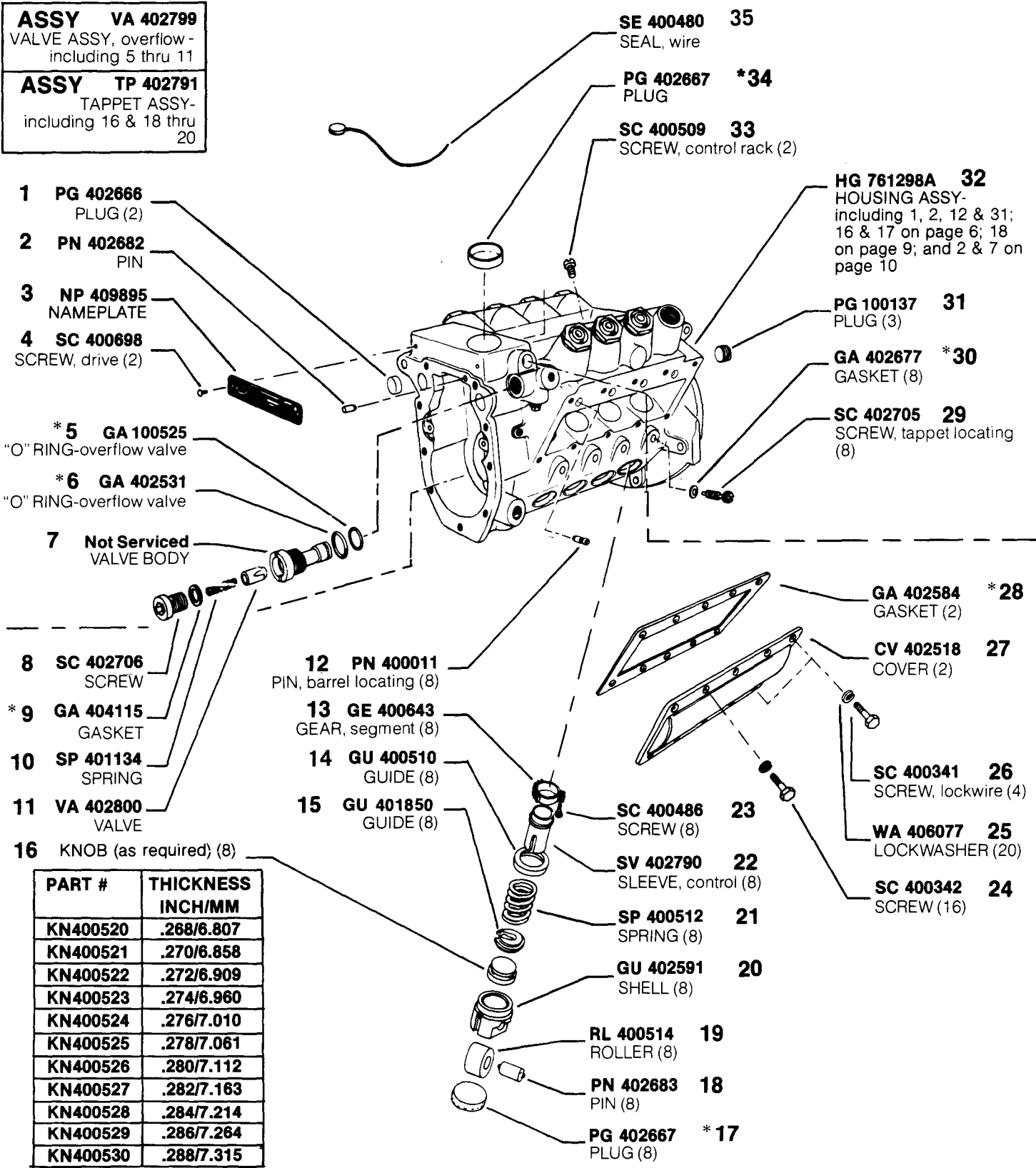

| PART # | THICKNESS INCH/MM |
|----------|----------------------|
| KN400520 | .268/6.807 |
| KN400521 | .270/6.858 |
| KN400522 | .272/6.909 |
| KN400523 | .274/6.960 |
| KN400524 | .276/7.010 |
| KN400525 | .278/7.061 |
| KN400526 | .280/7.112 |
| KN400527 | .282/7.163 |
| KN400528 | .284/7.214 |
| KN400529 | .286/7.264 |
| KN400530 | .288/7.315 |

* Denotes parts included in Pump Repair Gasket Kit-KT 76480.

MODEL APE 8VG PLN 450286

ASSY SGL 450269A
PUMP ASSY, supply

ASSY MP 404760
MANUAL PRIMER
ASSY, including 1 thru
3, 5 & 28 thru 30
(Optional)

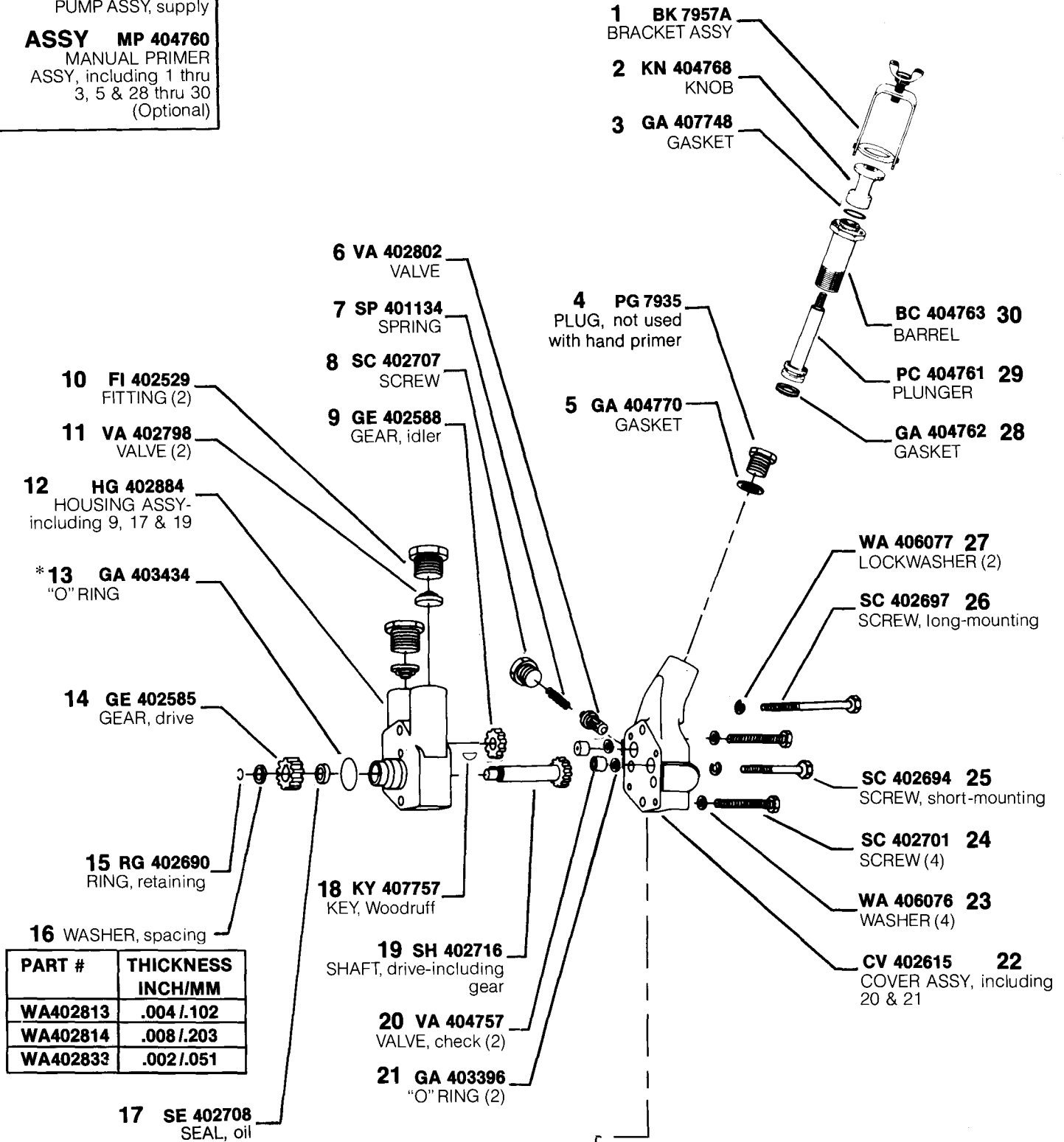

*Denotes parts included in Pump Repair Gasket Kit-KT 76480.

MODEL APE 8VG PLN 450286

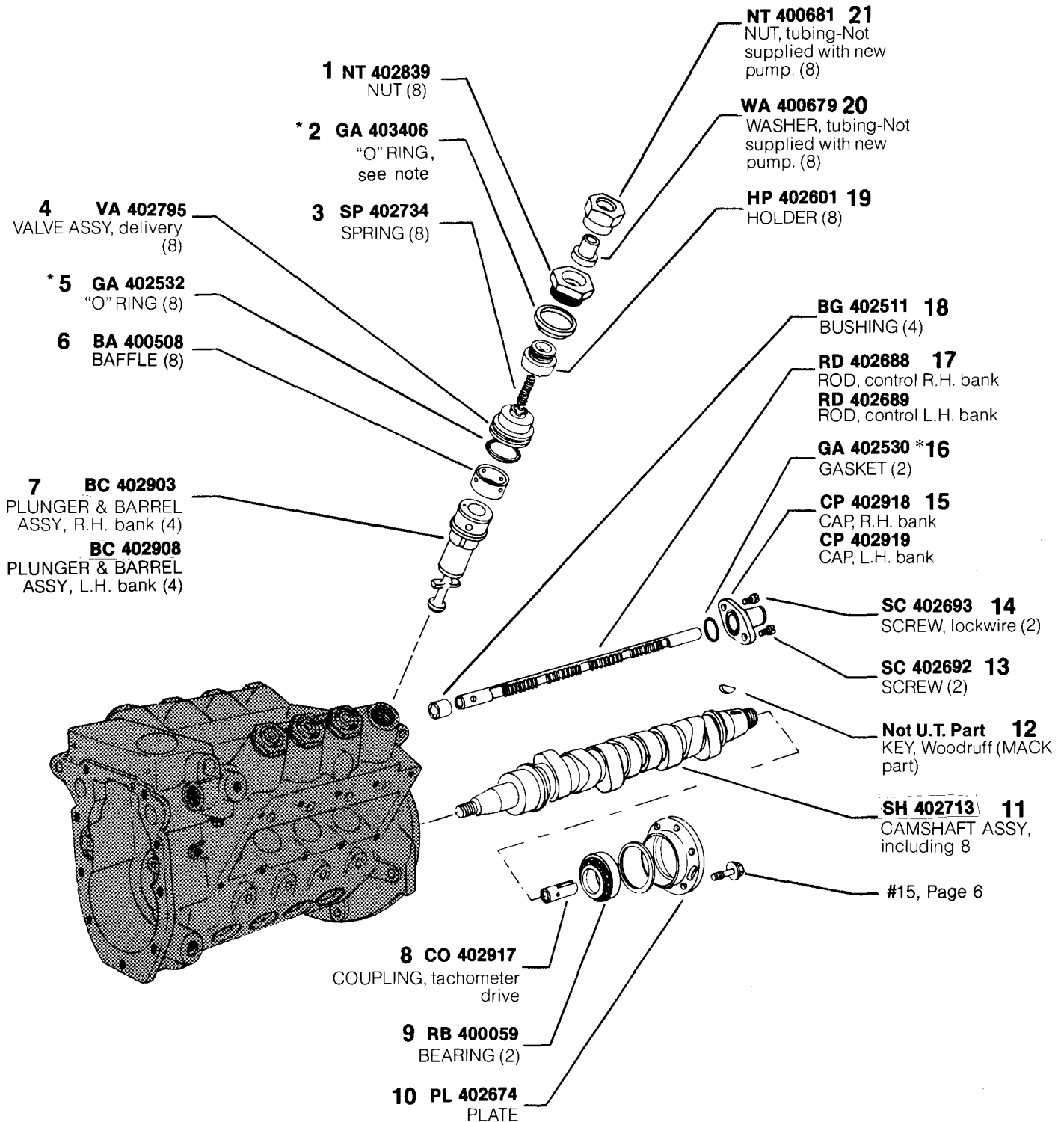

* Denotes parts included in Pump Repair Gasket Kit-KT76480.

#2 NOTE: 403406 "O" Ring replaces square cut ring. See 8VG service bulletin S6.

MODEL APE 8VG PLN 450286

ASSY LE 79298A
 LEVER ASSY, inner
 stop-including 6, 9 & 10

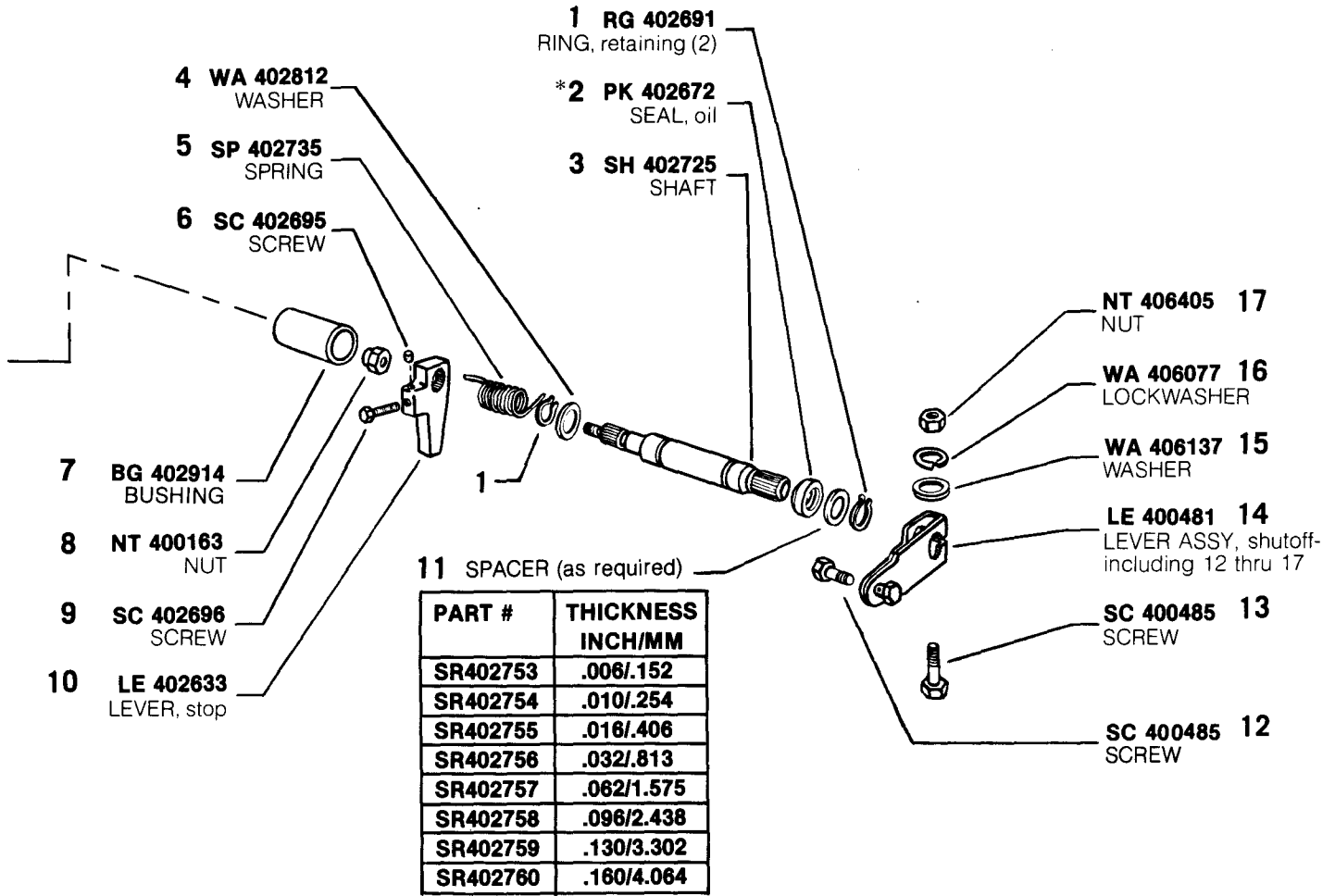

*Denotes parts included in Pump Repair Gasket Kit-KT 76480.

MODEL APE 8VG PLN 450286

