

**MACK**

**AKF**

**2901A**



**UNITED  
TECHNOLOGIES**  
DIESEL SYSTEMS

**TORQUE REQUIREMENTS:**

- #3 COVER CP 7821  
50-60 lbs. ft. (70-80 Nm)
- #6 NUT WVU 2034/2X  
80-85 lbs. ft. (110-115 Nm)
- #13 NUT NT 7876  
50-55 lbs. ft. (70-75 Nm)

**MACK  
AKF 100S 2901A**

**Special Information:**

ORDER NOZZLE SEPARATELY FROM HOLDER.

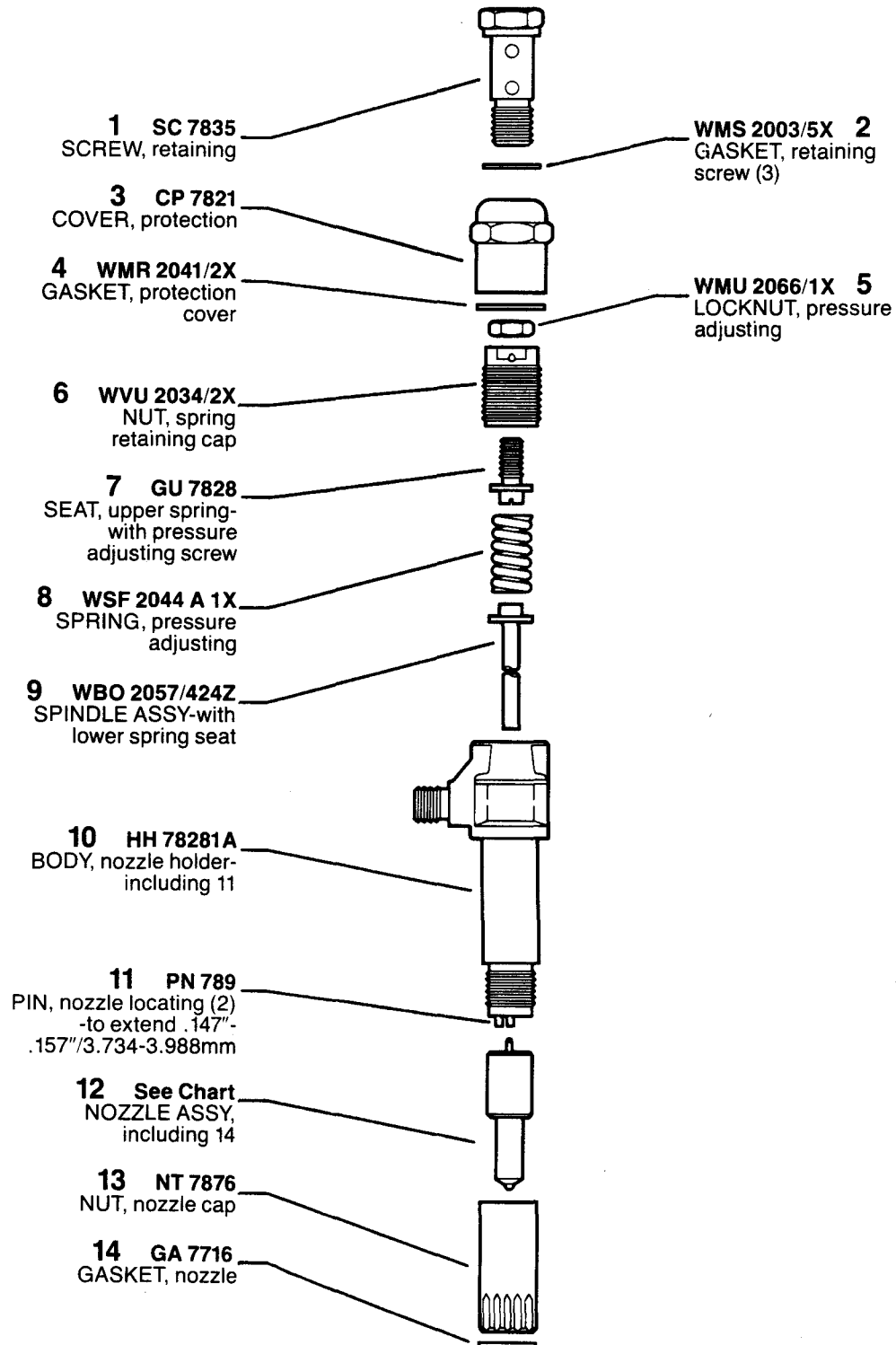

**AKF 100S 2901A**

AKF 100S 2901A  
**SERVICE DATA**

	*Nozzle & Holder	Customer Number	Code	Nozzle Number
1	<b>NONE</b>	<b>736GB-127</b>	<b>NONE</b>	<b>ADB 150S 103</b>

\*Nozzle & Holder number for reference only. Order holder and/or nozzle separately.

	Opening Pressure New Spring		Opening Pressure Used Spring	
	PSI	Bar	PSI	Bar
1	<b>2550-2660</b>	<b>177-185</b>	<b>2300</b>	<b>160</b>

	Lift	Number of Holes	Hole Diameter	Seat Angle
1	<b>.021"/.53mm</b>	<b>4</b>	<b>.340</b>	<b>60°</b>

**AKF 100S 2901A2  
SERVICE DATA**

	*Nozzle & Holder	Customer Number	Code	Nozzle Number
1	NONE	736GB-144	NONE	ADB 150S 103
2	NONE	736GB-156	NONE	ADB 152S 148
3	NONE	736GB-151	NONE	ADB 150S 112
4	NONE	736GB-165	NONE	ADB 152S 154

\*Nozzle & Holder number for reference only. Order holder and/or nozzle separately.

	Opening Pressure New Spring		Opening Pressure Used Spring	
	PSI	Bar	PSI	Bar
1	3300-3500	230-244	3000	209
2	3300-3500	230-244	3000	209
3	3300-3500	230-244	3000	209
4	3300-3500	230-244	3000	209

	Lift	Number of Holes	Hole Diameter	Seat Angle
1	.021"/.53mm	4	.340	60°
2	.021"/.53mm	4	.360	60°
3	.021"/.53mm	4	.360	60°
4	.021"/.53mm	4	.350	60°

# AKF 100S 2901A