

303

A



PUMP ROTATION:
Counterclockwise: Firing Order: 1-5-4-8-6-3-7-2
MOUNT:
Vee
TIMED FOR PORT CLOSING
SPECIAL FEATURES:
3.00:1 Gear Ratio

MACK
APE 8VG PLN 450303

Special Information:

SERVICE PARTS

Following are all parts, part numbers, pump codes and calibrations for the *Model: APE 8VG PLN 450303*. The exploded view drawing below is detailed with part numbers

listed on the pages indicated. Refer to the Index Section for explanations of codes and abbreviations.

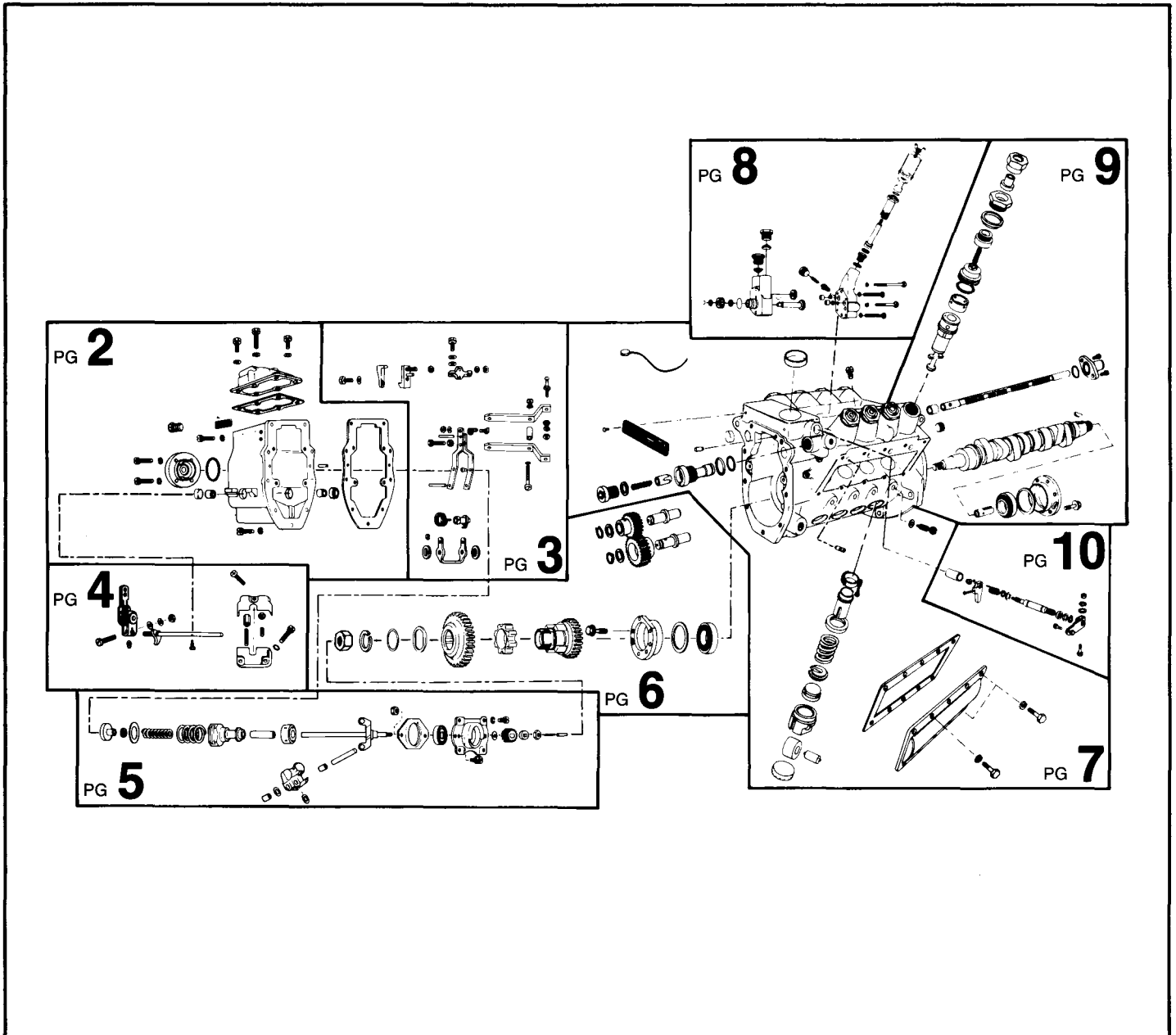

85121

MODEL APE 8VG PLN 450303

ASSY GMS 450271
GOVERNOR ASSY

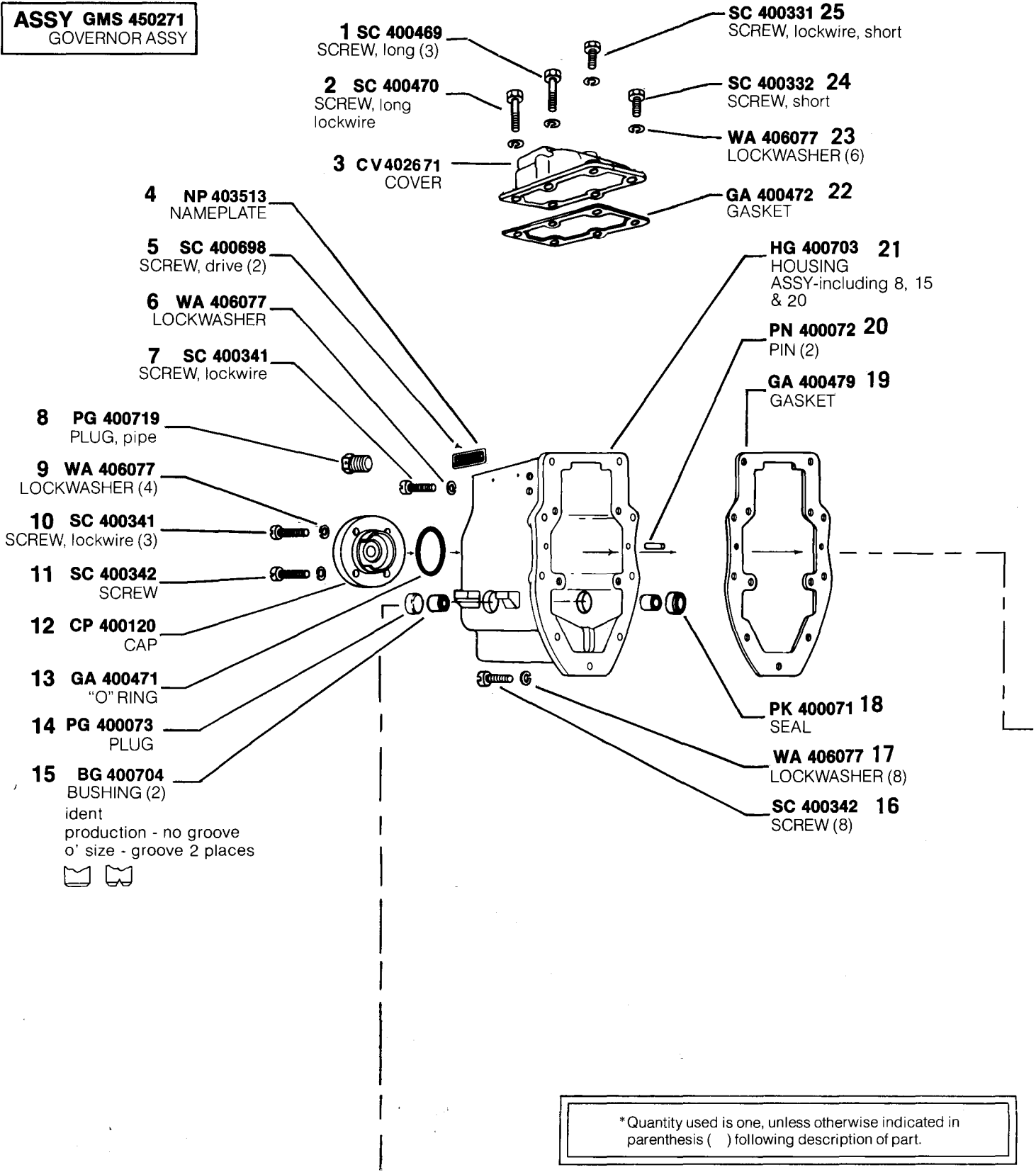

ASSY LE 402642
LEVER ASSY,
 fulcrum-including 8, 10
 thru 12, 14, 15, 20 thru
 28

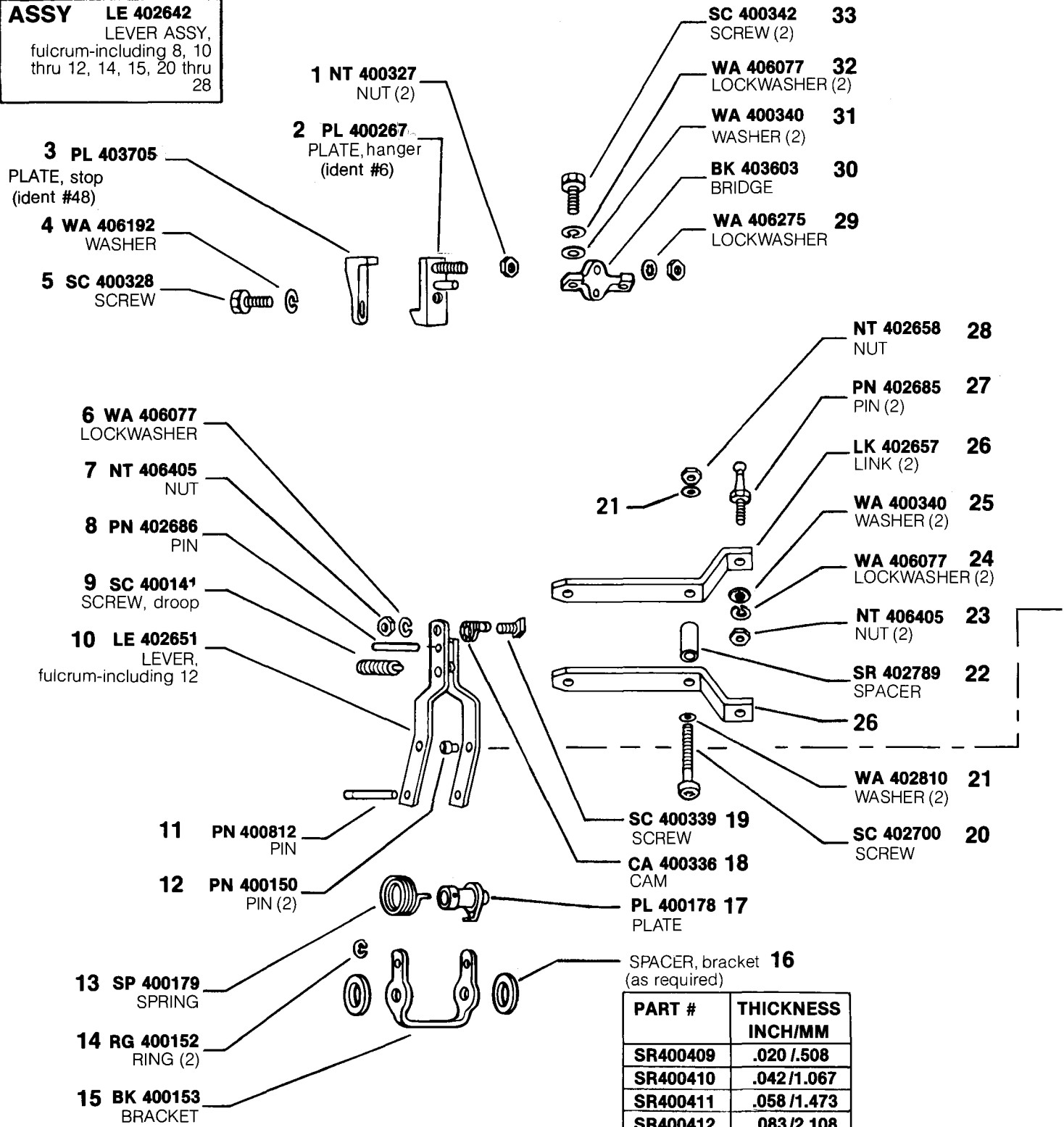

PART #	THICKNESS INCH/MM
SR400409	.020 / 1.508
SR400410	.042 / 1.067
SR400411	.058 / 1.473
SR400412	.083 / 2.108
SR400413	.177 / 4.496
SR400414	.276 / 7.010
SR400415	.010 / .254

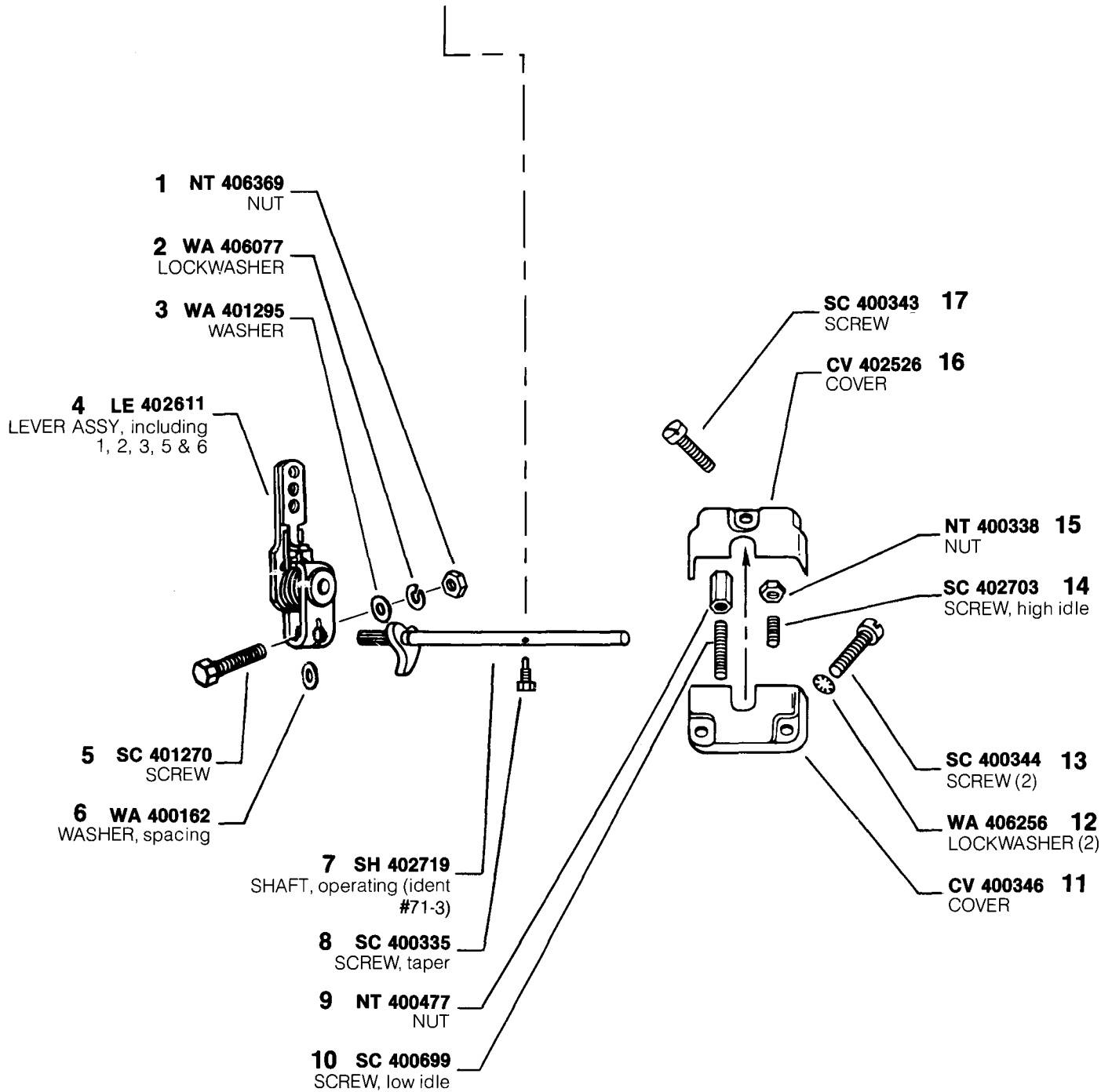

MODEL APE 8VG PLN 450303

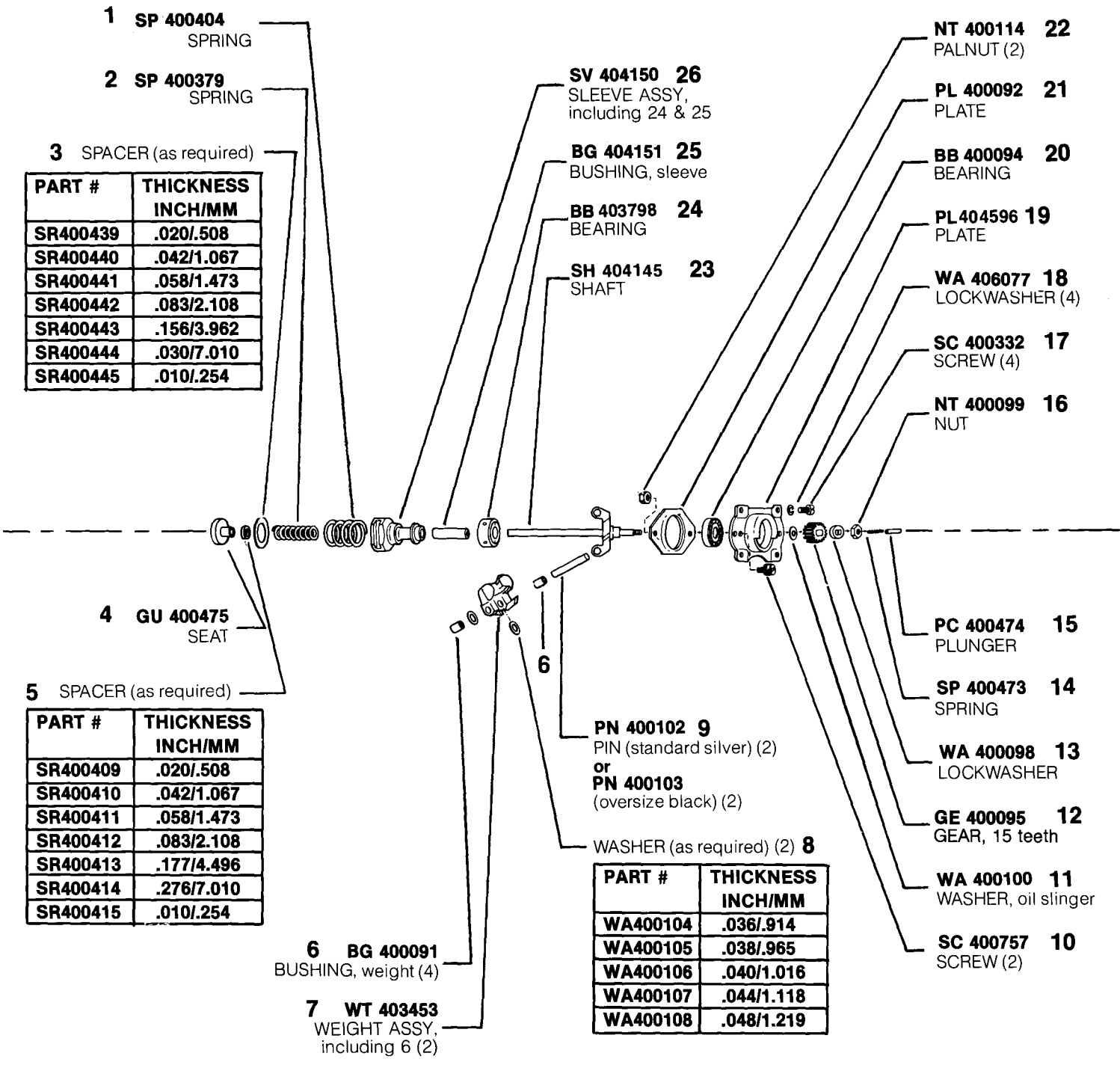

MODEL APE 8VG PLN 450303

ASSY GE 408660
 (RUBBER DRIVE)
 DRIVE ASSY-including
 5, 8 thru 11

PRODUCTION - No Groove
 1st 'O' SIZE - One Groove
 2nd 'O' SIZE - Two Grooves

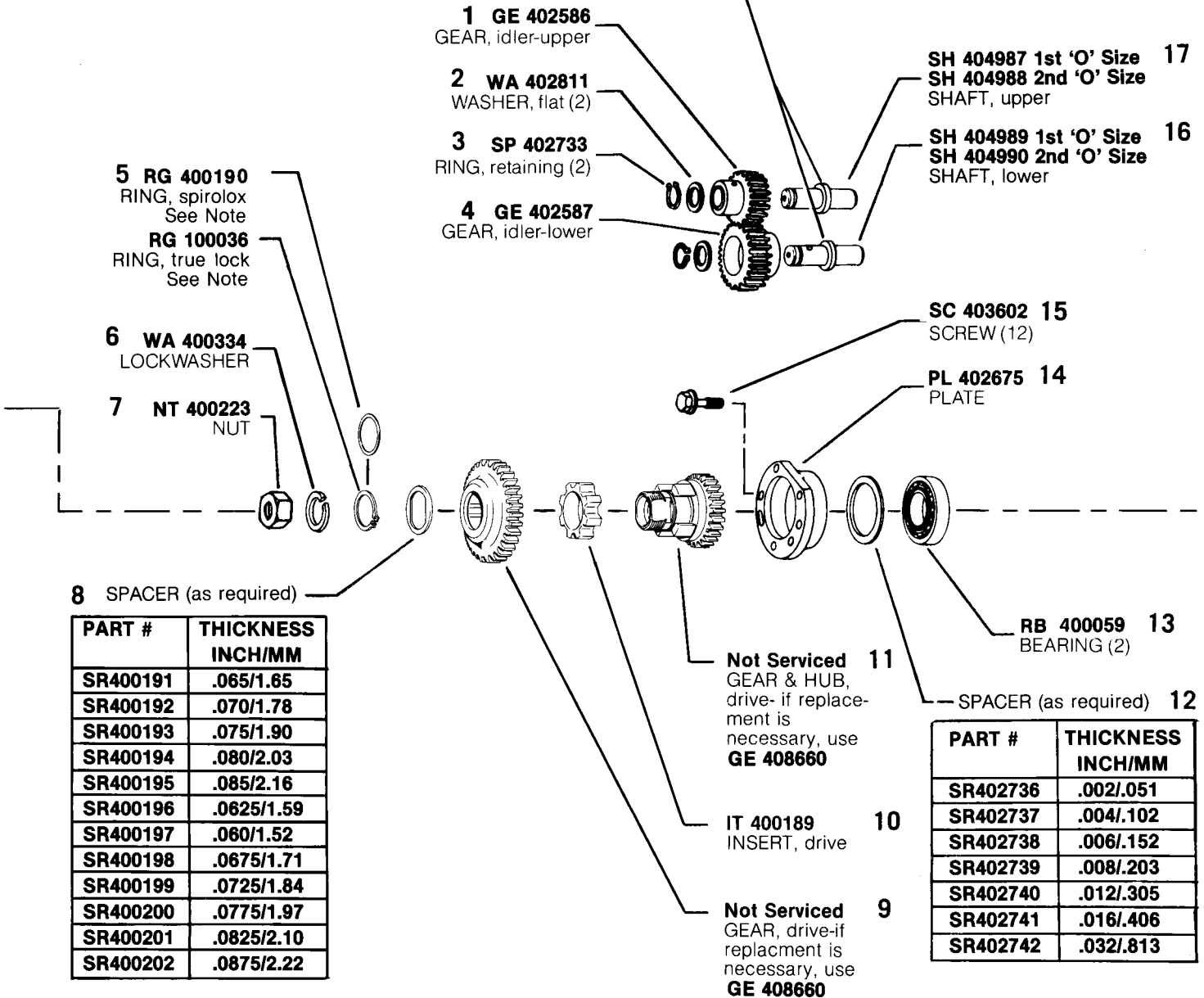
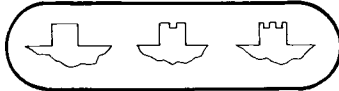

#5 NOTE: Earlier rubber drive assy GE 403794 used RG 400190 (spirolox ring), later assy GE 408660 using RG 100036 (true lock ring). Spirolox & true lock rings are NOT interchangeable.

ASSY VA 402799
VALVE ASSY, overflow -
including 5 thru 11

ASSY TP 402791
TAPPET ASSY -
including 16 & 18 thru
20

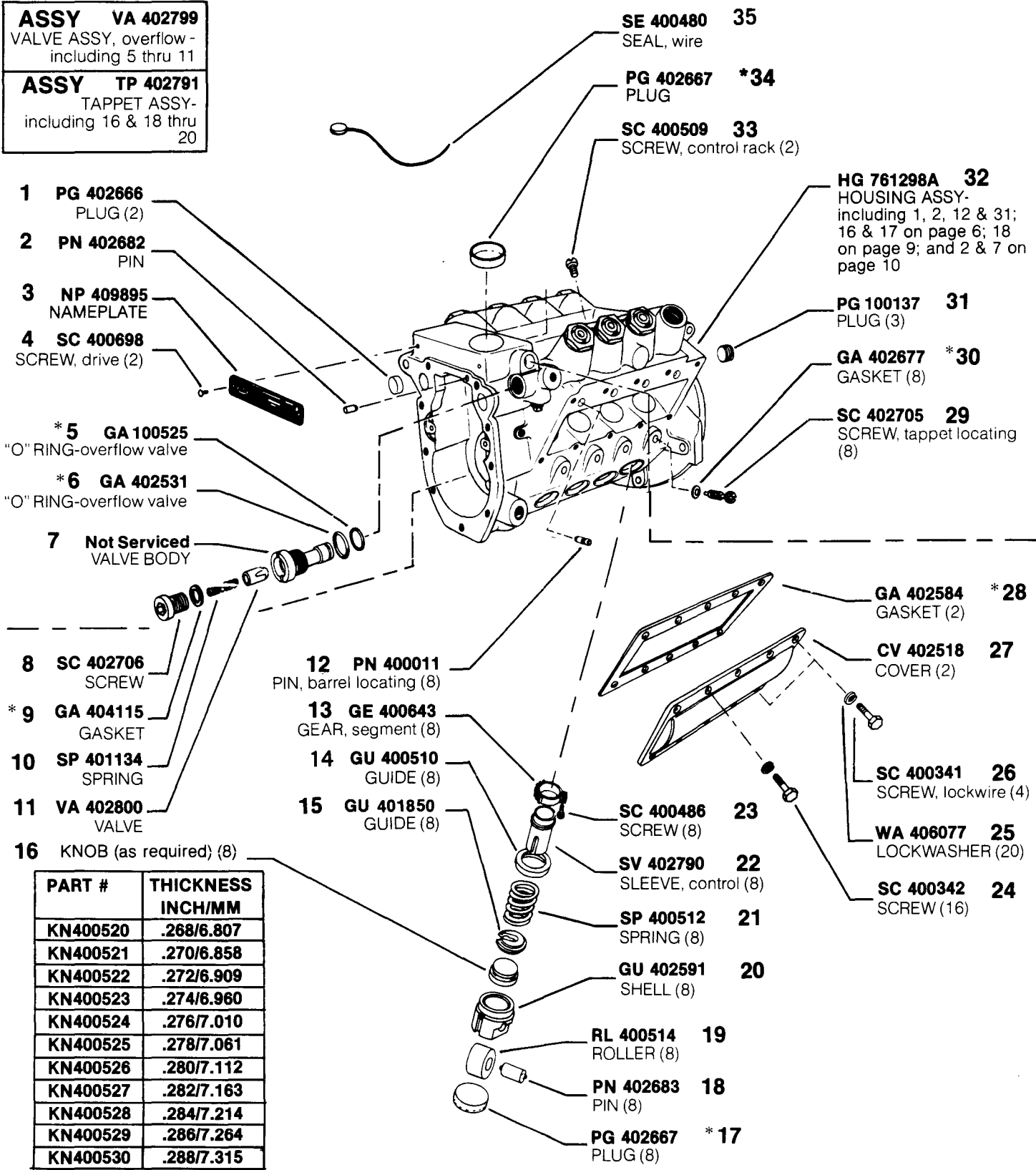

PART #	THICKNESS INCH/MM
KN400520	.268/6.807
KN400521	.270/6.858
KN400522	.272/6.909
KN400523	.274/6.960
KN400524	.276/7.010
KN400525	.278/7.061
KN400526	.280/7.112
KN400527	.282/7.163
KN400528	.284/7.214
KN400529	.286/7.264
KN400530	.288/7.315

*Denotes parts included in Pump Repair Gasket Kit-KT 76480.

MODEL APE 8VG PLN 450303

ASSY SGL 450269A
PUMP ASSY, supply

ASSY MP 404760
MANUAL PRIMER
ASSY, including 1 thru
3, 5 & 28 thru 30
(Optional)

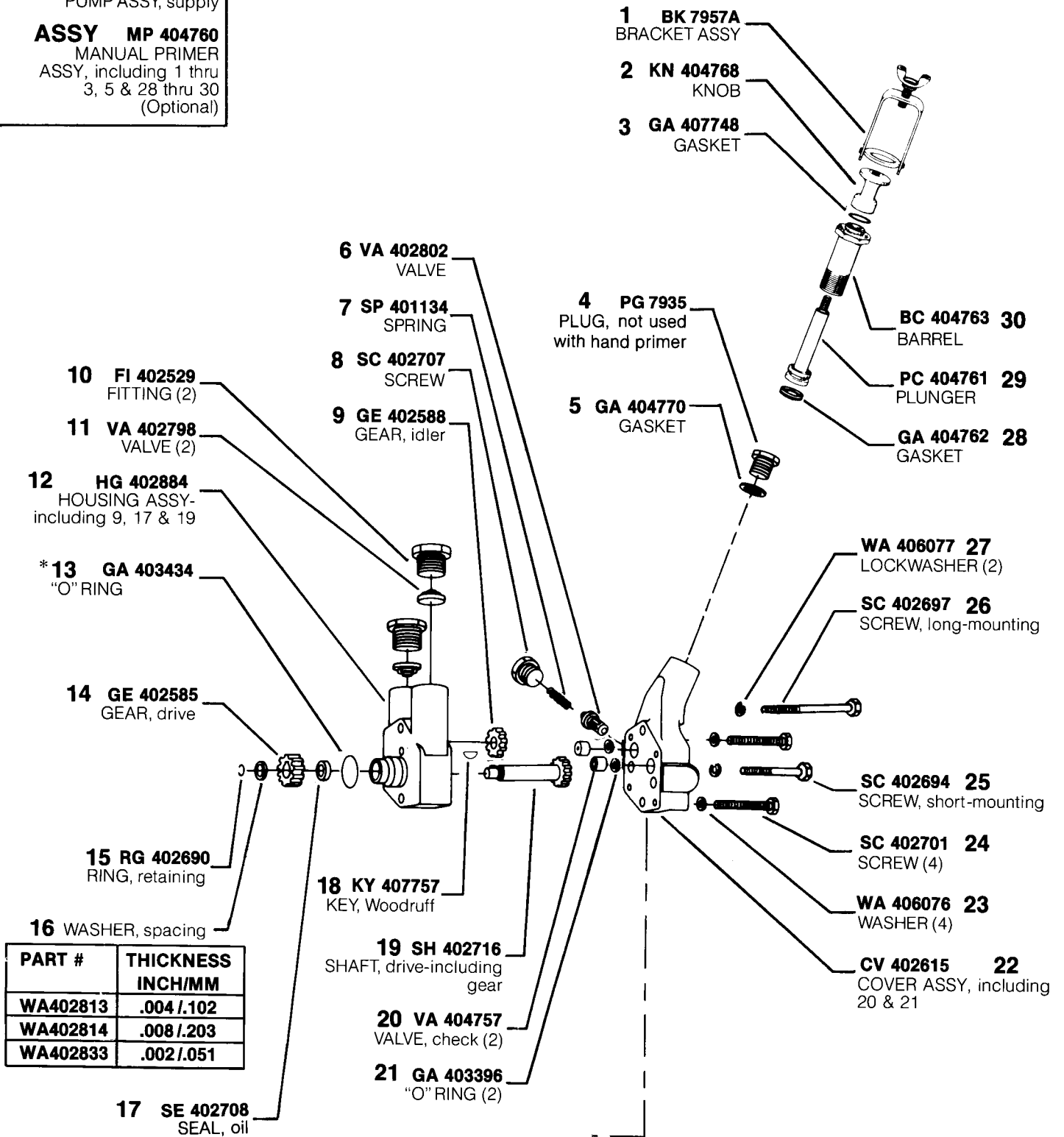

*Denotes parts included in Pump Repair Gasket Kit-KT 76480.

MODEL APE 8VG PLN 450303

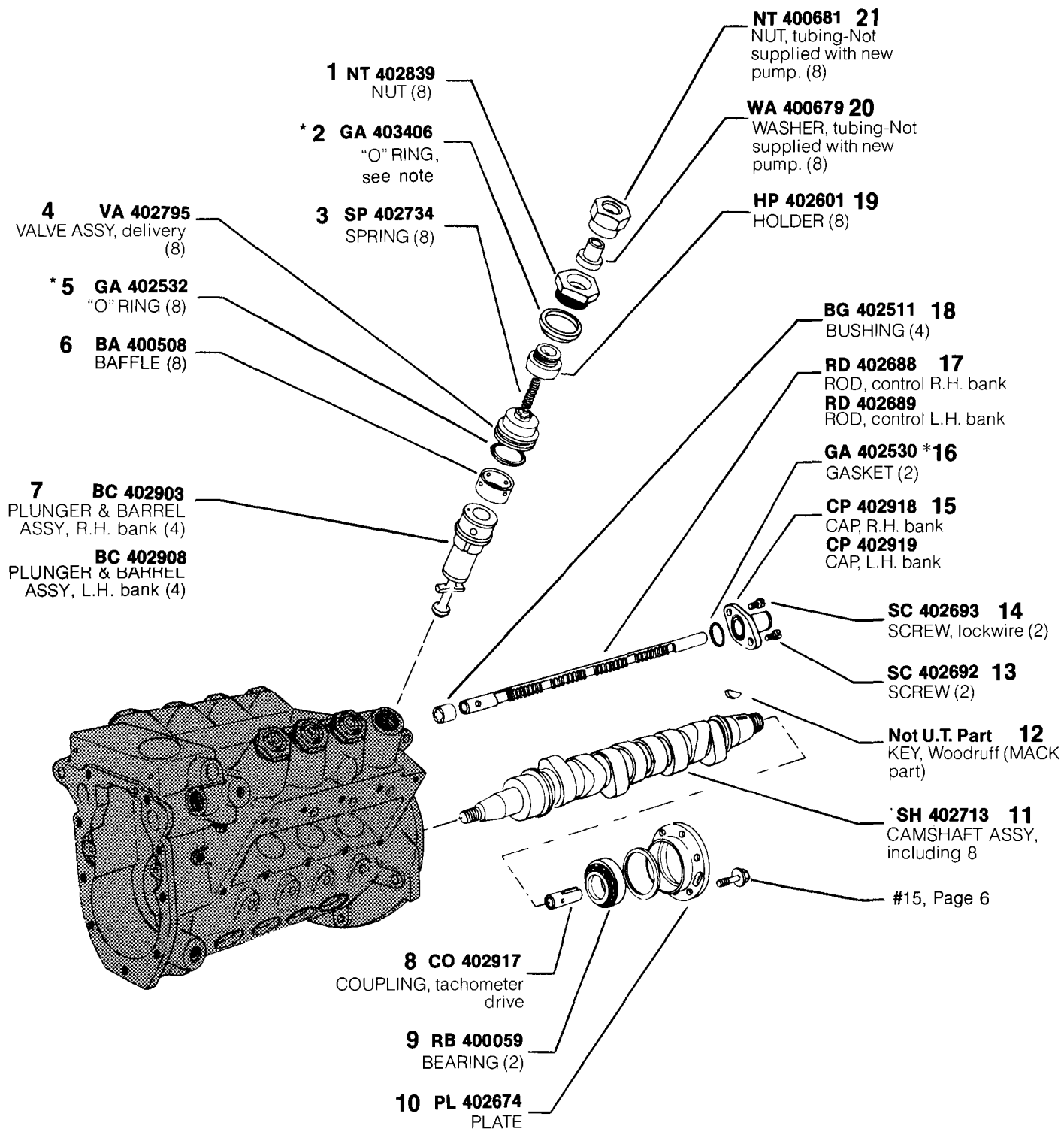

* Denotes parts included in Pump Repair Gasket Kit-KT76480.
#2 NOTE: 403406 "O" Ring replaces square cut ring. See 8VG service bulletin S6.

MODEL APE 8VG PLN 450303

ASSY LE 79298A
 LEVER ASSY, inner
 stop-including 6, 9 & 10

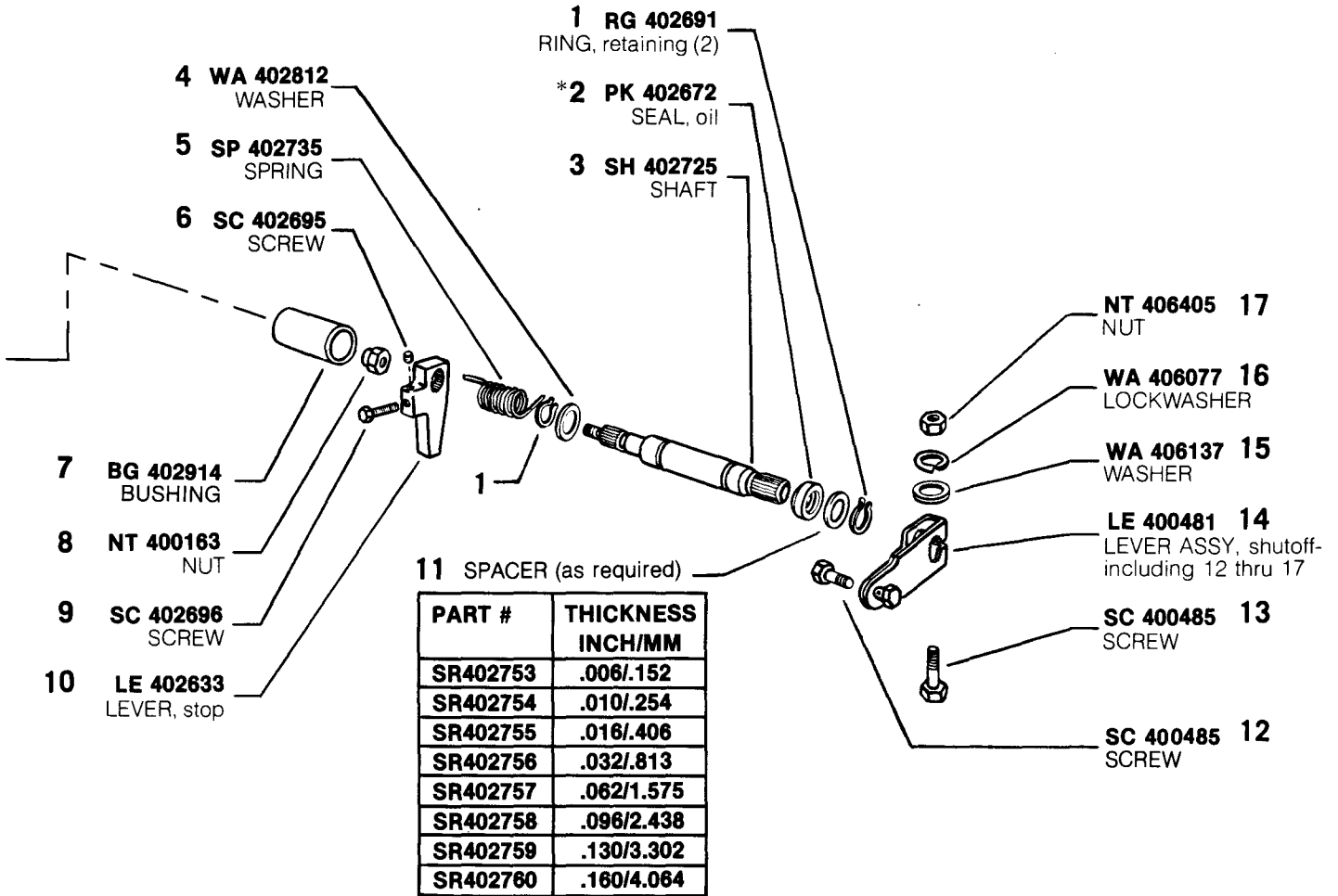

*Denotes parts included in Pump Repair Gasket Kit-KT 76480.

MODEL APE 8VG PLN 450303

