

6572

E

PUMP ROTATION:
Clockwise: Firing Order: 1-5-3-6-2-4
DRIVE END:
R. H. Side
TIMED FOR PORT CLOSING
SPECIAL FEATURES:

MACK
APE 6BB 110T 6572E

Special Information:



SERVICE PARTS

Following are all parts, part numbers, pump codes and calibrations for the *Model: APE 6BB 110T 6572E*. The exploded view drawing below is detailed with part numbers

listed on the pages indicated. Refer to the Index Section for explanations of codes and abbreviations.

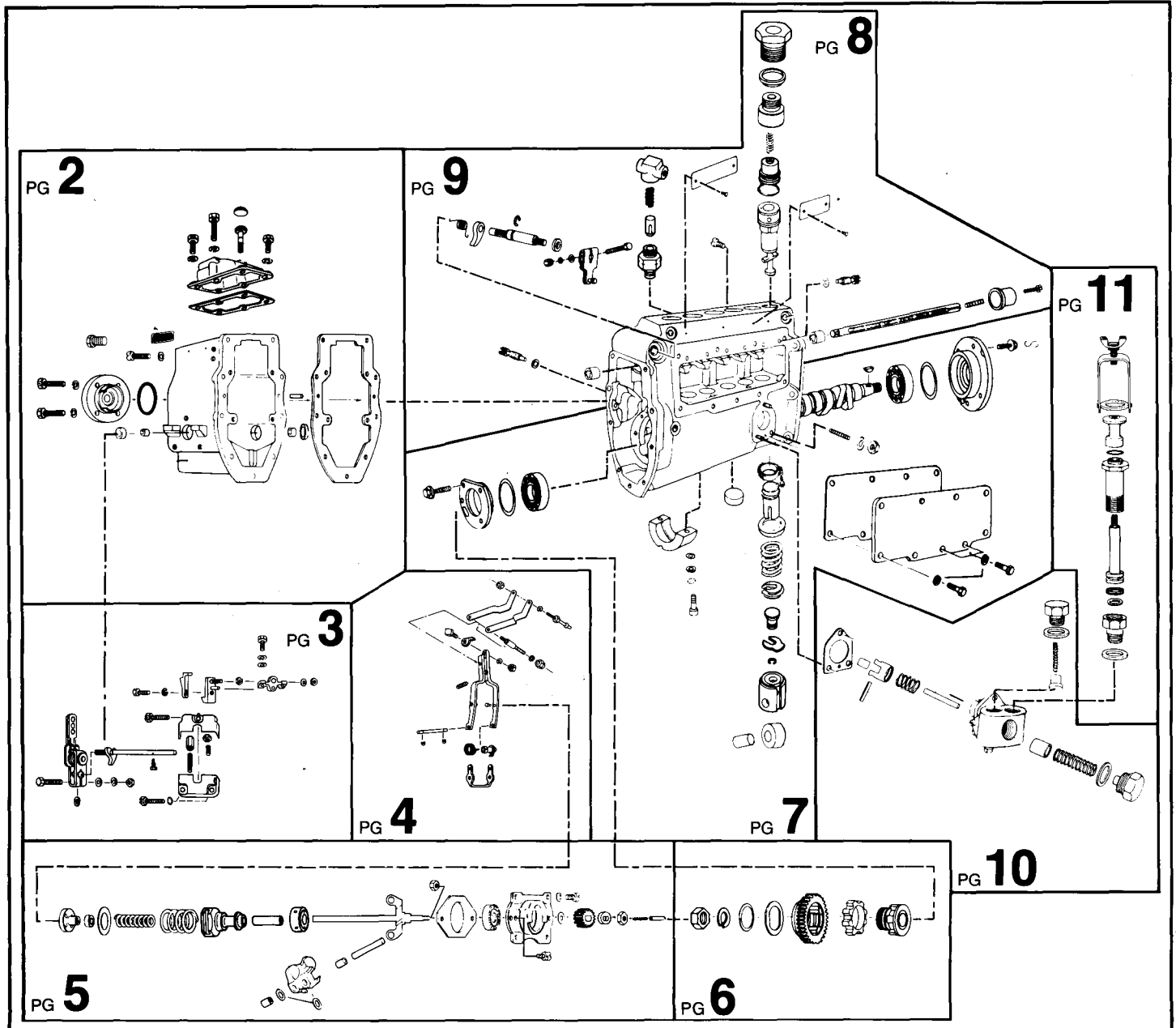

MODEL APE 6BB 110T 6572E

ASSY GVB/C 6663A-C
GOVERNOR ASSY
 Use on 6572E (parallel fuel adjustment)

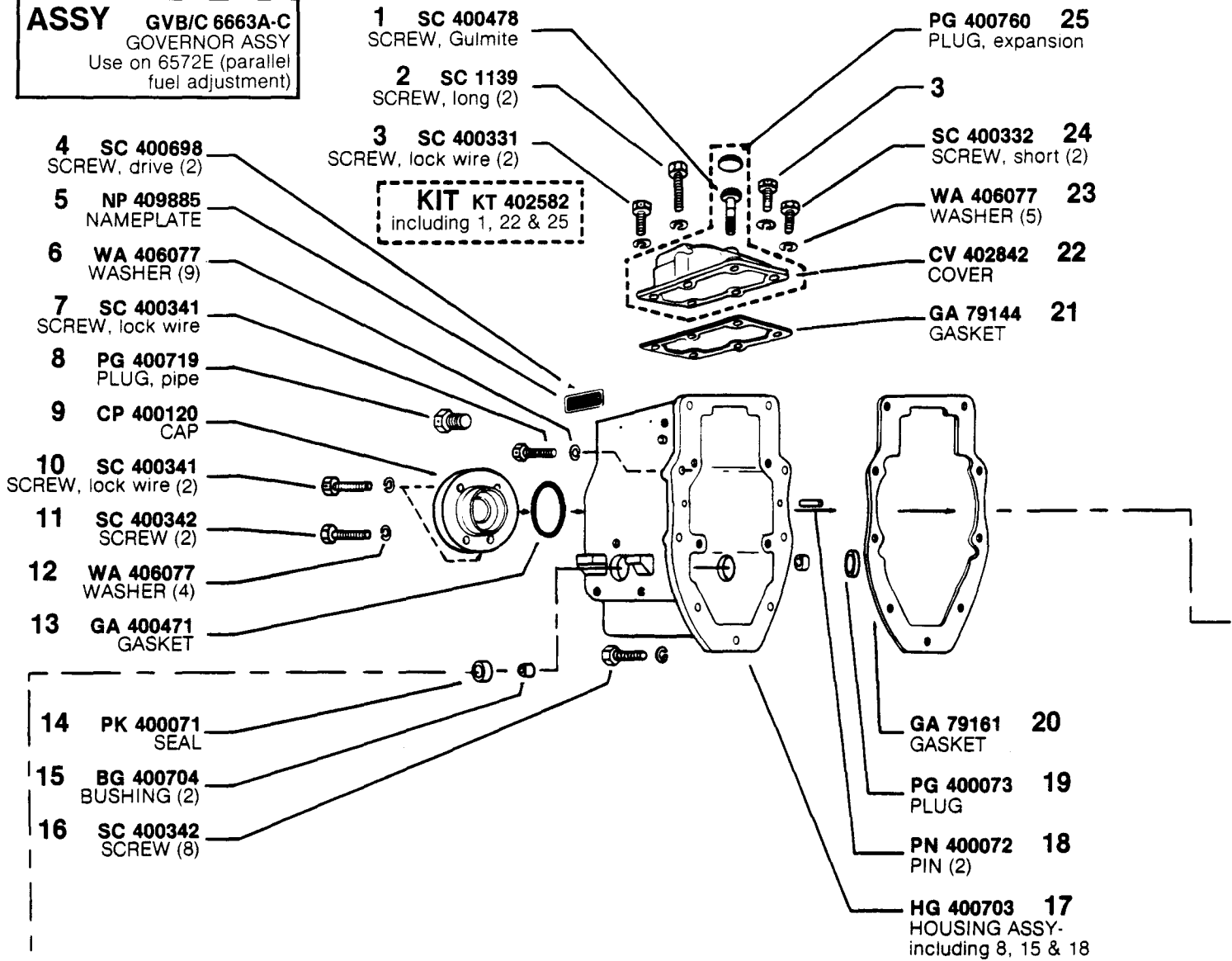

1 SC 400478
 SCREW, Gulmite

2 SC 1139
 SCREW, long (2)

3 SC 400331
 SCREW, lock wire (2)

KIT KT 402582
 including 1, 22 & 25

PG 400760 25
 PLUG, expansion

3

SC 400332 24
 SCREW, short (2)

WA 406077 23
 WASHER (5)

CV 402842 22
 COVER

GA 79144 21
 GASKET

4 SC 400698
 SCREW, drive (2)

5 NP 409885
 NAMEPLATE

6 WA 406077
 WASHER (9)

7 SC 400341
 SCREW, lock wire

8 PG 400719
 PLUG, pipe

9 CP 400120
 CAP

10 SC 400341
 SCREW, lock wire (2)

11 SC 400342
 SCREW (2)

12 WA 406077
 WASHER (4)

13 GA 400471
 GASKET

14 PK 400071
 SEAL

15 BG 400704
 BUSHING (2)

16 SC 400342
 SCREW (8)

GA 79161 20
 GASKET

PG 400073 19
 PLUG

PN 400072 18
 PIN (2)

HG 400703 17
 HOUSING ASSY-
 including 8, 15 & 18

*Quantity used is one, unless otherwise indicated in parenthesis () following description of part.

MODEL APE 6BB 110T 6572E

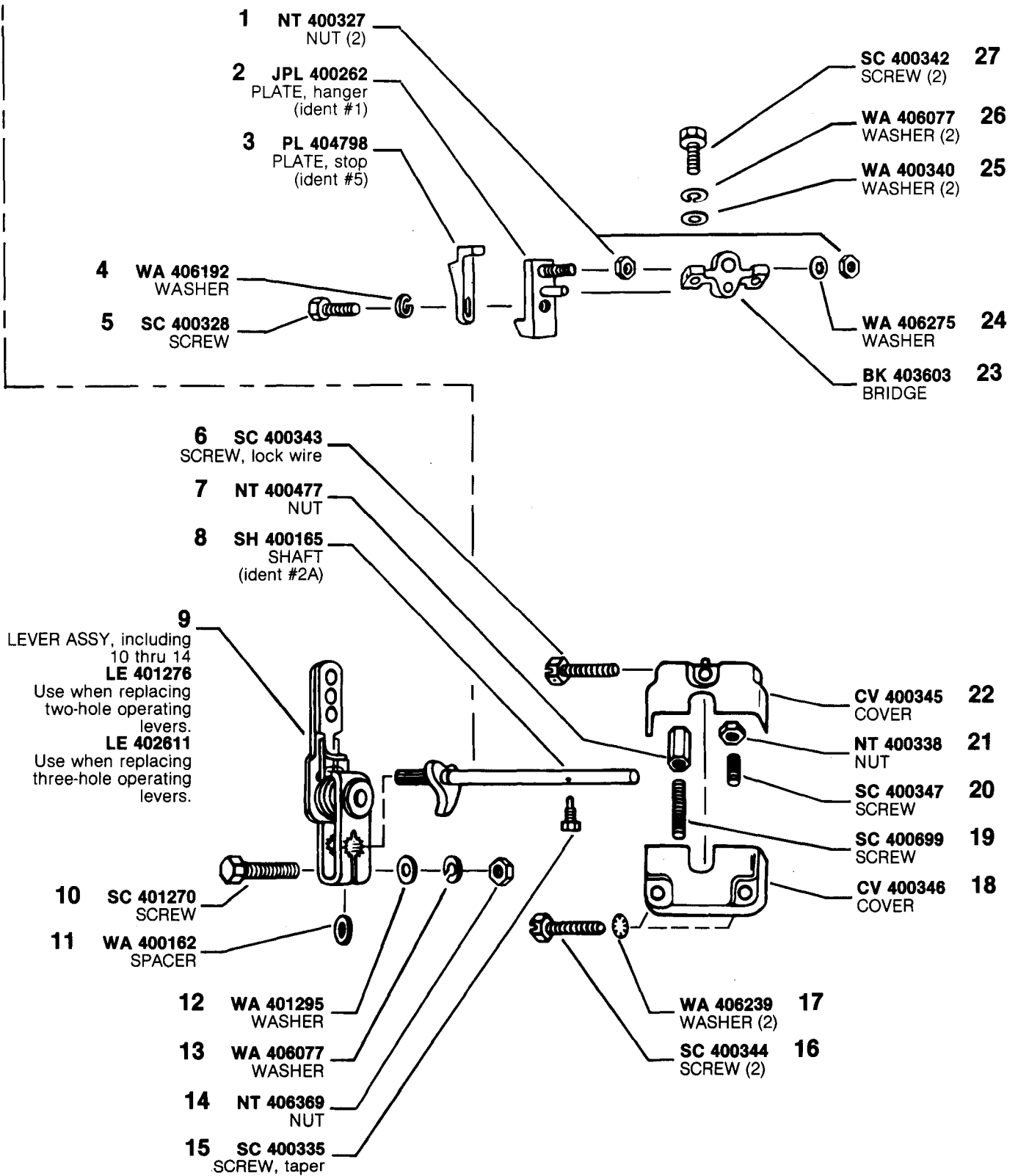

MODEL APE 6BB 110T 6572E

ASSY LE 400782
 LEVER ASSY, fulcrum-
 including 1, 2, 6 thru 8,
 10, 12 & 15 thru 20

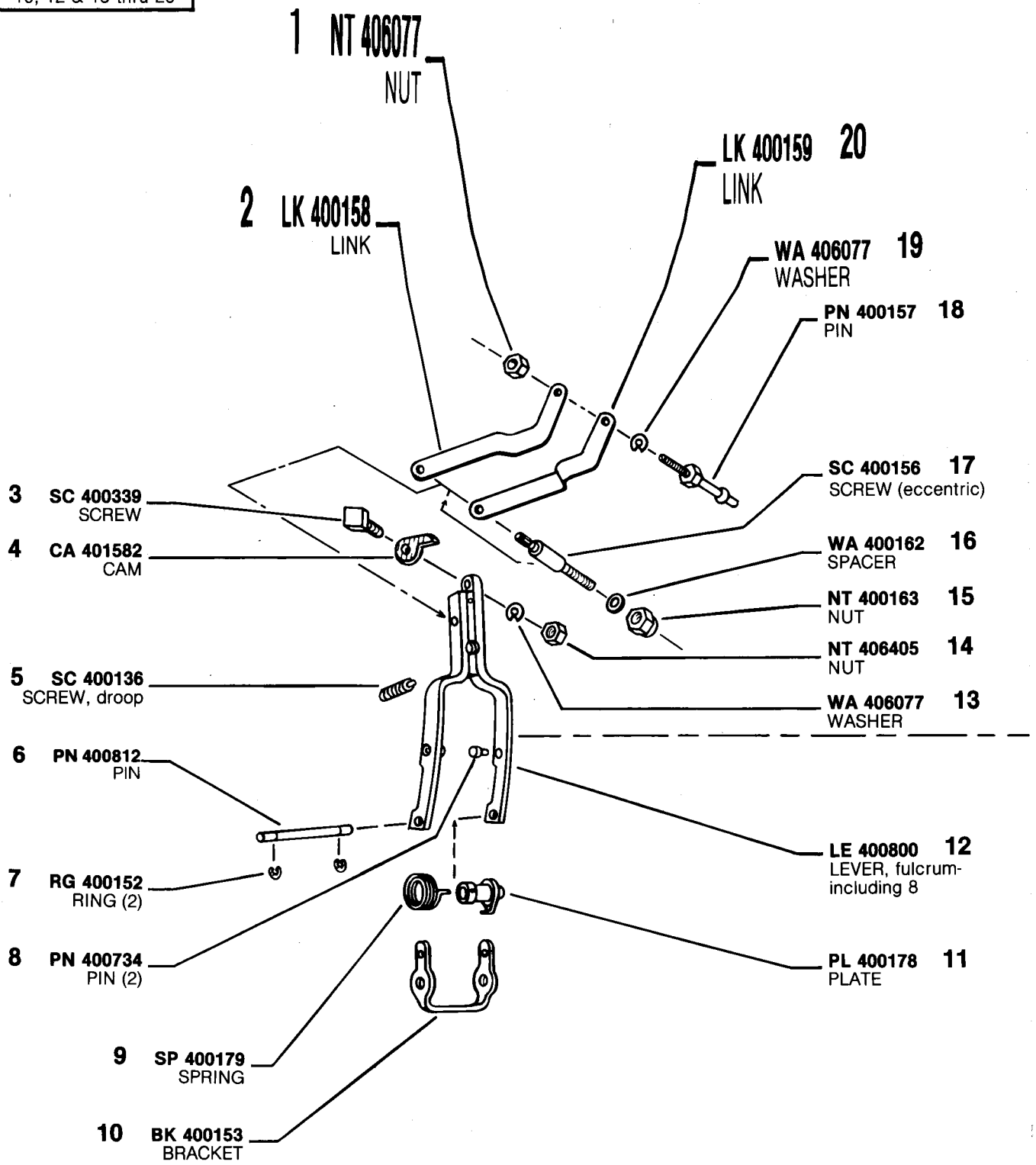

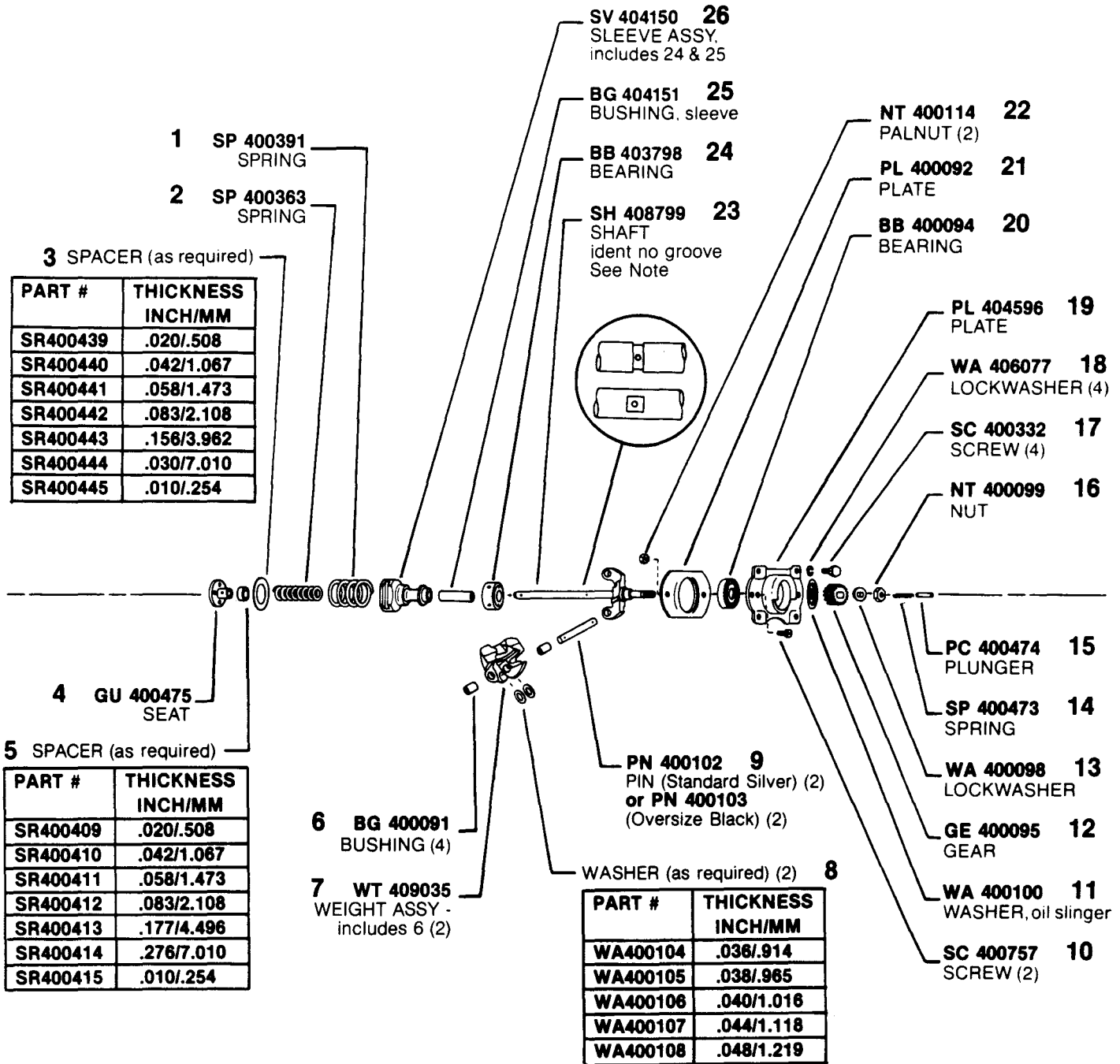

NOTE: When replacing shaft (#23 w/groove) with latest shaft (SH408799 no groove) BG404151 (25) MUST be used. Shaft with groove used BG400118.

MODEL APE 6BB 110T 6572E

ASSY GE 408663
(RUBBER DRIVE)
 DRIVE ASSY, includes
 3 thru 7

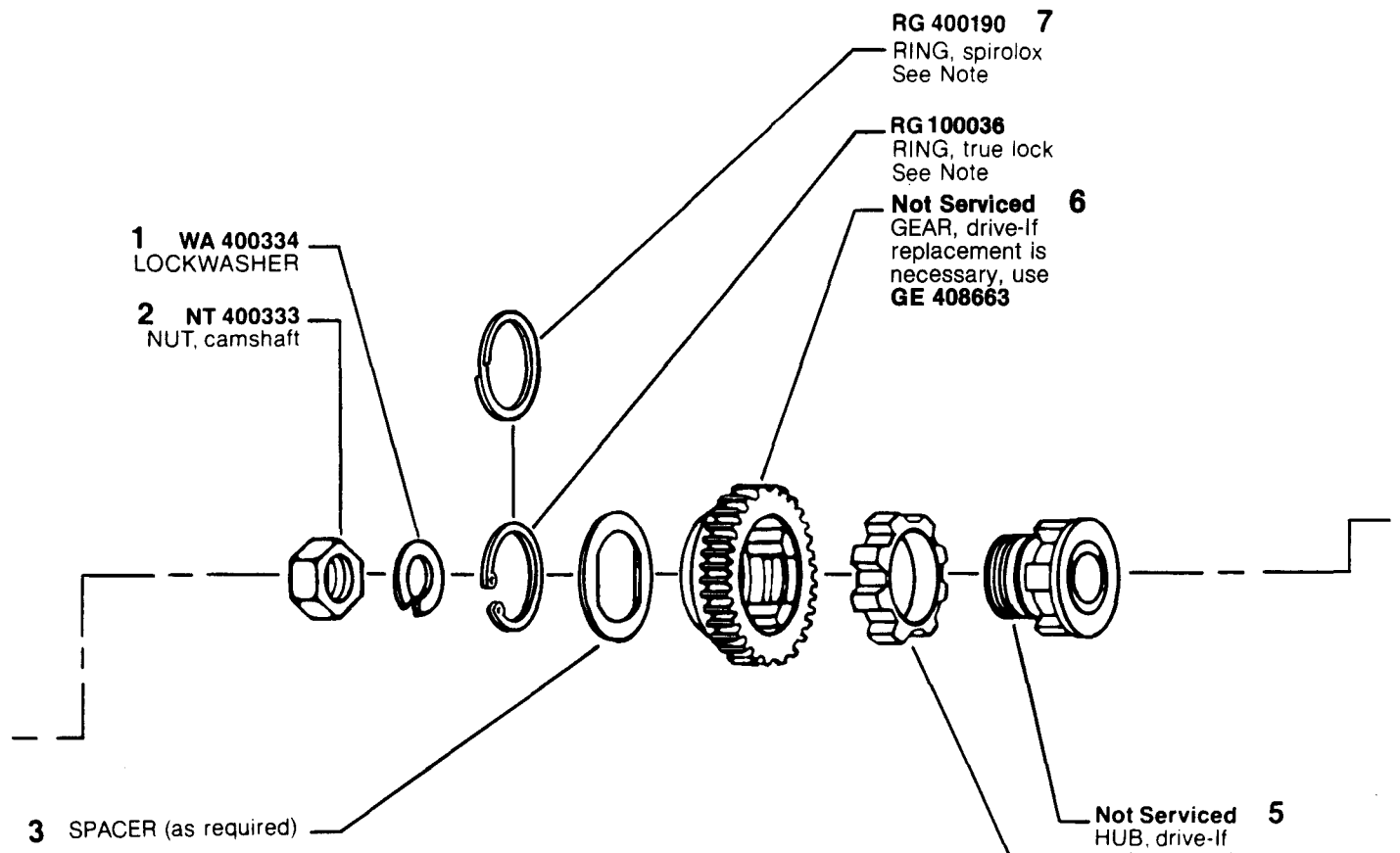

PART #	THICKNESS INCH/MM
SR400191	.065/1.65
SR400192	.070/1.78
SR400193	.075/1.90
SR400194	.080/2.03
SR400195	.085/2.16
SR400196	.0625/1.59
SR400197	.060/1.52
SR400198	.0675/1.71
SR400199	.0725/1.84
SR400200	.0775/1.97
SR400201	.0825/2.10
SR400202	.0875/2.22

#7 NOTE: Earlier rubber drive assy GE 400182 used RG 400190 (Spirolox ring), later assy GE 408663 using RG 100036 (true lock ring). Spirolox & true lock rings are NOT interchangeable.
ASSY NOTE: Pumps equipped with GE 7992A "Friction Clutch" refer to Service Instructions Model 6BBT Parts Bulletin P4 for Parts.

MODEL APE 6BB 110T 6572E

ASSY TP 7651A
TAPPET ASSY-
including 12-17 (6)

ASSY HG 761246-1A
HOUSING ASSY-
including 31; 4 on page
8; and 8 thru 10, 17 &
18 on page 9
See note

3 SPACER (as required)

PART #	THICKNESS INCH/MM
SR 7611-1	.008/0.2
SR 7611-2	.012/0.3
SR 7611-3	.016/0.4
SR 7611-4	.004/0.1
SR 7611-5	.006/0.15
SR 7611-6	.002/0.05
SR 7611-7	.032/0.8

PART #	THICKNESS INCH/MM
SR 7610-1	.050/1.270
SR 7610-2	.054/1.372
SR 7610-3	.058/1.473
SR 7610-4	.062/1.575
SR 7610-5	.066/1.676
SR 7610-6	.046/1.168
SR 7610-7	.048/1.219
SR 7610-8	.052/1.321

PART #	THICKNESS INCH/MM
SR 7610-9	.056/1.422
SR 7610-10	.060/1.524
SR 7610-11	.064/1.626
SR 7610-15	.042/1.067
SR 7610-16	.044/1.118
SR 7610-17	.068/1.727
SR 7610-18	.072/1.829

1 KY 403378
KEY, WOODRUFF
(Earlier Camshafts
require KY 764)

2 SH 404640
CAMSHAFT
See note

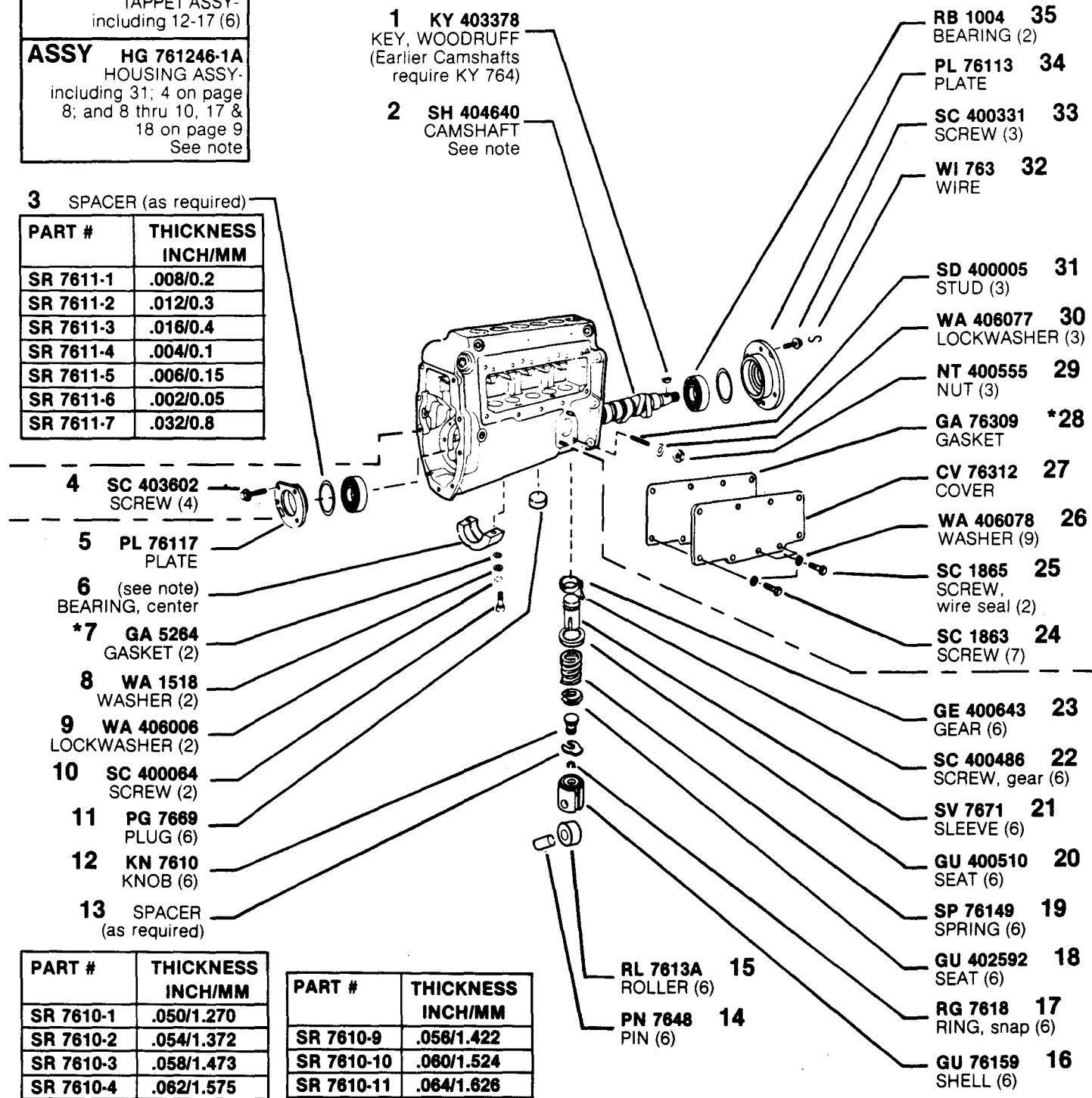

NOTE: Latest pump housings and camshafts do not allow use of center bearing. If bearing is not to be used, refer to note on page 13 (PG 400760 information)

*Denotes parts included in "Pump & Governor Repair Gasket Kit" KT 76399-2.

MODEL APE 6BB 110T 6572E

ASSY VA 400683
 VALVE ASSY, overflow-
 including 11 thru 14

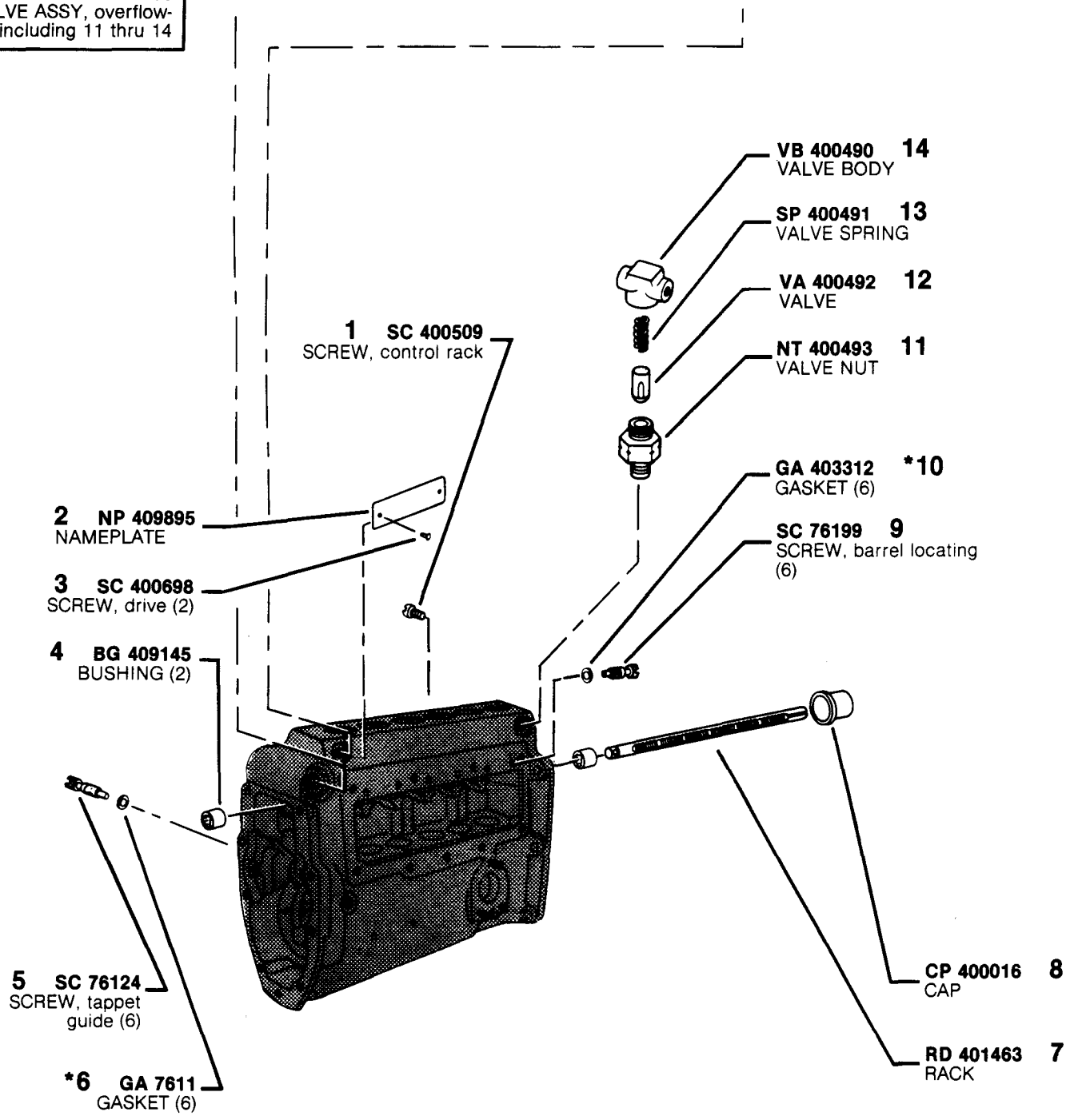

*Denotes parts included in "Pump & Governor Repair Gasket Kit" KT 76399-2.

MODEL APE 6BB 110T 6572E

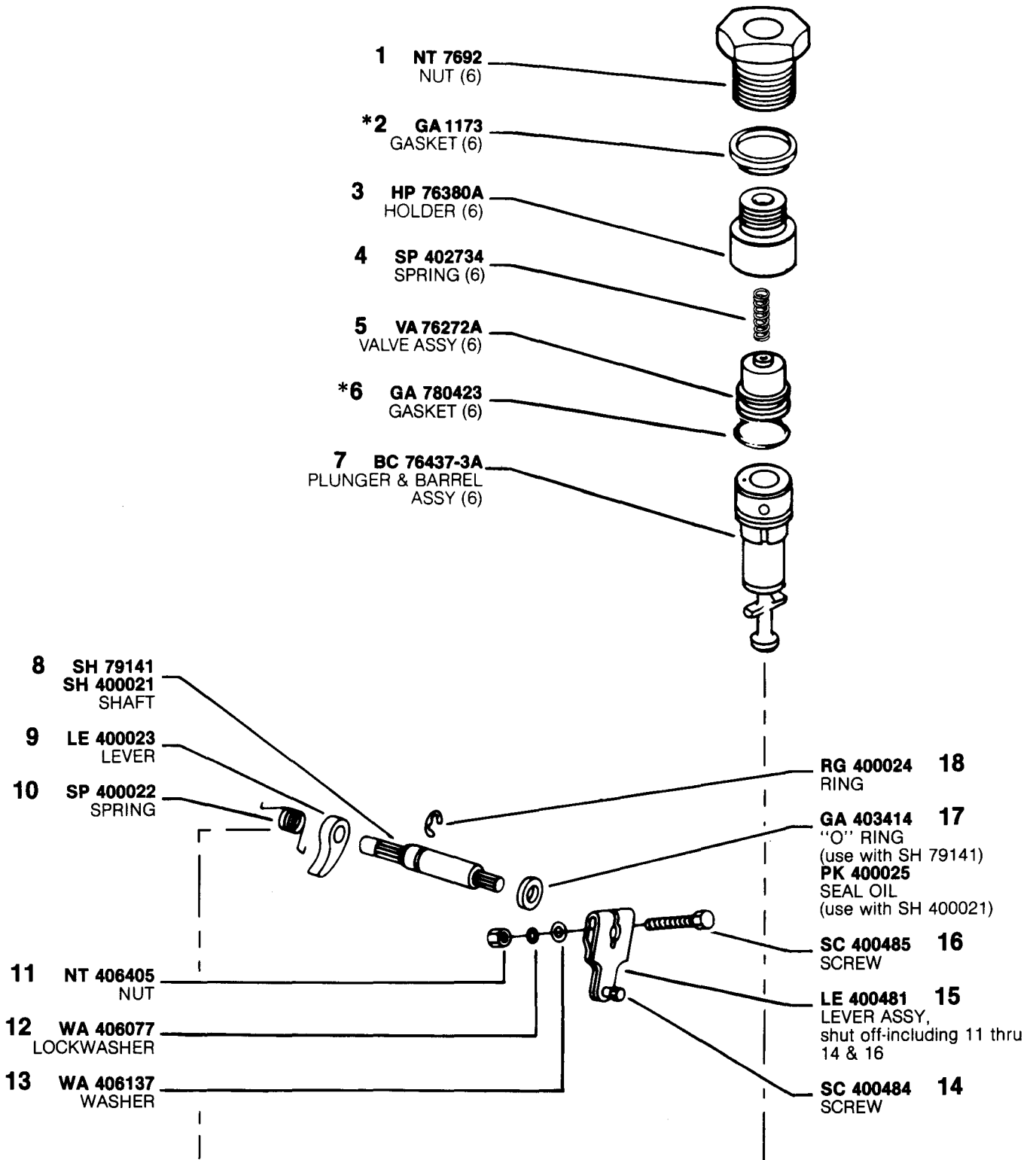

*Denotes parts included in "Pump & Governor Repair Gasket Kit" KT 76399-2.

MODEL APE 6BB 110T 6572E

ASSY SPA 22B2
 PUMP ASSY, supply-
 including 1 thru 9 & 11
 thru 16

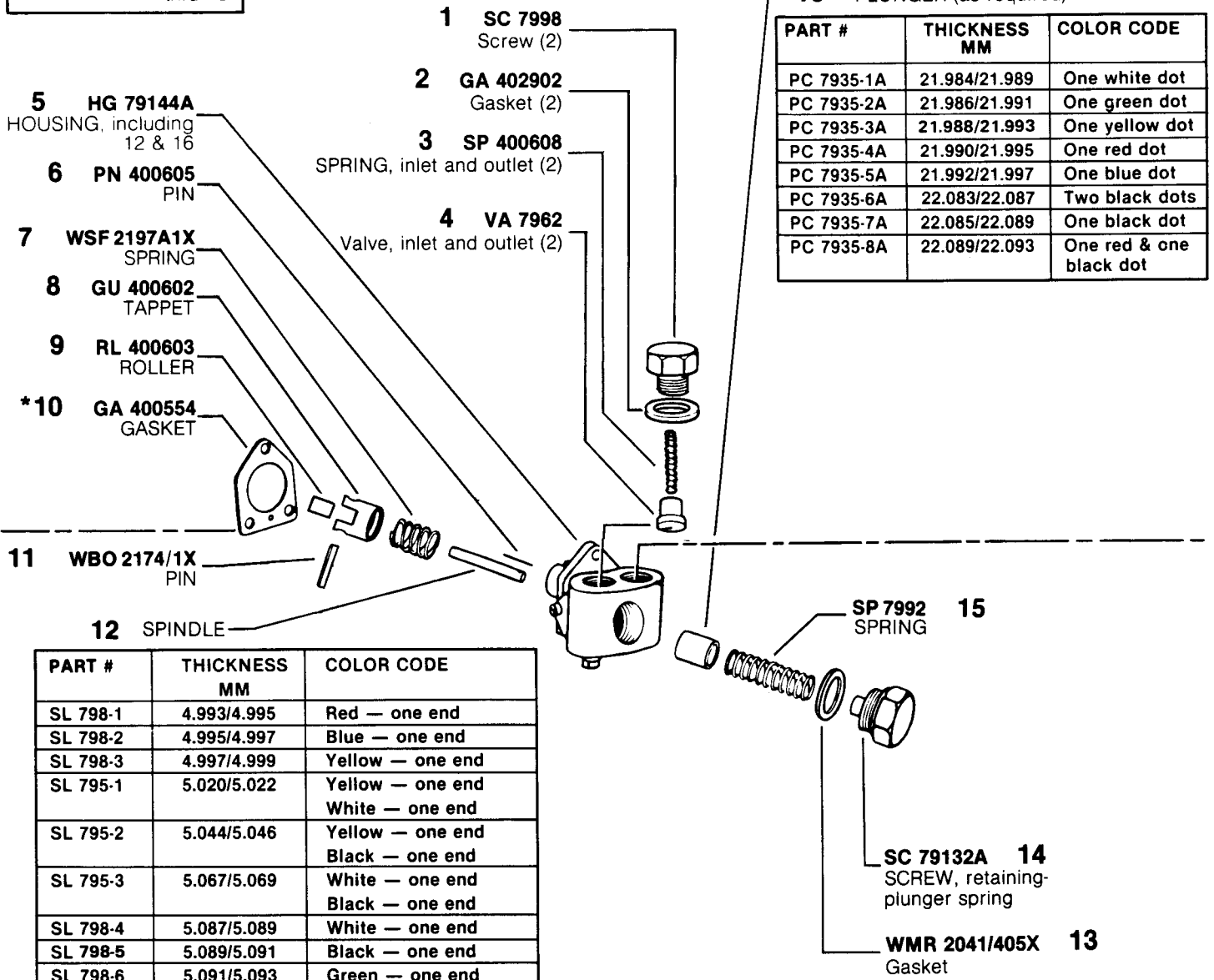

16 PLUNGER (as required)

PART #	THICKNESS MM	COLOR CODE
PC 7935-1A	21.984/21.989	One white dot
PC 7935-2A	21.986/21.991	One green dot
PC 7935-3A	21.988/21.993	One yellow dot
PC 7935-4A	21.990/21.995	One red dot
PC 7935-5A	21.992/21.997	One blue dot
PC 7935-6A	22.083/22.087	Two black dots
PC 7935-7A	22.085/22.089	One black dot
PC 7935-8A	22.089/22.093	One red & one black dot

12 SPINDLE

PART #	THICKNESS MM	COLOR CODE
SL 798-1	4.993/4.995	Red — one end
SL 798-2	4.995/4.997	Blue — one end
SL 798-3	4.997/4.999	Yellow — one end
SL 795-1	5.020/5.022	Yellow — one end White — one end
SL 795-2	5.044/5.046	Yellow — one end Black — one end
SL 795-3	5.067/5.069	White — one end Black — one end
SL 798-4	5.087/5.089	White — one end
SL 798-5	5.089/5.091	Black — one end
SL 798-6	5.091/5.093	Green — one end
SL 798-7	5.093/5.095	Aluminum — one end
SL 795-4	5.116/5.118	Aluminum — one end Red — one end
SL 795-5	5.039/5.141	Aluminum — one end Blue — one end
SL 795-6	5.162/5.164	Aluminum — one end Yellow — one end
SL 798-8	5.189/5.191	Red — both ends
SL 798-9	5.191/5.193	Blue — both ends
SL 798-10	5.193/5.195	Yellow — both ends
SL 798-11	5.195/5.197	Black — both ends

SPINDLE (requires reaming)

PART #	THICKNESS MM	COLOR CODE
SL 793-1	5.557/5.560	Red & Blue — one end
SL 793-2	5.561/5.564	Red & Green — one end
SL 793-3	5.565/5.568	Red & Yellow — one end
SL 793-4	5.569/5.572	Blue & Green — one end

*Denotes parts included in "Pump & Governor Repair Gasket Kit" KT 76399-2.

MODEL APE 6BB 110T 6572E

ASSY MP 404760
MANUAL PRIMER
ASSY, including 3 thru 9
(Optional)

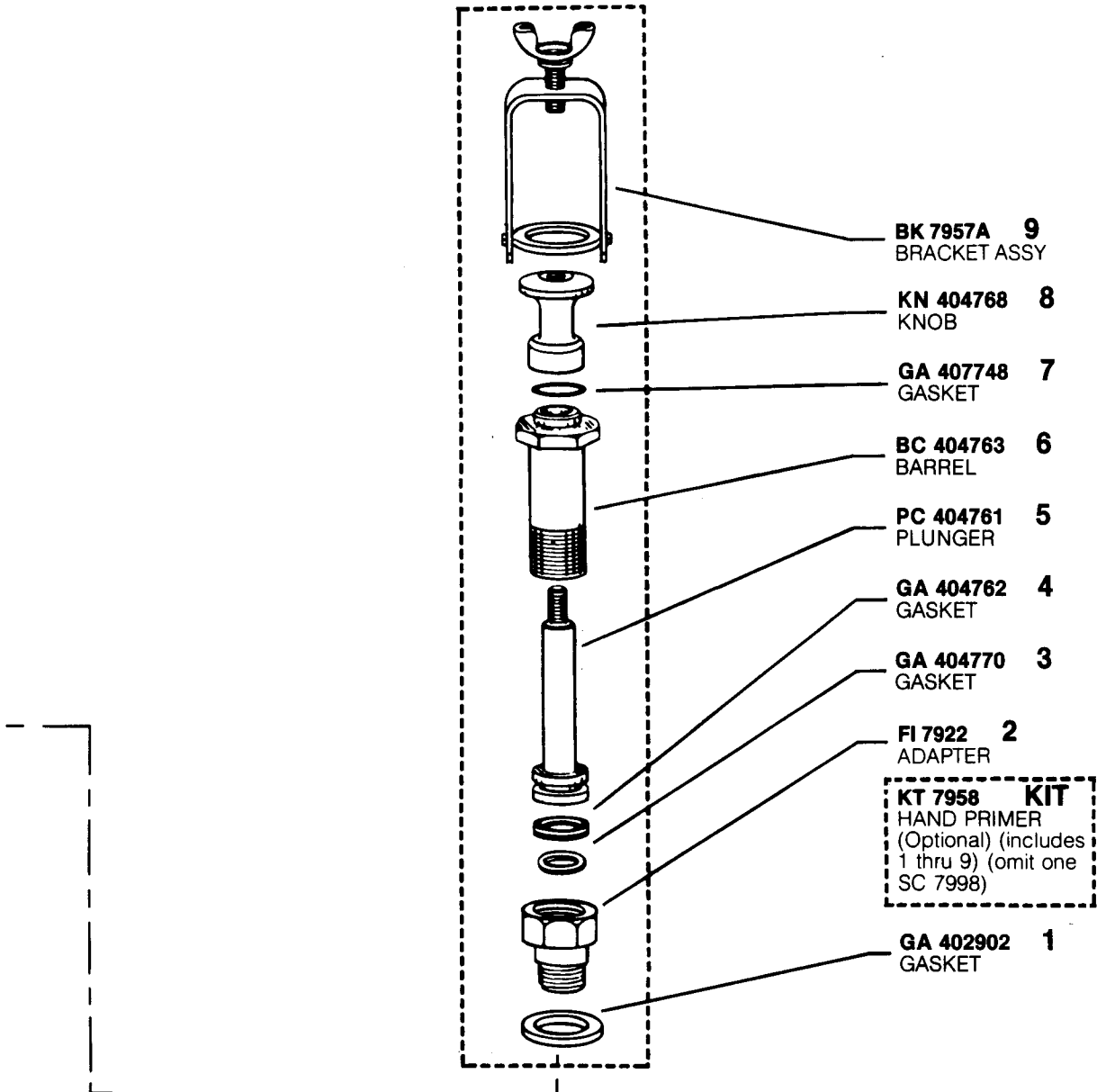

MODEL APE 6BB 110T 6572E

6572E13 DATA

Engine Model ENDT(B)676
 Engine Static Timing 22°
 Customer No. 313 GC 599A-P12
 Governor Speeds 250/900
 Cam Nose Angle 92°-96°

Governor Outer Spring
 Precompression Flush to 0.5mm (.020")
 Governor Inner Spring Gap 3.75-4.00mm (.148"-.157")
 Lift to Port Closing 3.00-3.20mm
 (.118"-.126"), cam lift with control rack at
 1.185" (full load position) extension

STEP	A Full Load at 1.185" Rack Ext	B Cam Departure	C Peak Torque	D Droop Screw
RPM	1000	1090-1100	700	600
DEL cc/500 str	85.5-90.5	NONE	99.0-105.0	109.5-115.5
DEL cc/300 str	51.0-54.5	NONE	59.5-63.0	65.5-69.5

STEP	E "PLE"	F Low Idle	G Minimum Delivery	H Reset Cam Departure
RPM	300	290	75	930-940
DEL cc/500 str	48.0-52.0	12-20	—	NONE
DEL cc/300 str	28.5-31.5	7-12	—	NONE
DEL cc/100 str	—	—	12.0	NONE

SERVICE CHECK — B, A, C, D & H are applicable.

**NOTE ON ELIMINATION OF CENTER BEARING
 IN APE 6BB FUEL INJECTION PUMPS**

INFORMATION:

Latest APE 6BB fuel injection pumps do not incorporate center bearings and accordingly, pump housings and cam shafts are no longer machined to provide for use of the part.

For earlier type APE 6BB pumps, elimination of the center bearing is OPTIONAL.

CAUTION: Prior to assembly of a camshaft and center bearing to a pump, first determine that the bearing can physically be used. Insure that there are holes in the housing for the bearing retaining screws and that the journal between cam lobes #3 and #4 has been machined to accept the part.

If a housing has been machined to accept a center bearing and the bearing is not to be utilized, then the screw holes must be plugged per the following instructions:

INSTRUCTIONS:

Plug center bearing screw holes as follows:

1. Clean out screw hole counterbores.
2. Press plug, PG 400760 into each hole.
3. Seal plug in hole with Devcon F, or an equivalent epoxy.

NOTE: Elimination of the center bearing is only to be undertaken if the initial service problem required removal of the camshaft from the pump.

THIS NOTE SUPERSEDES MODEL 6BBT, SERVICE BULLETIN S7.

MODEL APE 6BB 110T 6572E