

7516

A & B

PUMP ROTATION:
Clockwise: Firing Order: 1-5-3-6-2-4
DRIVE END:
R. H. Side
TIMED FOR PORT CLOSING
SPECIAL FEATURES:
"Dual Speed"

MACK
APE 6BB 110T 7516A & B



SERVICE PARTS

Following are all parts, part numbers, pump codes and calibrations for the *Model: APE 6BB 110T 7516A & B*. The exploded view drawing below is detailed with part numbers

listed on the pages indicated. Refer to the Index Section for explanations of codes and abbreviations.

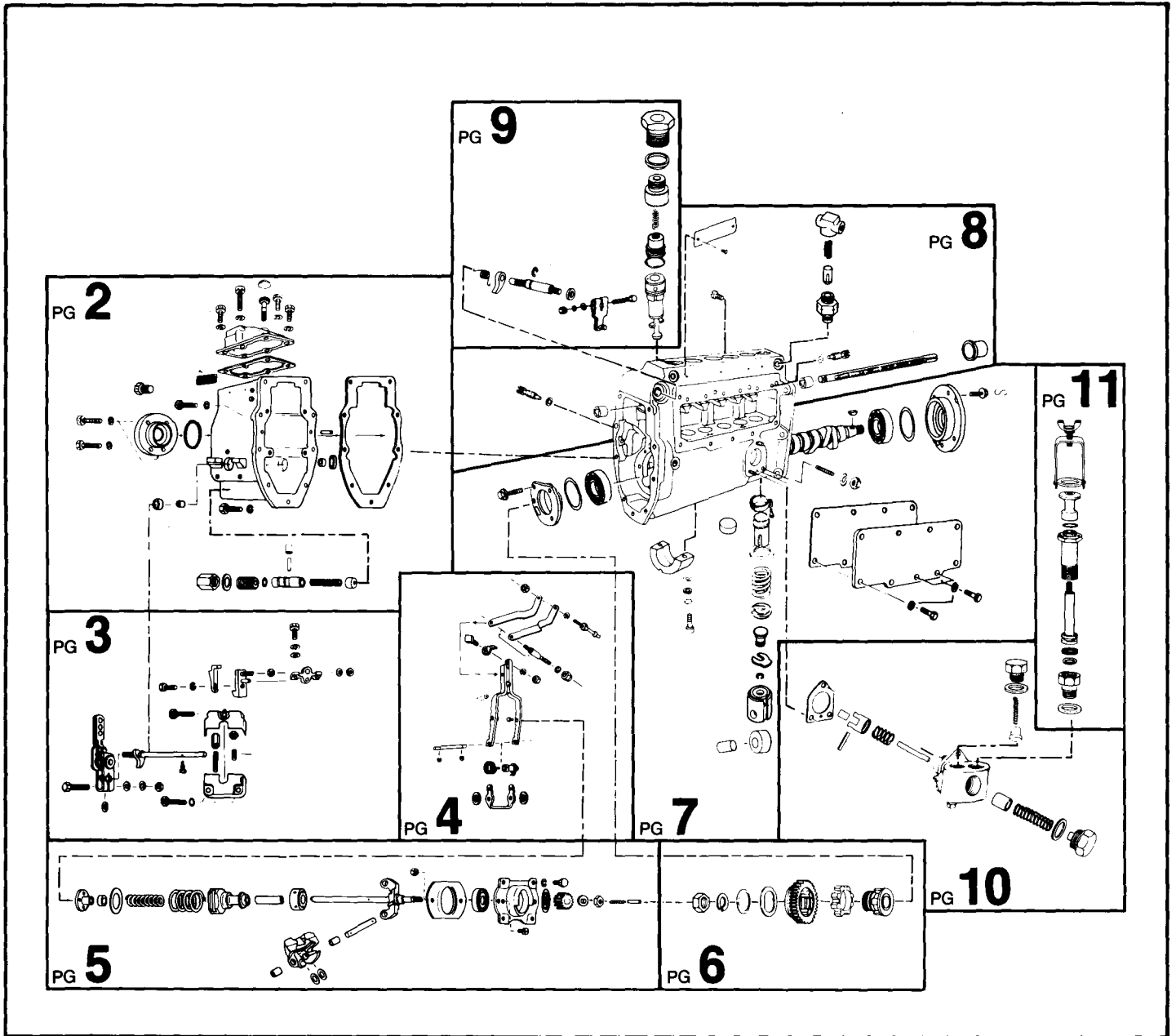

MODEL APE 6BB 110T 7516A & B

ASSY GVB/E 7517
GOVERNOR ASSY

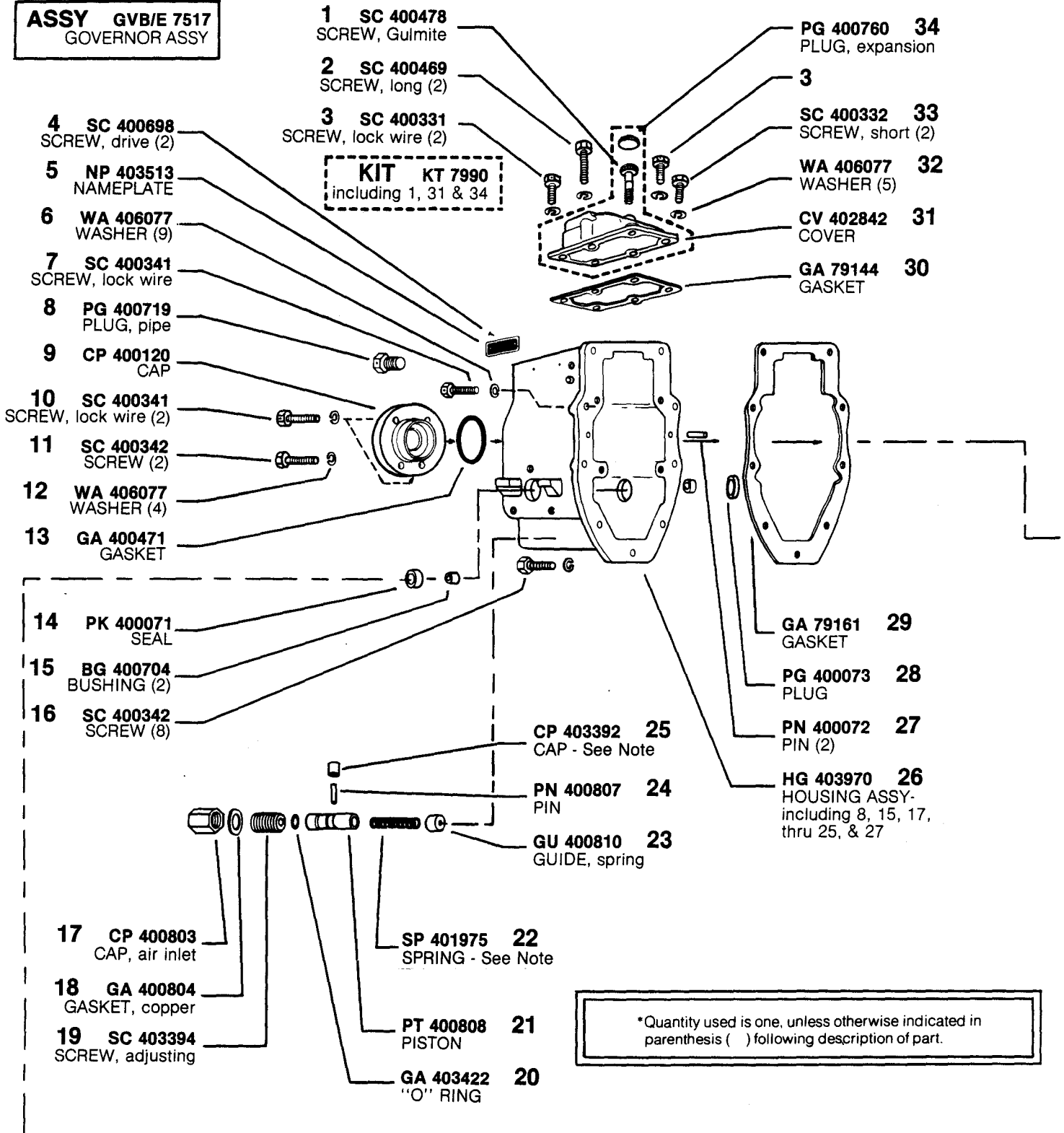

Note: Governor should be updated to GVB/E-7517B by replacing spring, #22, adding cap, #9 and replacing operating shaft set screw, #15 on page 3, with parts called for in parts list.

MODEL APE 6BB 110T 7516A&B

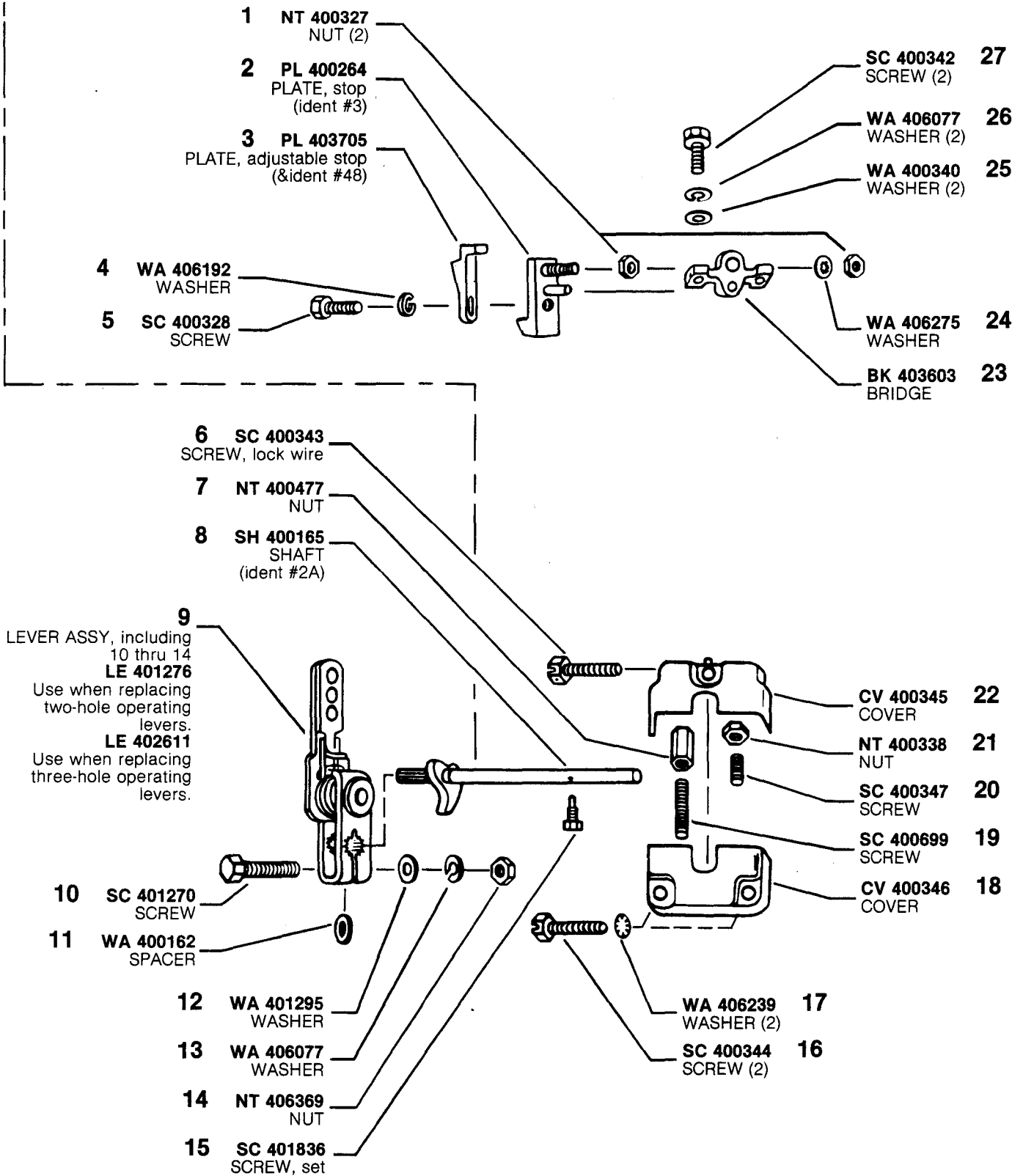

MODEL APE 6BB 110T 7516A&B

ASSY LE 400782
LEVER ASSY, fulcrum-
including 1, 2, 6 thru 8,
10, 12 & 15 thru 20

ASSY PL 400177
PLATE ASSY, including
9 & 11

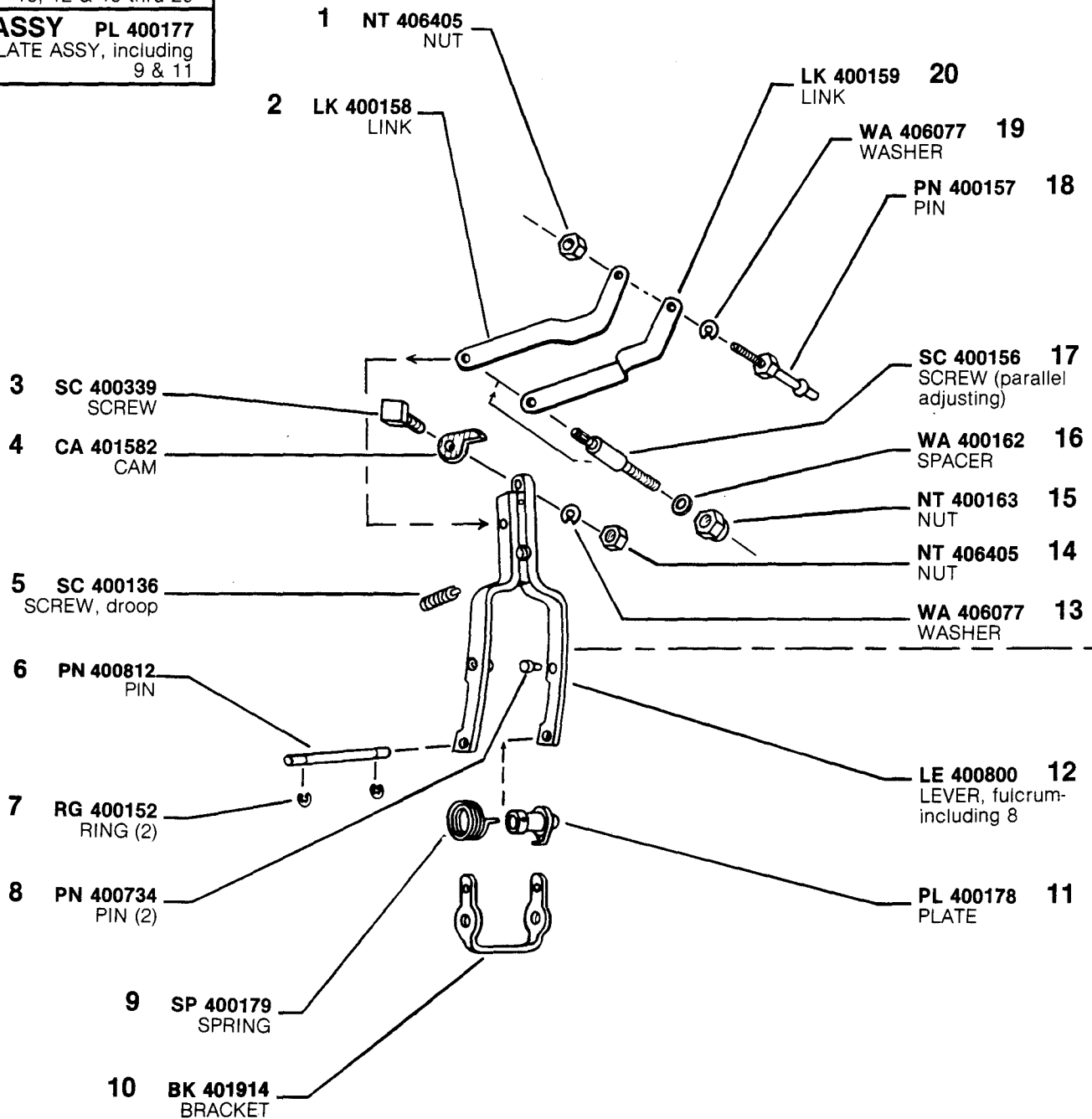

MODEL APE 6BB 110T 7516A&B

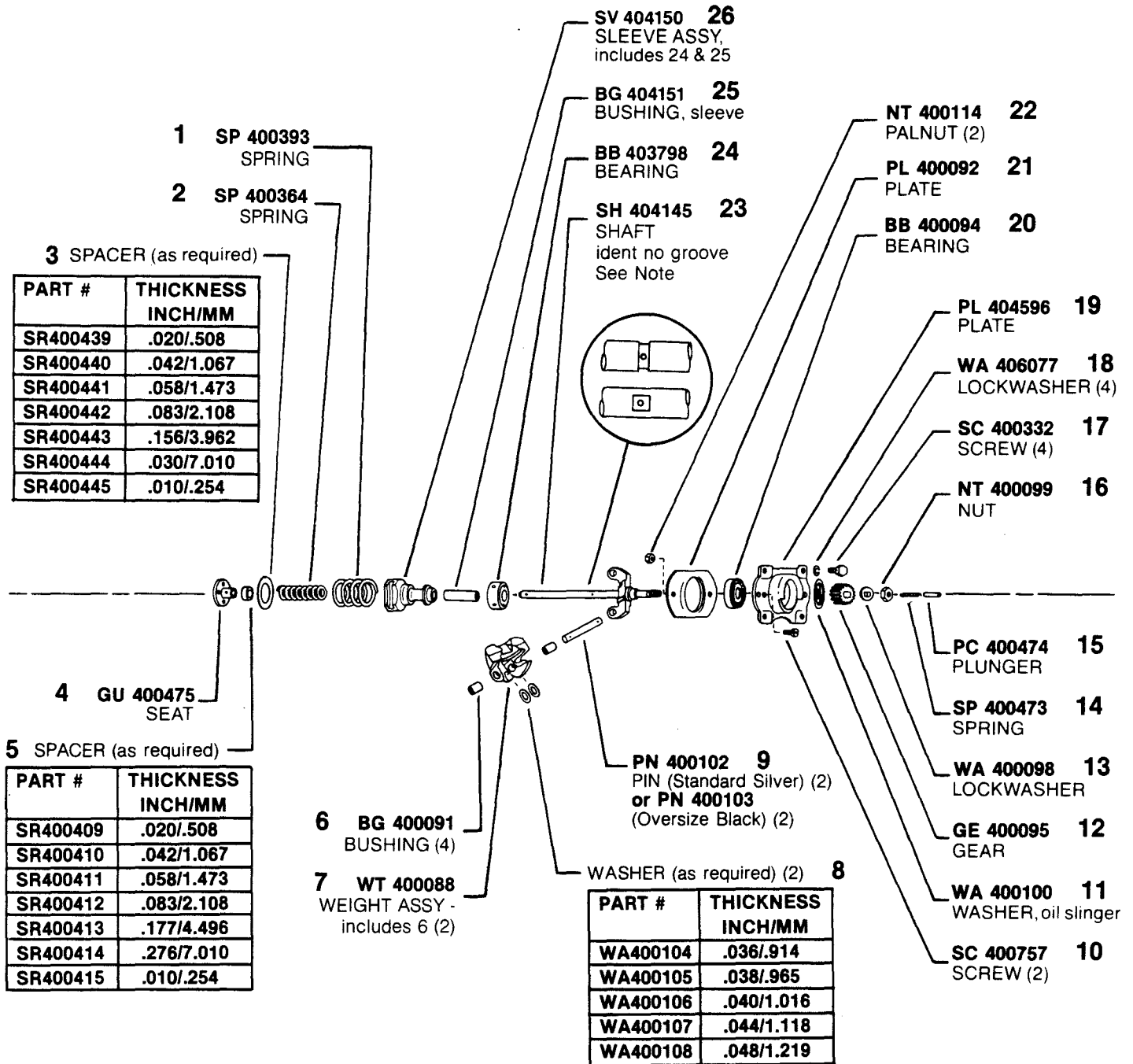

NOTE: When replacing shaft (#23 w/groove) with latest shaft (SH404145 no groove) BG404151 (25) MUST be used. Shaft with groove used BG400118.

MODEL APE 6BB 110T 7516A&B

ASSY GE 408663
(RUBBER DRIVE)
DRIVE ASSY, includes
3 thru 7

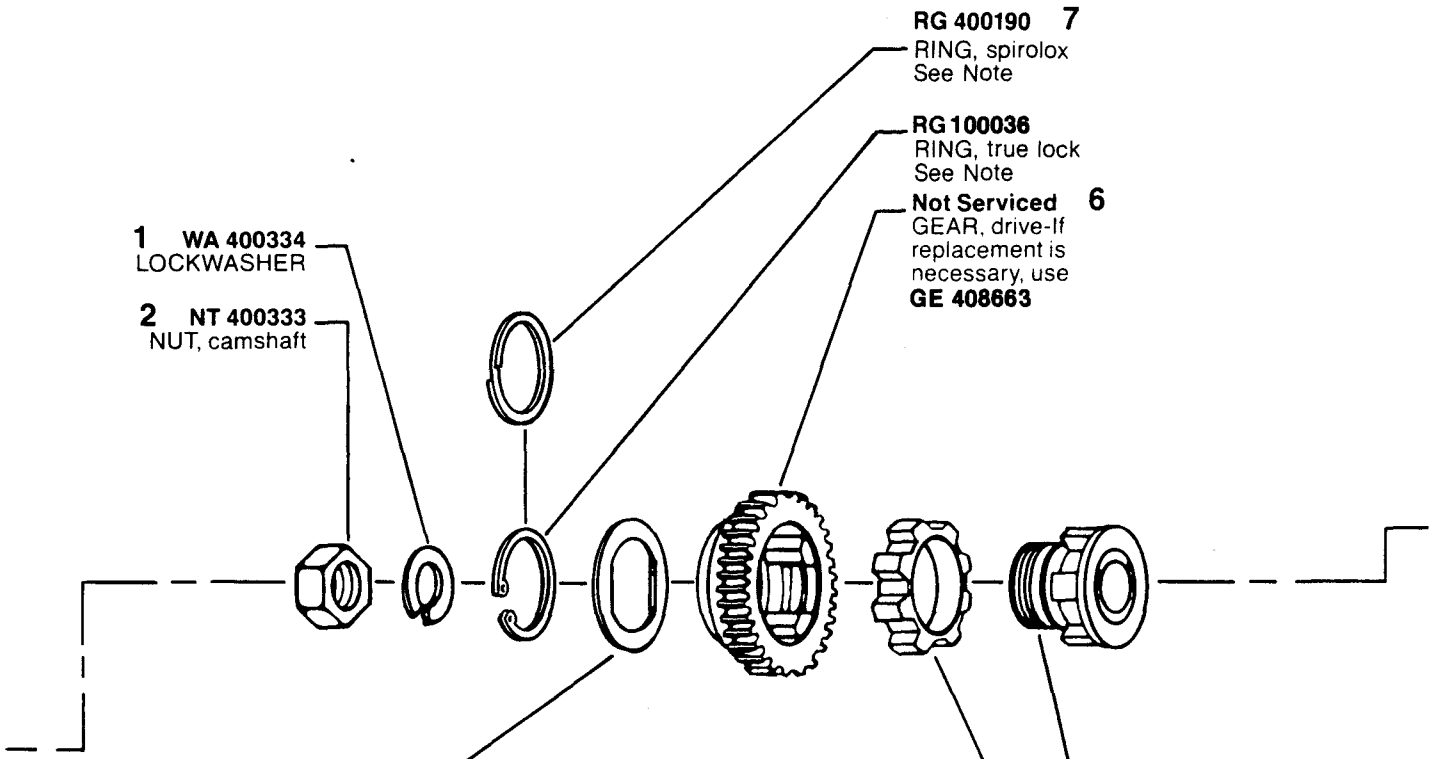

1 WA 400334
LOCKWASHER

2 NT 400333
NUT, camshaft

RG 400190 7
RING, spirolox
See Note

RG 100036
RING, true lock
See Note

Not Serviced 6
GEAR, drive-If
replacement is
necessary, use
GE 408663

3 SPACER (as required)

PART #	THICKNESS INCH/MM
SR400191	.065/1.65
SR400192	.070/1.78
SR400193	.075/1.90
SR400194	.080/2.03
SR400195	.085/2.16
SR400196	.0625/1.59
SR400197	.060/1.52
SR400198	.0675/1.71
SR400199	.0725/1.84
SR400200	.0775/1.97
SR400201	.0825/2.10
SR400202	.0875/2.22

Not Serviced 5
HUB, drive-If
replacement is
necessary, use
GE 408663

IT 400189 4
INSERT, drive

#7 NOTE: Earlier rubber drive assy GE 400182 used RG 400190 (Spirolox ring), later assy GE 408663 using RG 100036 (true lock ring). Spirolox & true lock rings are NOT interchangeable.

ASSY NOTE: Pumps equipped with GE 7992A "Friction Clutch" refer to Service Instructions Model 6BBT Parts Bulletin P4 for Parts.

MODEL APE 6BB 110T 7516A&B

ASSY TP 7651A
TAPPET ASSY-
including 12-17 (6)

ASSY HG 761246-1A
HOUSING ASSY-
including 31; 4 on page
8; and 8 thru 10, 17 &
18 on page 9
See note

1 KY 403378
KEY, WOODRUFF
(Earlier Camshafts
require KY 764)

2 SH 76121
CAMSHAFT
See note

3 SPACER (as required)

PART #	THICKNESS INCH/MM
SR 7611-1	.008/0.2
SR 7611-2	.012/0.3
SR 7611-3	.016/0.4
SR 7611-4	.004/0.1
SR 7611-5	.006/0.15
SR 7611-6	.002/0.05
SR 7611-7	.032/0.8

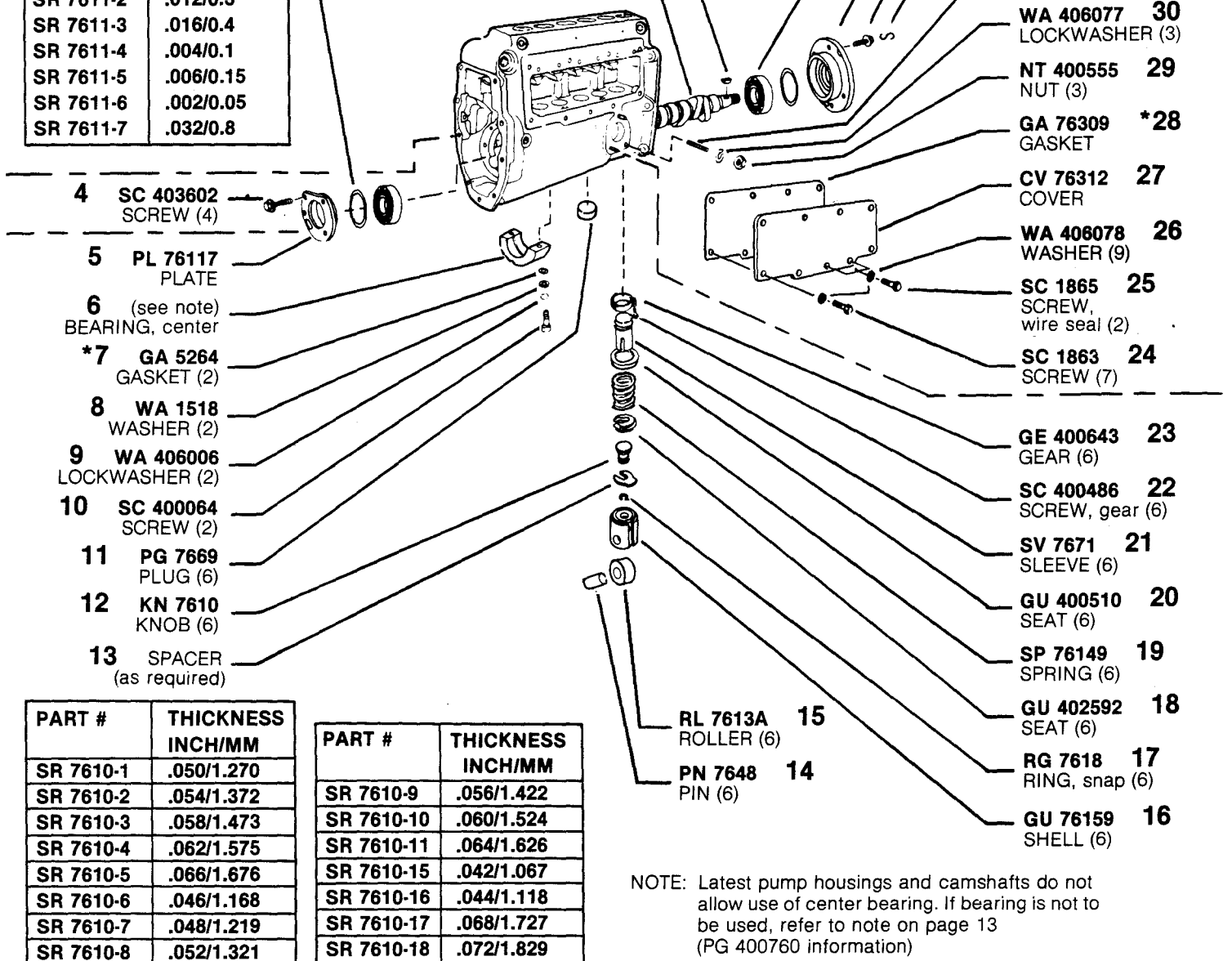

4 SC 403602
SCREW (4)

5 PL 76117
PLATE

6 (see note)
BEARING, center

***7 GA 5264**
GASKET (2)

8 WA 1518
WASHER (2)

9 WA 406006
LOCKWASHER (2)

10 SC 400064
SCREW (2)

11 PG 7669
PLUG (6)

12 KN 7610
KNOB (6)

13 SPACER
(as required)

RB 1004 35
BEARING (2)

PL 76113 34
PLATE

SC 400331 33
SCREW (3)

WI 763 32
WIRE

SD 400005 31
STUD (3)

WA 406077 30
LOCKWASHER (3)

NT 400555 29
NUT (3)

GA 76309 *28
GASKET

CV 76312 27
COVER

WA 406078 26
WASHER (9)

SC 1865 25
SCREW,
wire seal (2)

SC 1863 24
SCREW (7)

GE 400643 23
GEAR (6)

SC 400486 22
SCREW, gear (6)

SV 7671 21
SLEEVE (6)

GU 400510 20
SEAT (6)

SP 76149 19
SPRING (6)

GU 402592 18
SEAT (6)

RG 7618 17
RING, snap (6)

GU 76159 16
SHELL (6)

RL 7613A 15
ROLLER (6)

PN 7648 14
PIN (6)

PART #	THICKNESS INCH/MM
SR 7610-1	.050/1.270
SR 7610-2	.054/1.372
SR 7610-3	.058/1.473
SR 7610-4	.062/1.575
SR 7610-5	.066/1.676
SR 7610-6	.046/1.168
SR 7610-7	.048/1.219
SR 7610-8	.052/1.321

PART #	THICKNESS INCH/MM
SR 7610-9	.056/1.422
SR 7610-10	.060/1.524
SR 7610-11	.064/1.626
SR 7610-15	.042/1.067
SR 7610-16	.044/1.118
SR 7610-17	.068/1.727
SR 7610-18	.072/1.829

NOTE: Latest pump housings and camshafts do not allow use of center bearing. If bearing is not to be used, refer to note on page 13 (PG 400760 information)

MODEL APE 6BB 110T 7516A&B

*Denotes parts included in "Pump & Governor Repair Gasket Kit" KT 76399-2.

ASSY VA 400683
VALVE ASSY, overflow-
including 11 thru 14

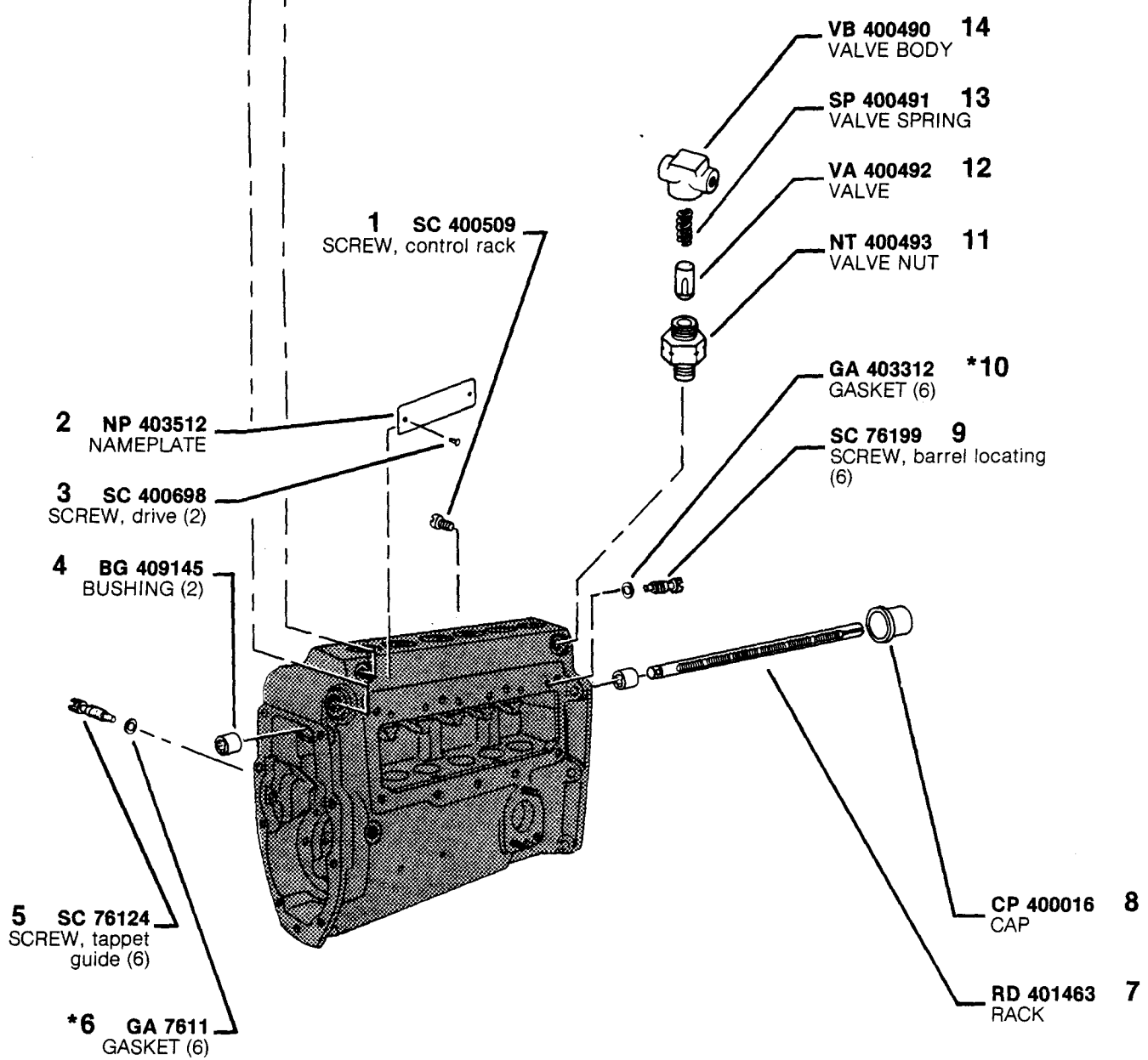

*Denotes parts included in "Pump & Governor Repair Gasket Kit" KT 76399-2.

MODEL APE 6BB 110T 7516A&B

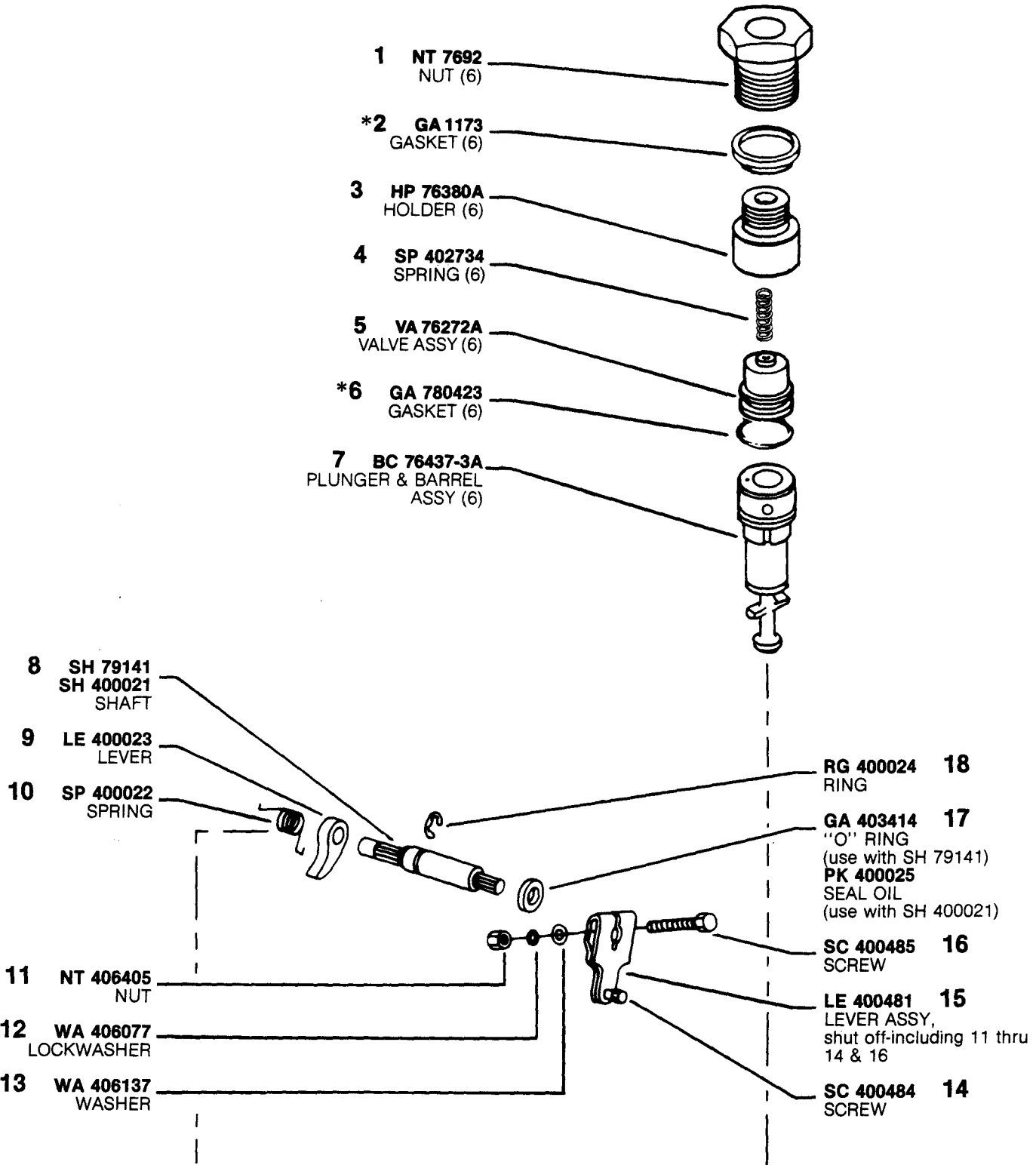

*Denotes parts included in "Pump & Governor Repair Gasket Kit" KT 76399-2.

MODEL APE 6BB 110T 7516A&B

ASSY SPA 22B2
 PUMP ASSY, supply-
 including 1 thru 9 & 11
 thru 16

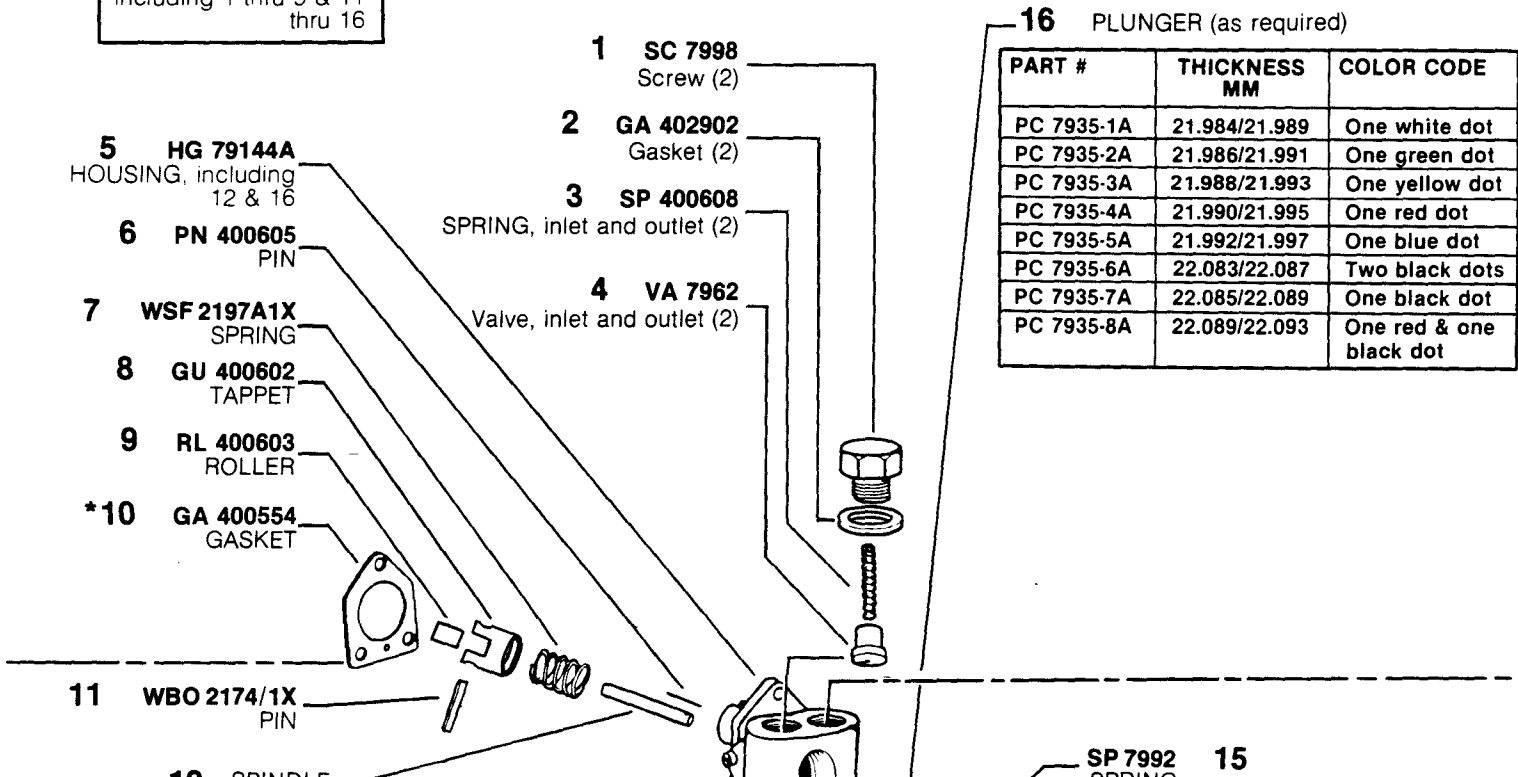

PART #	THICKNESS MM	COLOR CODE
PC 7935-1A	21.984/21.989	One white dot
PC 7935-2A	21.986/21.991	One green dot
PC 7935-3A	21.988/21.993	One yellow dot
PC 7935-4A	21.990/21.995	One red dot
PC 7935-5A	21.992/21.997	One blue dot
PC 7935-6A	22.083/22.087	Two black dots
PC 7935-7A	22.085/22.089	One black dot
PC 7935-8A	22.089/22.093	One red & one black dot

PART #	THICKNESS MM	COLOR CODE
SL 798-1	4.993/4.995	Red — one end
SL 798-2	4.995/4.997	Blue — one end
SL 798-3	4.997/4.999	Yellow — one end
SL 795-1	5.020/5.022	Yellow — one end White — one end
SL 795-2	5.044/5.046	Yellow — one end Black — one end
SL 795-3	5.067/5.069	White — one end Black — one end
SL 798-4	5.087/5.089	White — one end
SL 798-5	5.089/5.091	Black — one end
SL 798-6	5.091/5.093	Green — one end
SL 798-7	5.093/5.095	Aluminum — one end
SL 795-4	5.116/5.118	Aluminum — one end Red — one end
SL 795-5	5.039/5.141	Aluminum — one end Blue — one end
SL 795-6	5.162/5.164	Aluminum — one end Yellow — one end
SL 798-8	5.189/5.191	Red — both ends
SL 798-9	5.191/5.193	Blue — both ends
SL 798-10	5.193/5.195	Yellow — both end
SL 798-11	5.195/5.197	Black — both ends

SPINDLE (requires reaming)

PART #	THICKNESS MM	COLOR CODE
SL 793-1	5.557/5.560	Red & Blue — one end
SL 793-2	5.561/5.564	Red & Green — one end
SL 793-3	5.565/5.568	Red & Yellow — one end
SL 793-4	5.569/5.572	Blue & Green — one end

MODEL APE 6BB 110T 7516A&B

*Denotes parts included in "Pump & Governor Repair Gasket Kit" KT 76399-2.

ASSY MP 404760
MANUAL PRIMER
ASSY, including 3 thru 9
(Optional)

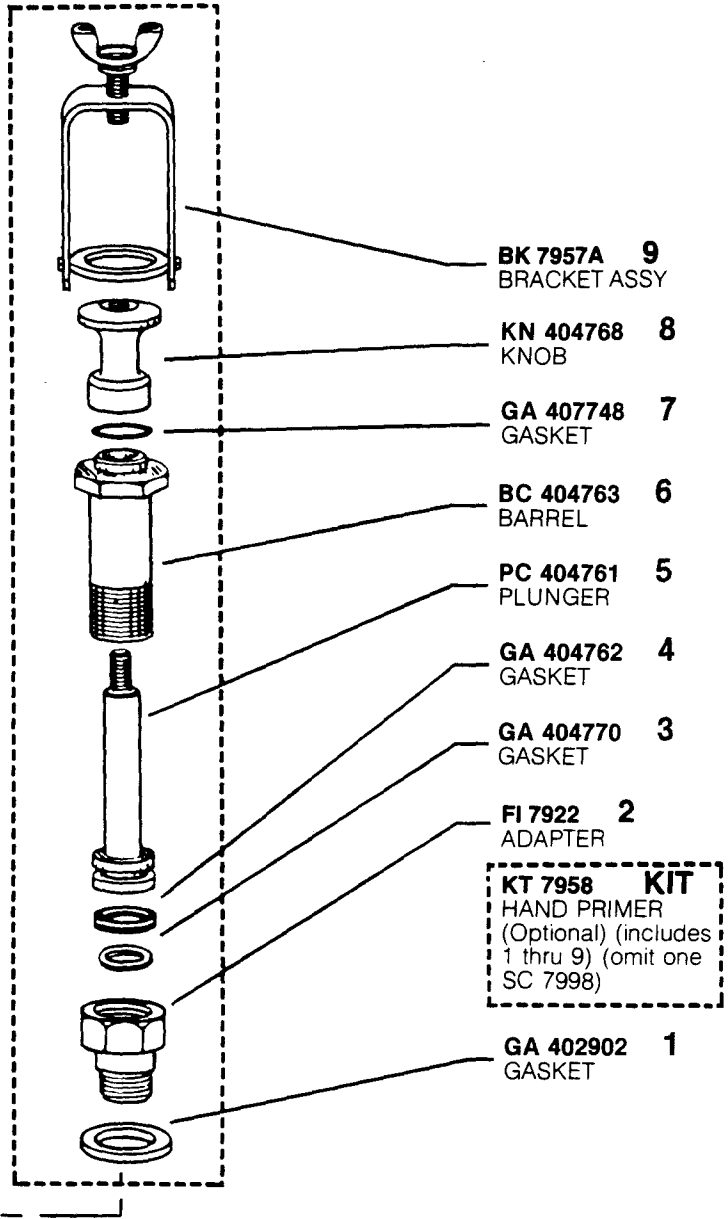

- BK 7957A 9**
BRACKET ASSY
- KN 404768 8**
KNOB
- GA 407748 7**
GASKET
- BC 404763 6**
BARREL
- PC 404761 5**
PLUNGER
- GA 404762 4**
GASKET
- GA 404770 3**
GASKET
- FI 7922 2**
ADAPTER
- GA 402902 1**
GASKET

KT 7958 KIT
HAND PRIMER
(Optional) (includes
1 thru 9) (omit one
SC 7998)

MODEL APE 6BB 110T 7516A&B

CALIBRATION SET-UP

Engine Holders HNS 780050
Opening Pressure 4200-4350 psi
 Engine Nozzles NBM770000
 Engine Nozzle & Holder Assy Ref. #NHM 780001
 High Pressure Tubing 1/4"OD x .067"ID
 x 39" Long

Calibrating Oil **Viscor 4487C @ 100°-105°F**
 (38°-41°C) at pump inlet
 Lube Oil SAE #20 or #30 at 20 psi/1.4 bar
 Air Pressure 70-90 psi to air inlet cap.
PROCEDURE Refer to Service Instructions
 and use figures below

7516A&B CODE 1 DATA

Engine Model EM6-275
 Engine Static Timing 25°
 Customer No. 313GC5152-P12
 Governor Speeds 250/1050
 Cam Nose Angle 88°-92°

Governor Outer Spring
 Precompression Flush to 0.5mm (.020")
 Governor Inner Spring Gap .3.75-4.00mm (.148".157")
 Lift to Port Closing 3.00-3.20mm
 (.118"-.126"), cam lift with control rack at
 approximate mid-travel position

STEP	A	B	C	D
	Full Load at 1.150" Rack Ext	Cam Departure	Peak Torque (from actual A delivery)	Droop Screw (from actual A delivery)
RPM	1050	1080	700	630
DEL cc/500 str	78.0-82.0	NONE	+ 18.5 ± 2.5	+ 24.5 ± 2.5
DEL cc/300 str	47.0-49.0	NONE	+ 11.0 ± 1.5	+ 14.7 ± 1.5

STEP	E	F	G	H
	"PLE"	Low Idle	Minimum Delivery	"Dual Speed" Cam Departure
RPM	800	300	75	815
DEL cc/500 str	59.0-63.0	12-14	—	NONE
DEL cc/300 str	35.5-38.0	7.0-8.5	—	NONE
DEL cc/100 str	—	—	12.0	NONE

SERVICE CHECK — A, C & D are applicable.

NOTE ON ELIMINATION OF CENTER BEARING IN APE 6BB FUEL INJECTION PUMPS

INFORMATION:

Latest APE 6BB fuel injection pumps do not incorporate center bearings and accordingly, pump housings and cam shafts are no longer machined to provide for use of the part.

For earlier type APE 6BB pumps, elimination of the center bearing is **OPTIONAL**.

CAUTION: Prior to assembly of a camshaft and center bearing to a pump, first determine that the bearing can physically be used. Insure that there are holes in the housing for the bearing retaining screws and that the journal between cam lobes #3 and #4 has been machined to accept the part.

If a housing has been machined to accept a center bearing and the bearing is not to be utilized, then the screw holes must be plugged per the following instructions:

INSTRUCTIONS:

Plug center bearing screw holes as follows:

1. Clean out screw hole counterbores.
2. Press plug, PG 400760 into each hole.
3. Seal plug in hole with Devcon F, or an equivalent epoxy.

NOTE: Elimination of the center bearing is only to be undertaken if the initial service problem required removal of the camshaft from the pump.

THIS NOTE SUPERCEEDS MODEL 6BBT, SERVICE BULLETIN S7.

MODEL APE 6BB 110T 7516A&B