

9164

A



**UNITED
TECHNOLOGIES
DIESEL SYSTEMS**

PUMP ROTATION:
Clockwise
FIRING ORDER:
1-5-3-6-2-4
MOUNTING:
L.H.
SPECIAL FEATURES:
Low Idle Screw Capsule

**INTERNATIONAL HARVESTER
100 6A 100A 9164**

Special Information:

SERVICE PARTS

Following are all parts, part numbers, pump codes and calibrations for the *Model: 100 6A 100A 9164*. The exploded view drawing below is detailed with part

numbers listed on the pages indicated. Refer to the Index Section for explanations of codes and abbreviations.

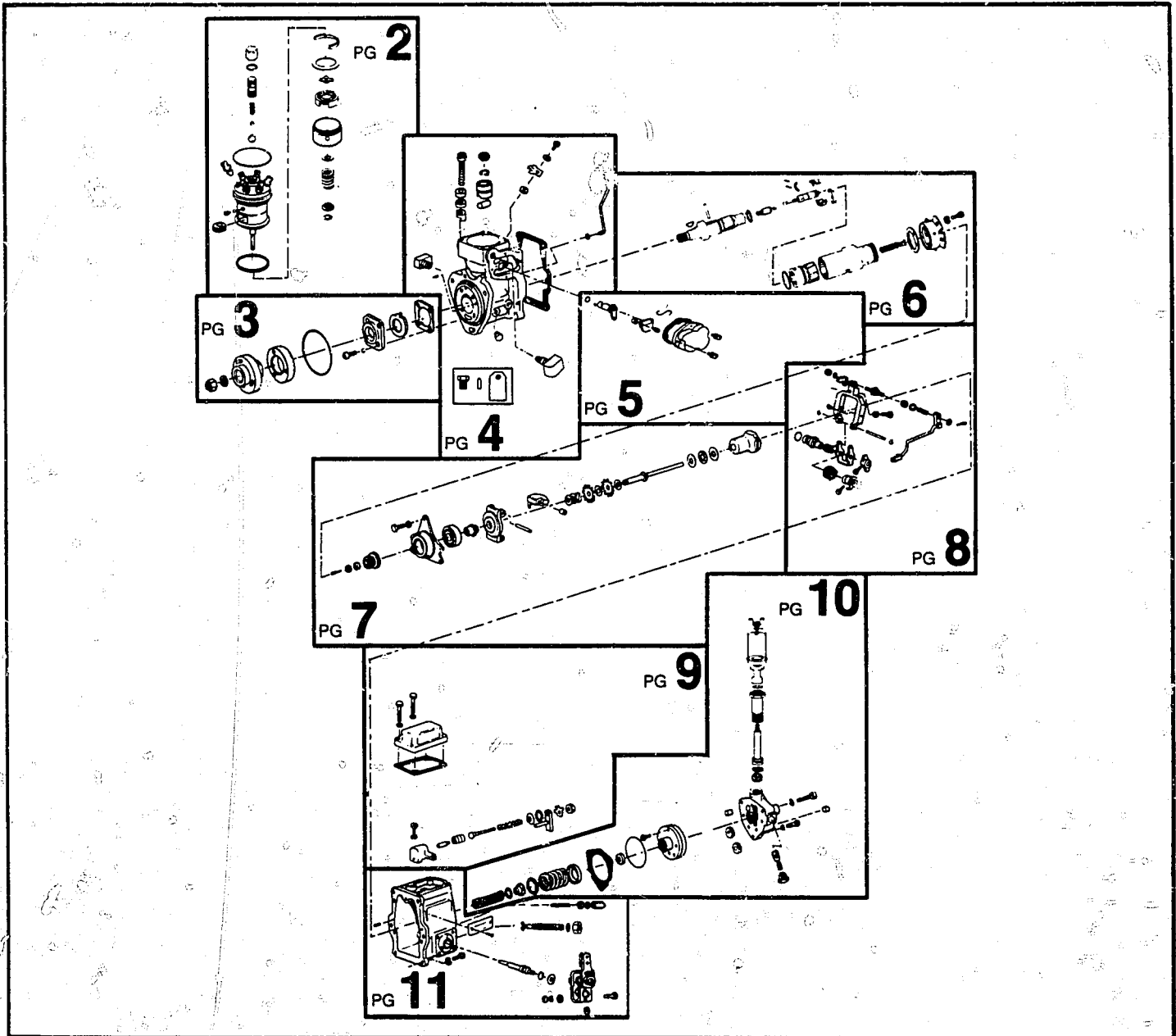

MODEL 100 6A 100A 9164

ASSY HD 9422-S
10MM HYDRAULIC
HEAD ASSY-including
1 thru 23; and 3 on
page 5

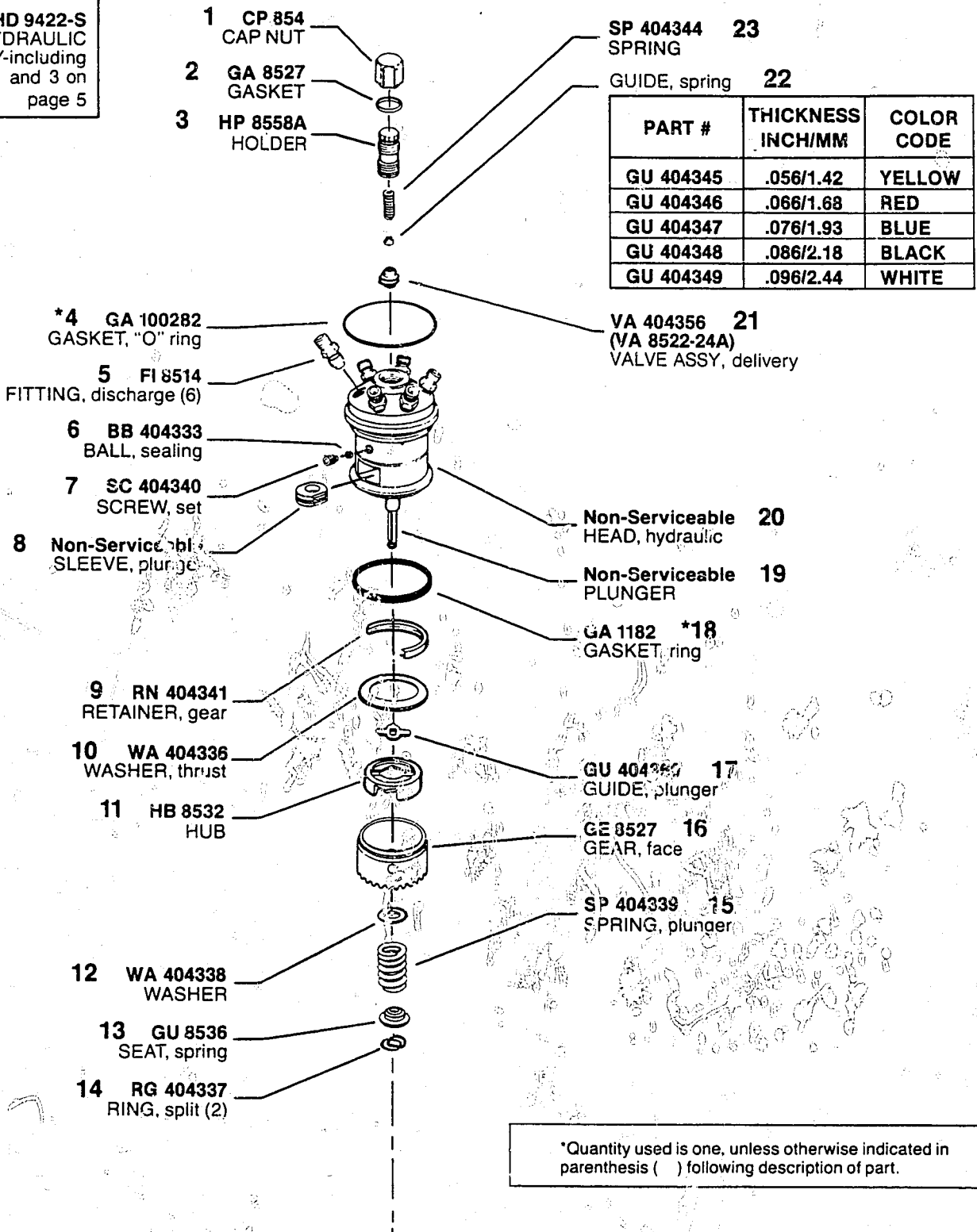

*Quantity used is one, unless otherwise indicated in parenthesis () following description of part.

MODEL 100 6A 100A 9164

*Denotes parts in Repair Gasket Kit, KT 85195.

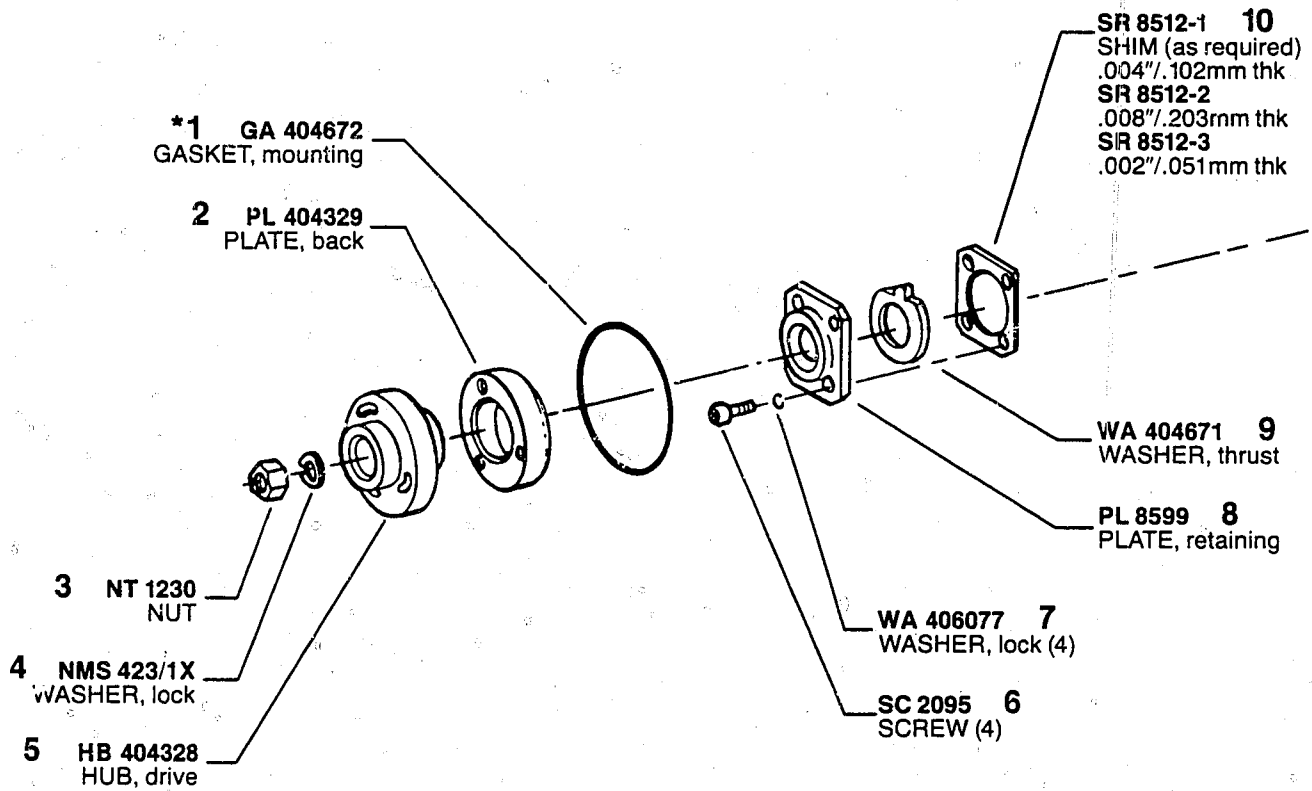

MODEL 100 6A 100A 9164

*Denotes parts in Repair Gasket Kit, KT 85195.

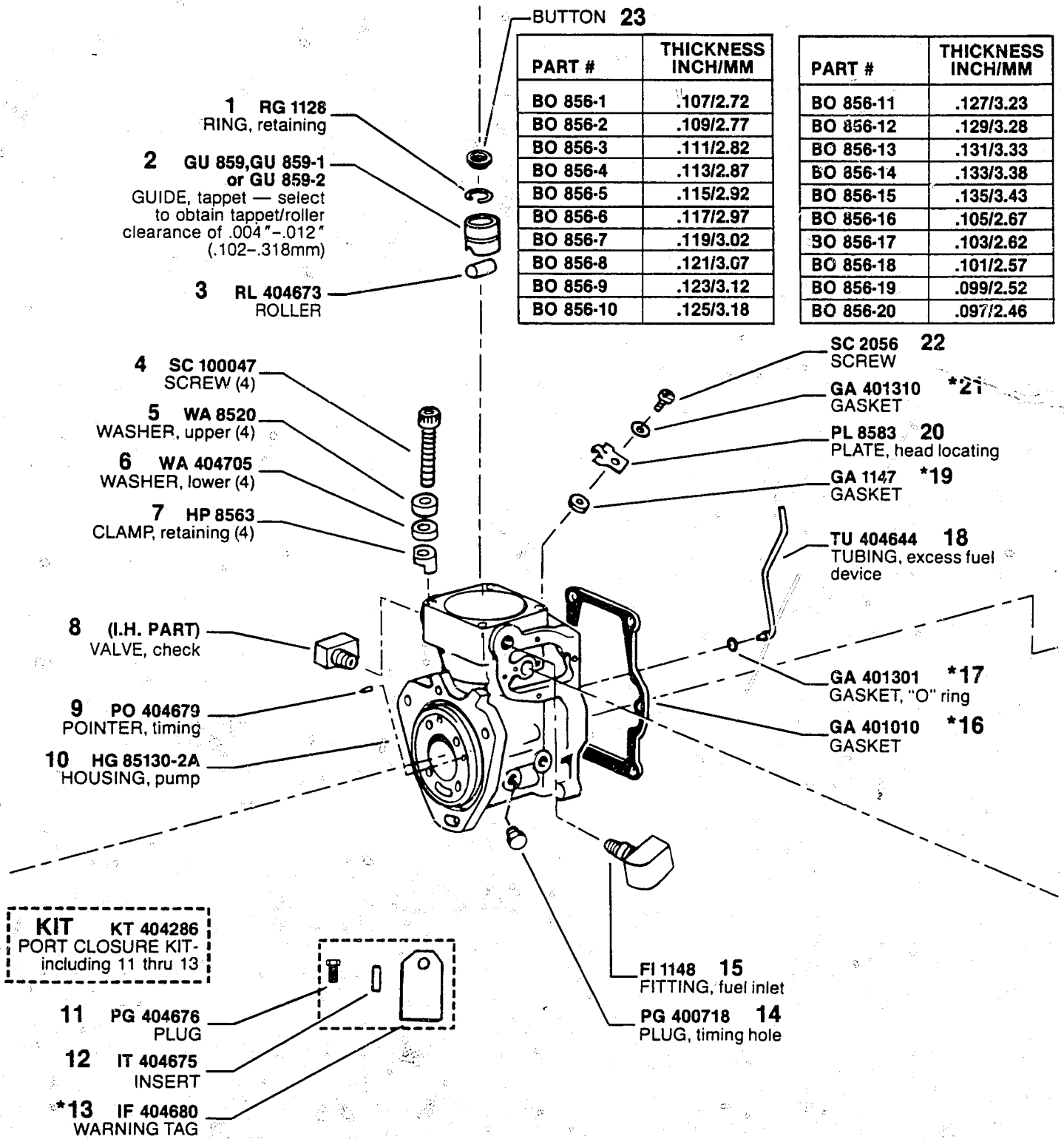

MODEL 100 6A 100A 9164

*Denotes parts in Repair Gasket Kit, KT 85195.

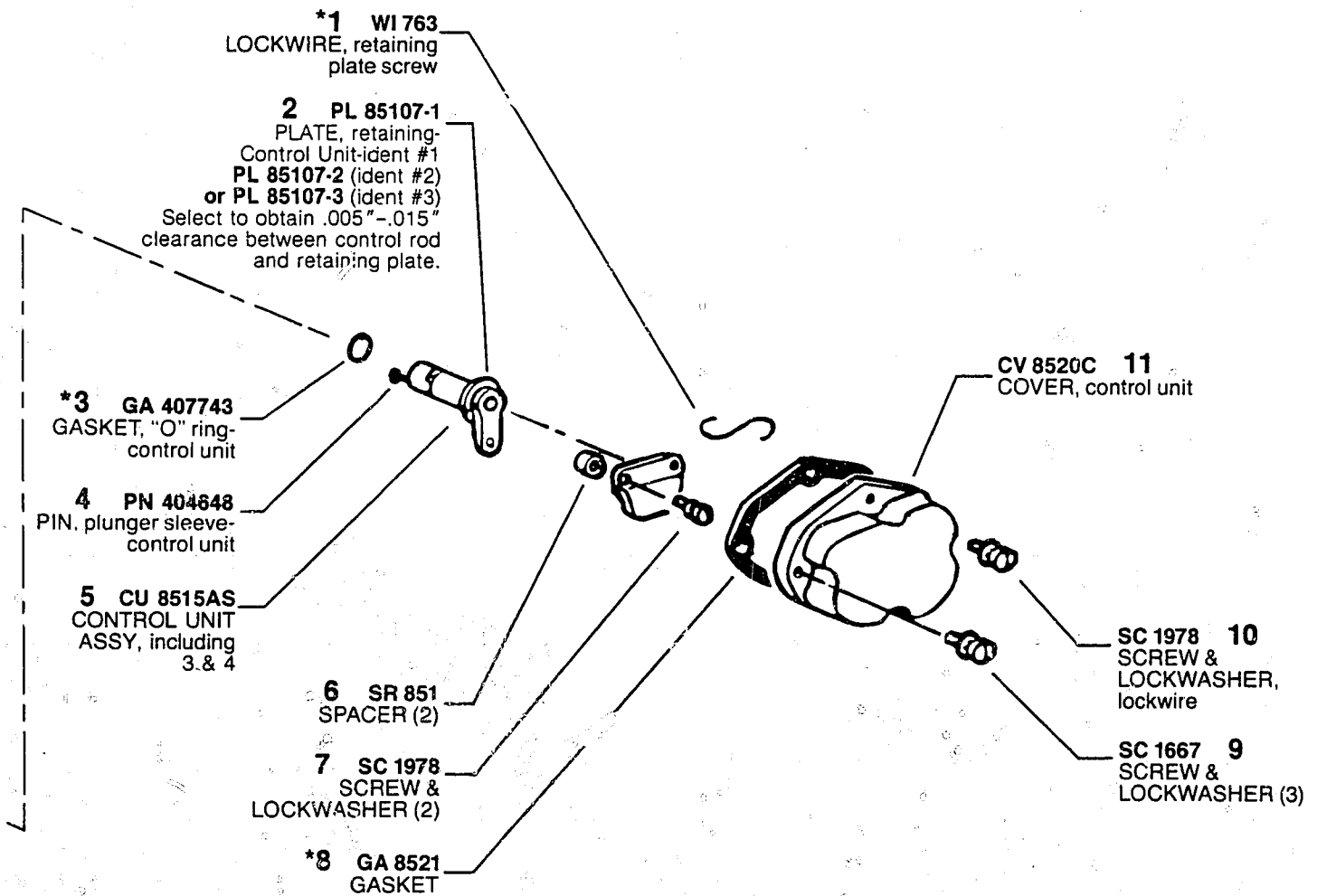

MODEL 100 6A 100A 9164

*Denotes parts in Repair Gasket Kit, KT 85195.

ASSY CT 85109A
INTRAVANCE®
CAMSHAFT ASSY-
including 1, 2, 4 thru 12
& 15 thru 19

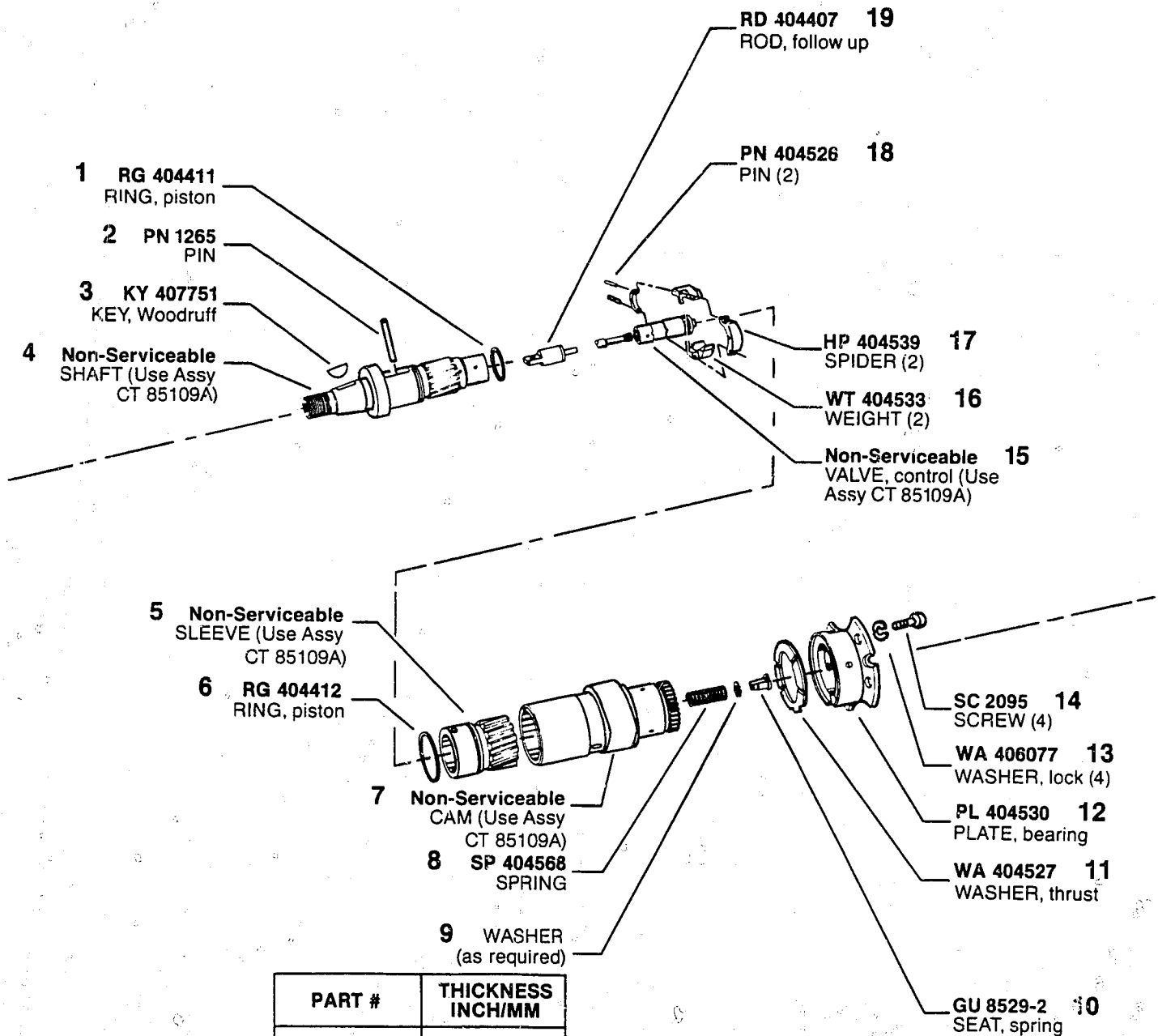

PART #	THICKNESS INCH/MM
WA 404540	.010/.254
WA 404541	.015/.381
WA 404542	.040/1.02
WA 404543	.060/1.52
WA 404544	.004/.102

MODEL 100 6A 100A 9164

ASSY WT 8535A
WEIGHT & SHAFT-
including 1, 5 thru 12 &
16 thru 21

ASSY WT 8531AS
WEIGHT & SPIDER
ASSY, including 9 & 16
thru 19

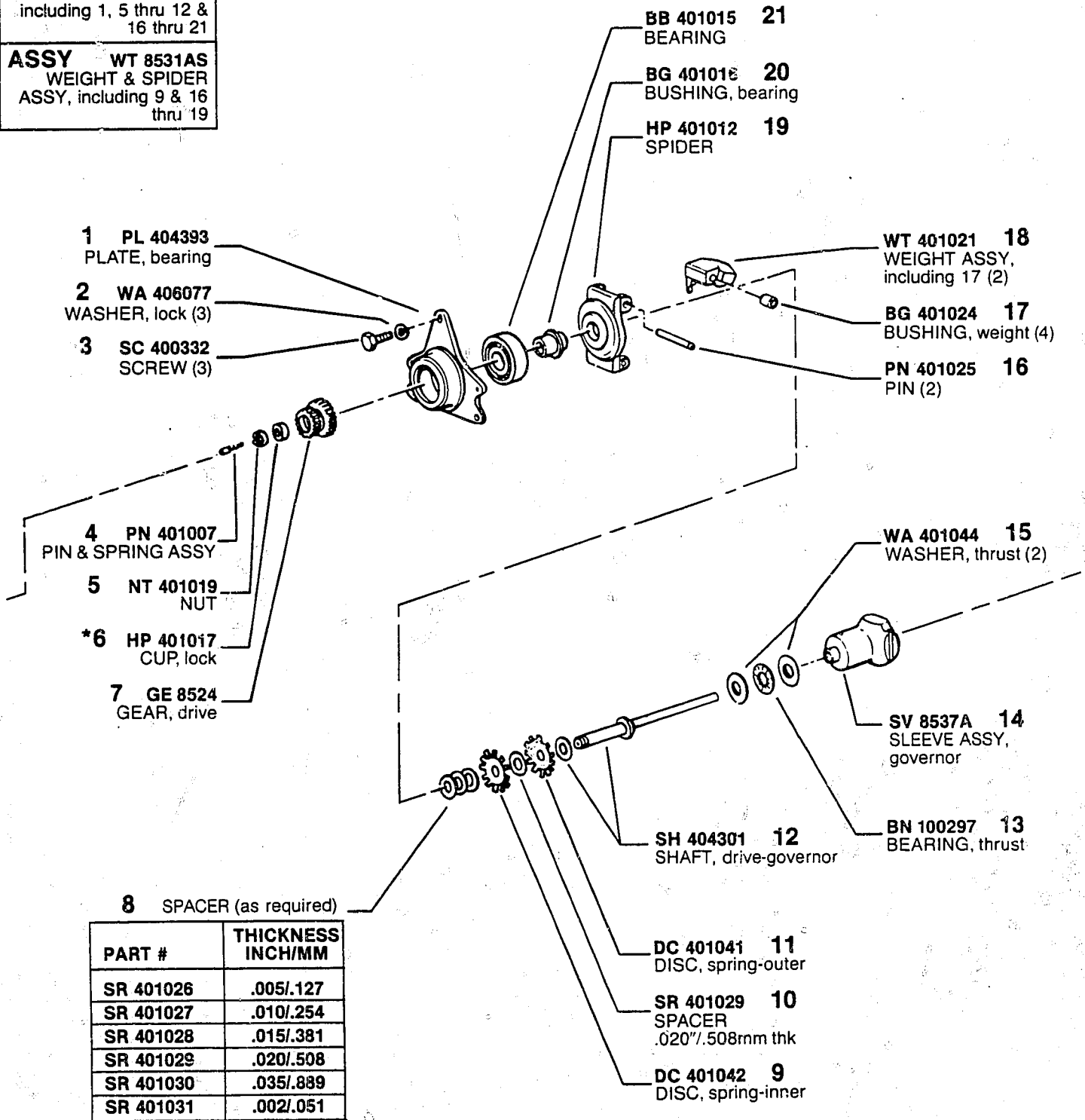

MODEL 100 6A 100A 9164

*Denotes parts in Repair Gasket Kit, KT 85195.

ASSY LE 85128-2A
LEVER & ROD,
fulcrum-including 1 thru
7, 15 thru 21 & 24

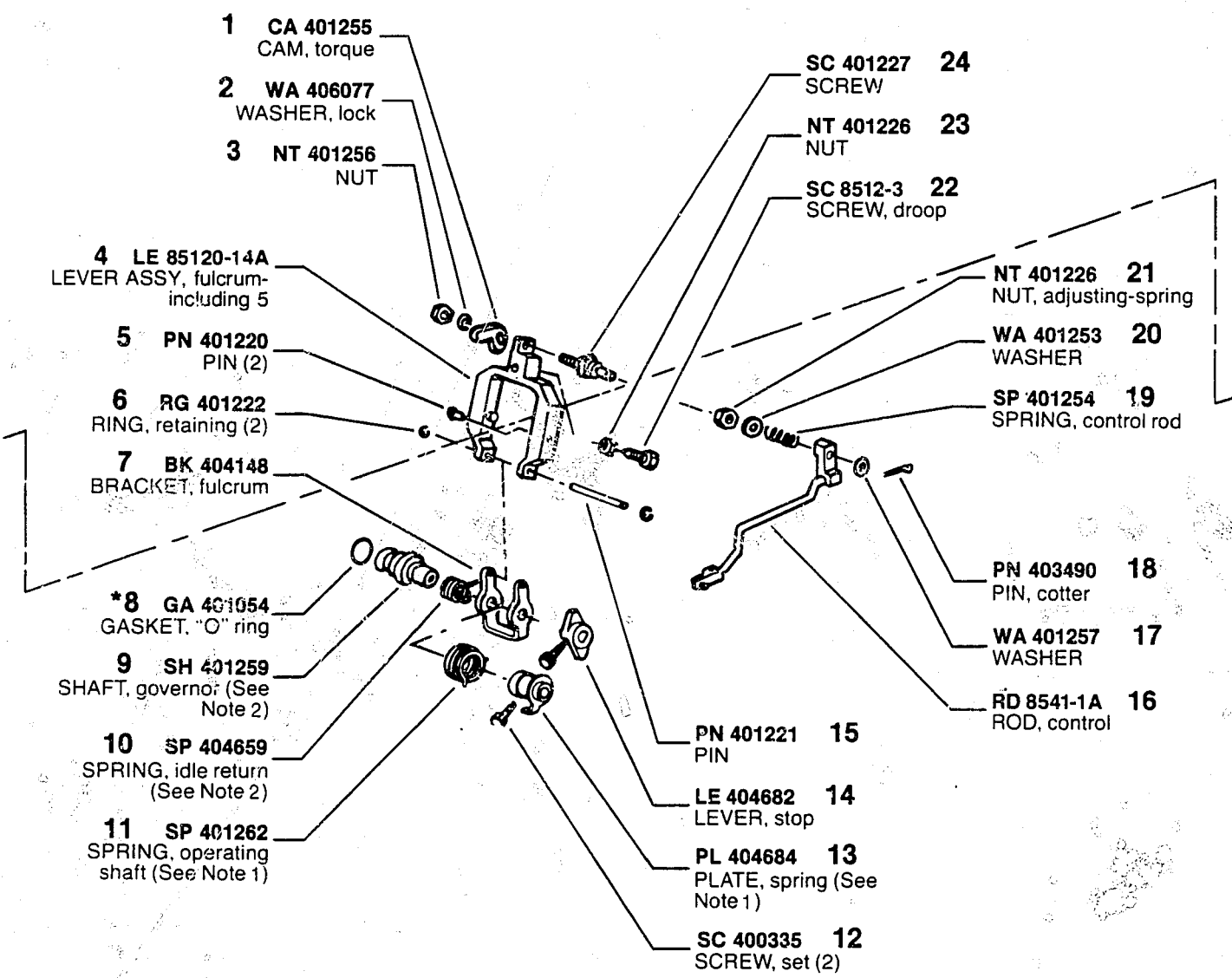

NOTE 1: If operating shaft spring has red or yellow band, replace spring (11) and spring plate (13).

NOTE 2: When replacing governor shaft (9) or governor operating shaft (5 on page 11), see if governor has idle return spring (10). If not, replace governor and operating shafts with SH 85153A which includes 9, 10; and 5 on page 11.

MODEL 100 6A 100A 9164

ASSY **PL 401607**
EXCESS FUEL
DEVICE ASSY-
including 4, 5, 8 thru
10 & 12 thru 15

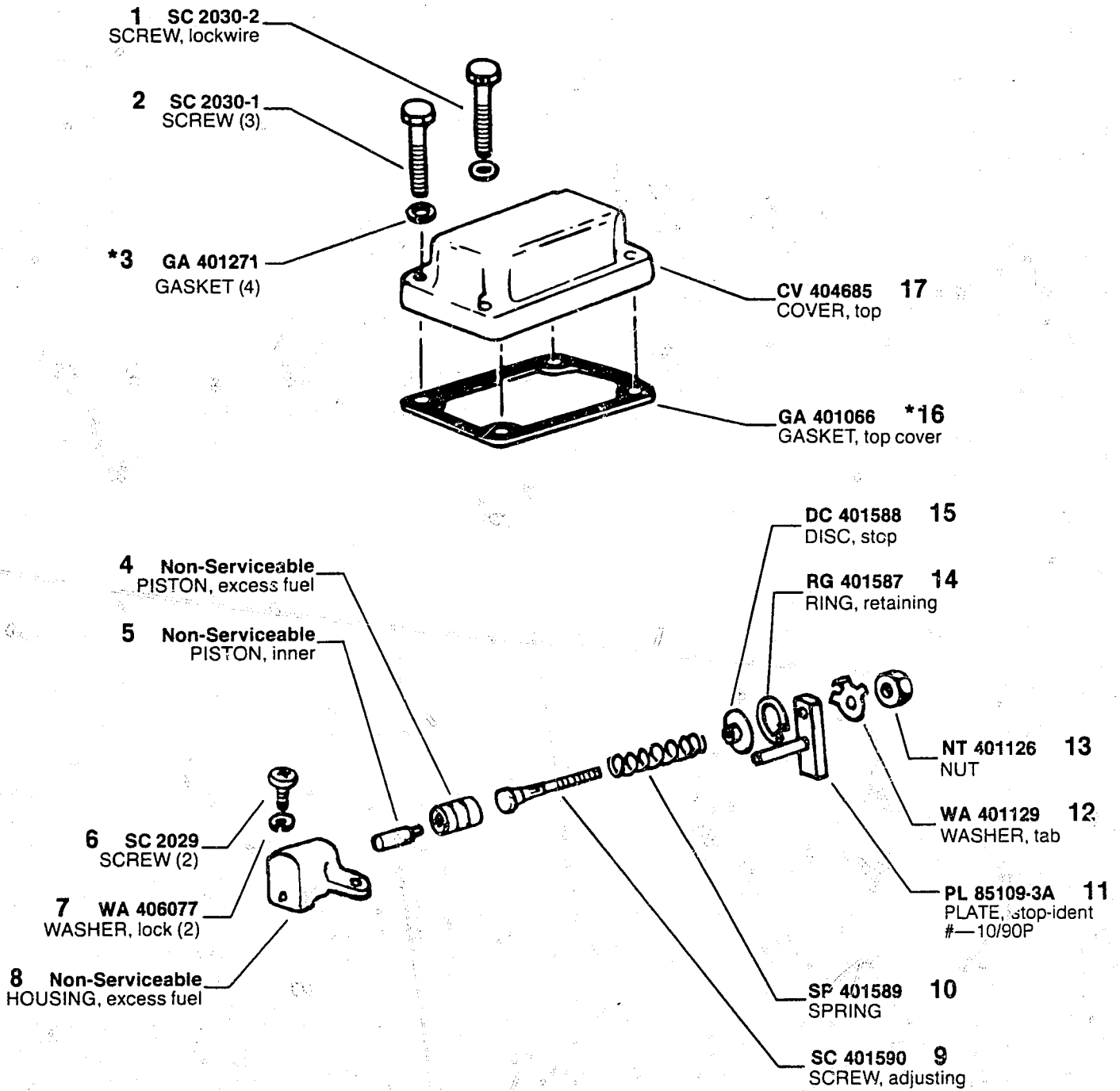

*Denotes parts in Repair Gasket Kit, KT 85195.

MODEL 100 6A 100A 9164



- ASSY CV 8567A**
COVER ASSY, supply pump-including 4, 7 thru 9 & 22
- ASSY MP 404760**
HAND PRIMER ASSY-including 1 thru 3 & 25 thru 28
- ASSY SGF 15-311**
SUPPLY PUMP ASSY-including 4 thru 9, 16 thru 20 & 22

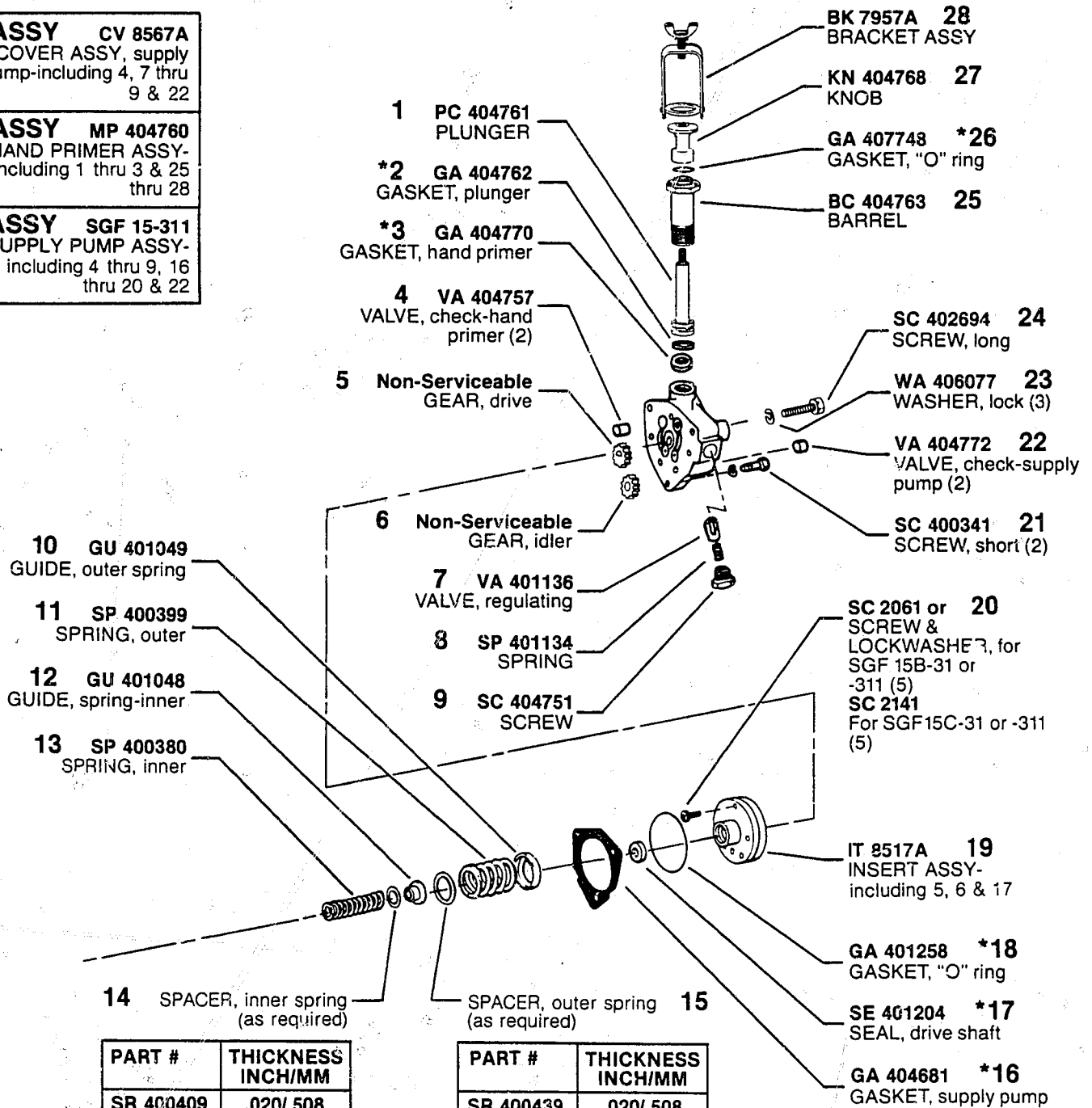

PART #	THICKNESS INCH/MM
SR 400409	.020/.508
SR 400410	.042/1.07
SR 400411	.058/1.47
SR 400412	.083/2.11
SR 400413	.177/4.50
SR 400414	.276/7.01
SR 400415	.010/.254
SR 400416	.005/.127

PART #	THICKNESS INCH/MM
SR 400439	.020/.508
SR 400440	.042/1.07
SR 400441	.058/1.47
SR 400442	.083/2.11
SR 400443	.156/3.96
SR 400444	.030/.762
SR 400445	.010/.254

*Denotes parts in Repair Gasket Kit, KT 85195.

MODEL 100 6A 100A 9164

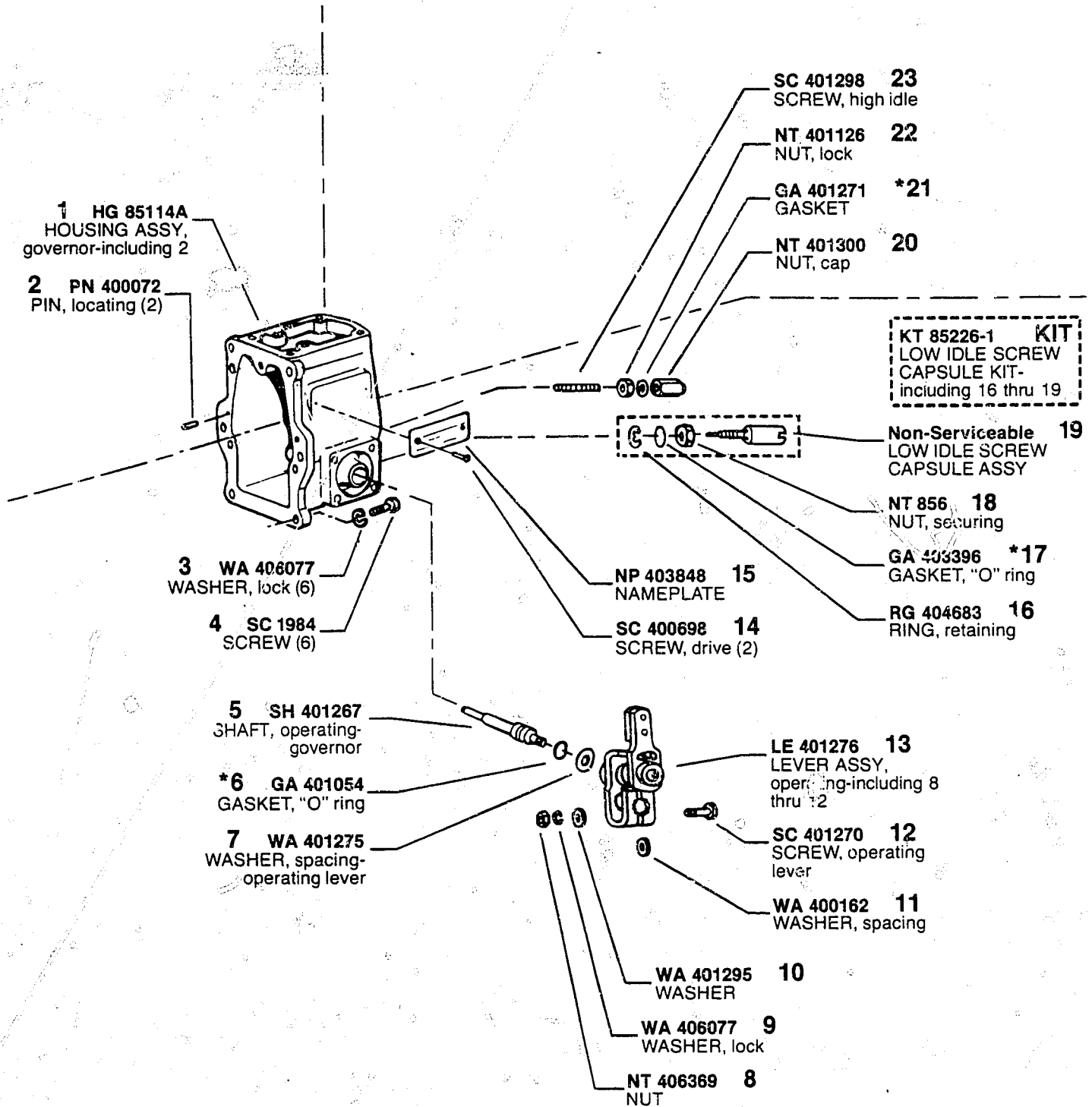

MODEL 100 6A 100A 9164

*Denotes parts in Repair Gasket Kit, KT 85195.



**UNITED
TECHNOLOGIES
DIESEL SYSTEMS**

CALIBRATION SET-UP

Nozzle Holder TSE 77107-5
 High Pressure Tubing 1/4" O.D. x .062" x 32" Long (6.35 x 1.58 x 813 mm)
 Test Oil Viscor 1487 @ 100°F (38°C) at pump inlet
 Supply Pump Pressure 40 psi (276 KPa) min at full load (rated) speed
 Lube Oil Pressure 55 psi (380 KPa)
 INTRAVANCE®
 Camshaft Assy CT 85109A (Stamped Ident Code: 109)
 Advance: 14° Total
 Start: 300-500 RPM
 End: 1720-1920 RPM

12

PROCEDURE: Refer to Service Instructions and use figures below.

**INTERNATIONAL HARVESTER
100 6A 100A 9164**

9164 (Code 1)
CODE DATA

Customer No. 672 763 C91
 Engine Model DT 414 (128 BHP)
 Application F 1066 GD
 Governor RPM 650/2400
 Inner Spring Gap 2.75 ± .25 mm
 Outer Spring Precompression 1.75 ± .25 mm
 Cam Angle (Ref) 50°

Lift To Port Closing Requirement024"-.030" (0.60-0.75 mm)
 Delivery Valve Opening Pressure 1150-1450 psi (7.929-9.998 MPa)

STEP	A	B	C	D
	Full Load	Puff Limiter Delivery Check	Peak Torque (from actual A delivery)	Cam Departure
RPM	2400	not applicable	1600	2475
DEL	*35.5		*+3.5	—

STEP	E	F	G	H
	High Speed Shut-Off	Droop Screw (from actual C delivery)	Low Idle	Starting Fuel Mir. Delivery
RPM	2800	1000	650	150
DEL	2cc Max	Droop Screw & Cam to contact stop plate	*11.5	10

*Permissible tolerances: Service Check: ± 2.5 cc/500 str
 Recalibration: ± 0.5 cc/500 str

STEP A: Max variation between cyl: 3.0 cc/500 str
 STEP A thru G: cc/500 str
 STEP H: cc/100 str