

**9245**

**A & B**



**UNITED  
TECHNOLOGIES  
DIESEL SYSTEMS**

**PUMP ROTATION:**

Clockwise

**FIRING ORDER:**

1-5-3-6-2-4

**MOUNTING:**

L.H.

**SPECIAL FEATURES:**

12 Volt Electric Shut-off

**INTERNATIONAL HARVESTER  
100 6A 100A 9245**

**Special Information:**

**SERVICE PARTS**

Following are all parts, part numbers, pump codes and calibrations for the *Model: 100 6A 100A 9245*. The exploded view drawing below is detailed with part

numbers listed on the pages indicated. Refer to the Index Section for explanations of codes and abbreviations.

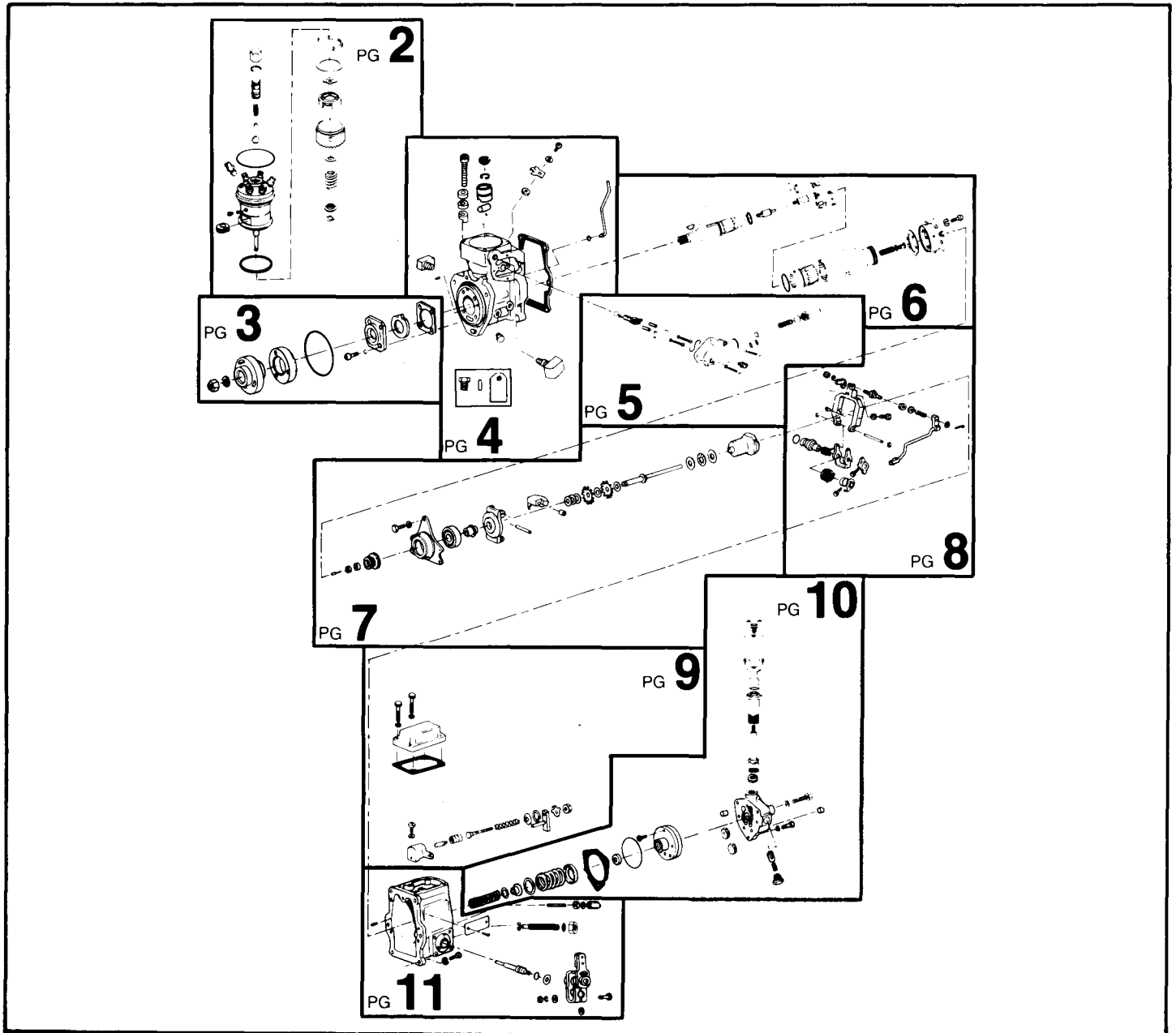

**MODEL 100 6A 100A 9245**

**ASSY HD 9422-S**  
10MM HYDRAULIC  
HEAD ASSY-  
including 1 thru 23; and  
4 on page 5

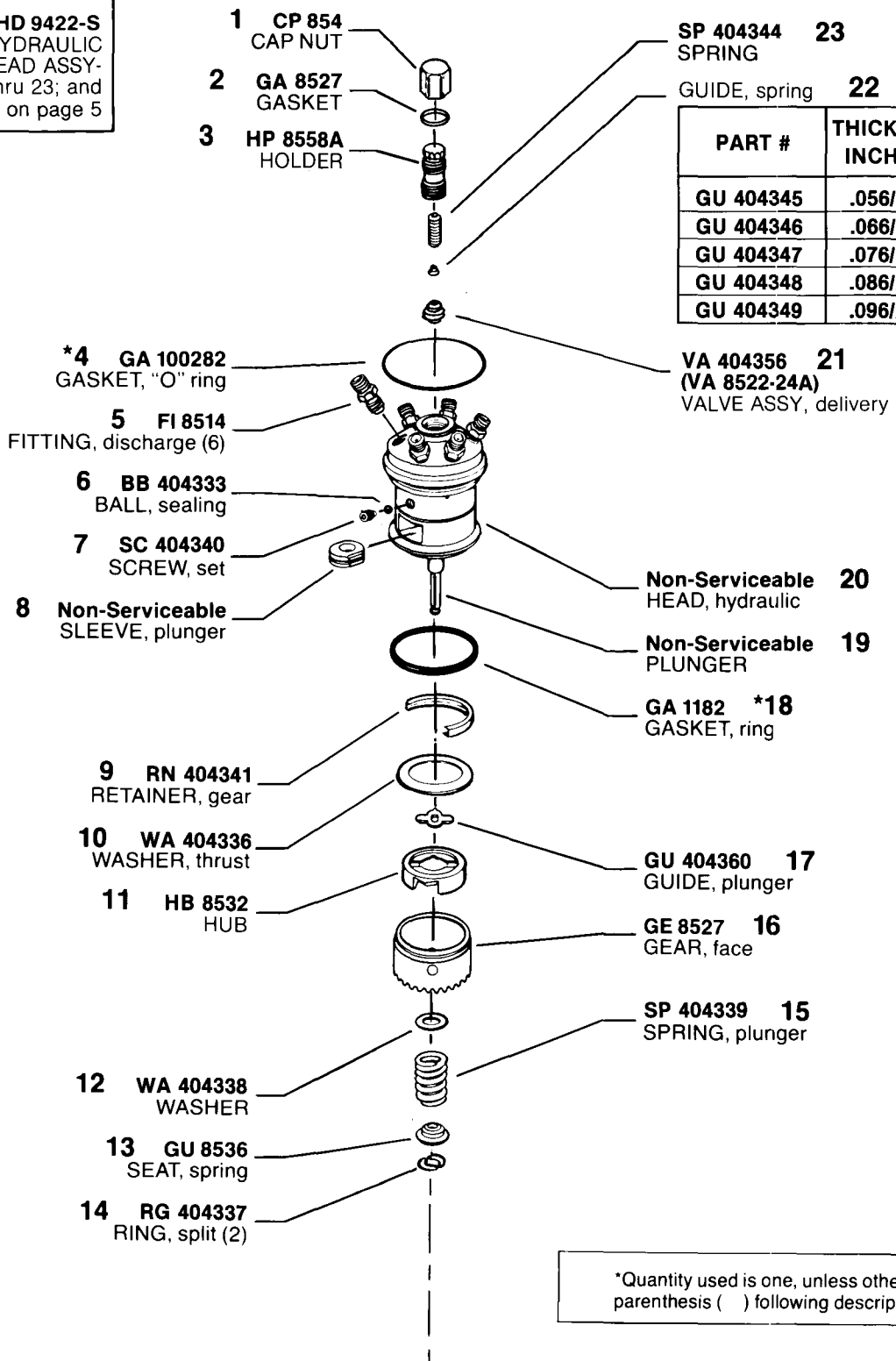

**SP 404344 23**  
SPRING

GUIDE, spring **22**

PART #	THICKNESS INCH/MM	COLOR CODE
GU 404345	.056/1.42	YELLOW
GU 404346	.066/1.68	RED
GU 404347	.076/1.93	BLUE
GU 404348	.086/2.18	BLACK
GU 404349	.096/2.44	WHITE

**VA 404356 21**  
(VA 8522-24A)  
VALVE ASSY, delivery

**Non-Serviceable 20**  
HEAD, hydraulic

**Non-Serviceable 19**  
PLUNGER

**GA 1182 \*18**  
GASKET, ring

**GU 404360 17**  
GUIDE, plunger

**GE 8527 16**  
GEAR, face

**SP 404339 15**  
SPRING, plunger

\*Quantity used is one, unless otherwise indicated in parenthesis ( ) following description of part.

# MODEL 100 6A 100A 9245

\*Denotes parts in Repair Gasket Kit, KT 85195.

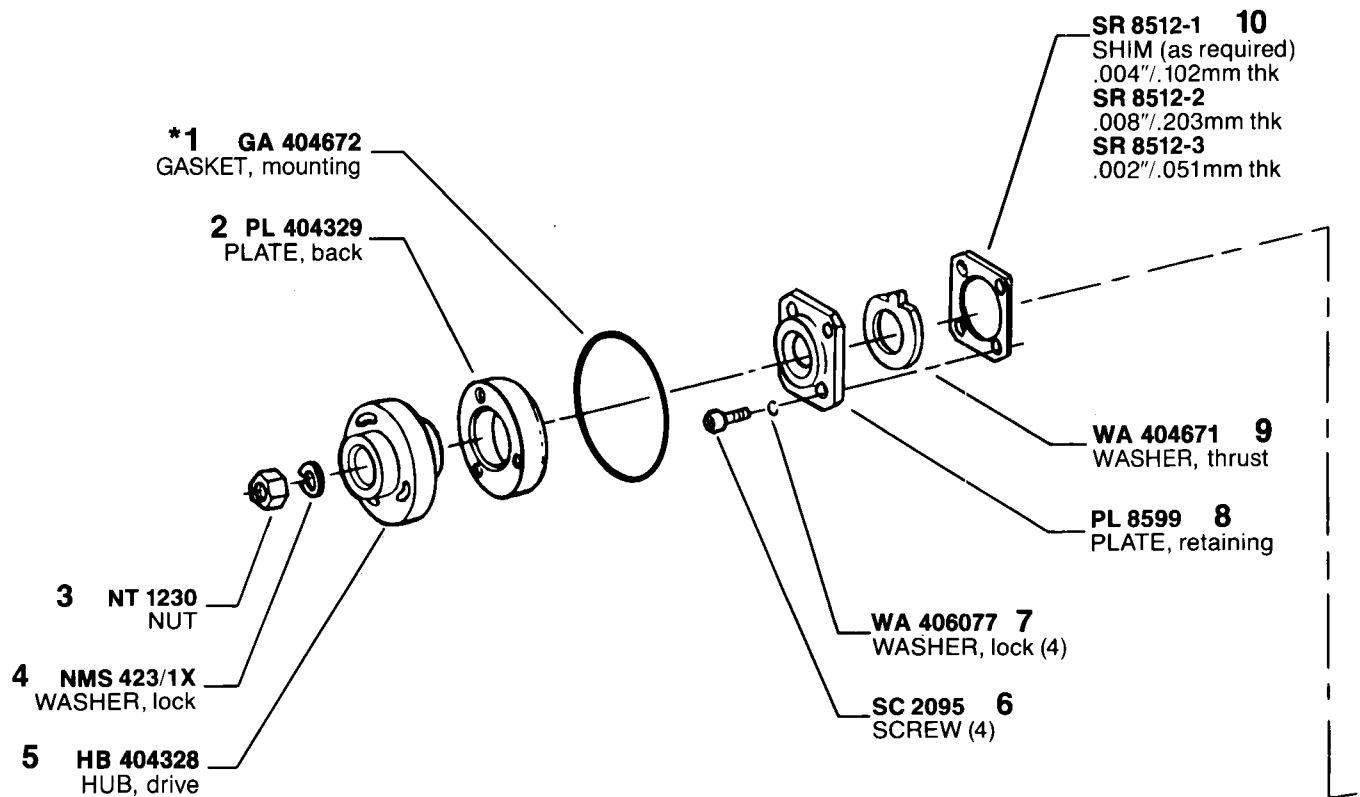

# MODEL 100 6A 100A 9245

\*Denotes parts in Repair Gasket Kit, KT 85195.

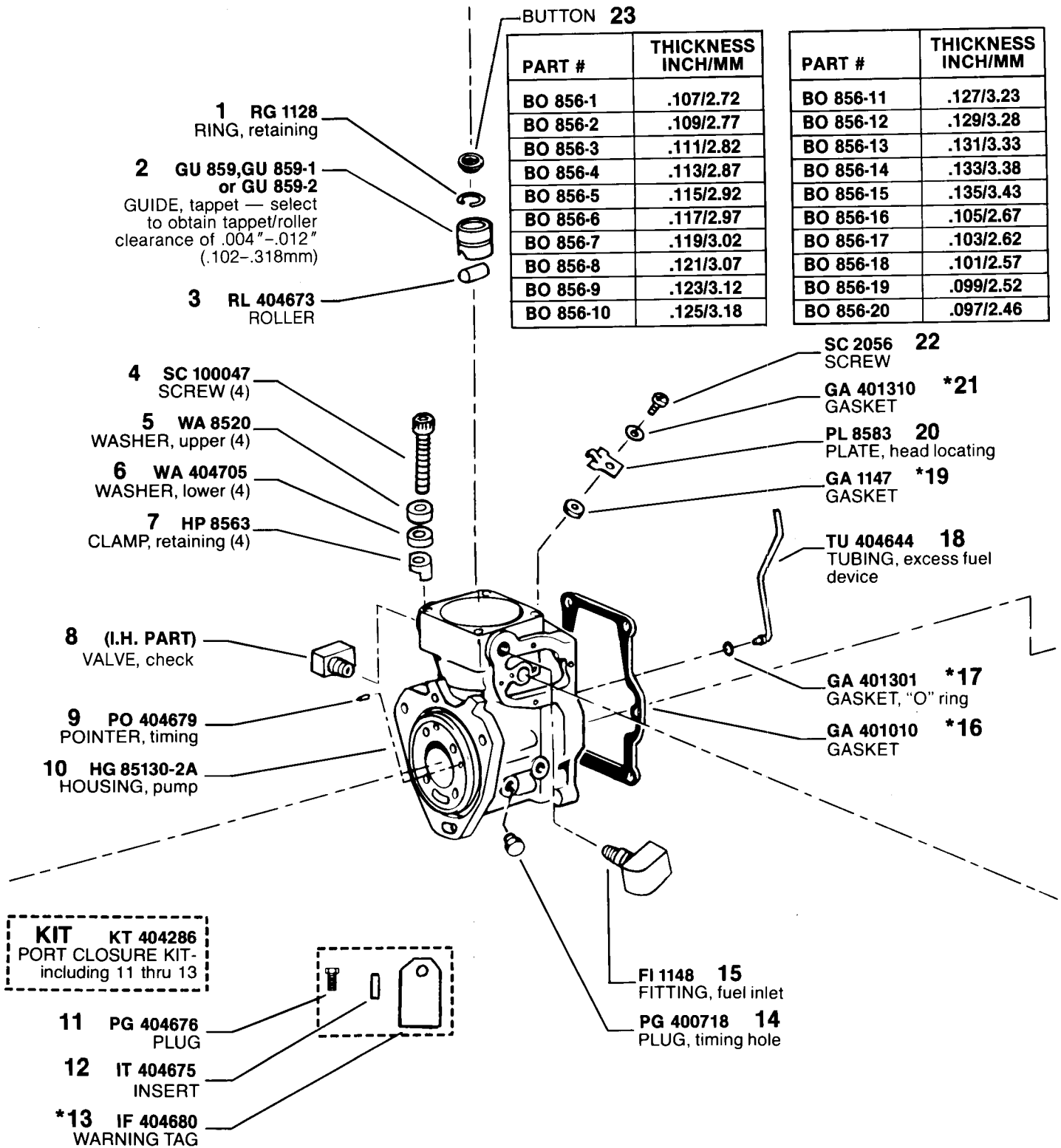

# MODEL 100 6A 100A 9245

\*Denotes parts in Repair Gasket Kit, KT 85195.

**KT 85208 KIT**  
ELECTRIC SOLENOID SHUT-OFF (12 Volt Application)-including 13 thru 18

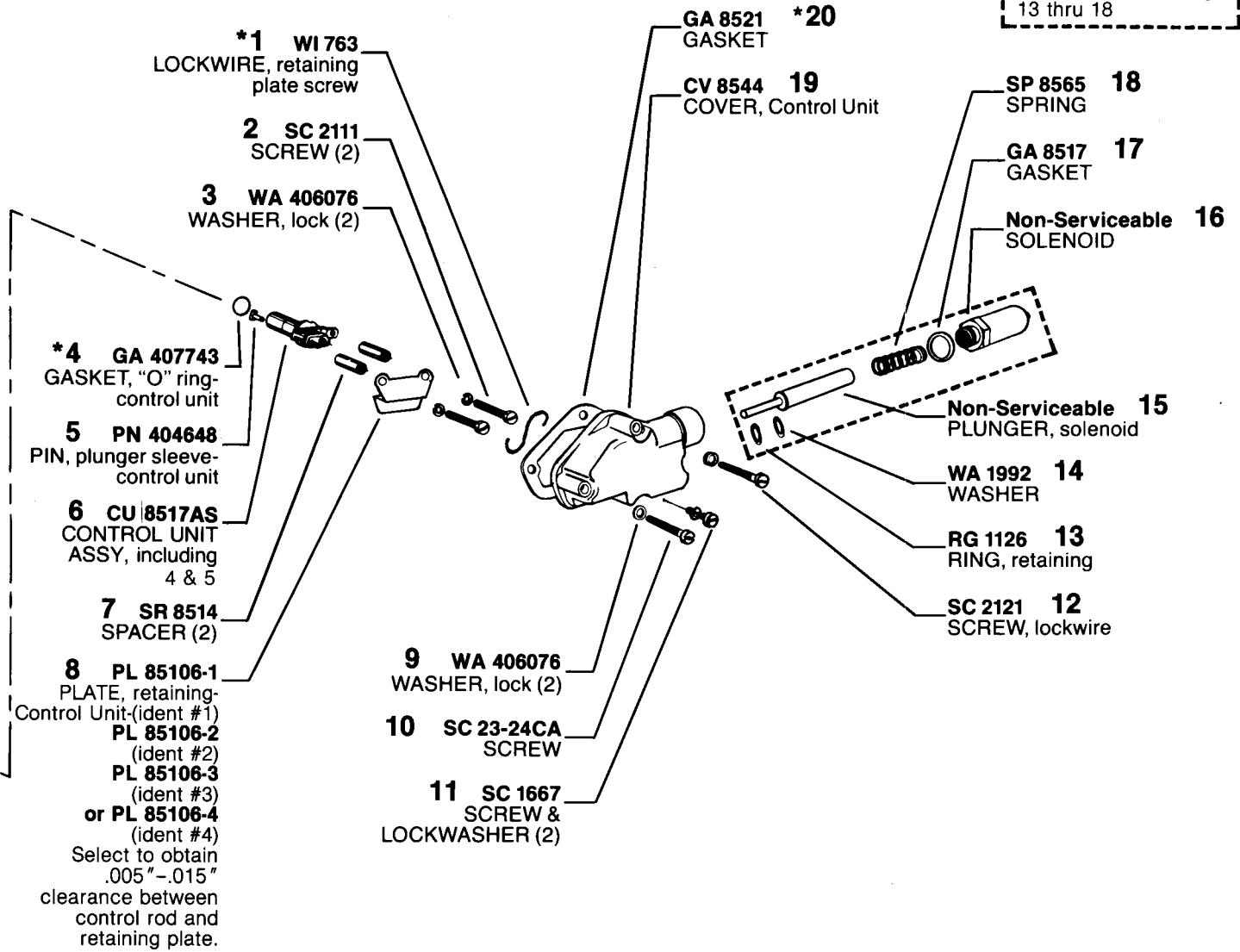

# MODEL 100 6A 100A 9245

\*Denotes parts in Repair Gasket Kit, KT 85195.

**ASSY CT 85109A**  
INTRAVANCE  
CAMSHAFT ASSY-  
including 1,2,4 thru 12  
& 15 thru 19

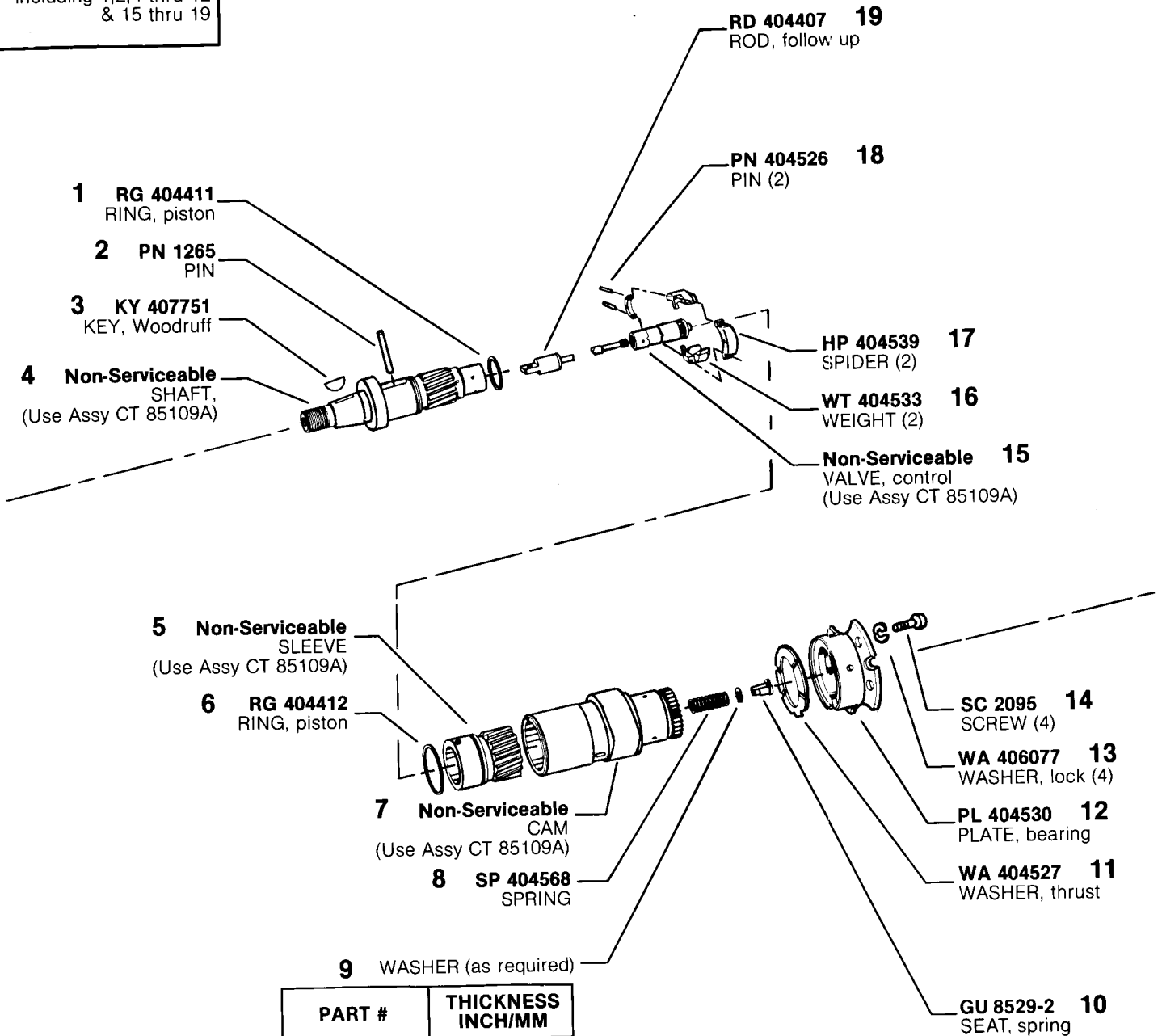

PART #	THICKNESS INCH/MM
WA 404540	.010/.254
WA 404541	.015/.381
WA 404542	.040/1.02
WA 404543	.060/1.52
WA 404544	.004/.102

MODEL 100 6A 100A 9245

**ASSY WT 8535A**  
WEIGHT & SHAFT-  
including 1, 5 thru 12 &  
16 thru 21

**ASSY WT 8531AS**  
WEIGHT & SPIDER  
ASSY, including 9 & 16  
thru 19

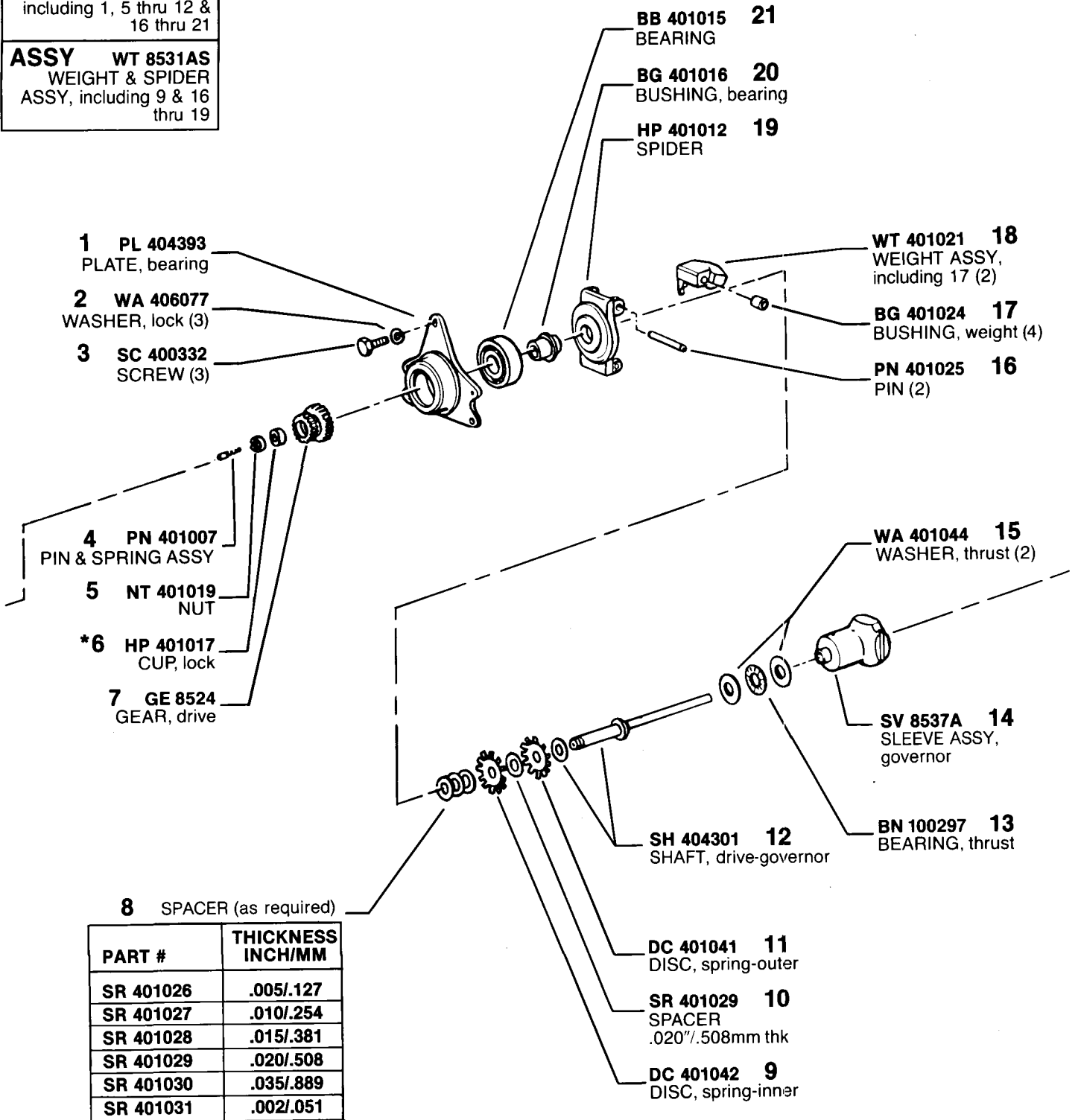

PART #	THICKNESS INCH/MM
SR 401026	.005/.127
SR 401027	.010/.254
SR 401028	.015/.381
SR 401029	.020/.508
SR 401030	.035/.889
SR 401031	.002/.051

# MODEL 100 6A 100A 9245

\*Denotes parts in Repair Gasket Kit, KT 85195.

**ASSY LE 85128-2A**  
LEVER & ROD,  
fulcrum-including 1 thru  
7, 15 thru 21 & 24

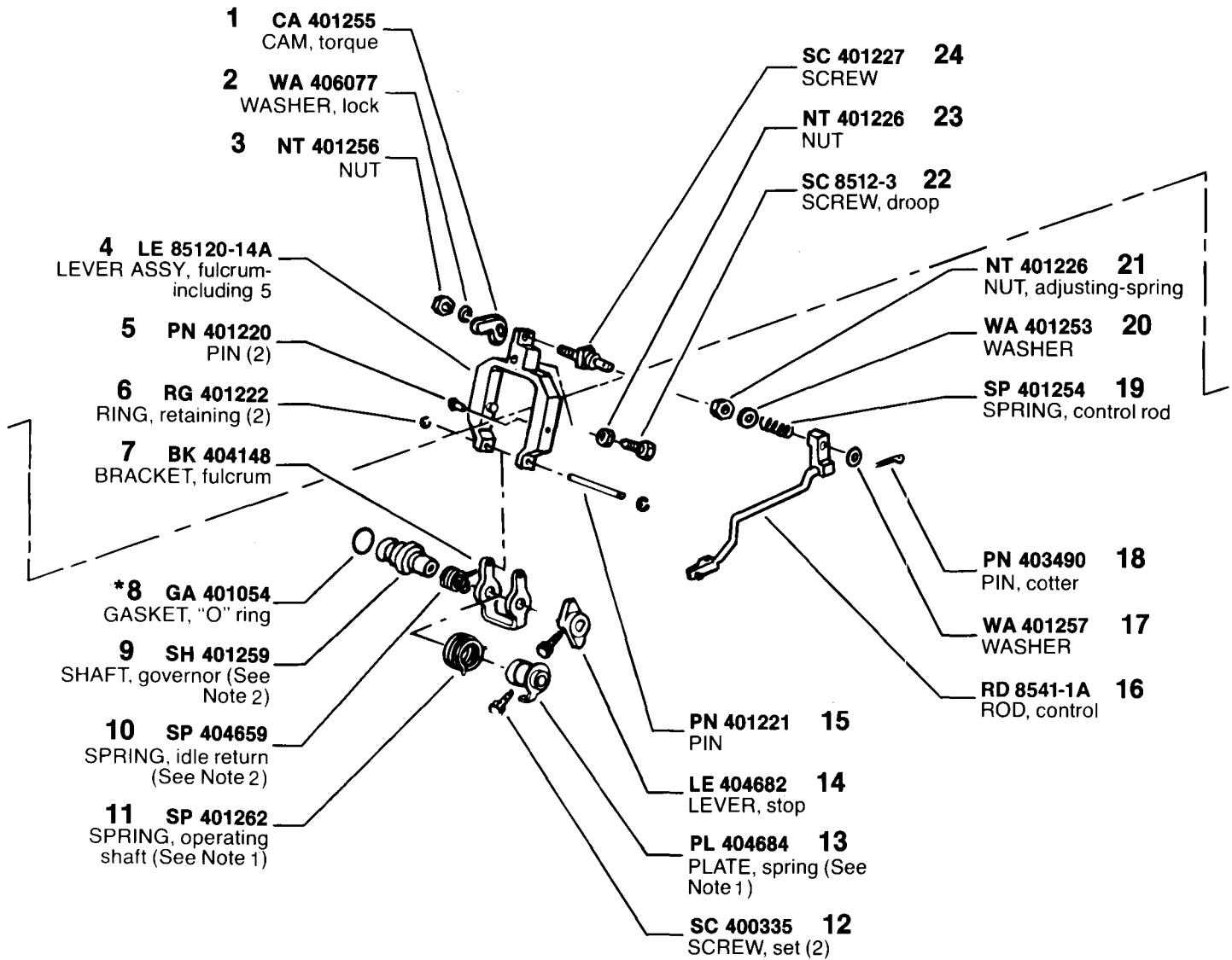

NOTE 1: If operating shaft spring has red or yellow band, replace spring (11) and spring plate (13).

NOTE 2: When replacing governor shaft (9) or governor operating shaft (5 on page 11), see if governor has idle return spring (10). If not, replace governor and operating shafts with SH 85153A which includes 9, 10; and 5 on page 11.

# MODEL 100 6A 100A 9245

**ASSY** PL 401607  
EXCESS FUEL  
DEVICE ASSY-  
including 4, 5, 8 thru  
10 & 12 thru 15

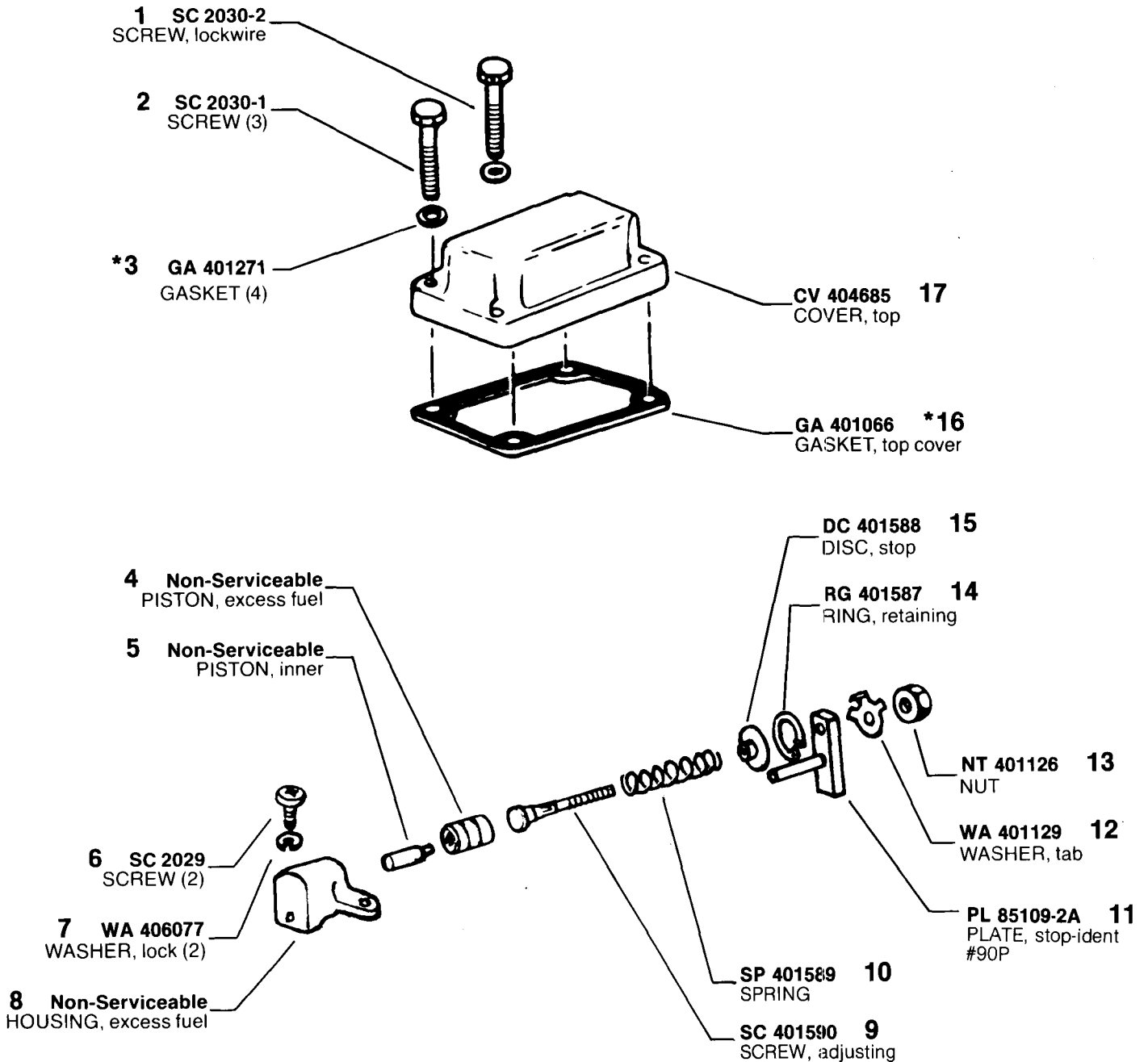

\*Denotes parts in Repair Gasket Kit, KT 85195.

MODEL 100 6A 100A 9245

- ASSY CV 8567A**  
COVER ASSY, supply pump-including 4, 7 thru 9 & 22
- ASSY MP 404760**  
HAND PRIMER ASSY-including 1 thru 3 & 25 thru 28
- ASSY SGF 15-311**  
SUPPLY PUMP ASSY-including 4 thru 9, 16 thru 20 & 22

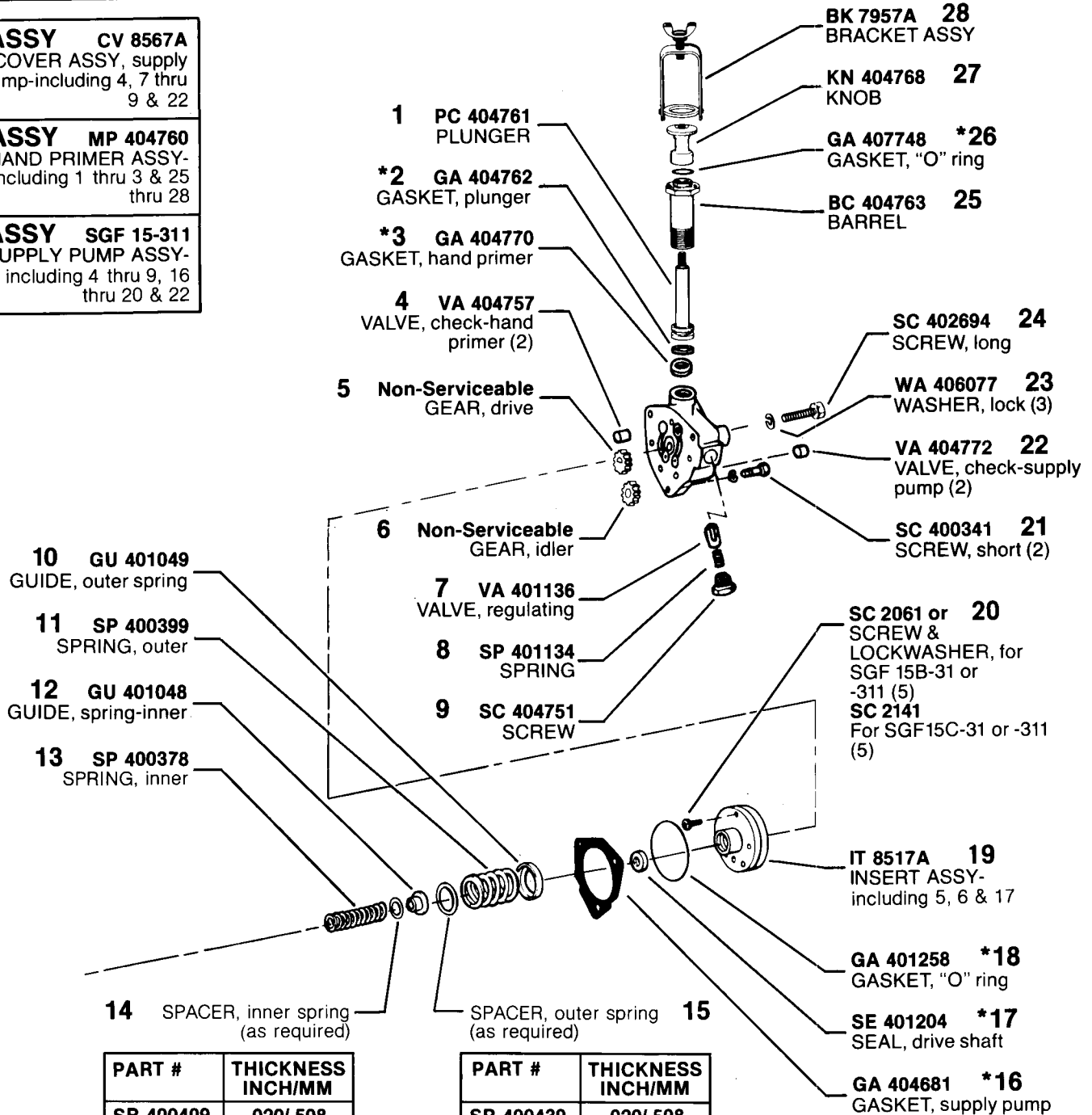

PART #	THICKNESS INCH/MM
SR 400409	.020/.508
SR 400410	.042/1.07
SR 400411	.058/1.47
SR 400412	.083/2.11
SR 400413	.177/4.50
SR 400414	.276/7.01
SR 400415	.010/.254
SR 400416	.005/.127

PART #	THICKNESS INCH/MM
SR 400439	.020/.508
SR 400440	.042/1.07
SR 400441	.058/1.47
SR 400442	.083/2.11
SR 400443	.156/3.96
SR 400444	.030/.762
SR 400445	.010/.254

\*Denotes parts in Repair Gasket Kit, KT 85195.

# MODEL 100 6A 100A 9245

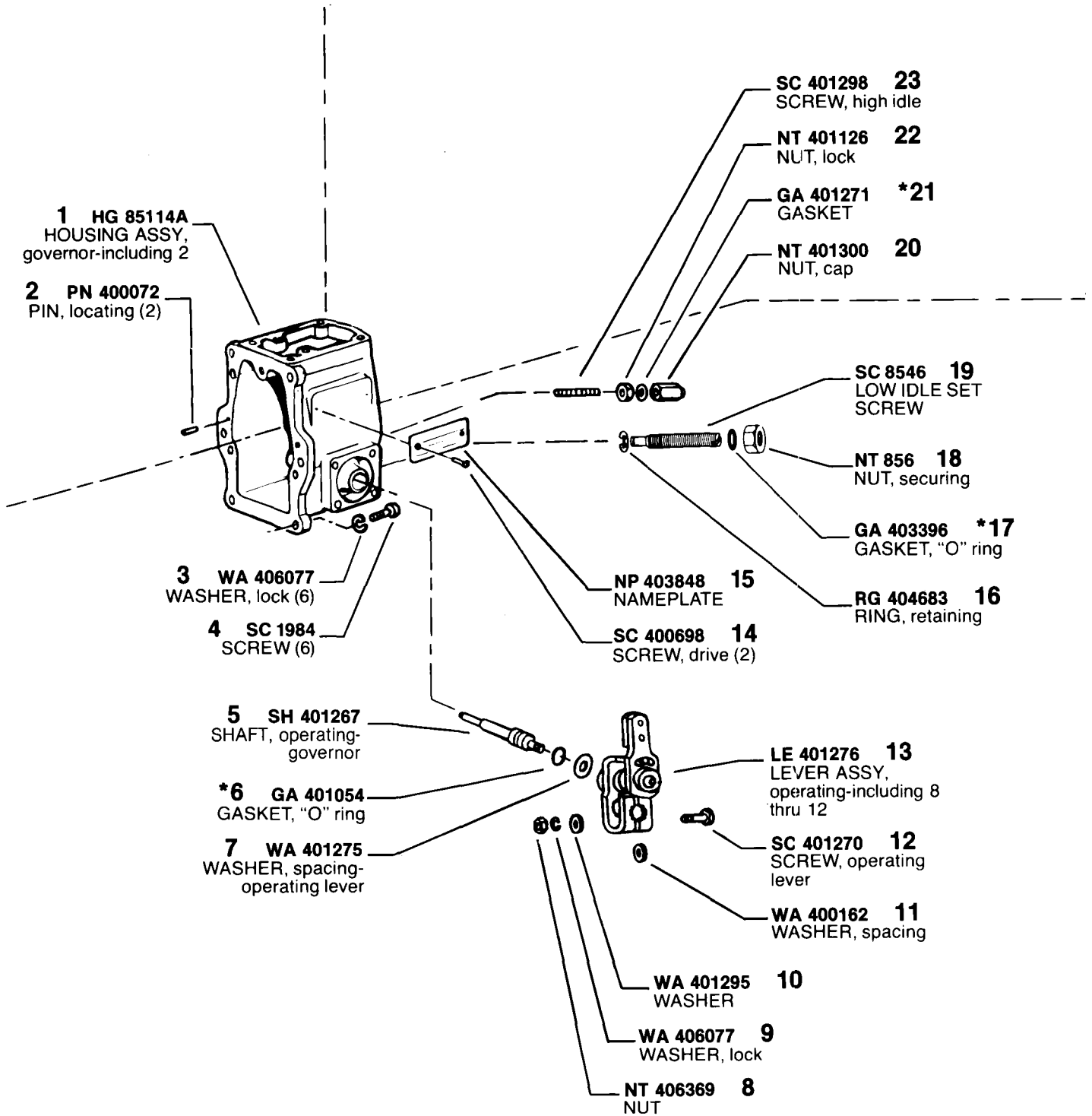

# MODEL 100 6A 100A 9245

\*Denotes parts in Repair Gasket Kit, KT 85195.



**UNITED  
TECHNOLOGIES  
DIESEL SYSTEMS**

**CALIBRATION SET-UP**

Nozzle Holder . . . . . TSE 77107-5  
 High Pressure Tubing . . . . . 1/4" O.D. x .062" x 32" Long (6.35 x 1.58 x 813 mm)  
 Test Oil . . . . . Viscor 1487 (at 100°F (38°C) at pump inlet)  
 Supply Pump Pressure . . . . . 40 psi (276 KPa) min at full load (rated) speed  
 Lube Oil Pressure . . . . . .55 psi (380 KPa)  
 INTRAVANCE®  
 Camshaft Assy . . . . . CT 85109A (Stamped Ident Code: 109)  
 Advance: 14° Total  
 Start: 300-500 RPM  
 End: 1720-1920 RPM

12

PROCEDURE: Refer to Service Instructions and use figures below.

**INTERNATIONAL HARVESTER  
100 6A 100A 9245**

9245 (Code 1)

**CODE DATA**

Customer No. . . . . 684 546 C91  
 Engine Model . . . . . UDT 466 (210 BHP)  
 Application . . . . . SMI Snow Blower  
 Governor RPM . . . . . 700/2800  
 Inner Spring Gap . . . . . 2.25 ± .25 mm  
 Outer Spring Precompression . . . . . 1.25 ± .25 mm  
 Cam Angle (Ref) . . . . . 85°

Lift To Port Closing Requirement . . . . . .024"-.030" (0.60-0.75 mm)  
 Delivery Valve Opening Pressure . . . . . 1150-1450 psi (7.929-9.998 MPa)

STEP	A	B	C	D
	Full Load	Puff Limiter Delivery Check	Peak Torque (from actual A delivery)	Cam Departure
RPM	<b>2800</b>	<b>not applicable</b>	<b>2100</b>	<b>2875</b>
DEL	<b>*51.0</b>		<b>*+0</b>	—

STEP	E	F	G	H
	High Speed Shut-Off	Droop Screw (from actual C delivery)	Low Idle	Starting Fuel Min Delivery
RPM	<b>3300</b>	<b>1400</b>	<b>700</b>	<b>150</b>
DEL	<b>2cc Max</b>	<b>* - 4.5</b>	<b>*7.5</b>	<b>10</b>

\*Permissible tolerances: Service Check: ± 2.5 cc/500 str  
 Recalibration: ± 0.5 cc/500 str  
 STEP A: Max variation between cyl: 4.0 cc/500 str  
 STEP A thru G: cc/500 str  
 STEP H: cc/100 str