

9379

A & B



**UNITED
TECHNOLOGIES
DIESEL SYSTEMS**

PUMP ROTATION:
Counter Clockwise
FIRING ORDER:
1-5-3-6-2-4
MOUNTING:
R.H.
SPECIAL FEATURES:

**BRITISH LEYLAND
100 6A 100A 9379A & B**

Special Information:

Springfield, MA 01107

SERVICE PARTS

Following are all parts, part numbers, pump codes and calibrations for the *Model: 100 6A 100A 9379A & B*. The exploded view drawing below is detailed with part numbers

listed on the pages indicated. Refer to the Index Section for explanations of codes and abbreviations.

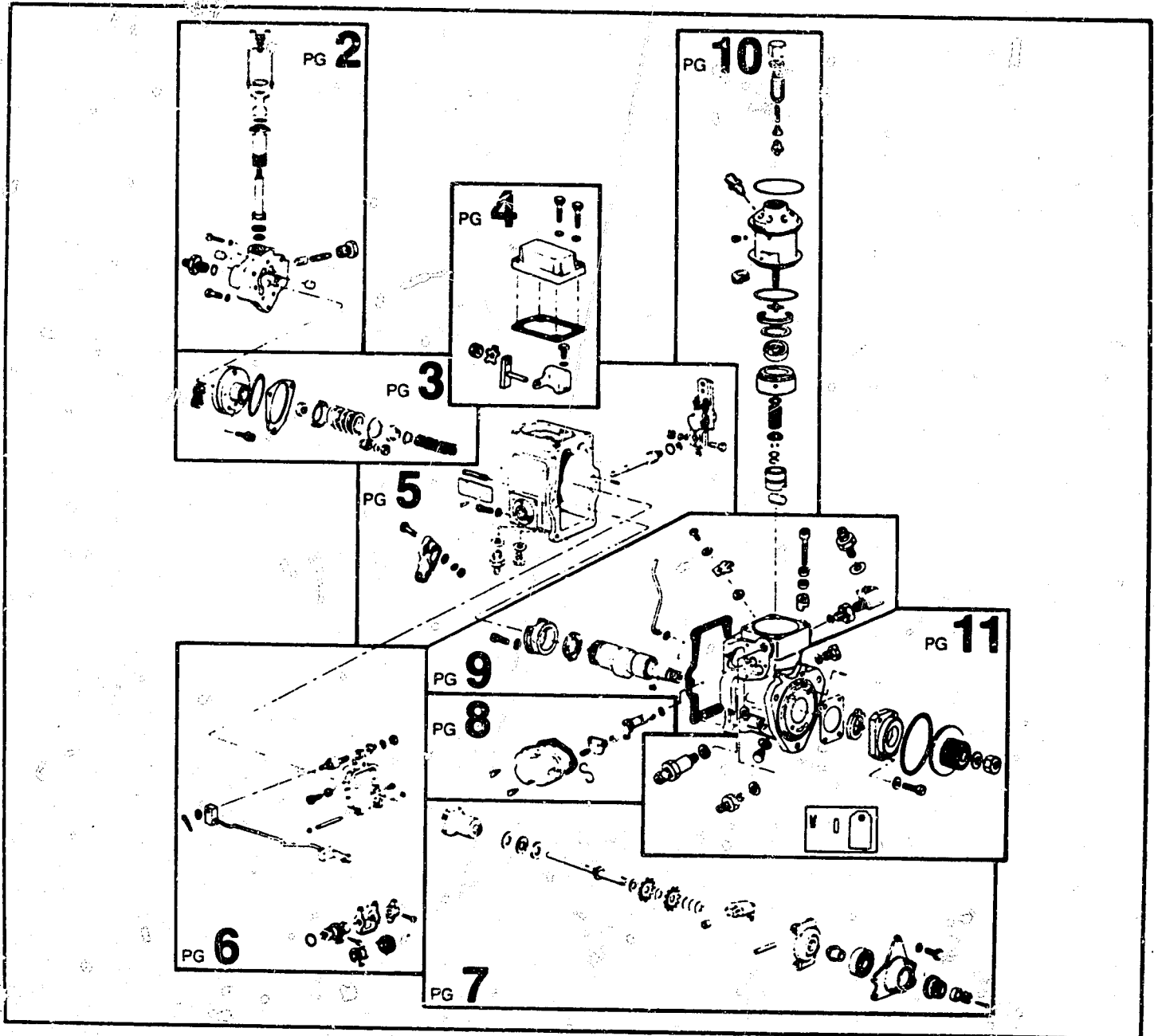

MODEL 100 6A 100A 9379A & B

- ASSY SGF 15C811**
PUMP ASSY, supply-
including 5 thru 7, cover,
9 thru 12, and 1 thru 3,
5, 6 & 13 on page 3
- ASSY CV 8570A**
COVER ASSY, supply
pump-including 5 & 9
thru 12
- ASSY MP 7915A**
HAND PRIMER ASSY-
including 1, 2 & 13
thru 17

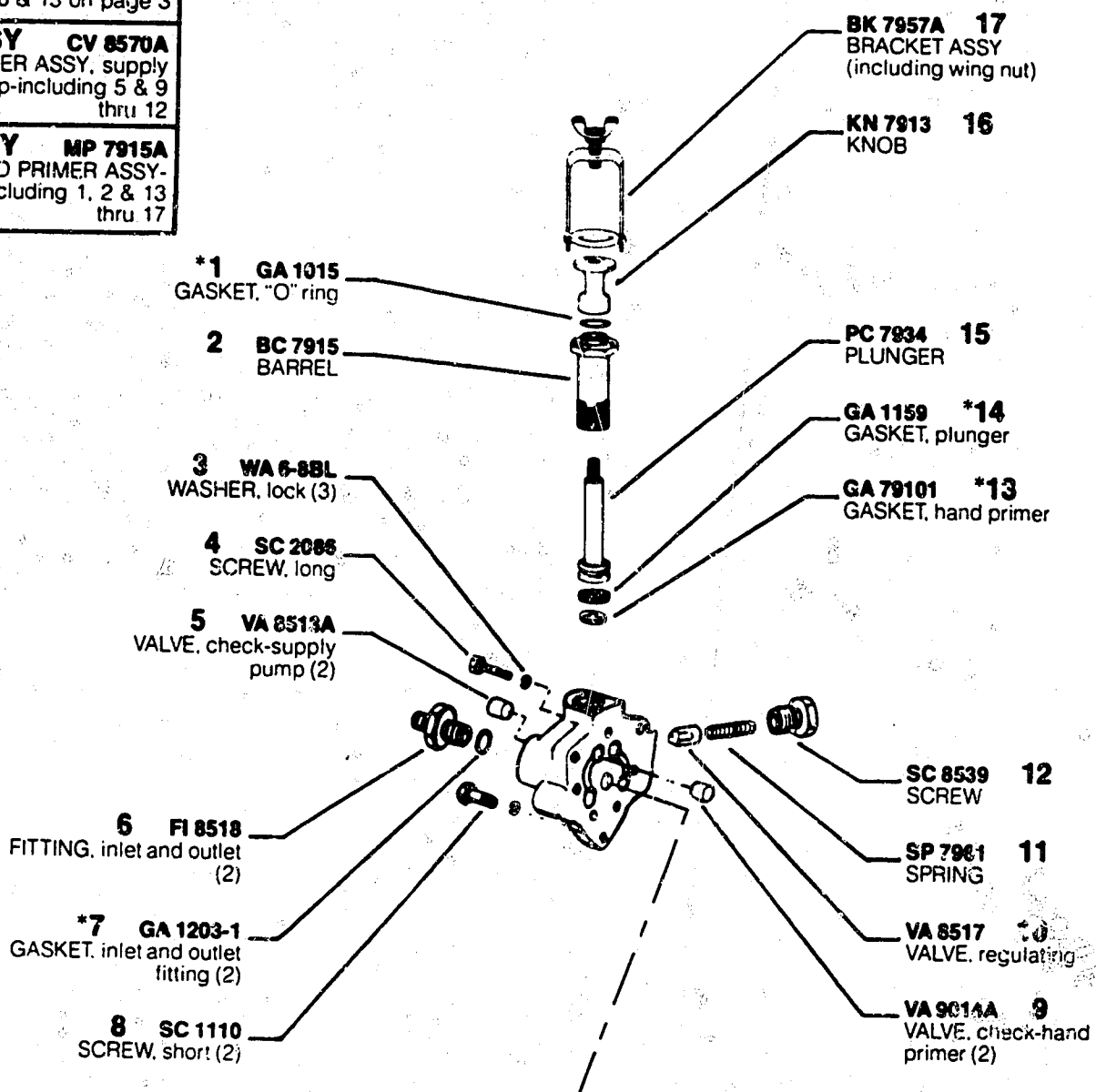

***1 GA 1015**
GASKET, "O" ring

2 BC 7915
BARREL

3 WA 6-88L
WASHER, lock (3)

4 SC 2086
SCREW, long

5 VA 8513A
VALVE, check-supply
pump (2)

6 FI 8518
FITTING, inlet and outlet
(2)

***7 GA 1203-1**
GASKET, inlet and outlet
fitting (2)

8 SC 1110
SCREW, short (2)

BK 7957A 17
BRACKET ASSY
(including wing nut)

KN 7913 16
KNOB

PC 7934 15
PLUNGER

GA 1159 *14
GASKET, plunger

GA 79101 *13
GASKET, hand primer

SC 8539 12
SCREW

SP 7961 11
SPRING

VA 8517 10
VALVE, regulating

VA 9014A 9
VALVE, check-hand
primer (2)

The descriptions are listed as shown in this example:

8	SC 1110	SCREW, short	(2)
illustration number	part number	description	quantity*

*Quantity used is one, unless otherwise indicated in parenthesis () following description of part.

MODEL 100 6A 100A 9379A & B

*Denotes parts in Repair Gasket Kit, KT 85221.

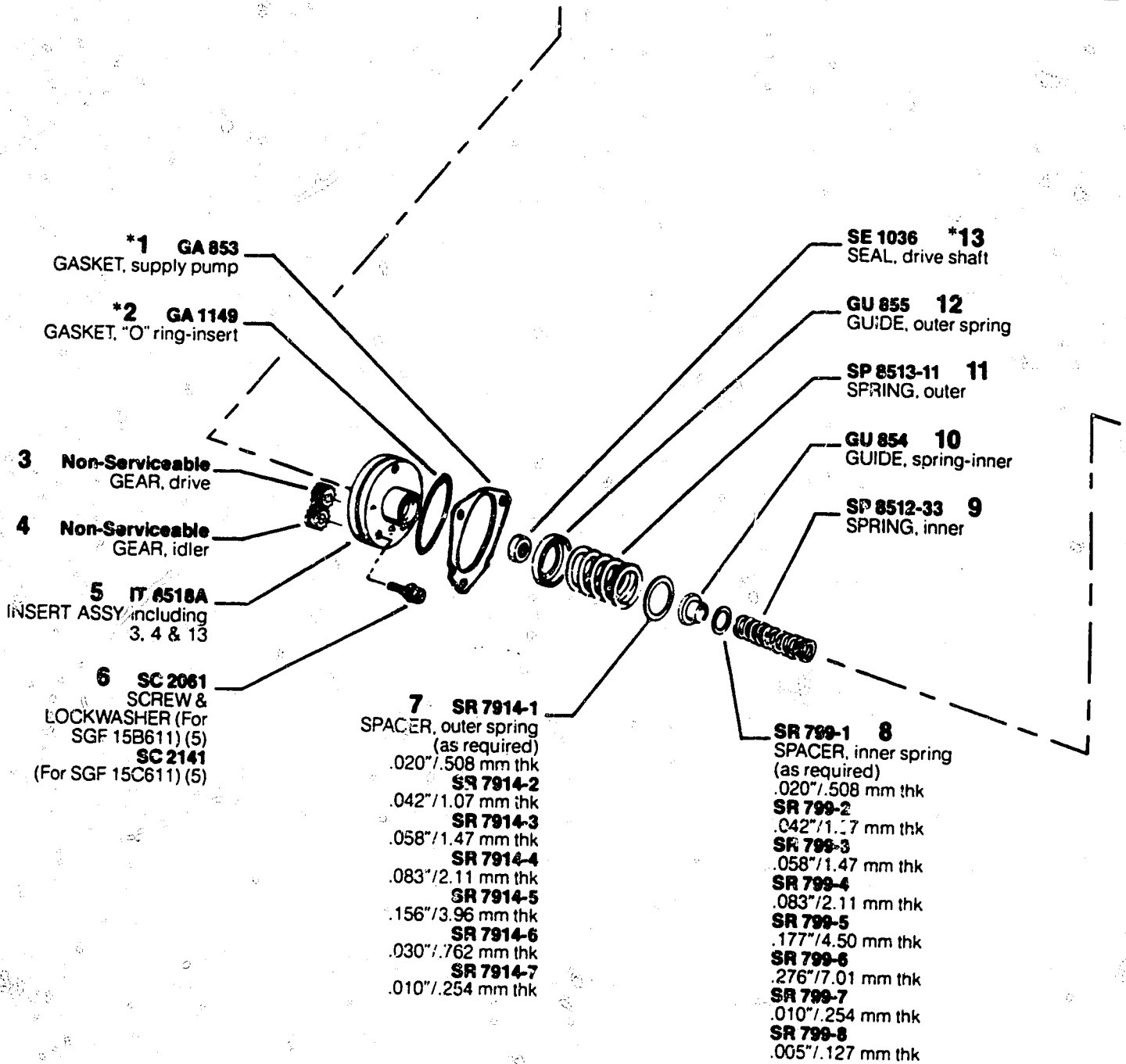

MODEL 100 6A 100A 9379A & B

*Denotes parts in Repair Gasket Kit, KT 85221

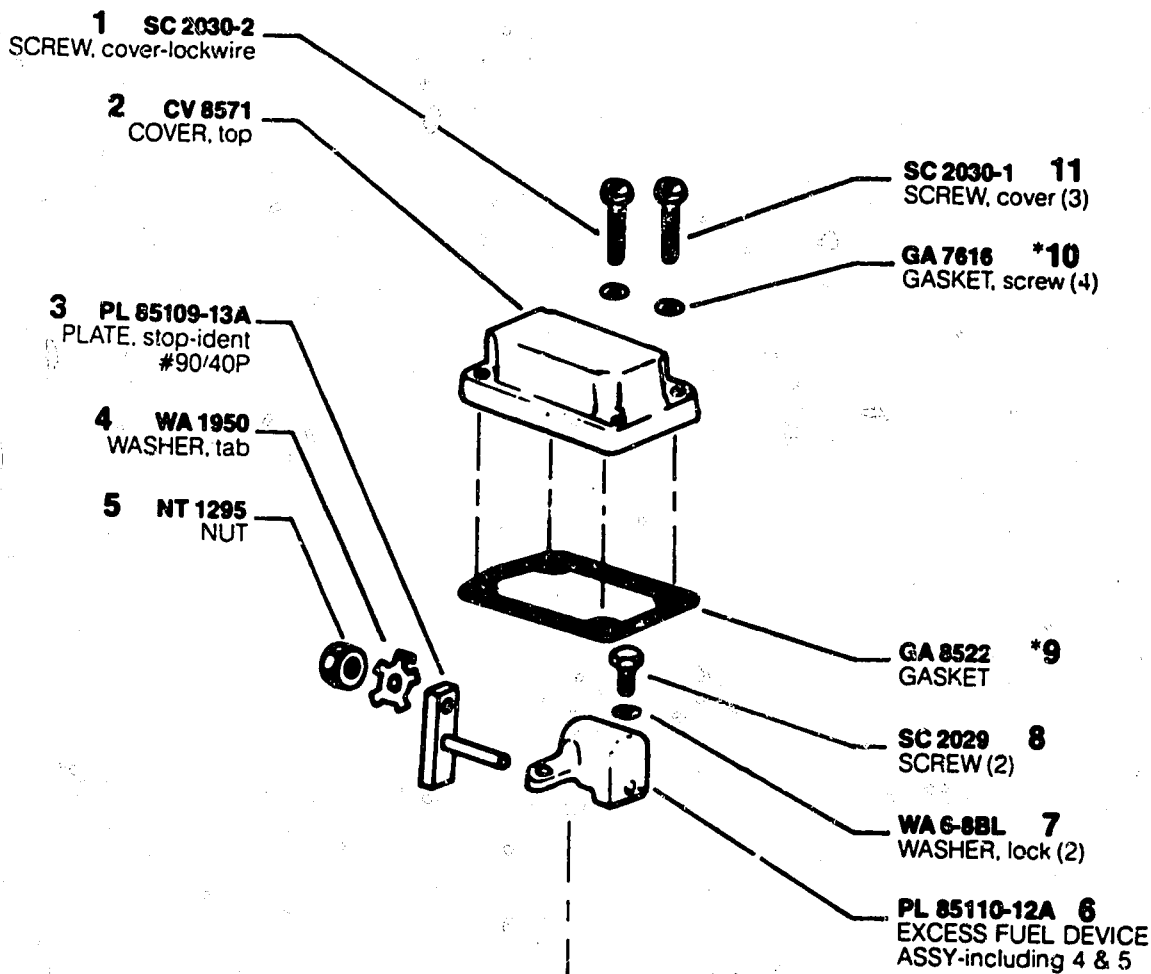

MODEL 100 6A 100A 9379A & B

*Denotes parts in Repair Gasket Kit, KT 85221.

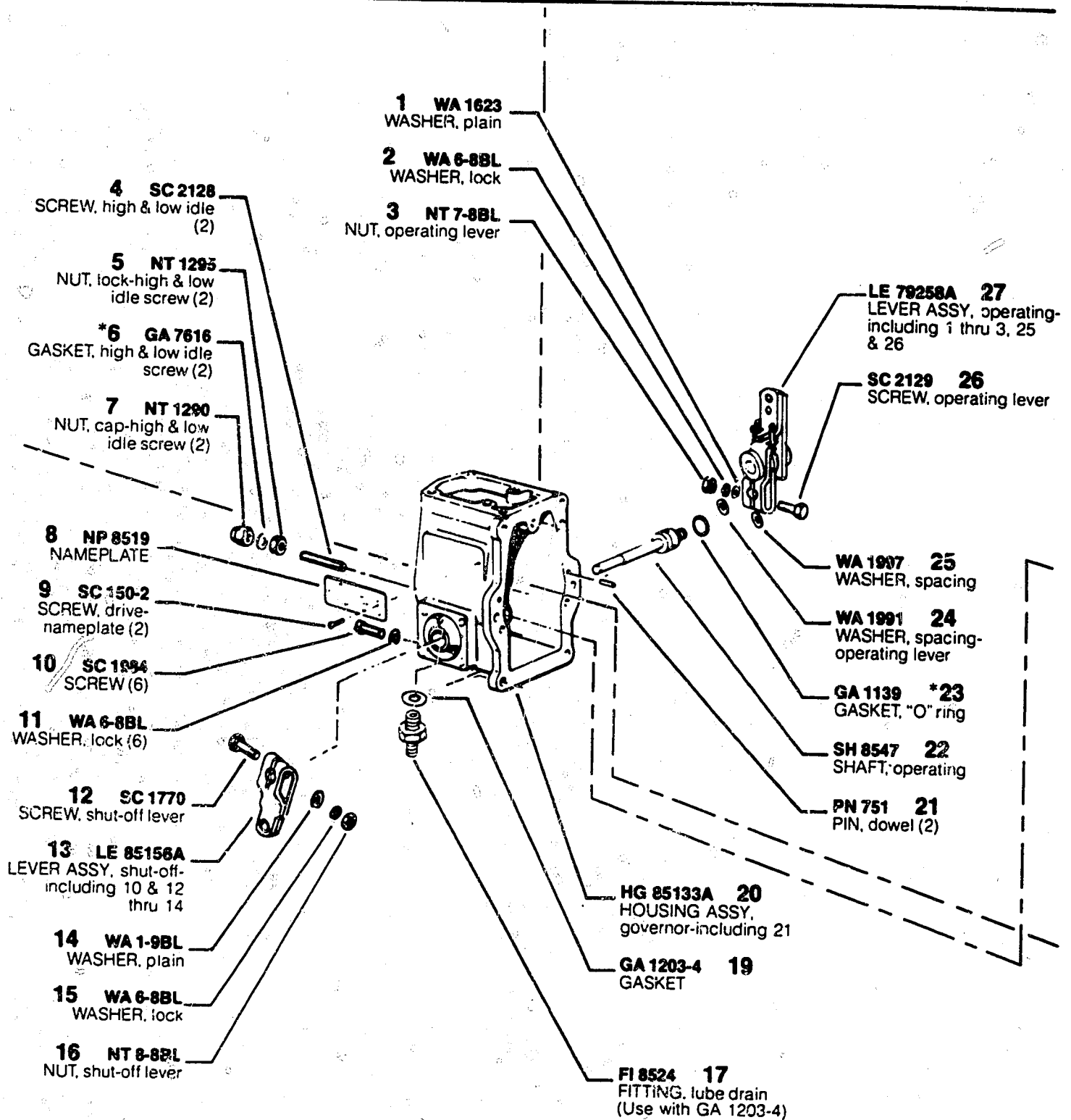

MODEL 100 6A 100A 9379A & B

*Denotes parts in Repair Gasket Kit, KT 85221.

ASSY LE 85150-3A
LEVER & ROD ASSY-
including 1 thru 6 & 13
thru 20

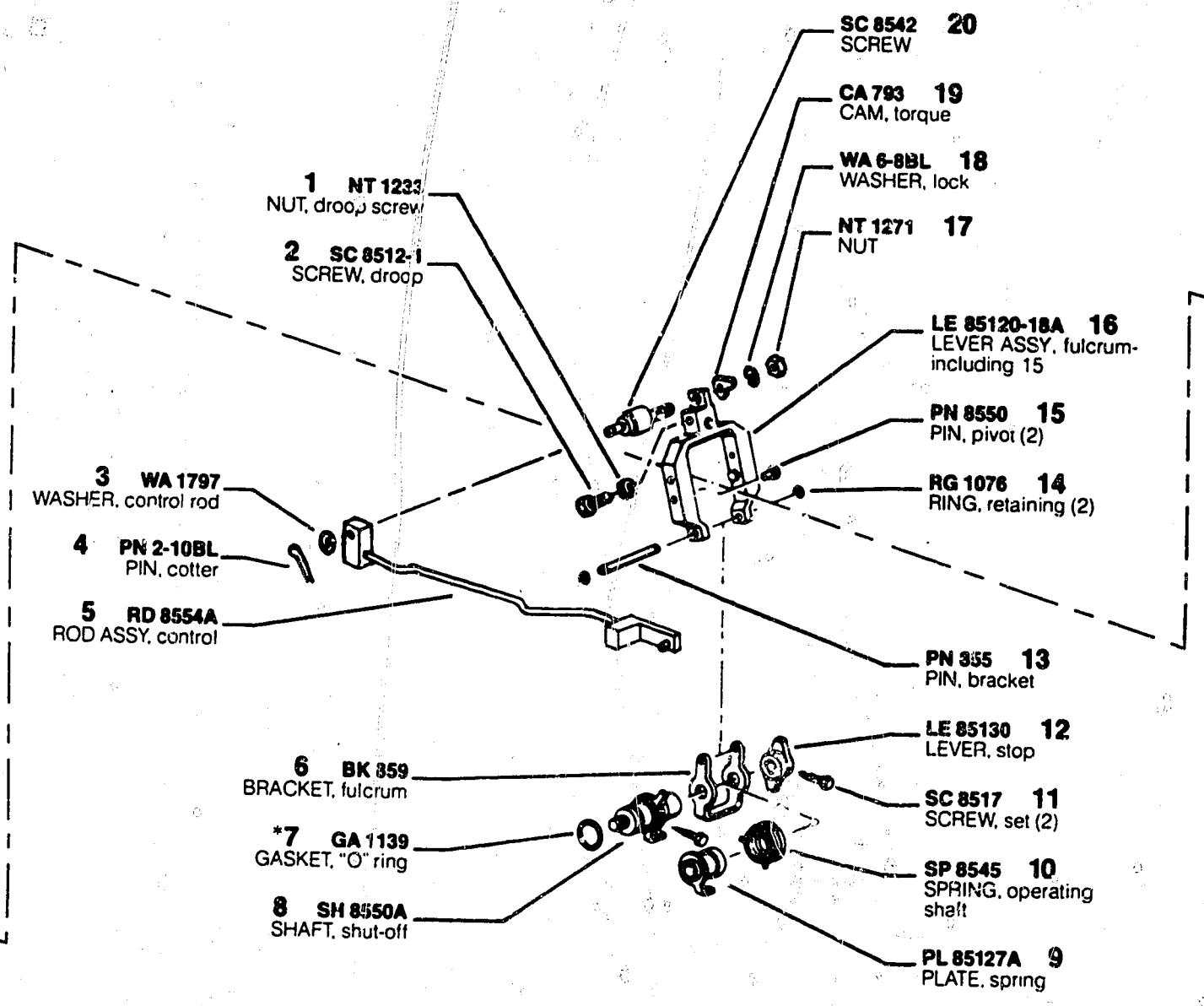

MODEL 100 6A 100A 9379A & B

*Denotes parts in Repair Gasket Kit, KT 85221.

ASSY WT 8528A
WEIGHT & SHAFT
ASSY-including 1 thru 4,
8 thru 15, 17, 20 & 21
(No longer available-
order components)

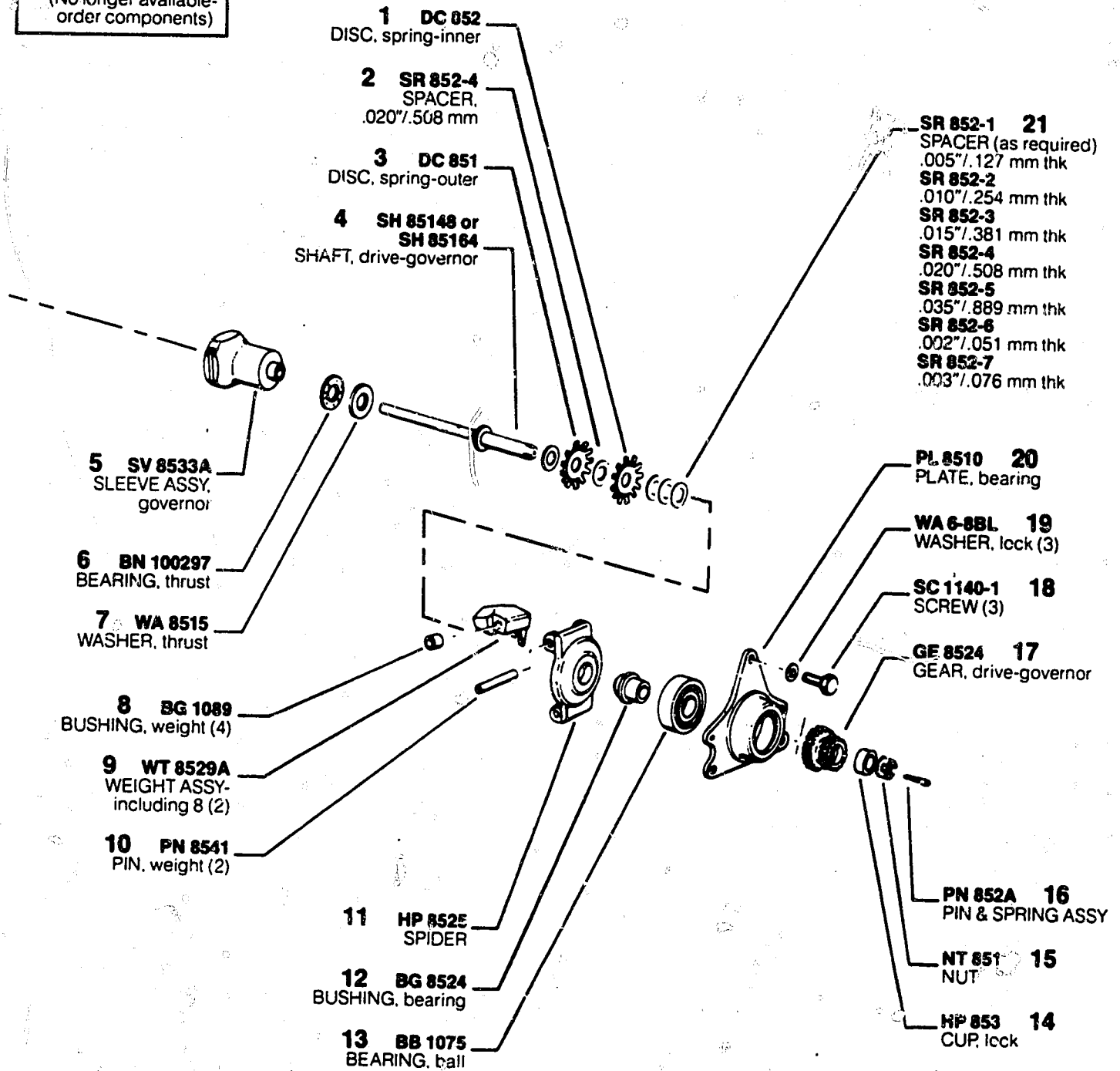

MODEL 100 6A 100A 9379A & B

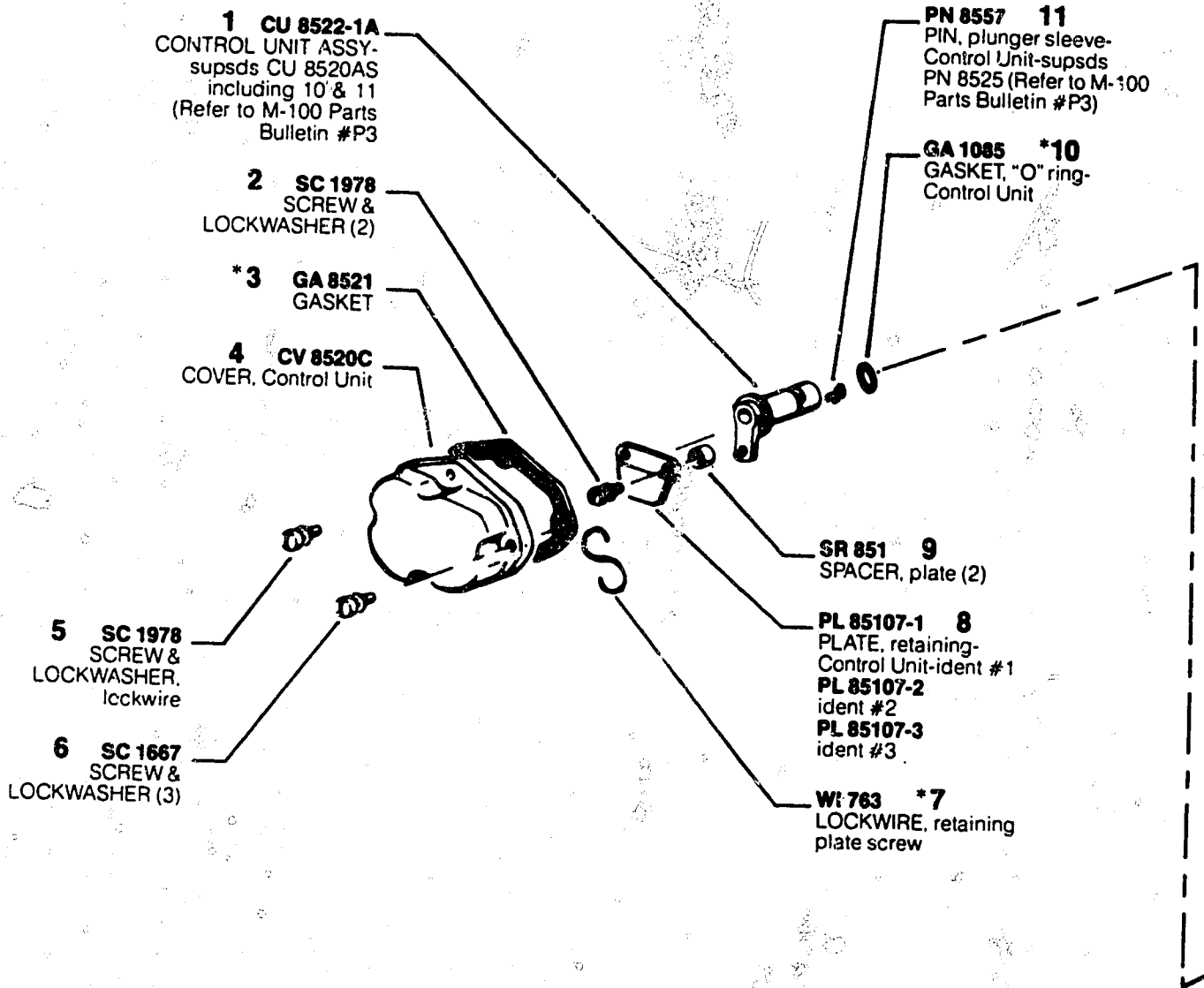

MODEL 100 6A 100A 9379A & B

* Denotes parts in Repair Gasket Kit, KT 85221.

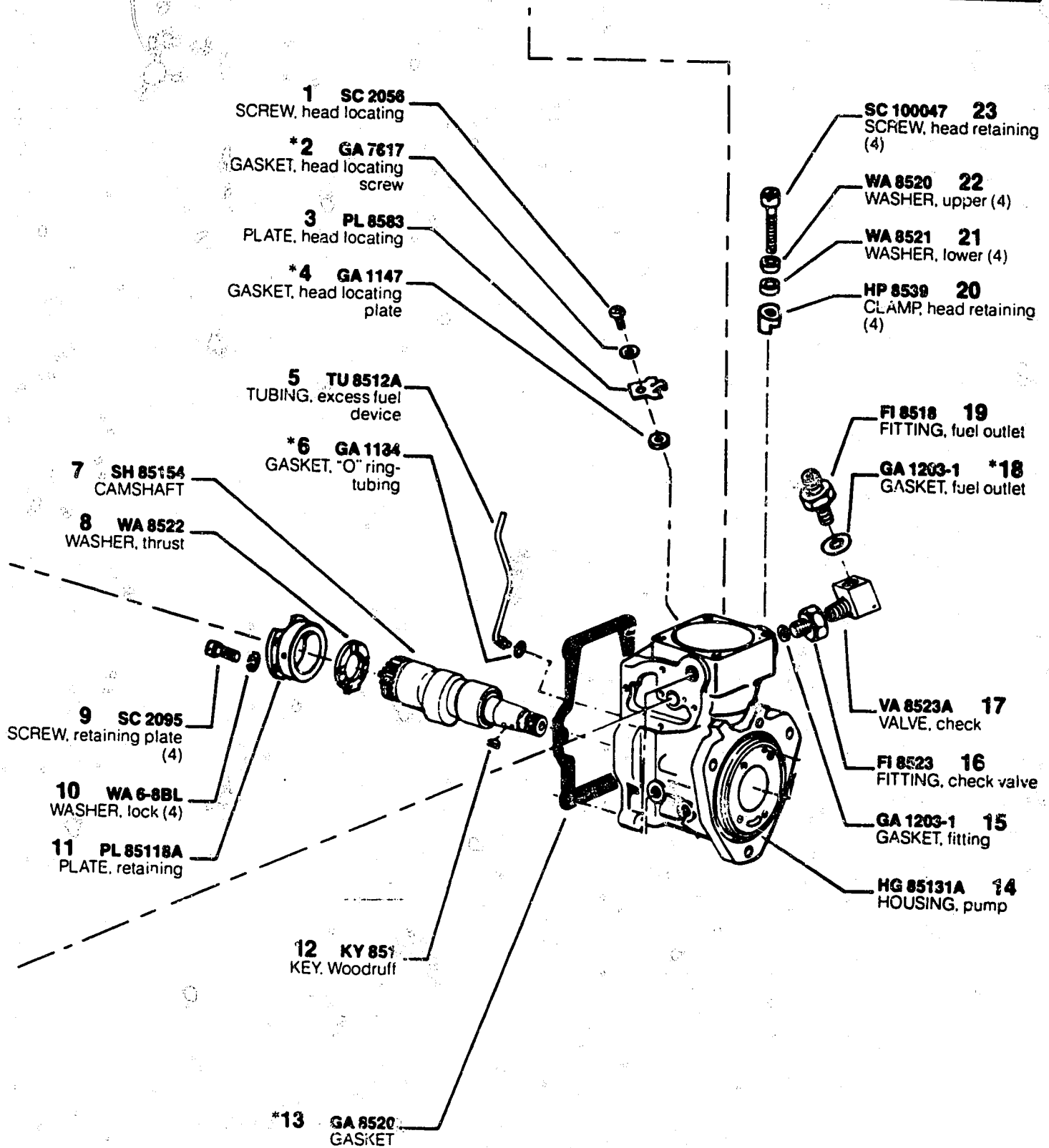

MODEL 100 6A 100A 9379A & B

*Denotes parts in Repair Gasket Kit, KT 85221.

ASSY HD 9370-S
HYDRAULIC HEAD
ASSY-includes 1 thru
13, 18 thru 27; and 10 on
page 8 - use on 9379A
HD 9427-S
use on 9379B

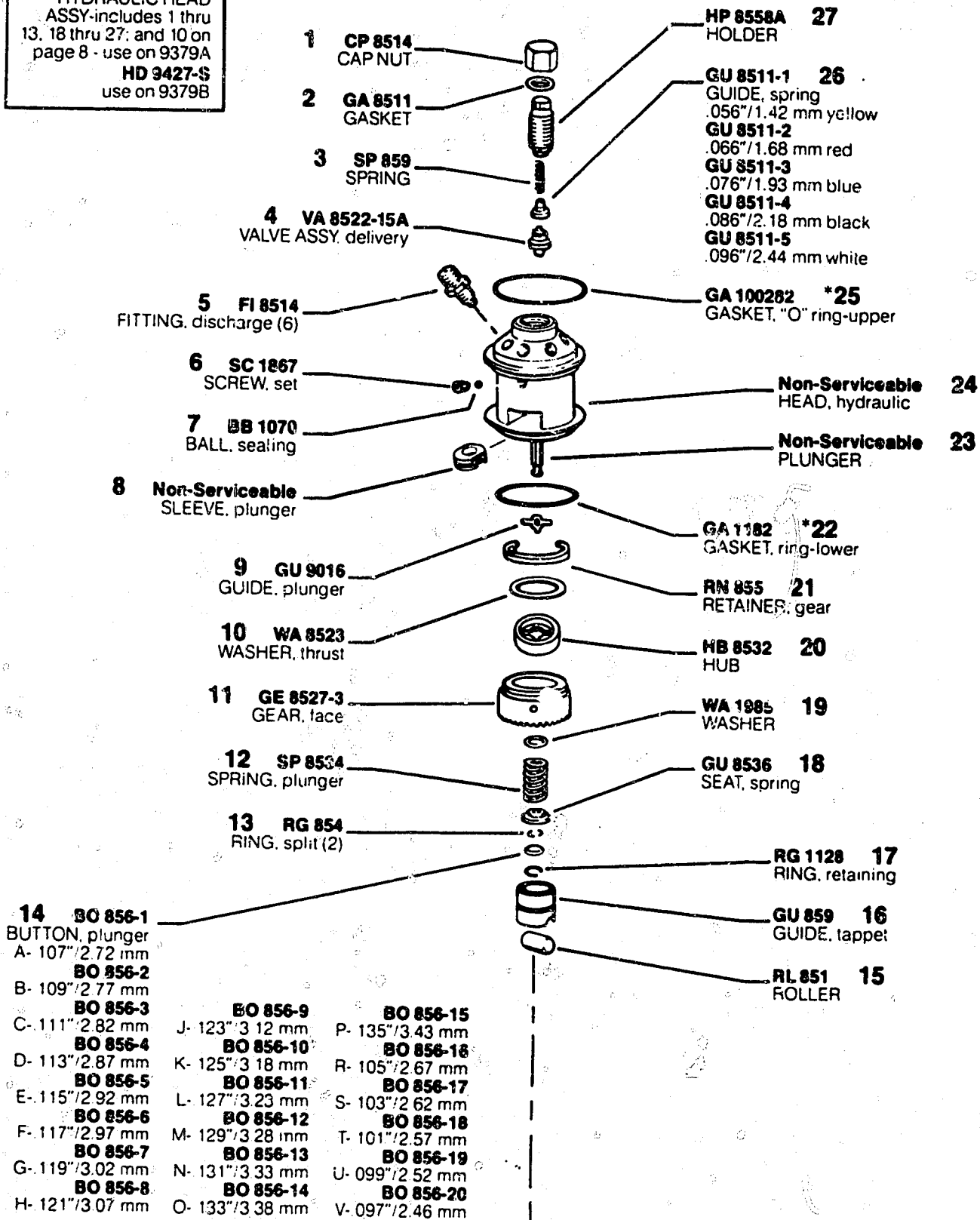

MODEL 100 6A 100A 9379A & B

*Denotes parts in Repair Kit, KT 85221.

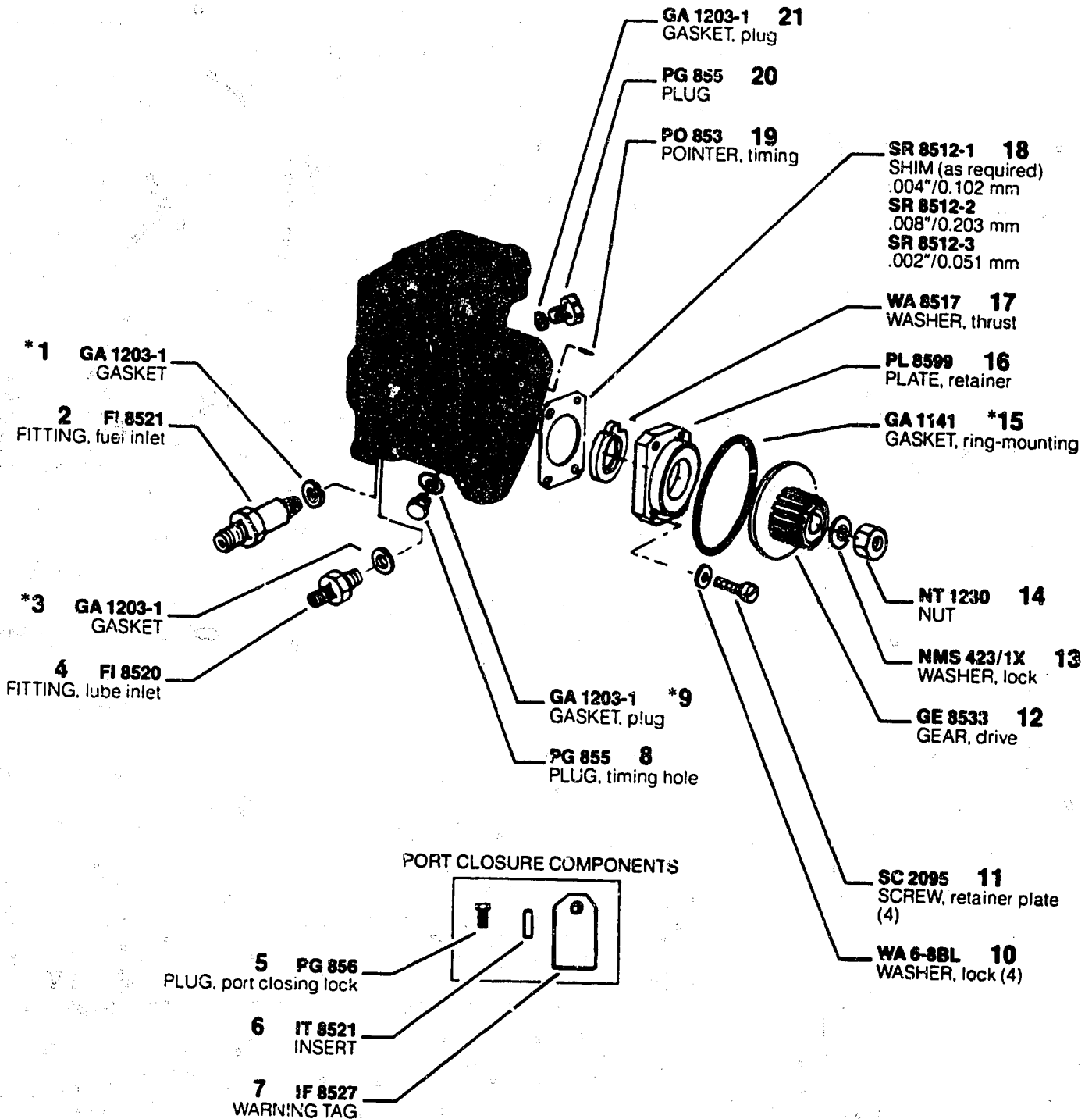

MODEL 100 6A 100A 9379A & B

*Denotes parts in Repair Gasket Kit, KT 85221.



**UNITED
TECHNOLOGIES
DIESEL SYSTEMS**

Springfield, MA 01107

CALIBRATION SET-UP

Nozzle & Holder ADN 12SD 12C nozzles with
AKB 50S 3495 or
AKB 50S 3498 holders, set at 2500 psi
opening pressure
High Pressure Tubing250" O.D. x .078" x 36" (6.35 x 1.98 x
914 mm)
Test Oil Bacharach #67-4038 (#2 diesel fuel,
ESSO #D-260) or equivalent, 100 -105 F
(38 -41 C) at pump inlet
Supply Pump Pressure 40 psi (276 KPa) min at full load
(rated speed)
Lube Oil Pressure 40 psi (276 KPa)
PROCEDURE: Refer to Service Instructions and use figures below.

12

**BRITISH LEYLAND
100 6A 100A 9379A & B**

9379A & B (Code 1)

CODE DATA

Customer No. AAU 6954
Engine Model 502V (215 BHP)
Application Bus/Truck
Governor RPM 400/2400
Inner Spring Gap 3.25 ± .25 mm
Outer Spring
Precompression 2.10 to 2.35 mm

Cam Angle (Ref)..... 68°-72°
Lift To Port Closing
Requirement032"-.039" (0.80-1.00 mm)
Delivery Valve Opening
Pressure 1150-1450 psi
(7.929-9.998 MPa)

STEP	A Full Load	B Peak Torque (from actual A delivery)	C Cam Departure	D High Speed Shut-off
RPM	2200	1600	2475	2725
DEL	*55.5	*+2.5	—	0

STEP	E Droop Screw	F Low Idle Set Point	G Starting Fuel Min Delivery
RPM	1200	400	150
DEL	*52.5	*8.0	8

*Permissible tolerances: Service Check: ± 2.5 cc
Recalibration: ± 0.5 cc

STEP A: Max variation between cyl: 4.5 cc/500 str

STEP A thru F: cc/500 str

STEP G: cc/100 str