

9399

A



**UNITED  
TECHNOLOGIES  
DIESEL SYSTEMS**

**PUMP ROTATION:**  
Counter Clockwise  
**FIRING ORDER:**  
1-5-3-6-2-4  
**MOUNTING:**  
R.H.  
**SPECIAL FEATURES:**

**BRITISH LEYLAND  
100 6A 100A 9399A**

**Special information:**

**Springfield, MA 01107**

### SERVICE PARTS

Following are all parts, part numbers, pump codes and calibrations for the Model: 100 6A 100A 9399A. The exploded view drawing below is detailed with part numbers

listed on the pages indicated. Refer to the Index Section for explanations of codes and abbreviations.

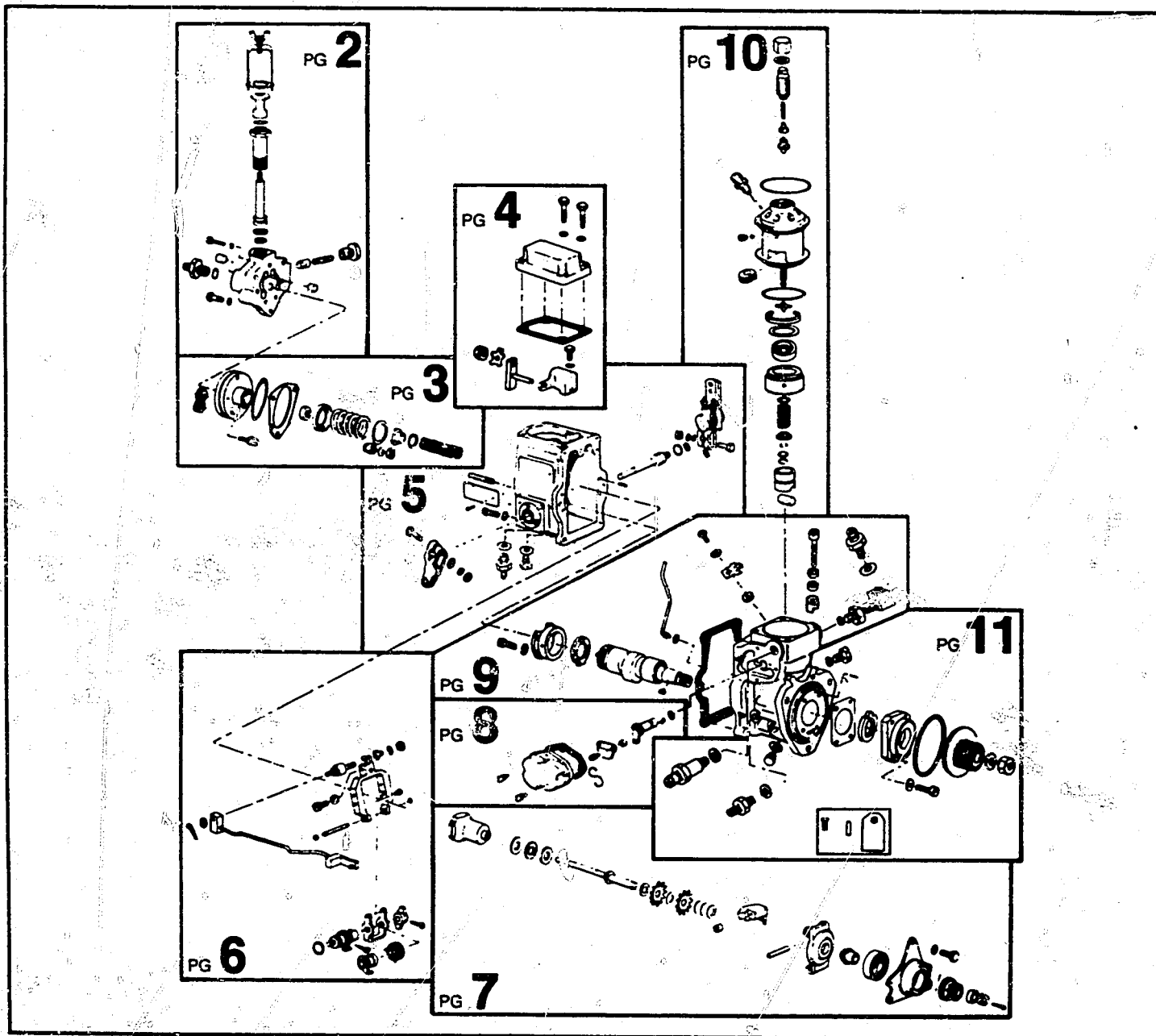

# MODEL 100 6A 100A 9399A

**ASSY SGF 15C811**  
PUMP ASSY, supply-  
including 5 thru 7, cover,  
9 thru 12; and 1 thru 3,  
5, 6 & 13 on page 3

**ASSY CV 8570A**  
COVER ASSY, supply  
pump-including 5 & 9  
thru 12

**ASSY MP 7915A**  
HAND PRIMER ASSY-  
including 1, 2 & 13  
thru 17

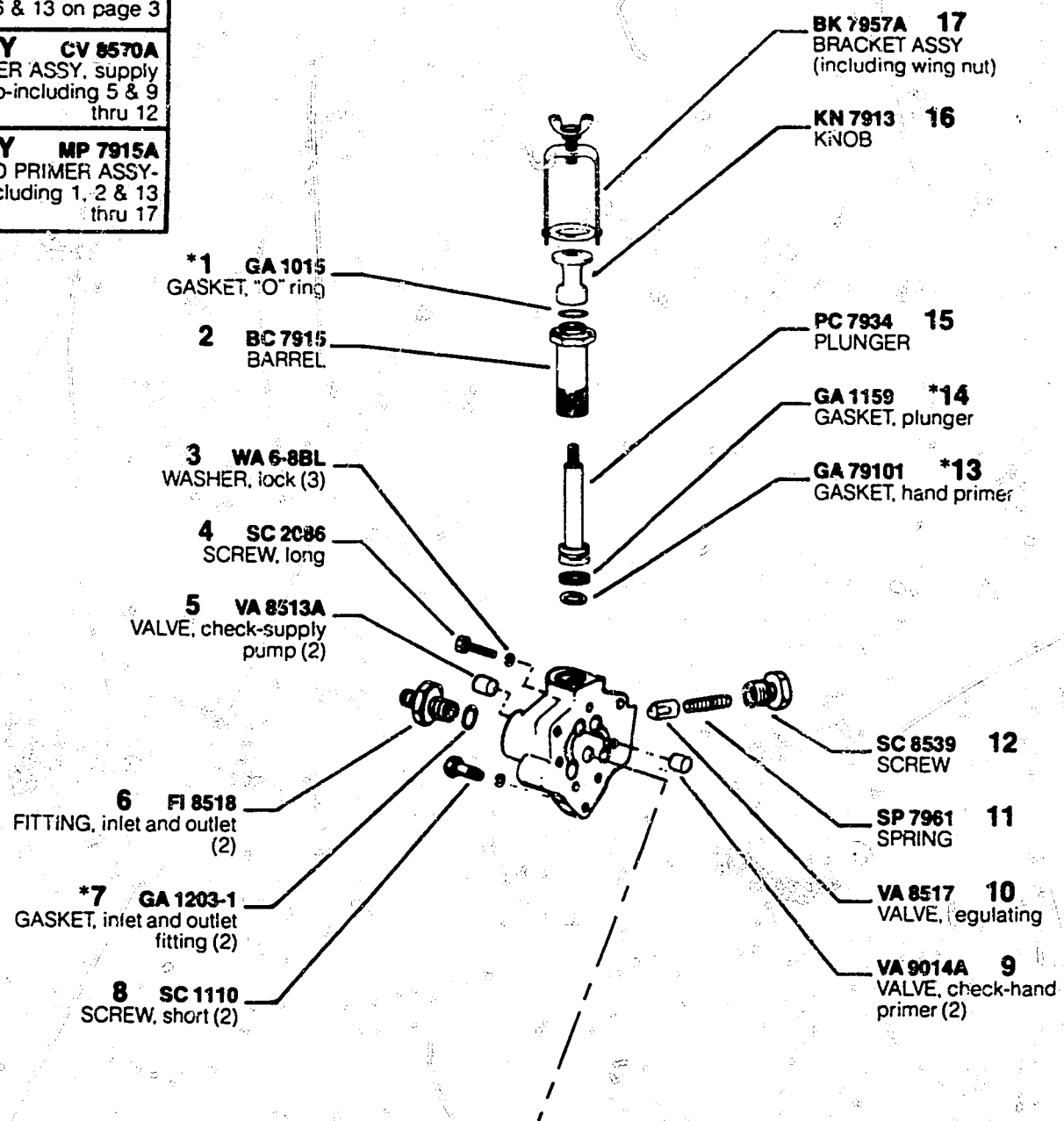

**\*1 GA 1015**  
GASKET, "O" ring

**2 BC 7915**  
BARREL

**3 WA 6-8BL**  
WASHER, lock (3)

**4 SC 2086**  
SCREW, long

**5 VA 8513A**  
VALVE, check-supply  
pump (2)

**6 FI 8518**  
FITTING, inlet and outlet  
(2)

**\*7 GA 1203-1**  
GASKET, inlet and outlet  
fitting (2)

**8 SC 1110**  
SCREW, short (2)

**BK 7957A 17**  
BRACKET ASSY  
(including wing nut)

**KN 7913 16**  
KNOB

**PC 7934 15**  
PLUNGER

**GA 1159 \*14**  
GASKET, plunger

**GA 79101 \*13**  
GASKET, hand primer

**SC 8539 12**  
SCREW

**SP 7961 11**  
SPRING

**VA 8517 10**  
VALVE, egulating

**VA 9014A 9**  
VALVE, check-hand  
primer (2)

The descriptions are listed as shown in this example:

Illustration number	part number	description	quantity*
8	SC 1110	SCREW, short	(2)

\*Quantity used is one, unless otherwise indicated in parenthesis ( ) following description of part.

# MODEL 100 6A 100A 9399A

\*Denotes parts in Repair Gasket Kit, KT 85221.

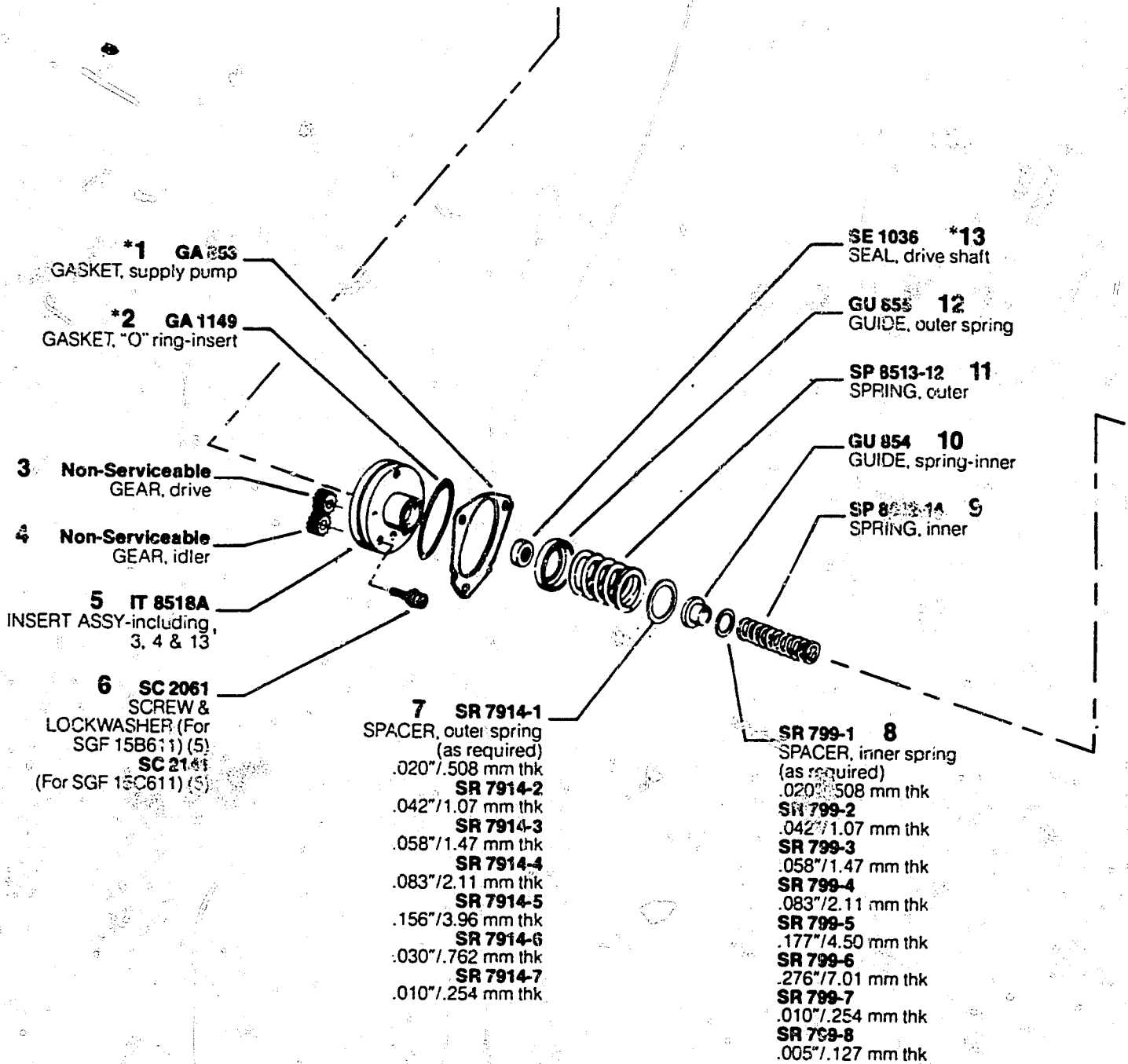

# MODEL 100 6A 100A 9399A

\*Denotes parts in Repair Gasket Kit, KT 85221

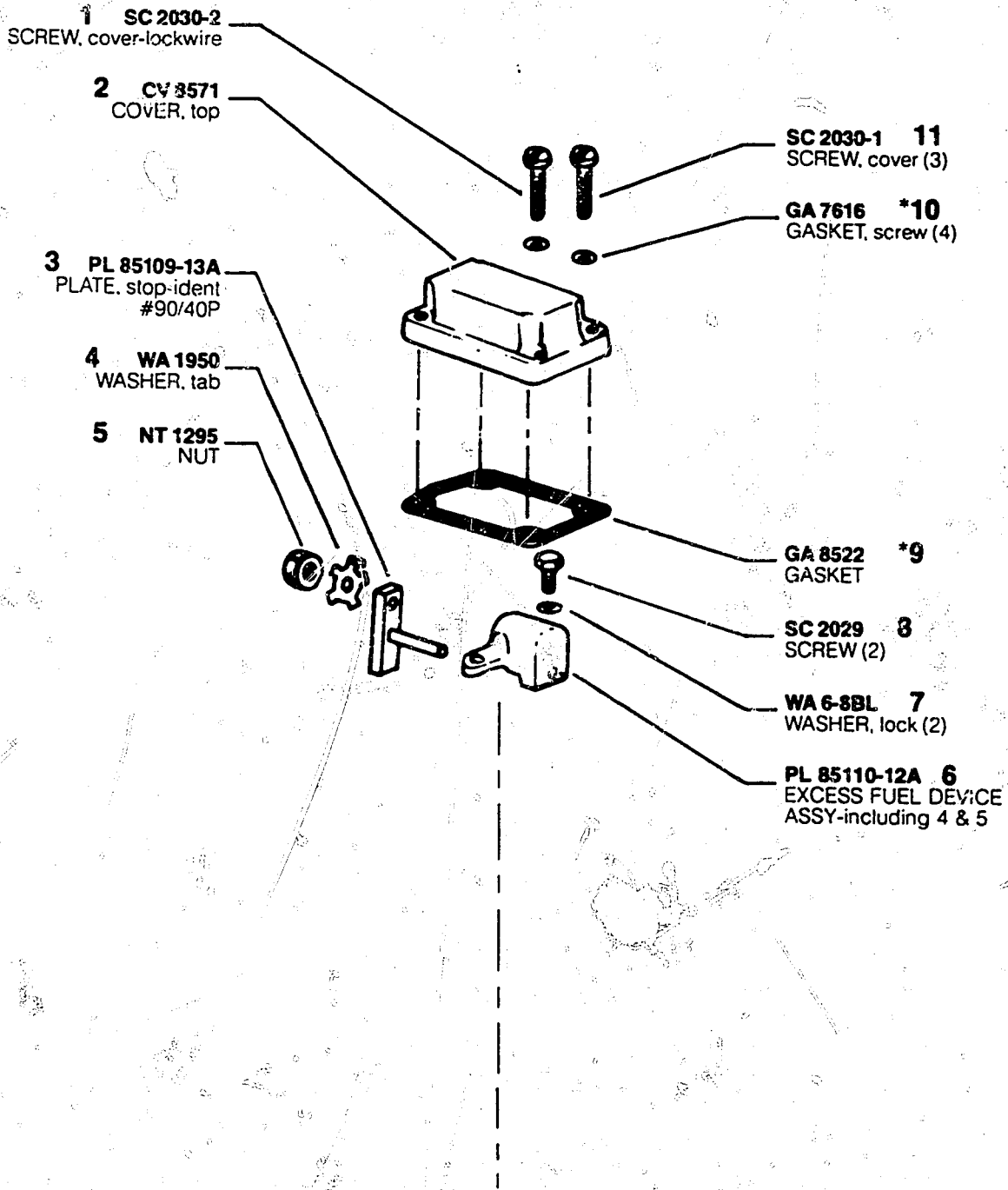

# MODEL 100 6A 100A 9399A

\*Denotes parts in Repair Gasket Kit, KT 85221

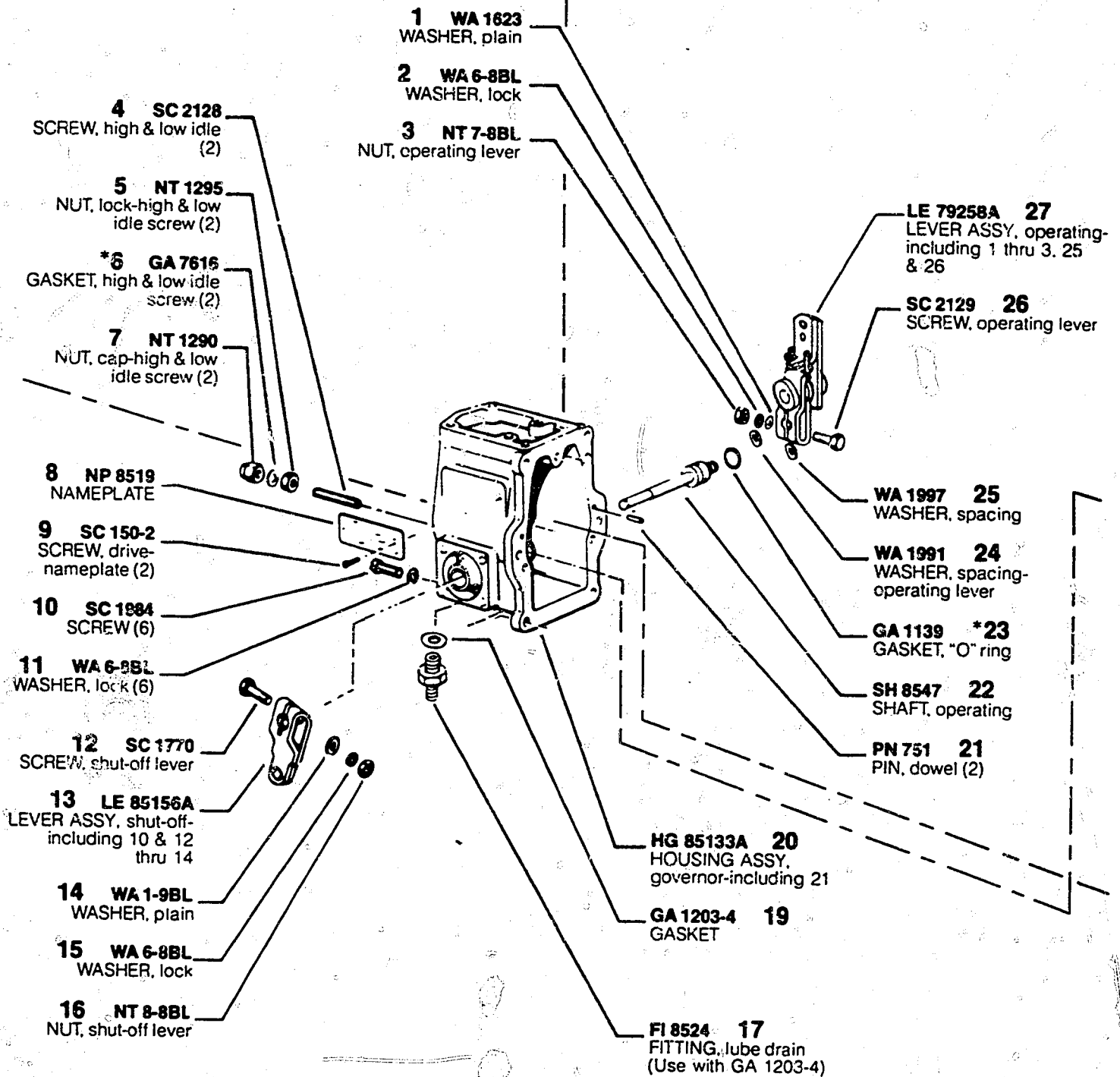

# MODEL 100 6A 100A 9399A

\*Denotes parts in Repair Gasket Kit, KT 85221.

**ASSY LE 85158-3A**  
LEVER & ROD ASSY-  
including 1 thru 6 & 13  
thru 20

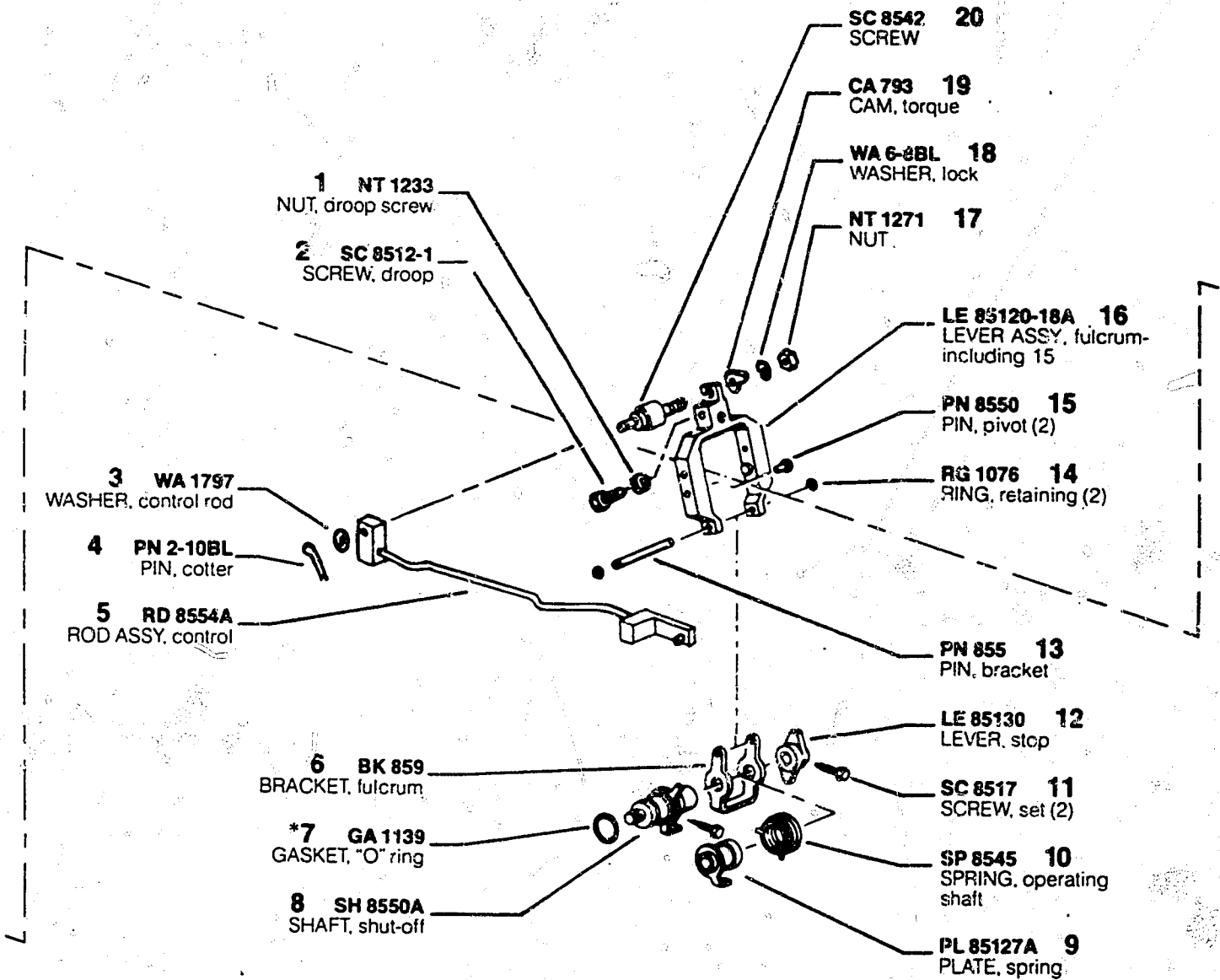

# MODEL 100 6A 100A 9399A

\*Denotes parts in Repair Gasket Kit, KT 85221.

**ASSY WT 8528A**  
WEIGHT & SHAFT  
ASSY-including 1 thru 4,  
8 thru 15, 17, 20 & 21  
(No longer available-  
order components)

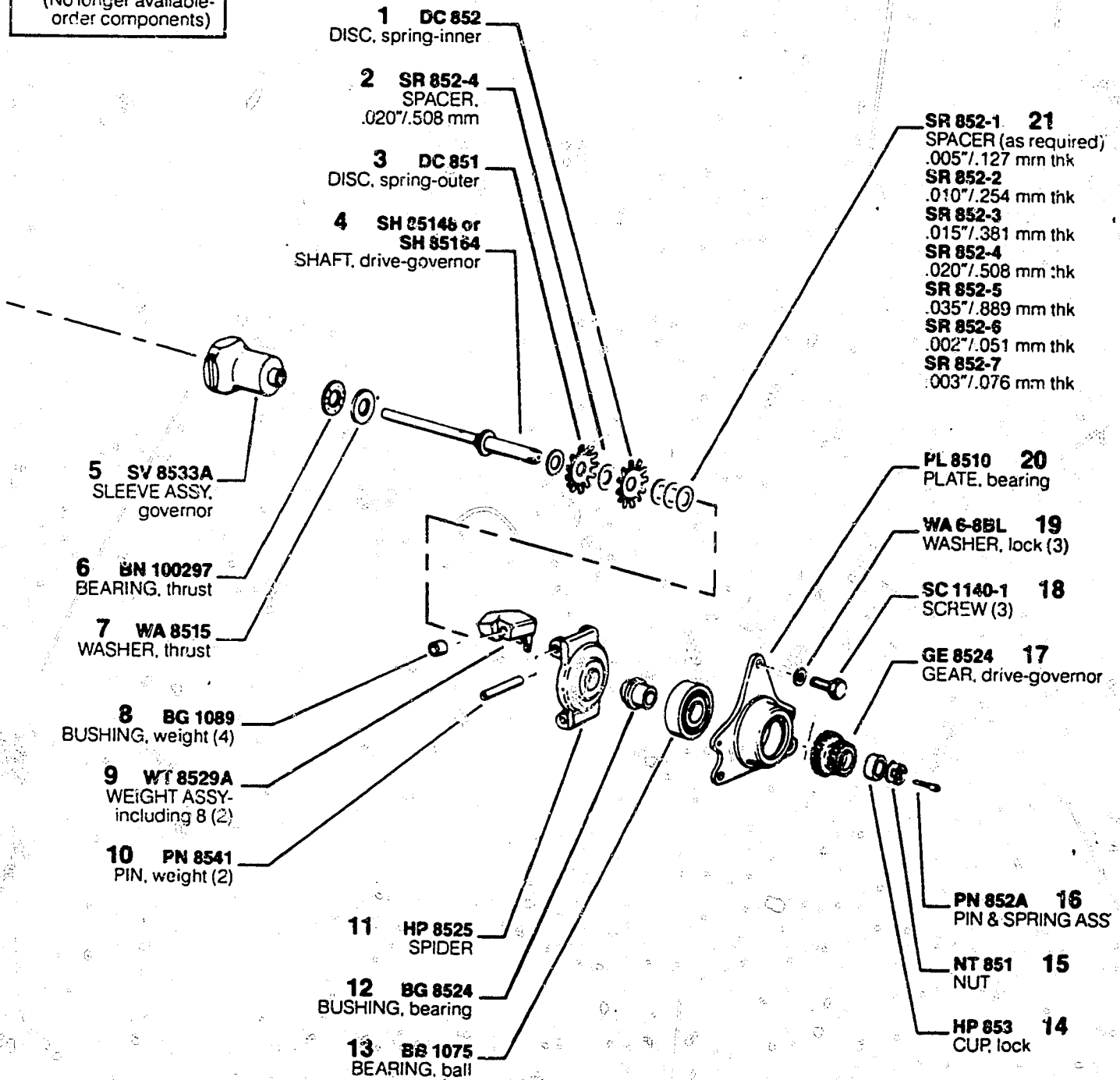

**MODEL 100 6A 100A 9399A**

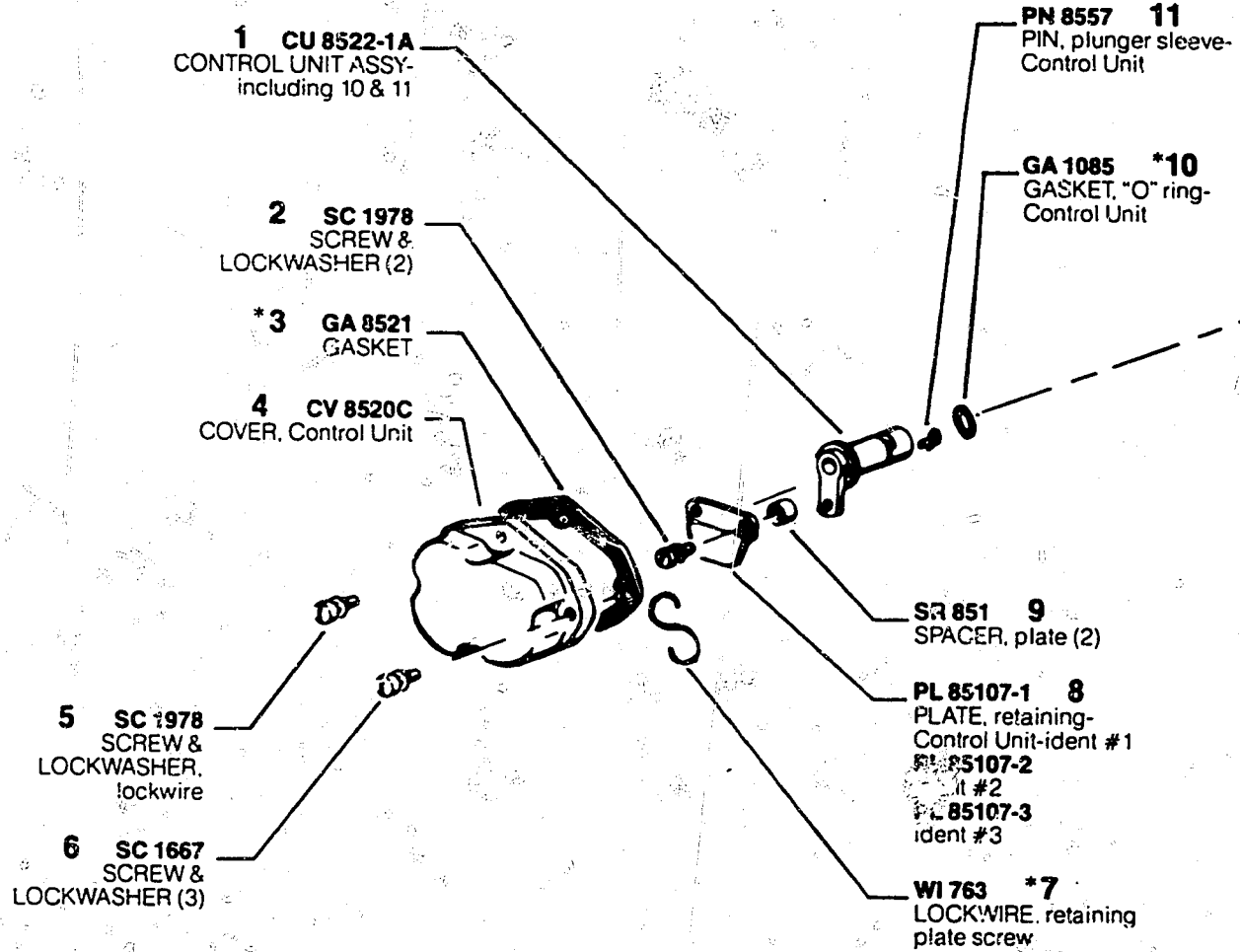

# MODEL 100 6A 100A 9399A

\*Denotes parts in Repair Gasket Kit, KT 85221

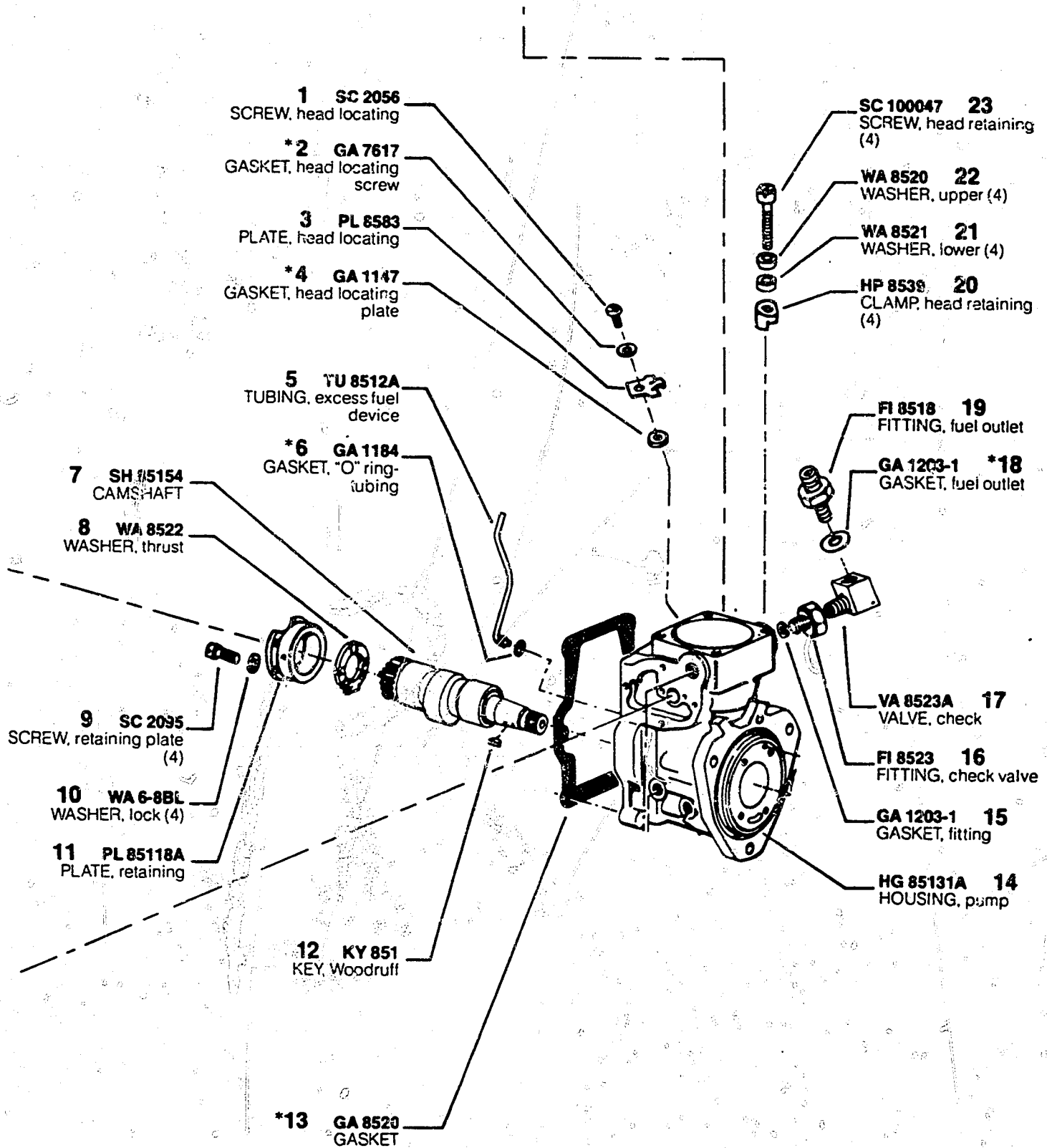

# MODEL 100 6A 100A 9399A

\*Denotes parts in Repair Gasket Kit, KT 85221.

**ASSY HD 9427-S**  
HYDRAULIC HEAD  
ASSY-includes 1 thru  
13, 18 thru 27; and 10 on  
page 8

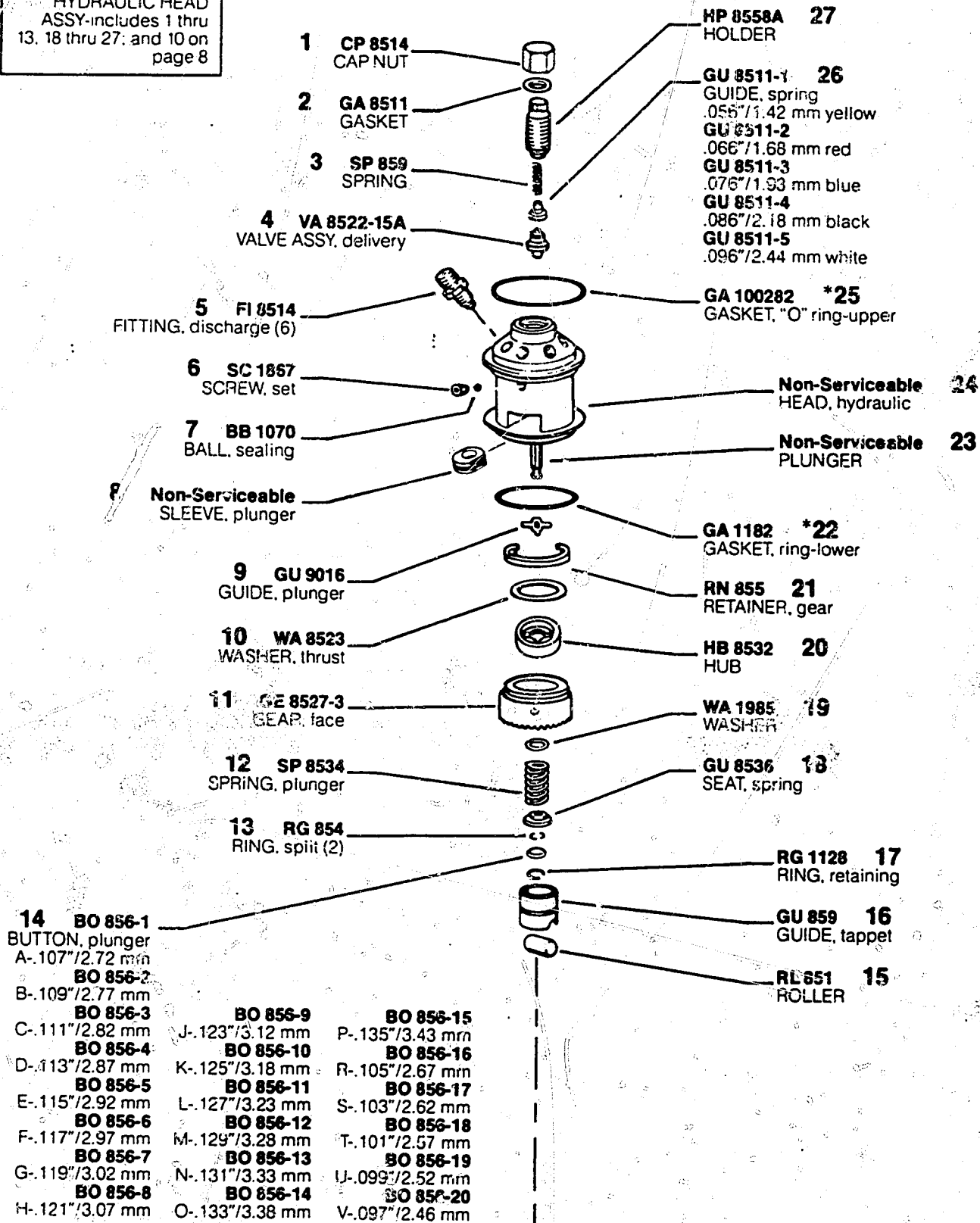

# MODEL 100 6A 100A 9399A

\*Denotes parts in Repair Kit, KT 85221.

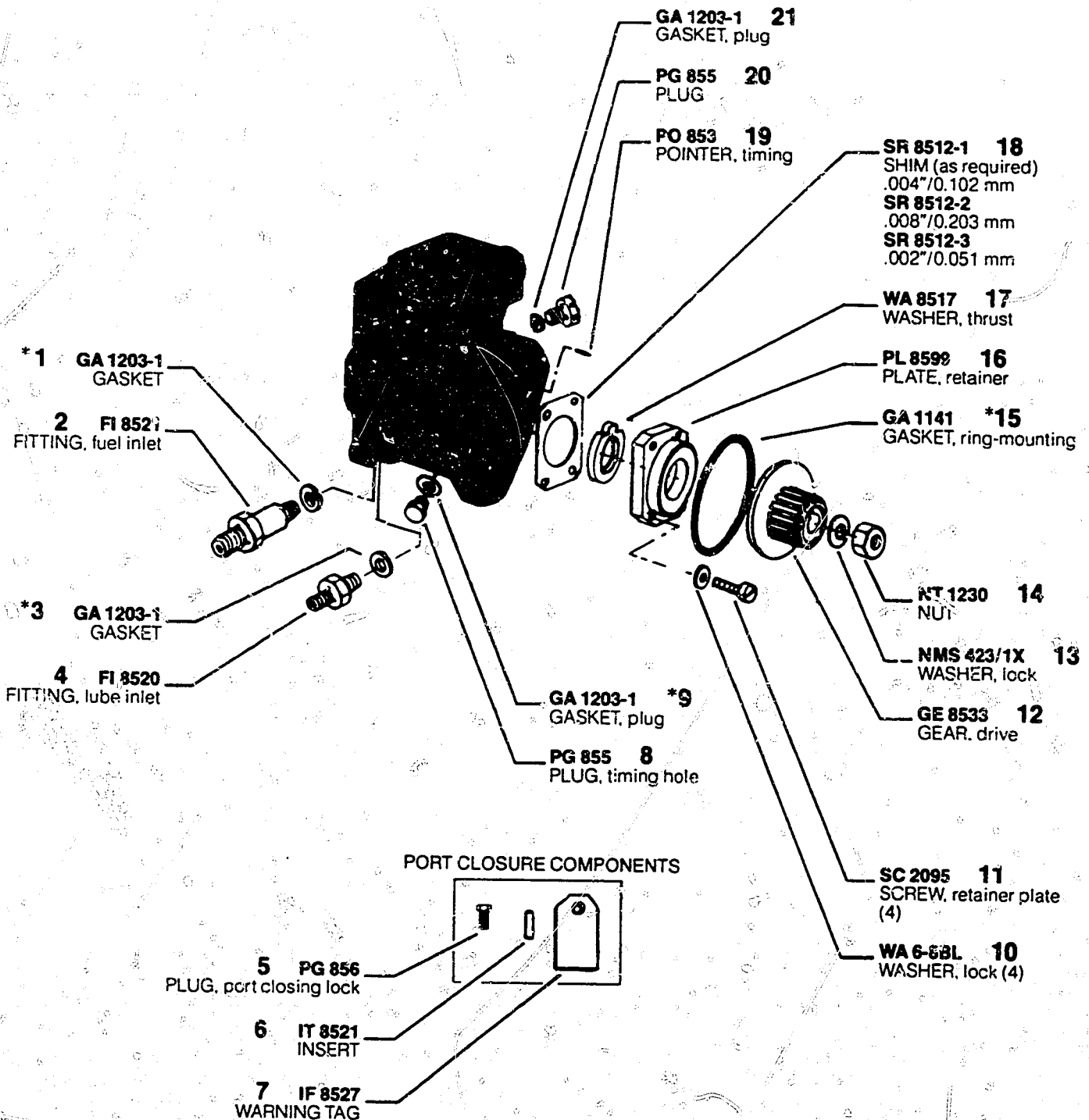

# MODEL 100 6A 100A 9399A

\*Denotes parts in Repair Gasket Kit, KT 85221.



**UNITED  
TECHNOLOGIES  
DIESEL SYSTEMS**

**CALIBRATION SET-UP**  
 Nozzle & Holder ..... ADN 12SD 12C nozzles with  
 AKB 50S 3495 or  
 AKB 50S 3496 holders, set at 2500 psi  
 opening pressure  
 High Pressure Tubing . . . 2.50" O.D. x .078" x 36" (6.35 x 1.98 x  
 914 mm)  
 Test Oil ..... Bacharach #57-4036 (#2 diesel fuel,  
 ESSO #D-260) or equivalent, 100 -105 F  
 (38 -41 C) at pump inlet  
 Supply Pump Pressure . . . 40 psi (276 KPa) min at full load  
 (rated speed)  
 Lube Oil Pressure ..... 40 psi (276 KPa)  
 PROCEDURE: Refer to Service Instructions and use figures below.

12

**BRITISH LEYLAND  
100 6A 100A 9399A**

**Springfield, MA 01107**

9399A (Code 1)

**CODE DATA**

Customer No. .... AAU 6954  
 Engine Model ..... 502V (215 BHP)  
 Application ..... Bus/Truck  
 Governor RPM ..... 400/2400  
 Inner Spring Gap ..... 3.25 ± .25 mm  
 Outer Spring  
 Precompression ..... 1.0 ± .25 mm

Cam Angle (Ref)..... 68°-72°  
 Lift To Port Closing  
 Requirement ..... .032"-.039" (0.80-1.00 mm)  
 Delivery Valve Opening  
 Pressure ..... 1150-1450 psi  
 (7.929-9.998 MPa)

STEP	A	B	C	D
	Full Load	Peak Torque (from actual A delivery)	Cam Departure	High Speed Shut-off
RPM	<b>2200</b>	<b>1600</b>	<b>2475</b>	<b>2725</b>
DEL	<b>*55.5</b>	<b>*+2.5</b>	<b>—</b>	<b>0</b>

STEP	E	F	G
	Droop Screw	Low Idle Set Point	Starting Fuel Min Delivery
RPM	<b>1200</b>	<b>400</b>	<b>150</b>
DEL	<b>*52.5</b>	<b>*8.0</b>	<b>8</b>

\*Permissible tolerances: Service Check: ± 2.5 cc  
 Recalibration: ± 0.5 cc  
 STEP A: Max variation between cyl: 4.5 cc/500 str  
 STEP A thru F: cc/500 str  
 STEP G: cc/100 str