

9412

A thru D

PUMP ROTATION:
Clockwise
FIRING ORDER:
1-5-3-6-2-4
MOUNTING:
L.H.
SPECIAL FEATURES:
Vertical Bowden Wire Shut-off, Puff Limiter Excess Fuel Device, Dual Range Inravance® Camshaft Assy

Special Information:

SERVICE PARTS

Following are all parts, part numbers, pump codes and calibrations for the *Model: 100 6A 100A 9412*. The exploded view drawing below is detailed with part

numbers listed on the pages indicated. Refer to the Index Section for explanations of codes and abbreviations.

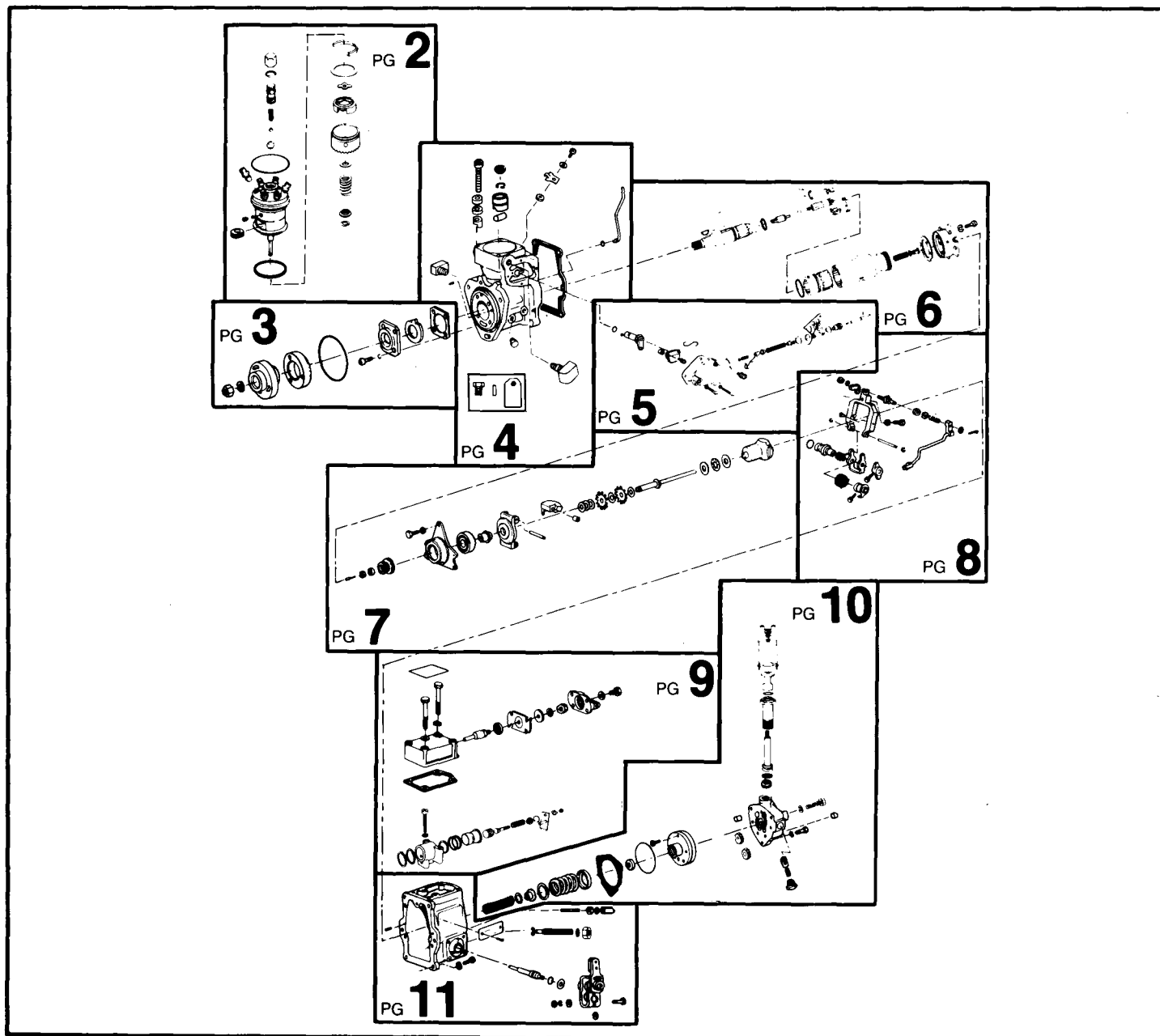

MODEL 100 6A 100A 9412

ASSY HD 9423-S
10MM HYDRAULIC
HEAD ASSY-
including 1 thru 23; and
3 on page 5

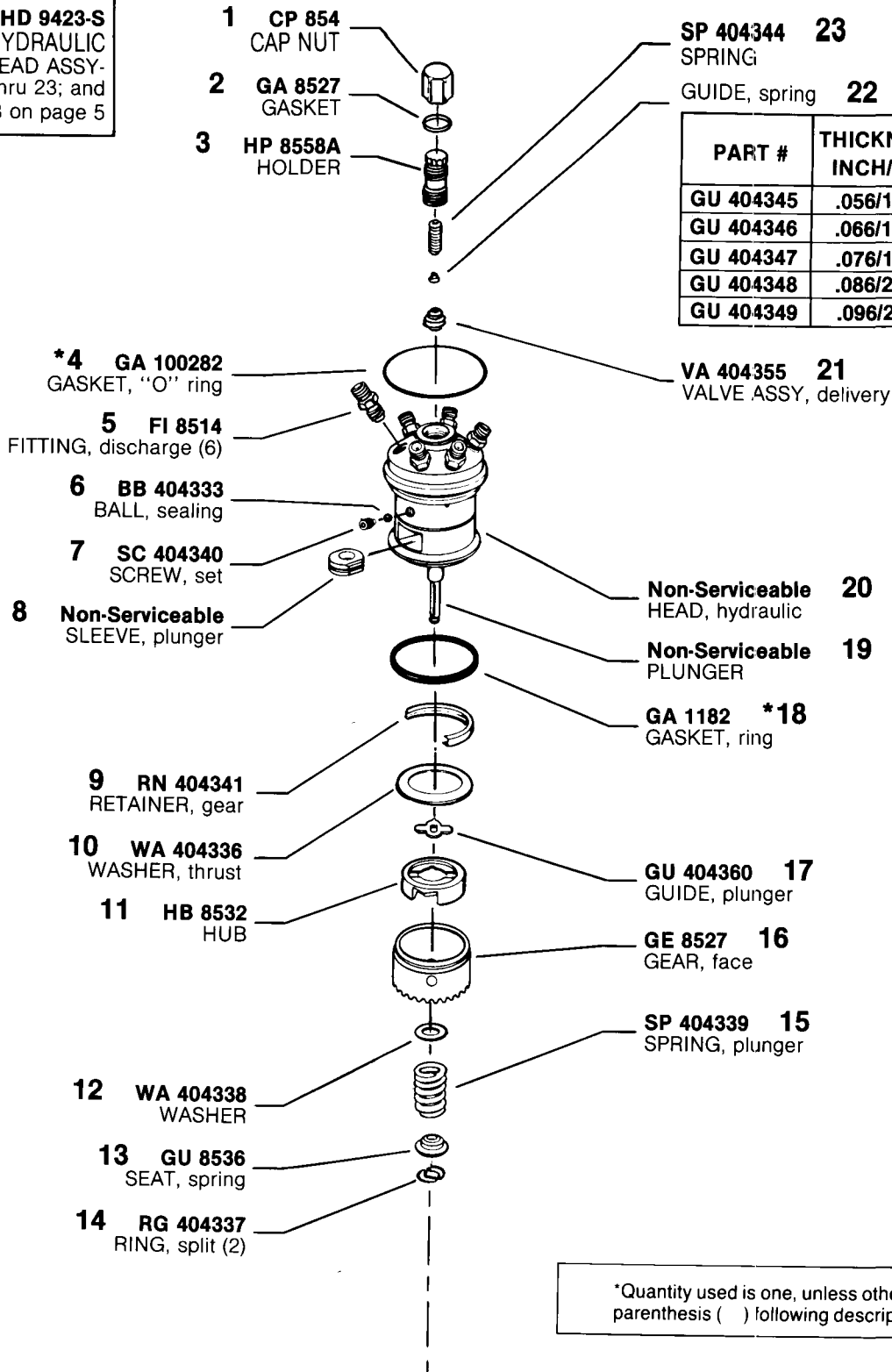

*Quantity used is one, unless otherwise indicated in parenthesis () following description of part.

MODEL 100 6A 100A 9412

*Denotes parts in Repair Gasket Kit, KT 85195.

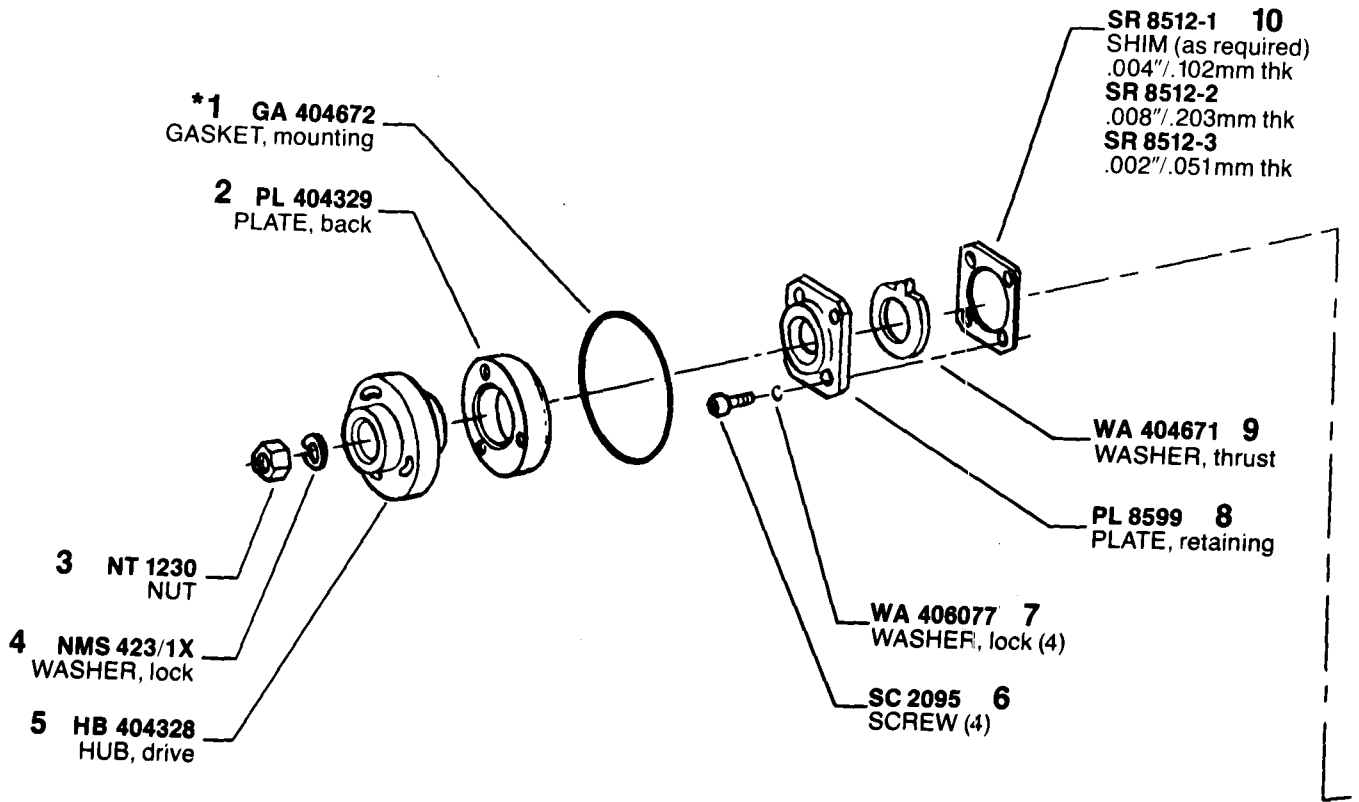

MODEL 100 6A 100A 9412

*Denotes parts in Repair Gasket Kit, KT 85195.

876

MODEL 100 6A 100A 9412

*Denotes parts in Repair Gasket Kit, KT 85195.

876

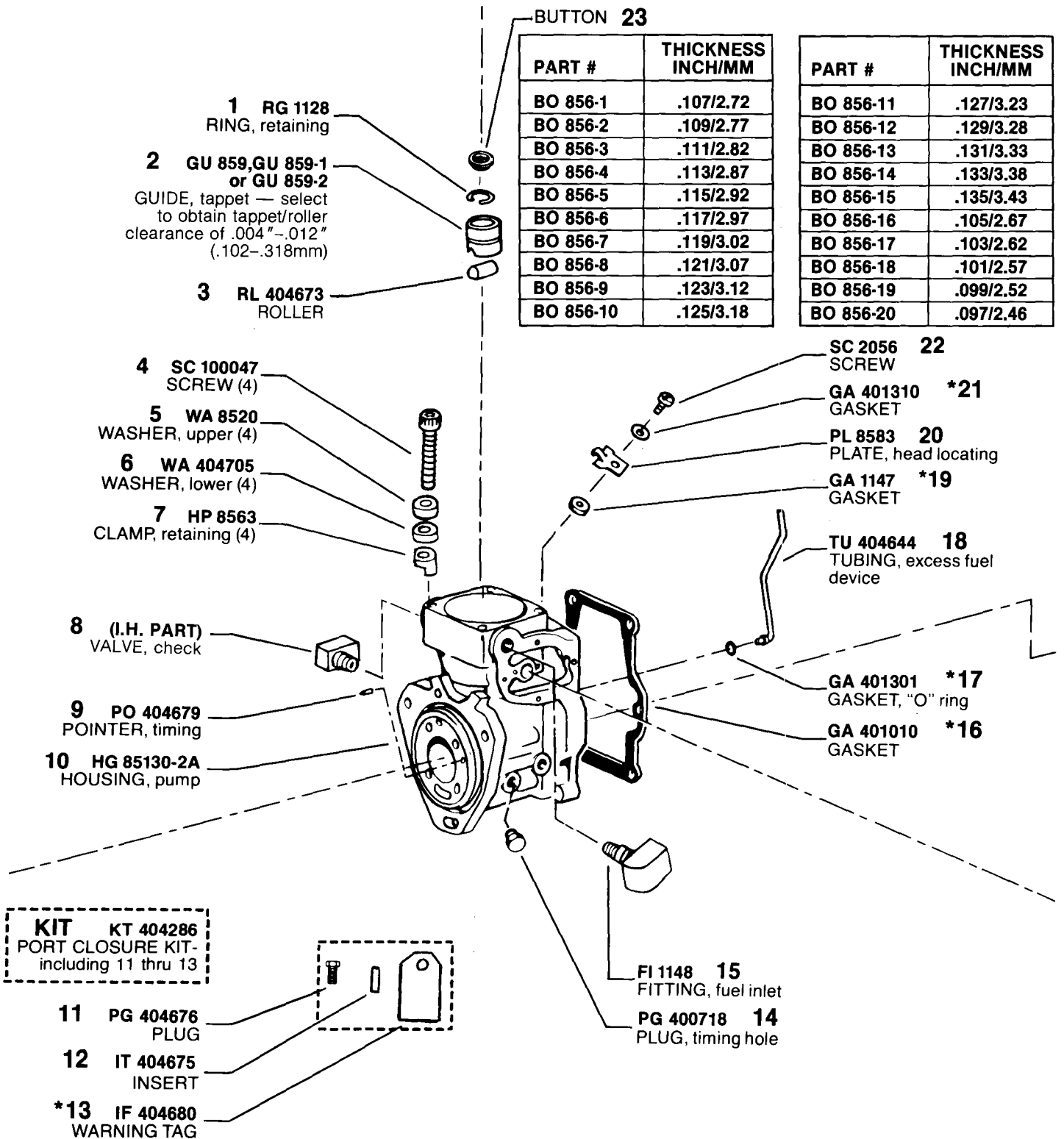

MODEL 100 6A 100A 9412

*Denotes parts in Repair Gasket Kit, KT 85195.

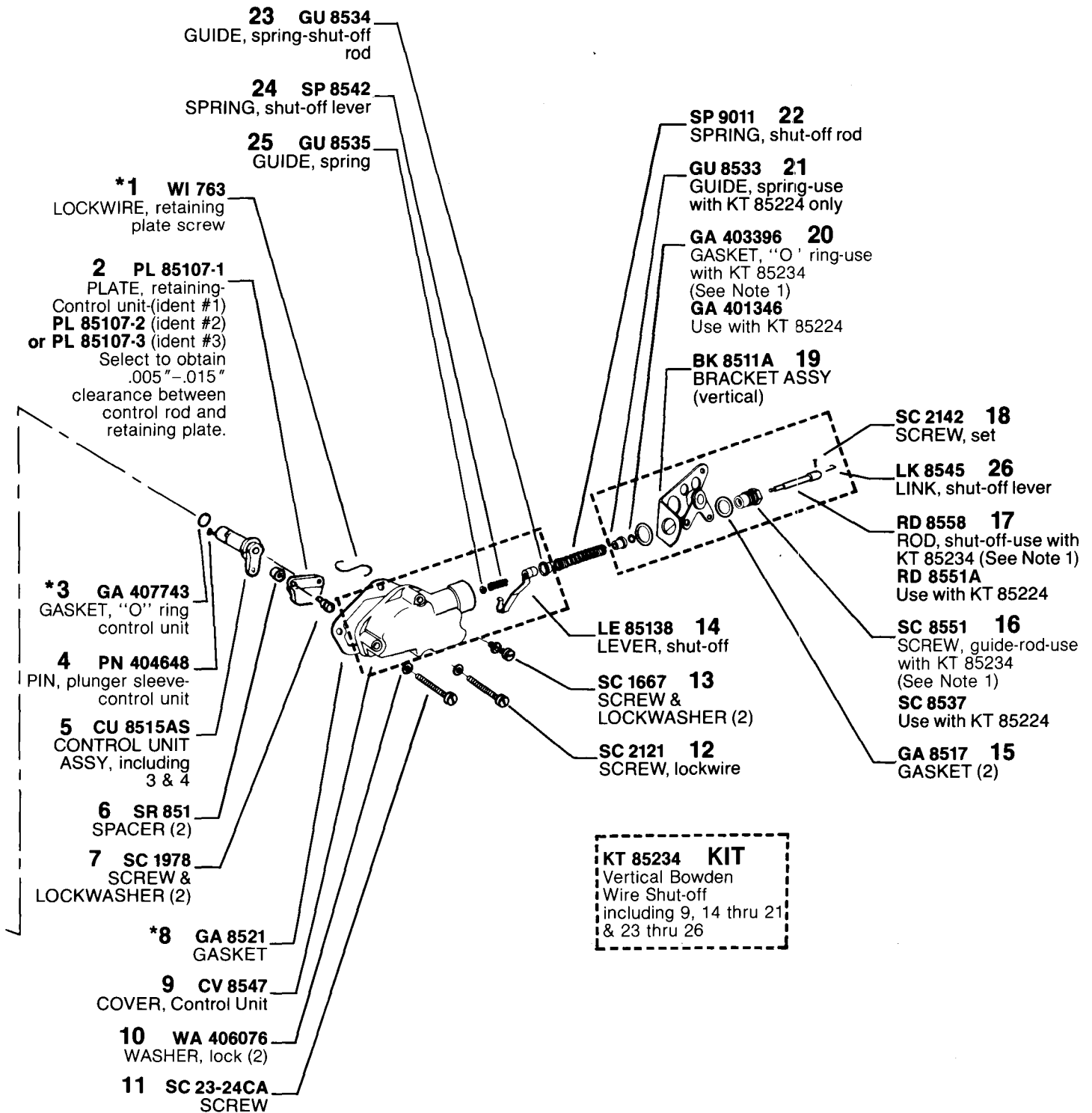

NOTE: 1. Bowden Wire shut-off rod RD 8558 (17), screw SC 8551 (16) and "O" ring GA 403396 (20) must be used together since rod diameter is larger. Spring seat GU 8533 (21) not needed when these parts are used.

MODEL 100 6A 100A 9412

ASSY CT 8599A
INTRAVANCE®
CAMSHAFT ASSY-
including 1,2,4 thru 12
& 15 thru 24

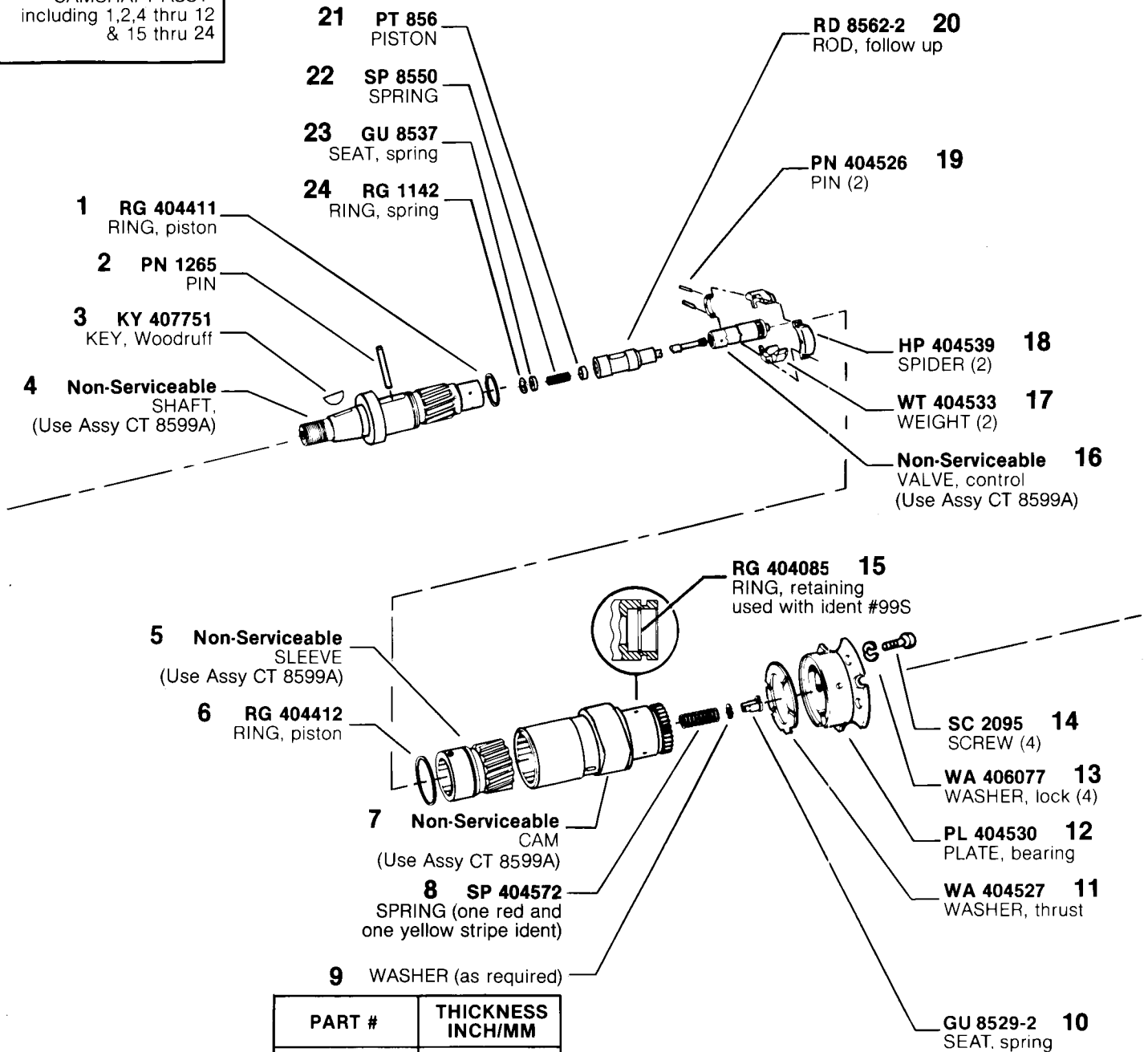

MODEL 100 6A 100A 9412

ASSY WT 8535A
WEIGHT & SHAFT-
including 1, 5 thru 12 &
16 thru 21

ASSY WT 8531AS
WEIGHT & SPIDER
ASSY, including 9 & 16
thru 19

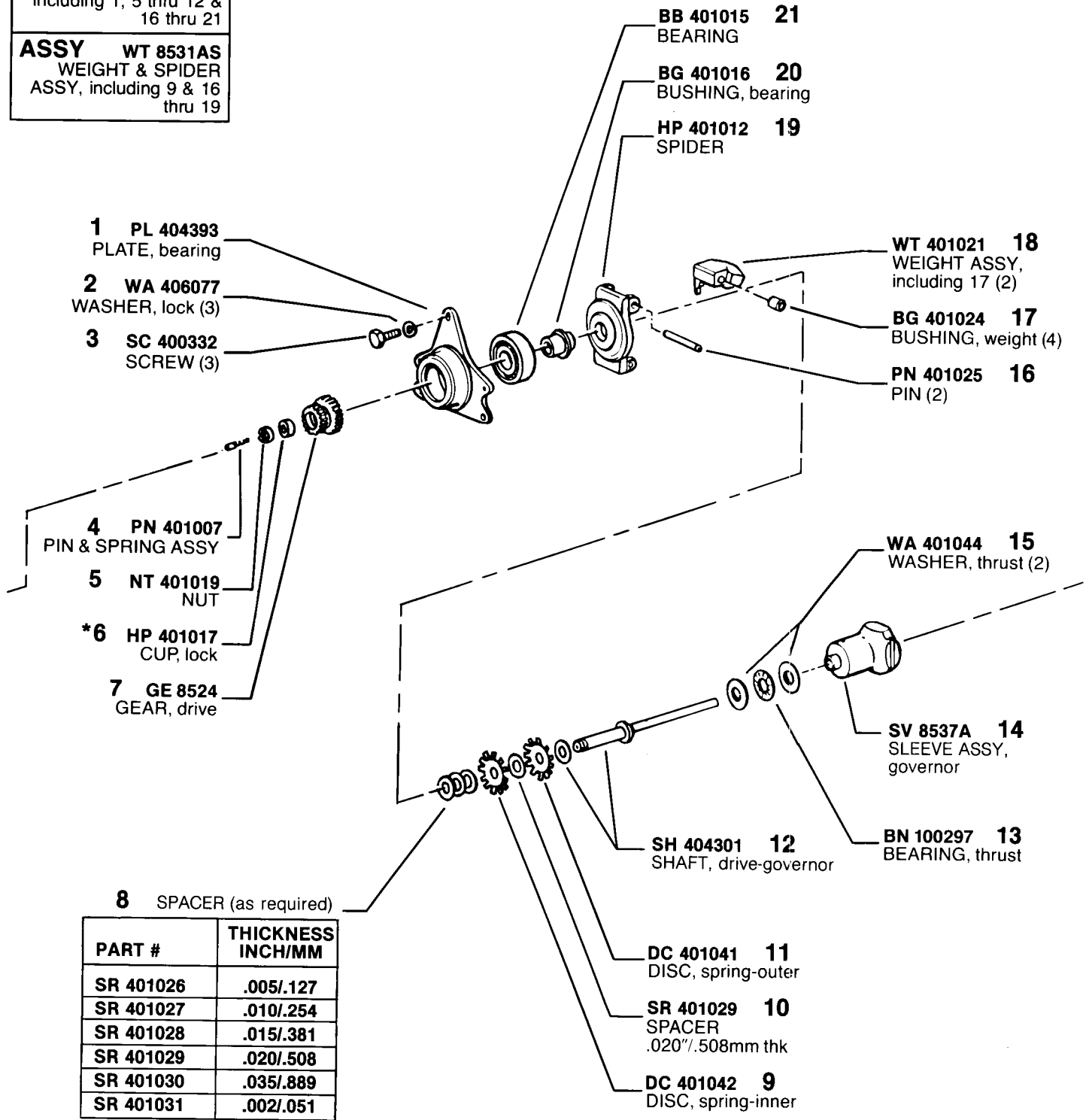

PART #	THICKNESS INCH/MM
SR 401026	.005/.127
SR 401027	.010/.254
SR 401028	.015/.381
SR 401029	.020/.508
SR 401030	.035/.889
SR 401031	.002/.051

MODEL 100 6A 100A 9412

*Denotes parts in Repair Gasket Kit, KT 85195.

ASSY LE 85128-10A
LEVER & ROD,
fulcrum-including 1
thru 7, 15 thru 21 & 24

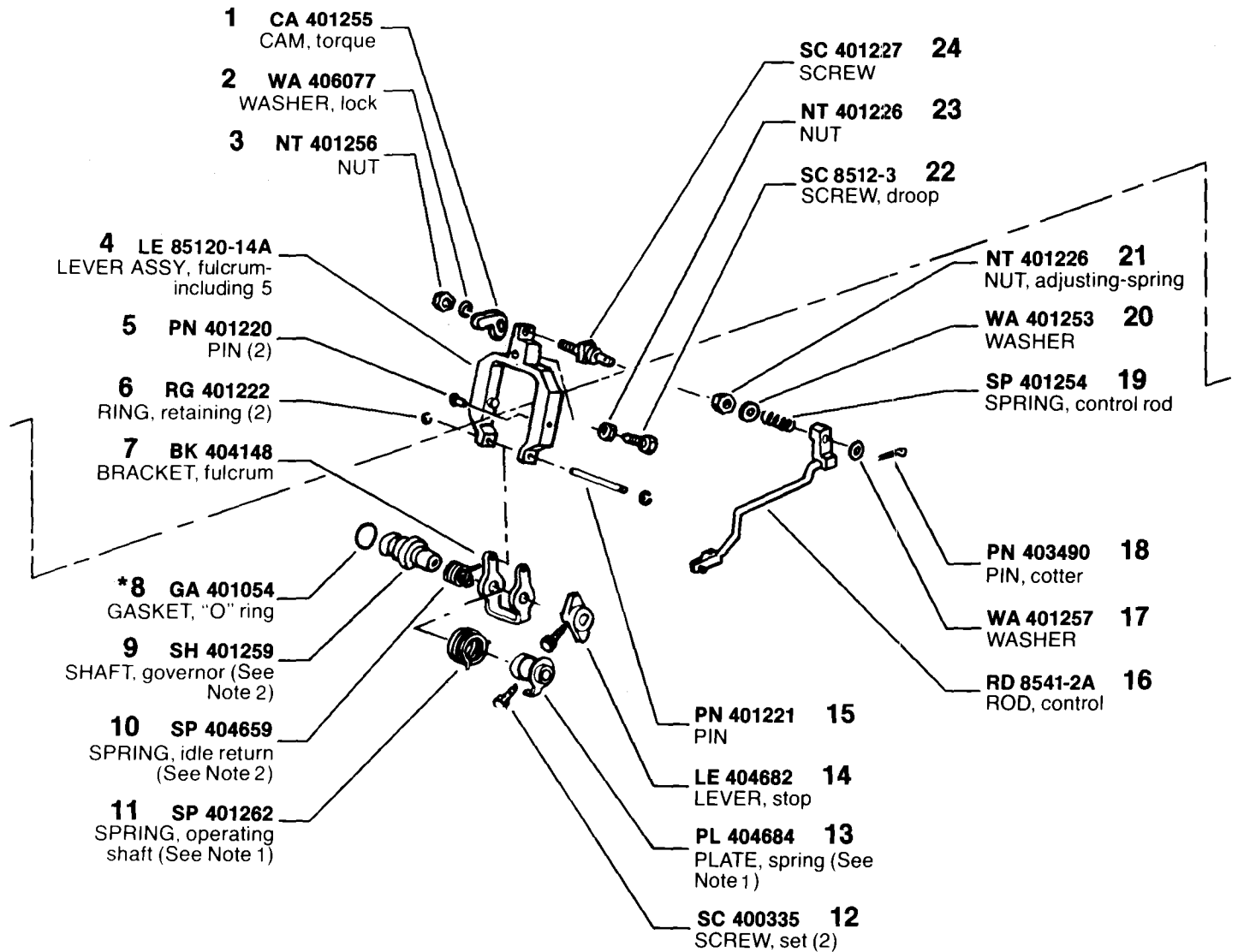

NOTE 1: If operating shaft spring has red or yellow band, replace spring (11) and spring plate (13).

NOTE 2: When replacing governor shaft (9) or governor operating shaft (5 on page 11), see if governor has idle return spring (10). If not, replace governor and operating shafts with SH 85153A which includes 9, 10; and 5 on page 11.

MODEL 100 6A 100A 9412

ASSY CV 8560A
COVER ASSY, puff limiter-including 1 thru 4, 8 & 25 thru 29

ASSY PL 85124-1A
PUFF LIMITER EXCESS FUEL DEVICE ASSY-including 12 thru 29 & 21 thru 24

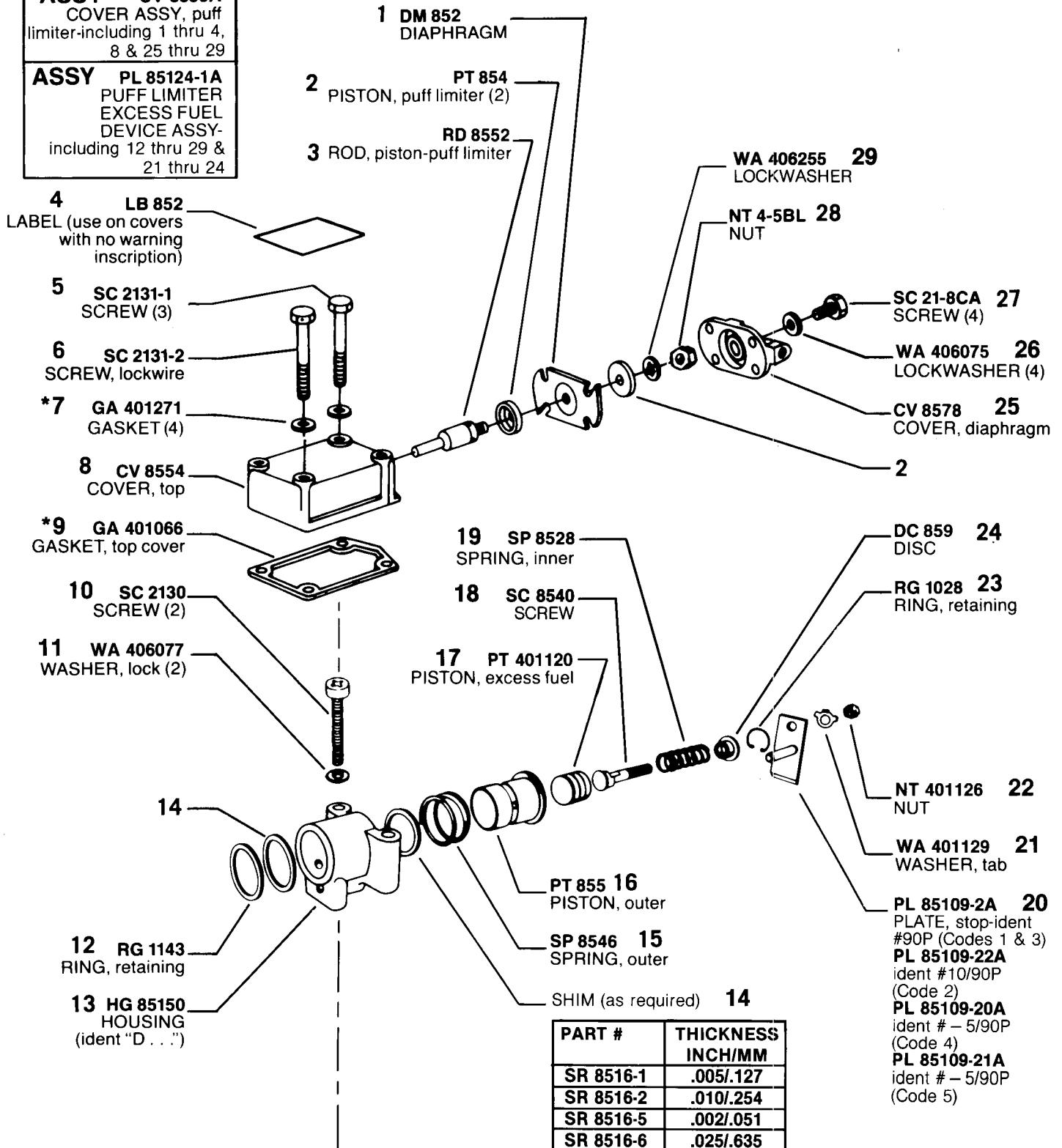

PART #	THICKNESS INCH/MM
SR 8516-1	.005/1.27
SR 8516-2	.010/2.54
SR 8516-5	.002/0.51
SR 8516-6	.025/6.35
SR 8616-7	.050/1.27

*Denotes parts in Repair Gasket Kit, KT 85195.

MODEL 100 6A 100A 9412

- ASSY CV 8567A**
COVER ASSY, supply pump-including 4, 7 thru 9 & 22
- ASSY MP 404760**
HAND PRIMER ASSY-including 1 thru 3 & 28 thru 28
- ASSY SGF 15-311**
SUPPLY PUMP ASSY-including 4 thru 9, 16 thru 20 & 22

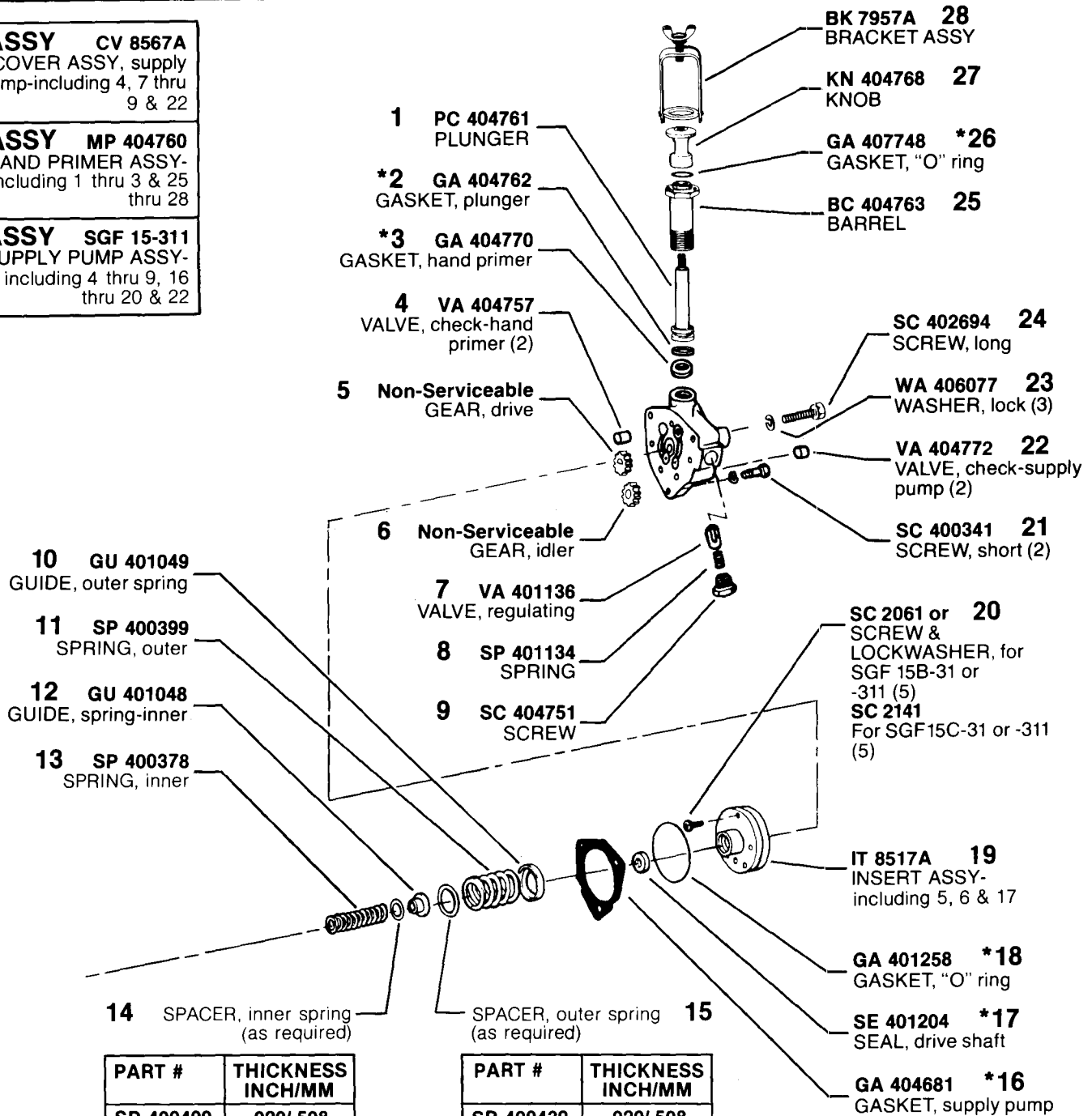

PART #	THICKNESS INCH/MM
SR 400409	.020/.508
SR 400410	.042/1.07
SR 400411	.058/1.47
SR 400412	.083/2.11
SR 400413	.177/4.50
SR 400414	.276/7.01
SR 400415	.010/.254
SR 400416	.005/.127

PART #	THICKNESS INCH/MM
SR 400439	.020/.508
SR 400440	.042/1.07
SR 400441	.058/1.47
SR 400442	.083/2.11
SR 400443	.156/3.96
SR 400444	.030/.762
SR 400445	.010/.254

*Denotes parts in Repair Gasket Kit, KT 85195.

MODEL 100 6A 100A 9412

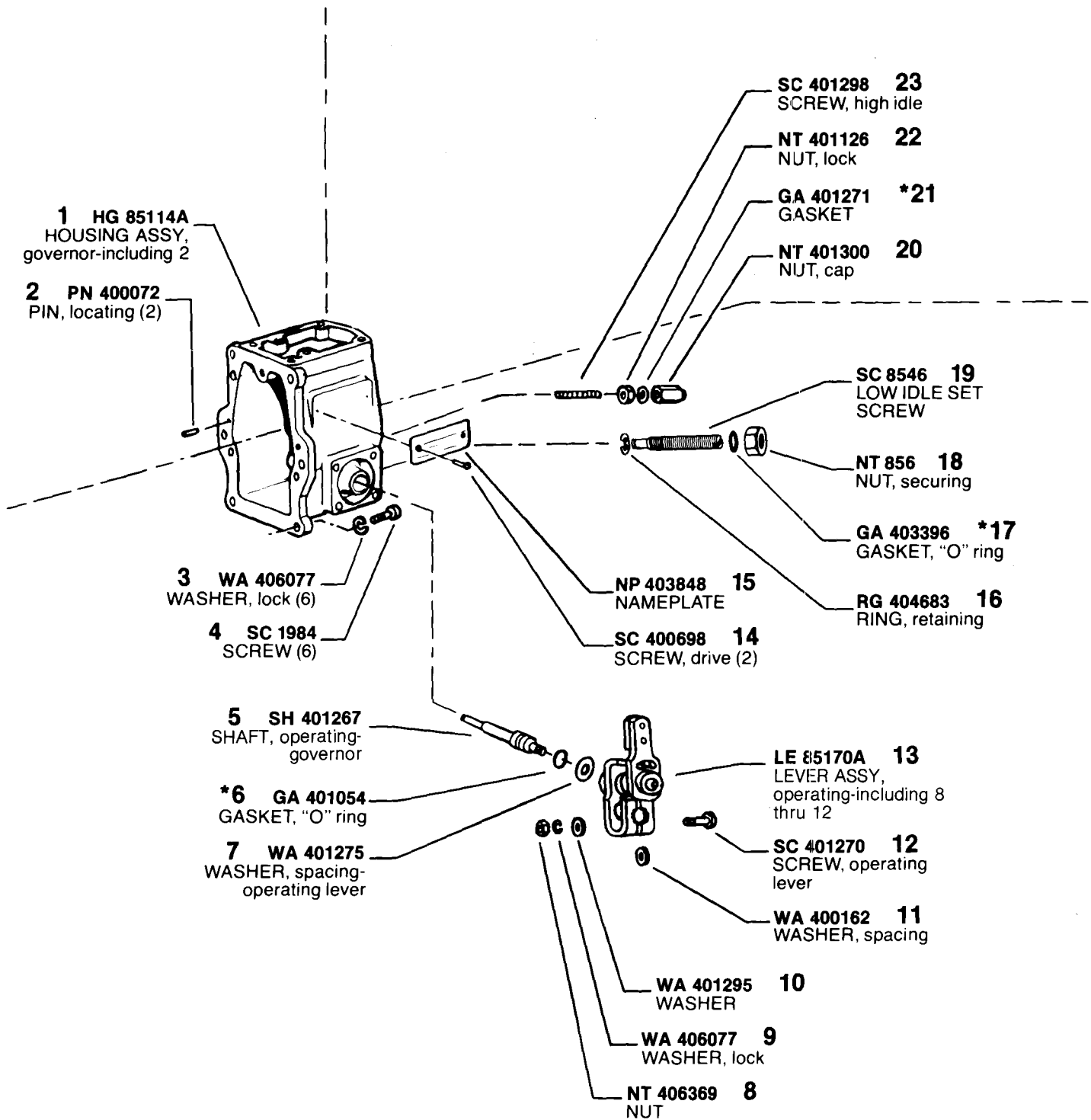

MODEL 100 6A 100A 9412

*Denotes parts in Repair Gasket Kit, KT 85195.

9412 (Code 3)
CODE DATA

Customer No. 689 646 C91
 Engine Model DT 466B (180 BHP)
 Application Federal Truck
 Governor RPM 625/2600
 Inner Spring Gap 3.10 ± .25 mm
 Outer Spring Precompression 1.25 ± .25 mm
 Cam Angle (Ref) 75°

Lift To Port Closing
 Requirement024"-.030"
 (0.60-0.75 mm)
 Delivery Valve Opening
 Pressure 1150-1450 psi
 (7.929-9.998 MPa)

STEP	A	B	C	D
	Full Load	Puff Limiter Delivery Check	Peak Torque (from actual A delivery)	Cam Departure
RPM	2600	2600	1800	2675
DEL	*41.5	35.5-39.5	*+1.0	—

STEP	E	F	G	H
	High Speed Shut-Off	Droop Screw (from actual C delivery)	Low Idle	Starting Fuel Min Delivery
RPM	3100	1400	625	150
DEL	2cc Max	*-1.5	*9.5	10

*Permissible tolerances: Service Check: ± 2.5 cc/500 str
 Recalibration: ± 0.5 cc/500 str

STEP A: Max variation between cyl: 4.0 cc/500 str

STEP A thru G: cc/500 str

STEP H: cc/100 str

9412 (Code 4)
CODE DATA

Customer No. 691 156 C91
 Engine Model DT 466B (160 BHP)
 Application Federal Truck
 Governor RPM 625/2400
 Inner Spring Gap 3.10 ± .25 mm
 Outer Spring Precompression 1.25 ± .25 mm
 Cam Angle (Ref) 80°

Lift To Port Closing
 Requirement024"-.030"
 (0.60-0.75 mm)
 Delivery Valve Opening
 Pressure 1150-1450 psi
 (7.929-9.998 MPa)

STEP	A	B	C	D
	Full Load	Puff Limiter Delivery Check	Peak Torque (from actual A delivery)	Cam Departure
RPM	2400	2400	1600	2475
DEL	*39.5	31.5-35.5	*+4.0	—

STEP	E	F	G	H
	High Speed Shut-Off	Droop Screw (from actual C delivery)	Low Idle	Starting Fuel Min Delivery
RPM	2850	1200	625	150
DEL	2cc Max	*-2.0	*9.5	10

*Permissible tolerances: Service Check: ± 2.5 cc/500 str
 Recalibration: ± 0.5 cc/500 str

STEP A: Max variation between cyl: 4.0 cc/500 str

STEP A thru G: cc/500 str

STEP H: cc/100 str

9412 (Code 5)

CODE DATA

 Customer No. 691 211 C91
 Engine Model DTI 466B (230 BHP)
 Application Seddon Atkinson
 Governor RPM..... 700/2600
 Inner Spring Gap 3.10 ± .25 mm
 Outer Spring Precompression 1.25 ± .25 mm
 Cam Angle (Ref).....60°

 Lift To Port Closing
 Requirement024"-.030"
 (0.60-0.75 mm)
 Delivery Valve Opening
 Pressure1150-1450 psi
 (7.929-9.998 MPa)

STEP	A	B	C	D
	Full Load	Puff Limiter Delivery Check	Peak Torque (from actual A delivery)	Cam Departure
RPM	2600	2600	2000	2675
DEL	*55.5	44.0-48.0	* - 3.0	—

STEP	E	F	G	H
	High Speed Shut-Off	Droop Screw (from actual C delivery)	Low Idle	Starting Fuel Min Delivery
RPM	3100	1600	700	150
DEL	2cc Max	* +0.5	*7.5	10

 *Permissible tolerances: Service Check: ± 2.5 cc/500 str
 Recalibration: ± 0.5 cc/500 str

STEP A: Max variation between cyl: 4.5 cc/500 str

STEP A thru G: cc/500 str

STEP H: cc/100 str