

9556

A

PUMP ROTATION:
Clockwise
FIRING ORDER:
1-5-3-6-2-4
MOUNTING:
L.H.
SPECIAL FEATURES:
Horizontal Bowden Wire Shut-off

INTERNATIONAL HARVESTER
100 6A 100A 9556

Special Information:

SERVICE PARTS

Following are all parts, part numbers, pump codes and calibrations for the *Model: 100 6A 100A 9556*. The exploded view drawing below is detailed with part

numbers listed on the pages indicated. Refer to the Index Section for explanations of codes and abbreviations.

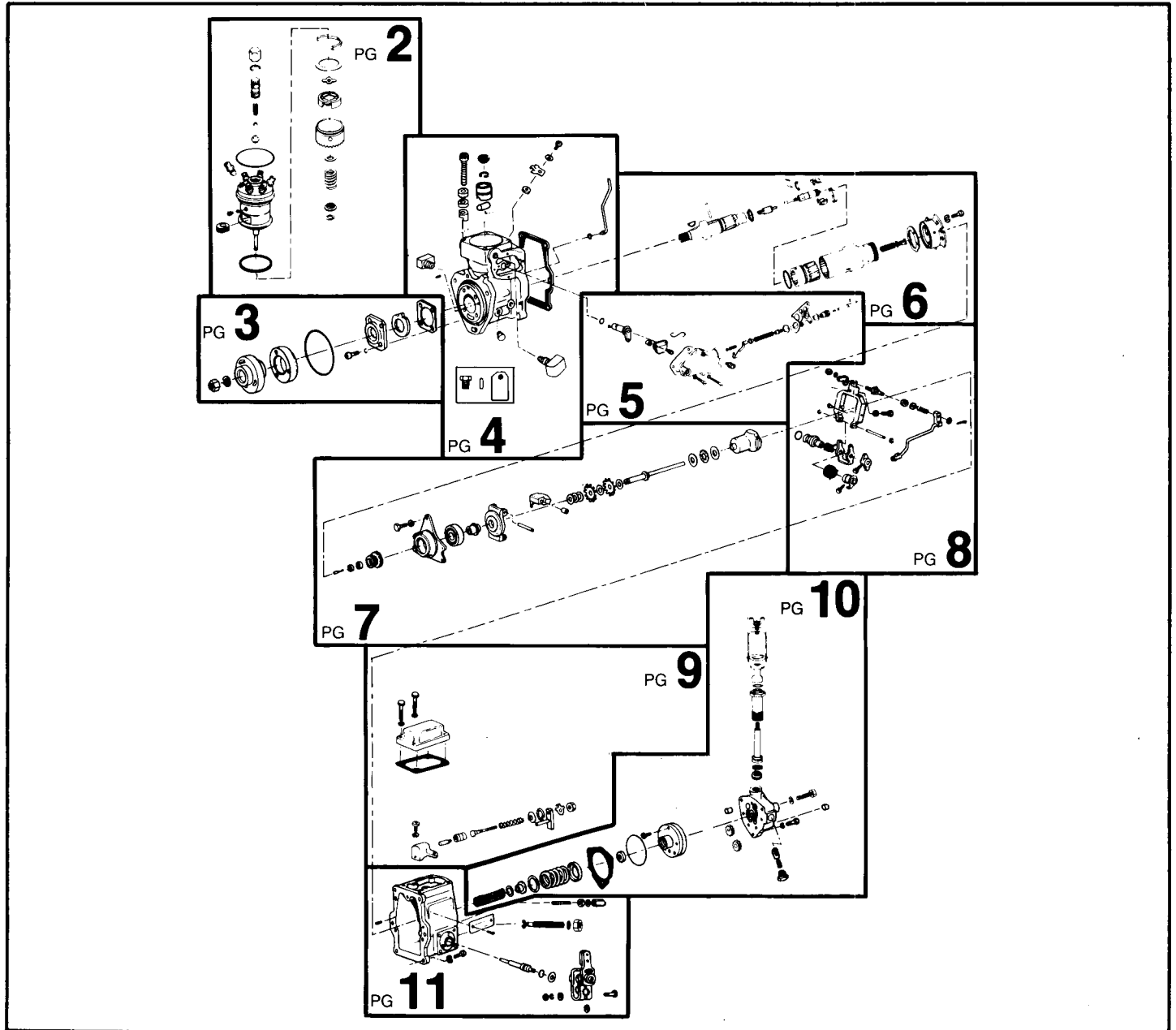

MODEL 100 6A 100A 9556

ASSY HD 9422-S
10MM HYDRAULIC
HEAD ASSY-
including 1 thru 23; and
3 on page 5

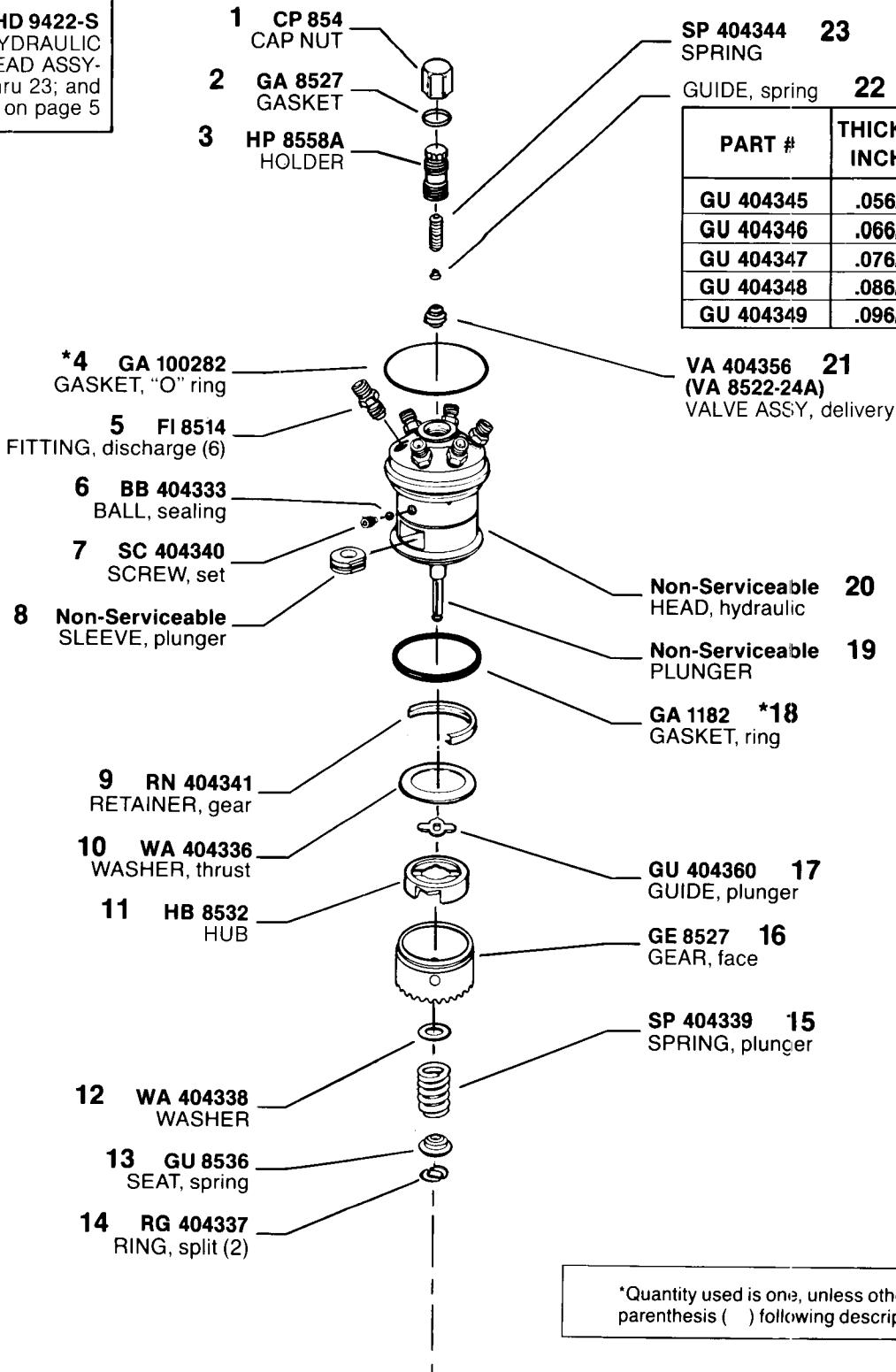

*Quantity used is one, unless otherwise indicated in parenthesis () following description of part.

MODEL 100 6A 100A 9556

*Denotes parts in Repair Gasket Kit, KT 85195.

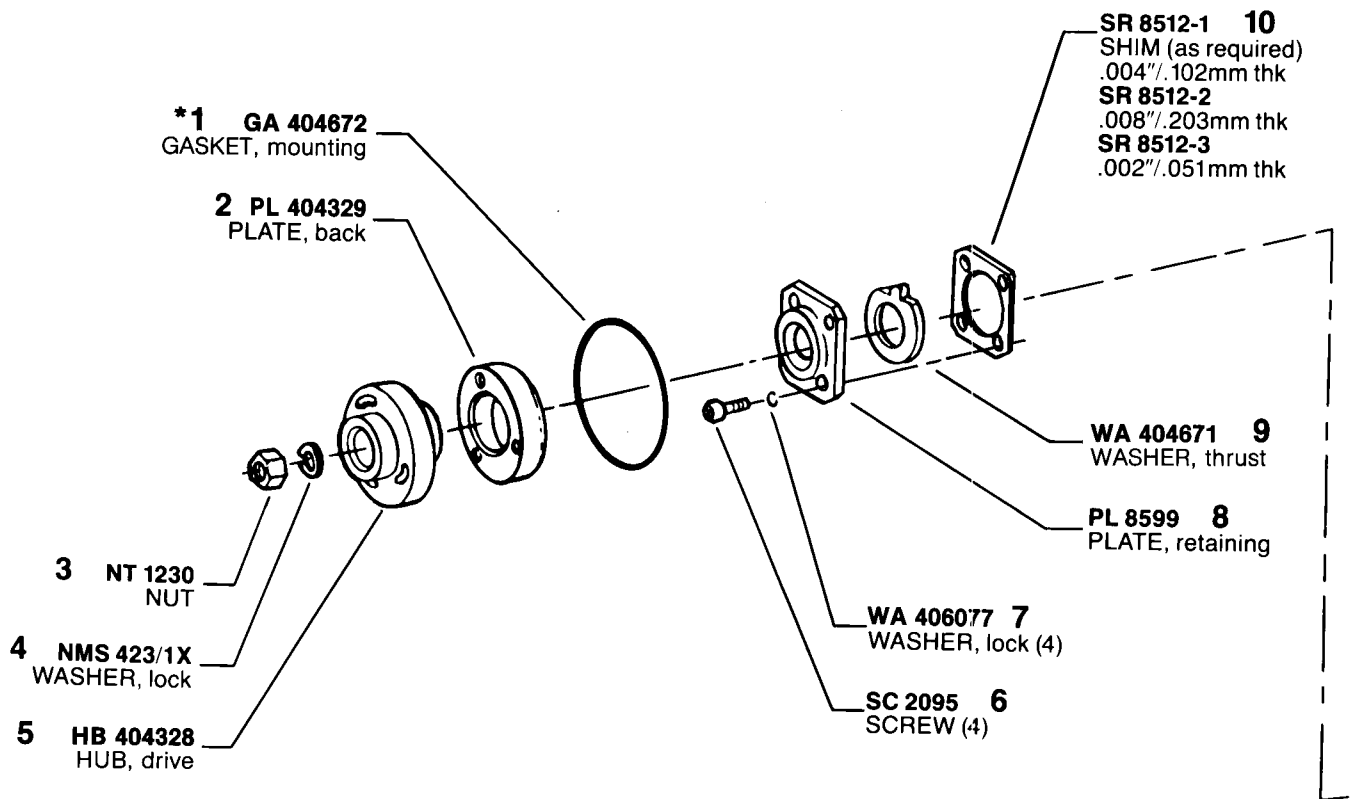

MODEL 100 6A 100A 9556

*Denotes parts in Repair Gasket Kit, KT 85195.

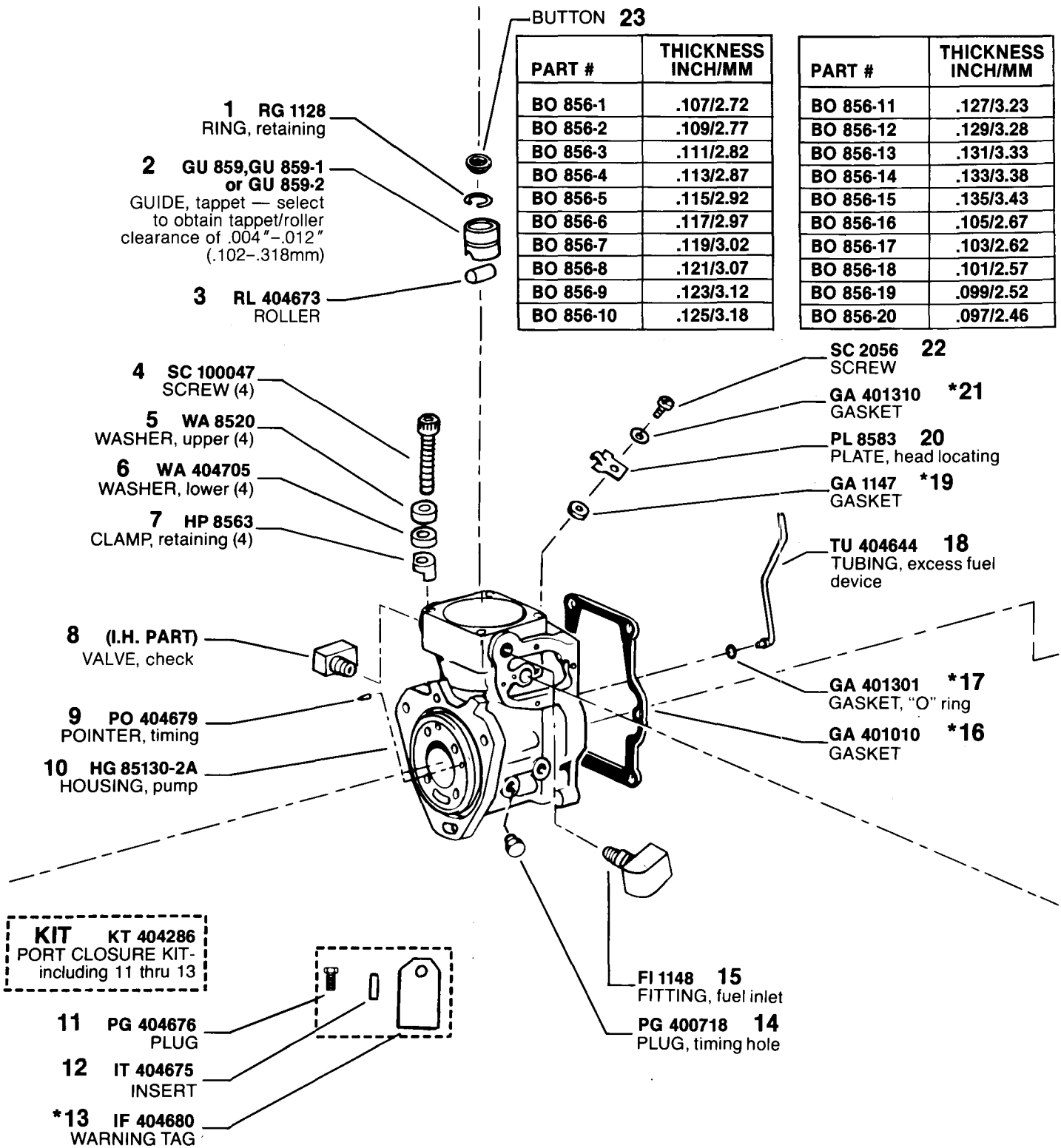

MODEL 100 6A 100A 9556

*Denotes parts in Repair Gasket Kit, KT 85195.

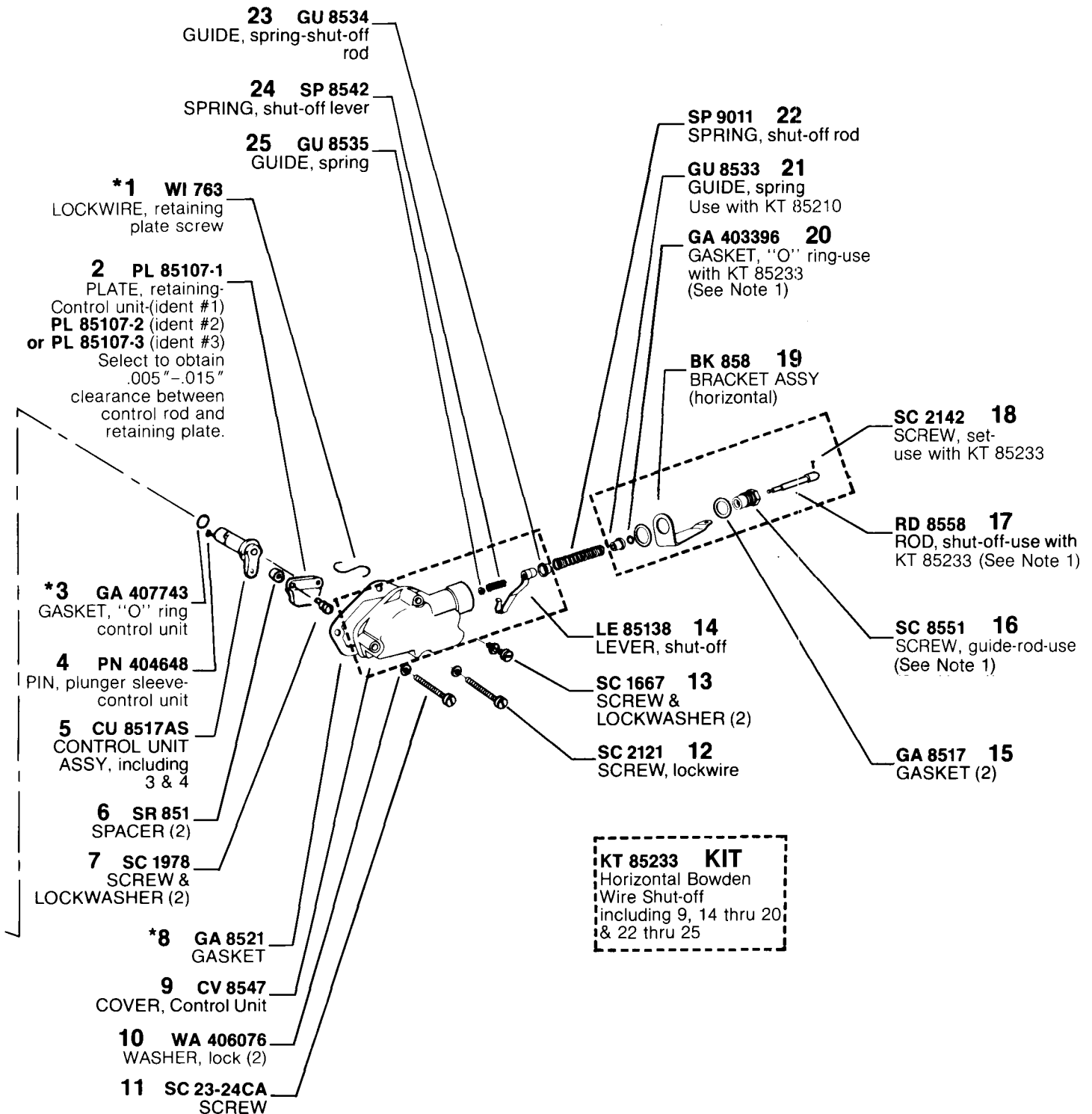

NOTE: 1. Bowden Wire shut-off rod RD 8558 (17), screw SC 8551 (16) and "O" ring GA 403396 (20) must be used together since rod diameter is larger. Spring seat GU 8533 (21) not needed when these parts are used.

MODEL 100 6A 100A 9556

ASSY CT 85109A
INTRAVANCE
CAMSHAFT ASSY-
including 1,2,4 thru 12
& 15 thru 19

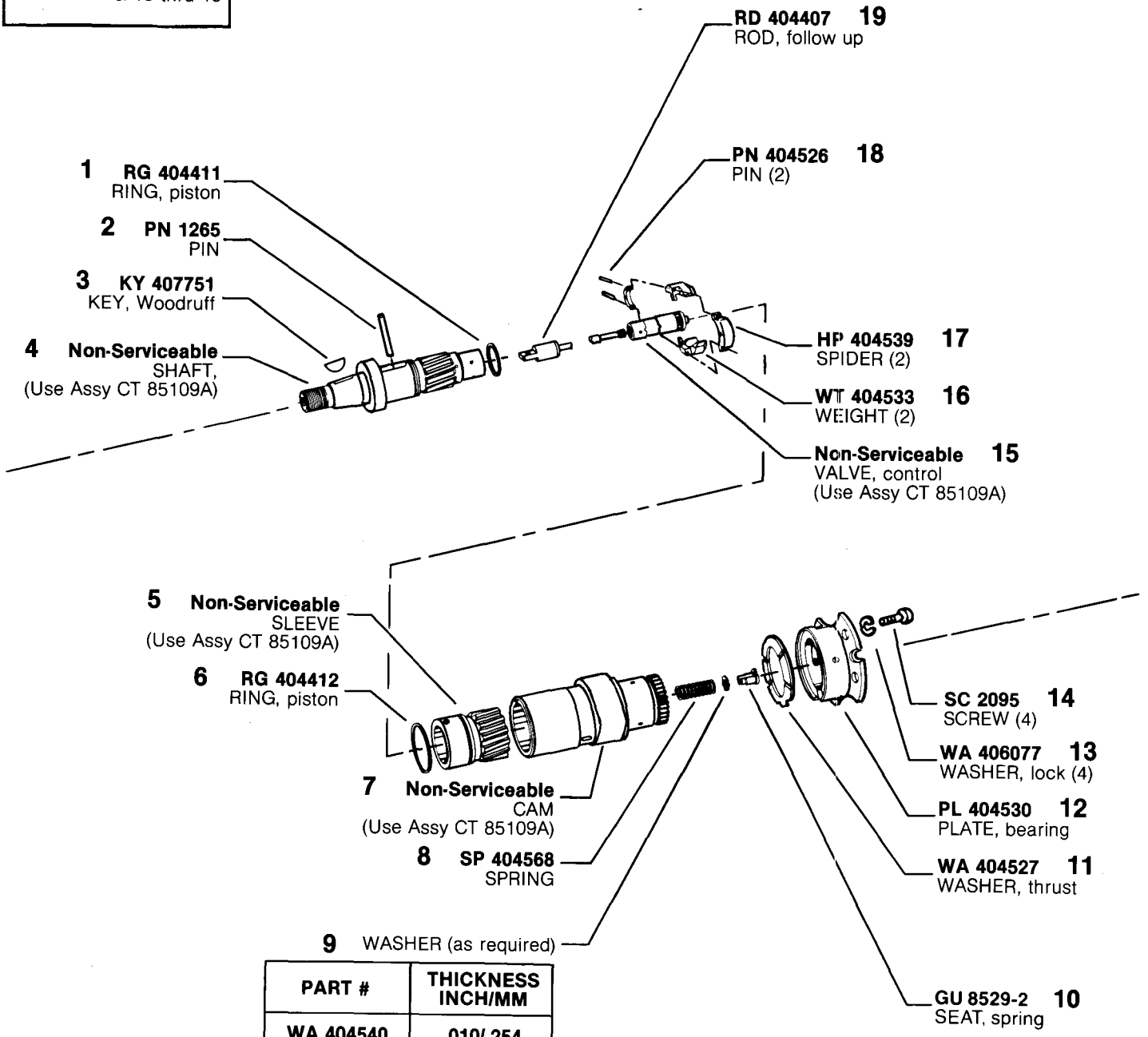

| PART # | THICKNESS INCH/MM |
|-----------|----------------------|
| WA 404540 | .010/.254 |
| WA 404541 | .015/.381 |
| WA 404542 | .040/1.02 |
| WA 404543 | .060/1.52 |
| WA 404544 | .004/.102 |

MODEL 100 6A 100A 9556

ASSY WT 8535A
WEIGHT & SHAFT-
including 1, 5 thru 12 &
16 thru 21

ASSY WT 8531AS
WEIGHT & SPIDER
ASSY, including 9 & 16
thru 19

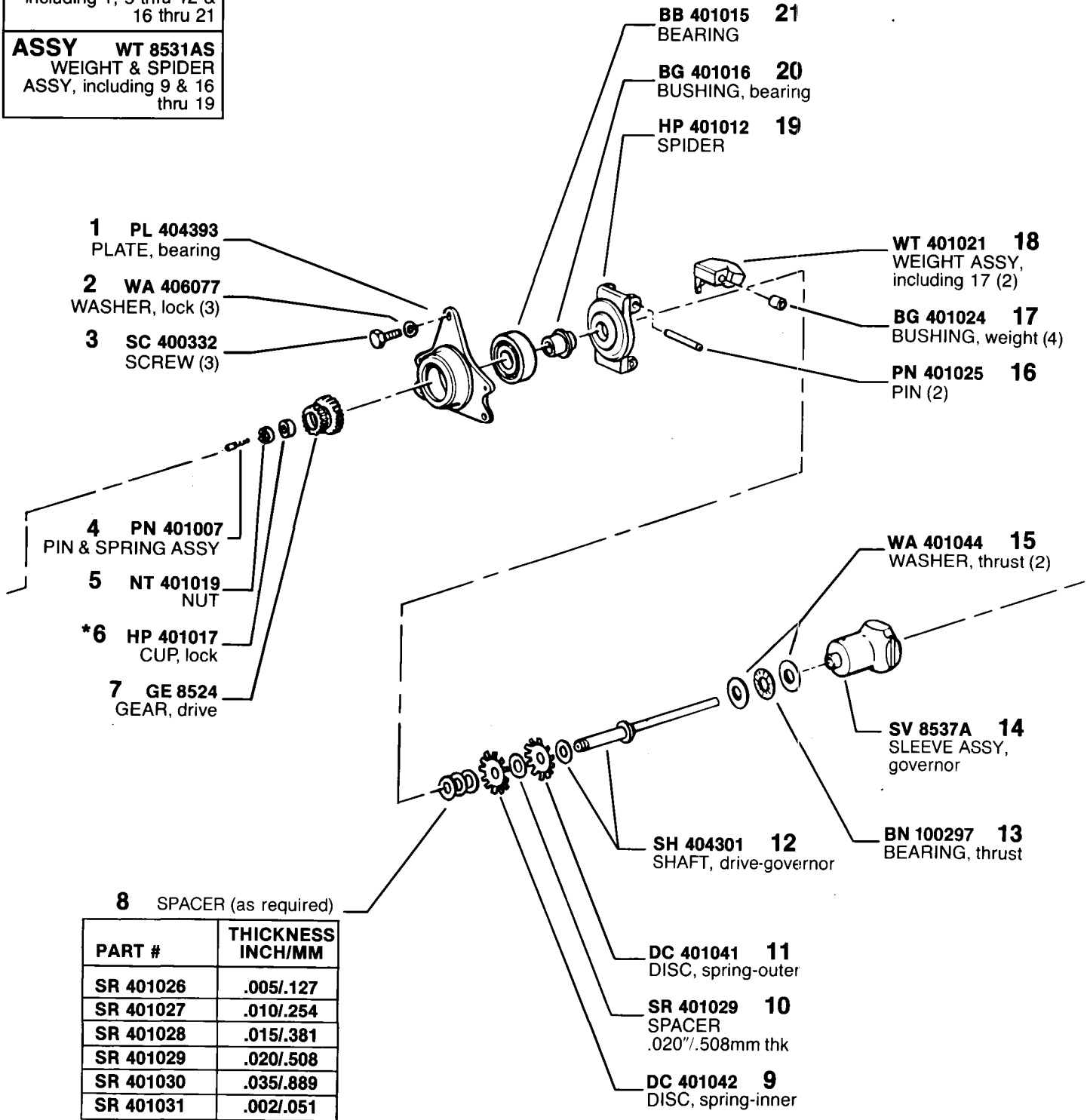

MODEL 100 6A 100A 9556

*Denotes parts in Repair Gasket Kit, KT 85195.

ASSY LE 85128-2A
LEVER & ROD,
fulcrum-including 1 thru
7, 15 thru 21 & 24

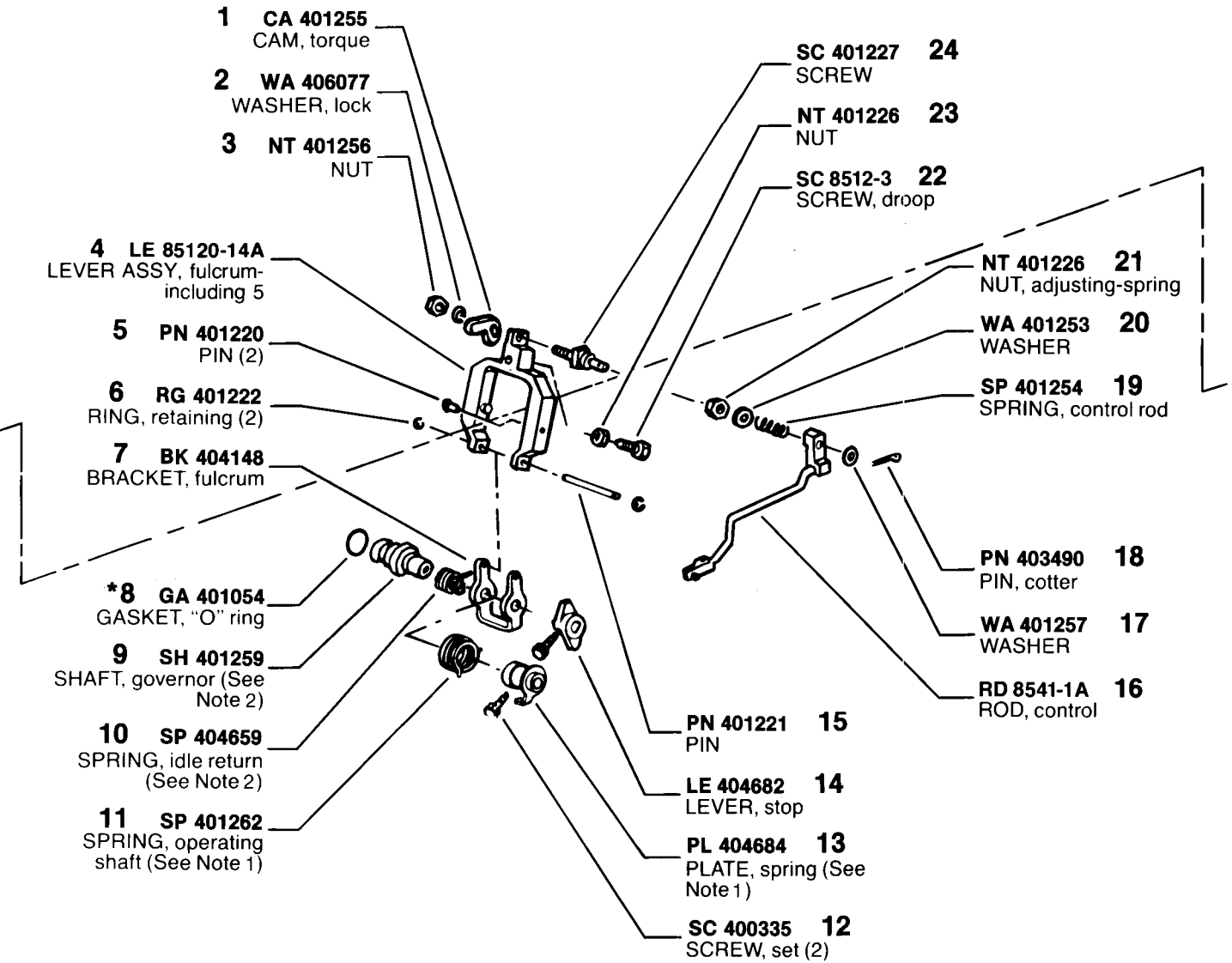

NOTE 1: If operating shaft spring has red or yellow band, replace spring (11) and spring plate (13).

NOTE 2: When replacing governor shaft (9) or governor operating shaft (5 on page 11), see if governor has idle return spring (10). If not, replace governor and operating shafts with SH 85153A which includes 9, 10; and 5 on page 11.

MODEL 100 6A 100A 9556

ASSY PL 401607
EXCESS FUEL
DEVICE ASSY-
including 4, 5, 8 thru
10 & 12 thru 15

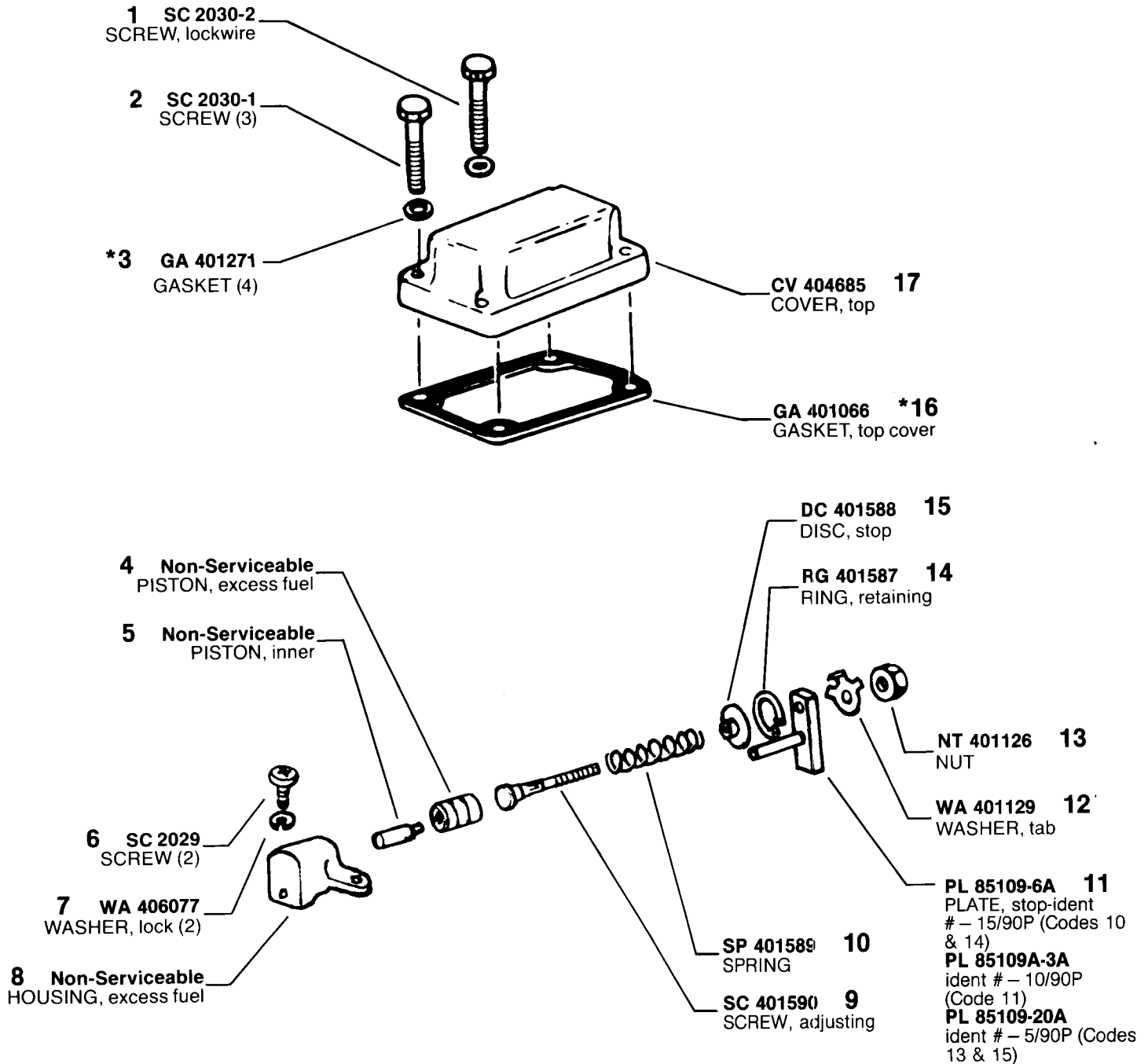

*Denotes parts in Repair Gasket Kit, KT 85195.

MODEL 100 6A 100A 9556

- ASSY CV 8567A**
COVER ASSY, supply pump-including 4, 7 thru 9 & 22
- ASSY MP 404760**
HAND PRIMER ASSY-including 1 thru 3 & 25 thru 28
- ASSY SGF 15-311**
SUPPLY PUMP ASSY-including 4 thru 9, 16 thru 20 & 22

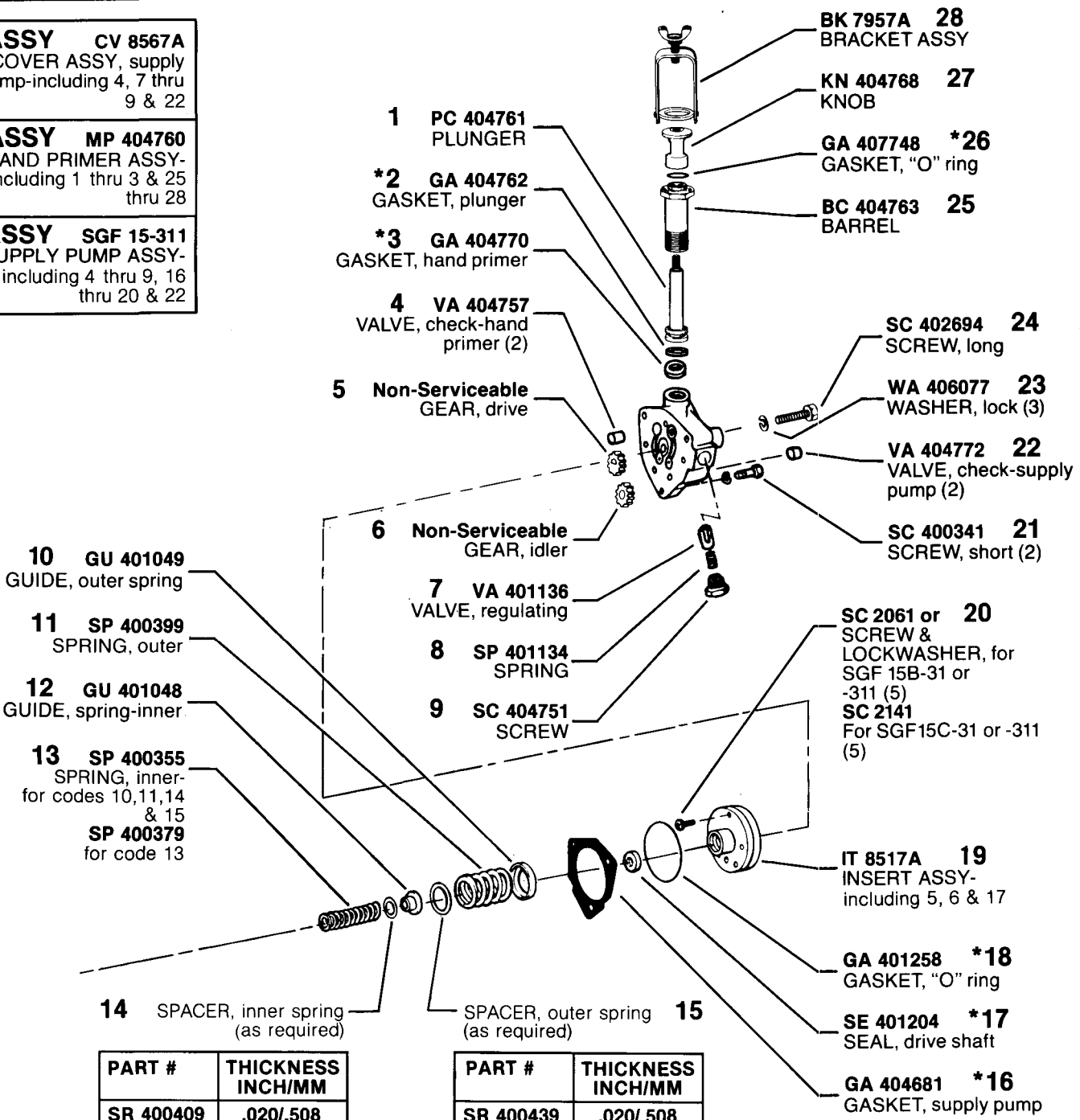

| PART # | THICKNESS INCH/MM |
|-----------|-------------------|
| SR 400409 | .020/.508 |
| SR 400410 | .042/1.07 |
| SR 400411 | .058/1.47 |
| SR 400412 | .083/2.11 |
| SR 400413 | .177/4.50 |
| SR 400414 | .276/7.01 |
| SR 400415 | .010/.254 |
| SR 400416 | .005/.127 |

| PART # | THICKNESS INCH/MM |
|-----------|-------------------|
| SR 400439 | .020/.508 |
| SR 400440 | .042/1.07 |
| SR 400441 | .058/1.47 |
| SR 400442 | .083/2.11 |
| SR 400443 | .156/3.96 |
| SR 400444 | .030/.762 |
| SR 400445 | .010/.254 |

*Denotes parts in Repair Gasket Kit, KT 85195.

MODEL 100 6A 100A 9556

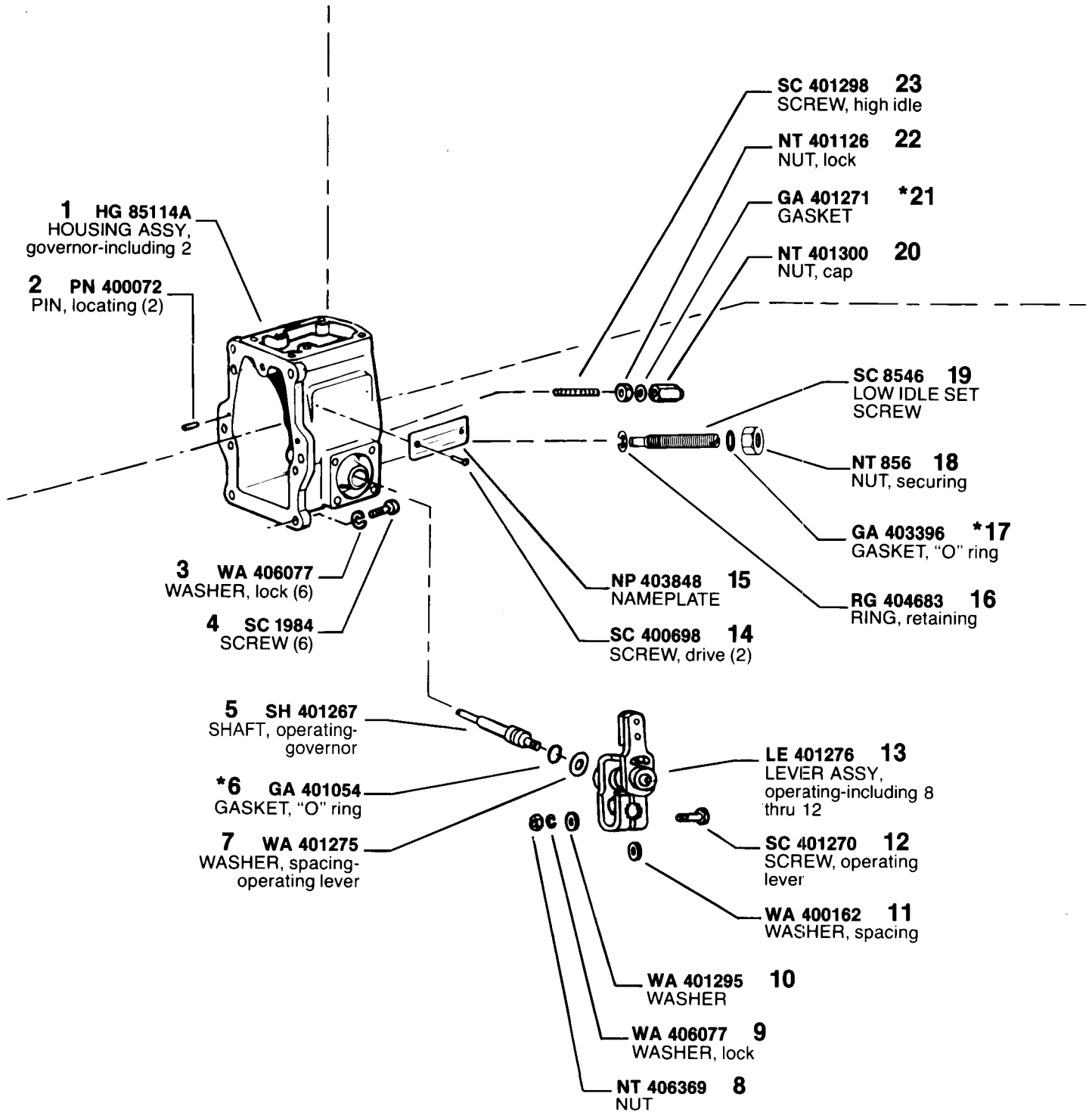

MODEL 100 6A 100A 9556

*Denotes parts in Repair Gasket Kit, KT 85195.



**UNITED
TECHNOLOGIES
DIESEL SYSTEMS**

CALIBRATION SET-UP

Nozzle Holder TSE 77107-5
 High Pressure Tubing 1/4" O.D. x .062" x 32" Long (6.35 x 1.58 x 813 mm)
 Test Oil Viscor 1487 @ 100°F (38°C) at pump inlet
 Supply Pump Pressure 40 psi (276 KPa) min at full load (rated) speed
 Lube Oil Pressure 55 psi (380 KPa)
 INTRAVANCE®
 Camshaft Assy CT 85109A (Stamped Ident Code: 109)
 Advance: 14° Total
 Start: 300-500 RPM
 End: 1720-1920 RPM

PROCEDURE: Refer to Service Instructions and use figures below.

12

**INTERNATIONAL HARVESTER
100 6A 100A 9556**

9556 (Code 10)

CODE DATA

Customer No. 687 476 C91
 Engine Model DT 414B (165 BHP)
 Application H530 All Pay Loader
 Governor RPM 700/2500
 Inner Spring Gap 3.0 ± .25 mm
 Outer Spring Precompression 1.25 ± .25 mm
 Cam Angle (Ref) 80°

Lift To Port Closing Requirement024"-.030" (0.60-0.75 mm)
 Delivery Valve Opening Pressure 1150-1450 psi (7.929-9.998 MPa)

| STEP | A | B | C | D |
|------|--------------|-----------------------------|--------------------------------------|---------------|
| | Full Load | Puff Limiter Delivery Check | Peak Torque (from actual A delivery) | Cam Departure |
| RPM | 2500 | not applicable | 1900 | 2575 |
| DEL | *38.0 | | *+4.0 | — |

| STEP | E | F | G | H |
|------|---------------------|--------------------------------------|-------------|----------------------------|
| | High Speed Shut-Off | Droop Screw (from actual C delivery) | Low Idle | Starting Fuel Min Delivery |
| RPM | 3000 | 1600 | 700 | 150 |
| DEL | 2cc Max | *-0.5 | *6.0 | 10 |

*Permissible tolerances: Service Check: ± 2.5 cc/500 str
 Recalibration: ± 0.5 cc/500 str
 STEP A: Max variation between cyl: 3.0 cc/500 str
 STEP A thru G: cc/500 str
 STEP H: cc/100 str

9556 (Code 11)

CODE DATA

Customer No. 687 480 C91
 Engine Model DT 414B (158 BHP)
 Application H-65C Wheel Loader
 Governor RPM 700/2500
 Inner Spring Gap 3.50 ± .25 mm
 Outer Spring Precompression 1.25 ± .25 mm
 Cam Angle (Ref) 75°

Lift To Port Closing Requirement024"-.030" (0.60-0.75 mm)
 Delivery Valve Opening Pressure 1150-1450 psi (7.929-9.998 MPa)

| STEP | A | B | C | D |
|------|--------------|-----------------------------|--------------------------------------|---------------|
| | Full Load | Puff Limiter Delivery Check | Peak Torque (from actual A delivery) | Cam Departure |
| RPM | 2500 | not applicable | 1900 | 2575 |
| DEL | *36.5 | | *+3.5 | — |

| STEP | E | F | G | H |
|------|---------------------|--------------------------------------|-------------|----------------------------|
| | High Speed Shut-Off | Droop Screw (from actual C delivery) | Low Idle | Starting Fuel Min Delivery |
| RPM | 2950 | 1600 | 700 | 150 |
| DEL | 2cc Max | *-0.5 | *6.0 | 10 |

*Permissible tolerances: Service Check: ± 2.5 cc/500 str
 Recalibration: ± 0.5 cc/500 str
 STEP A: Max variation between cyl: 3.0 cc/500 str
 STEP A thru G: cc/500 str
 STEP H: cc/100 str

9556 (Code 13)

CODE DATA

Customer No. 691 023 C91
 Engine Model DT 466B (200 BHP)
 Application H-80B, H-540
 Governor RPM..... 700/2500
 Inner Spring Gap 3.20 ± .25 mm
 Outer Spring Precompression 1.25 ± .25 mm
 Cam Angle (Ref)......85°

Lift To Port Closing Requirement024"-.030"
 (0.60-0.75 mm)
 Delivery Valve Opening Pressure1150-1450 psi
 (7.929-9.998 MPa)

| STEP | A | B | C | D |
|------|--------------|-----------------------------|--------------------------------------|---------------|
| | Full Load | Puff Limiter Delivery Check | Peak Torque (from actual A delivery) | Cam Departure |
| RPM | 2500 | not applicable | 1900 | 2575 |
| DEL | *46.0 | | * +2.5 | — |

| STEP | E | F | G | H |
|------|---------------------|--------------------------------------|-------------|----------------------------|
| | High Speed Shut-Off | Droop Screw (from actual C delivery) | Low Idle | Starting Fuel Min Delivery |
| RPM | 3100 | 1600 | 700 | 150 |
| DEL | 2cc Max | * -1.0 | *6.0 | 10 |

*Permissible tolerances: Service Check: ± 2.5 cc/500 str
 Recalibration: ± 0.5 cc/500 str
 STEP A: Max variation between cyl: 4.0 cc/500 str
 STEP A thru G: cc/500 str
 STEP H: cc/100 str

9556 (Code 14)

CODE DATA

Customer No. 691 055 C91
 Engine Model DT 466B (180 BHP)
 Application 412B Scraper
 Governor RPM..... 700/2500
 Inner Spring Gap 3.10 ± .25 mm
 Outer Spring Precompression 1.25 ± .25 mm
 Cam Angle (Ref)......60°

Lift To Port Closing Requirement024"-.030"
 (0.60-0.75 mm)
 Delivery Valve Opening Pressure1150-1450 psi
 (7.929-9.998 MPa)

| STEP | A | B | C | D |
|------|--------------|-----------------------------|--------------------------------------|---------------|
| | Full Load | Puff Limiter Delivery Check | Peak Torque (from actual A delivery) | Cam Departure |
| RPM | 2500 | not applicable | 1800 | 2575 |
| DEL | *41.5 | | * +3.0 | — |

| STEP | E | F | G | H |
|------|---------------------|--------------------------------------|-------------|----------------------------|
| | High Speed Shut-Off | Droop Screw (from actual C delivery) | Low Idle | Starting Fuel Min Delivery |
| RPM | 2950 | 1500 | 700 | 150 |
| DEL | 2cc Max | * -0.5 | *6.0 | 10 |

*Permissible tolerances: Service Check: ± 2.5 cc/500 str
 Recalibration: ± 0.5 cc/500 str
 STEP A: Max variation between cyl: 4.0 cc/500 str
 STEP A thru G: cc/500 str
 STEP H: cc/100 str

9556 (Code 15)

CODE DATA

Customer No. 691 167 C91
 Engine Model DT-466B (165 BHP)
 Application H530 All Payloader
 Governor RPM 700/2500
 Inner Spring Gap 3.0 ± .25 mm
 Outer Spring Precompression 1.25 ± .25 mm
 Cam Angle (Ref)..... 65°

Lift To Port Closing
 Requirement024"-.030"
 (0.60-0.75 mm)
 Delivery Valve Opening
 Pressure 1150-1450 psi
 (7.929-9.998 MPa)

| STEP | A | B | C | D |
|------|--------------|--------------------------------|--|------------------|
| | Full Load | Puff Limiter Delivery Check | Peak Torque (from actual A delivery) | Cam Departure |
| RPM | 2500 | not applicable | 1900 | 2575 |
| DEL | *38.0 | | *+ 1.5 | — |

| STEP | E | F | G | H |
|------|------------------------|--|-------------|-------------------------------|
| | High Speed Shut-Off | Droop Screw (from actual C delivery) | Low Idle | Starting Fuel Min Delivery |
| RPM | 3000 | 1600 | 700 | 150 |
| DEL | 2cc Max | *- 1.0 | *6.0 | 10 |

*Permissible tolerances: Service Check: ± 2.5 cc/500 str
 Recalibration: ± 0.5 cc/500 str

STEP A: Max variation between cyl: 3.0 cc/500 str

STEP A thru G: cc/500 str

STEP H: cc/100 str