

9656

A



PUMP ROTATION:
Clockwise
FIRING ORDER
1-5-3-6-2-4
MOUNTING:
L.H.
SPECIAL FEATURES:
Bowden Wire Shut-Off

HERCULES
100 6A 100A 9656A

Special Information:

SERVICE PARTS

Following are all parts, part numbers, pump codes and calibrations for the Model: 100 6A 100A 9656. The exploded view drawing below is detailed with part

numbers listed on the pages indicated. Refer to the Index Section for explanations of codes and abbreviations.

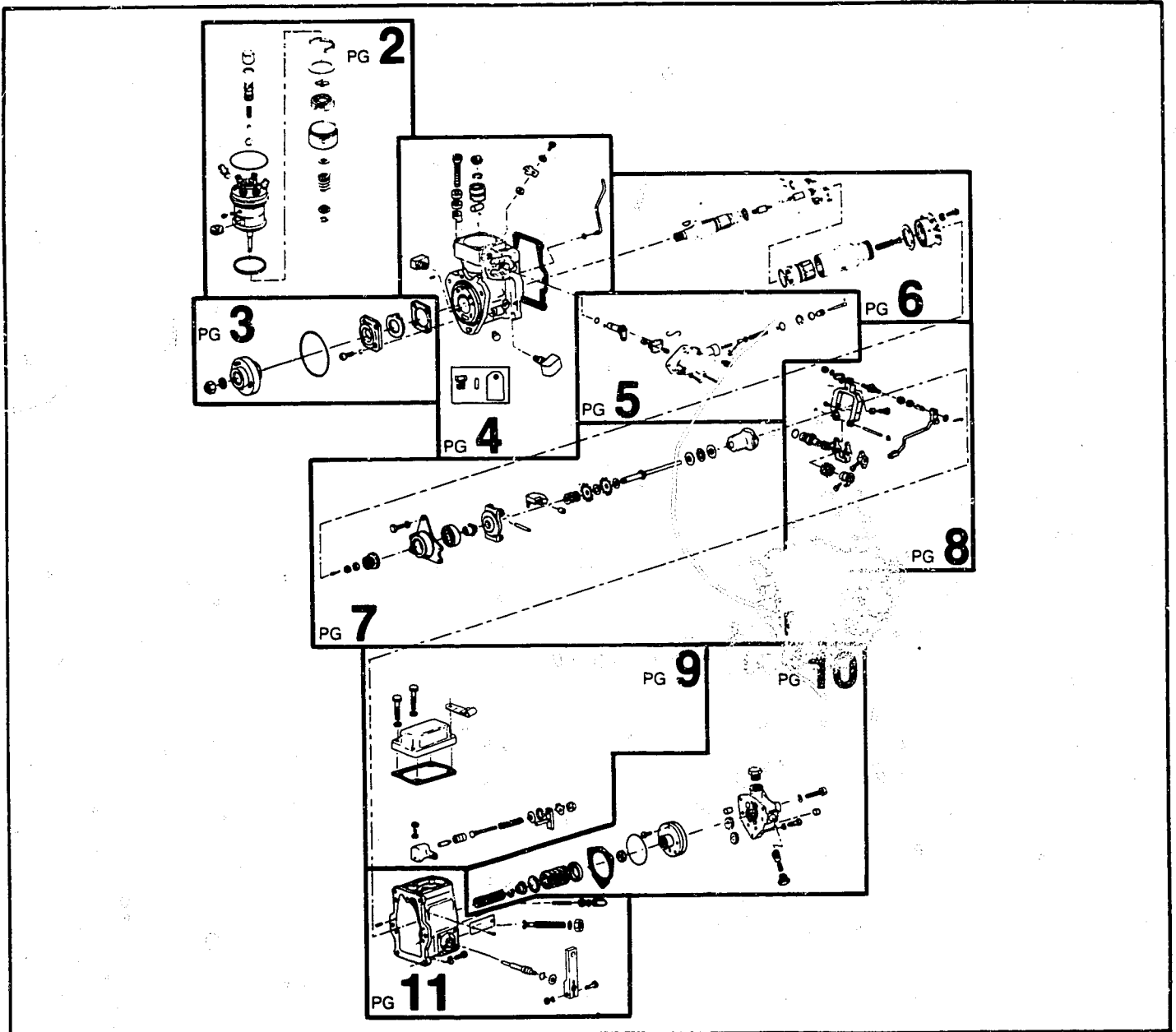

MODEL 100 6A 100A 9656

ASSY HD 9654AS
 10MM HYDRAULIC
 HEAD ASSY-
 including 1 thru 23; and
 3 on page 5

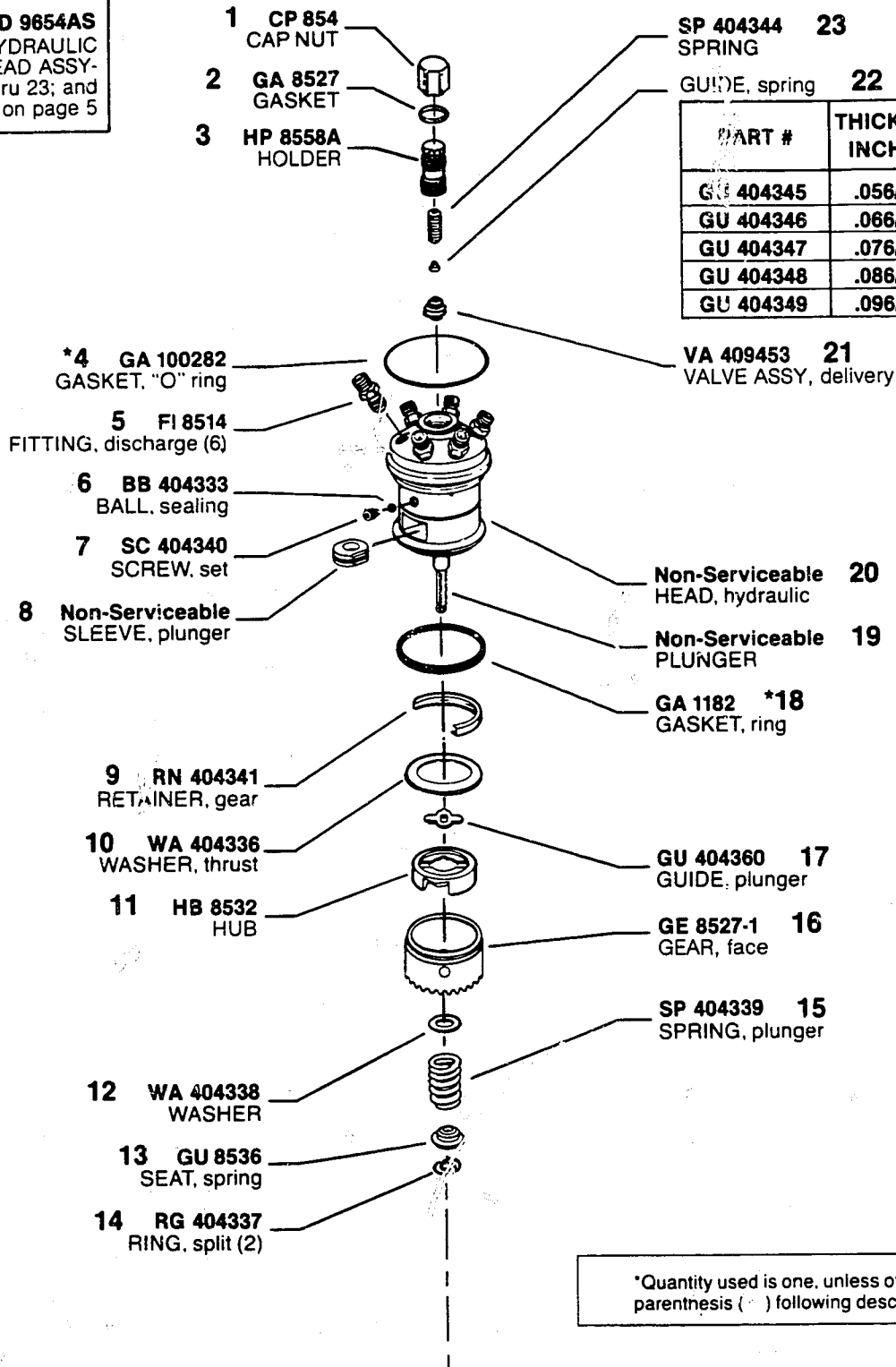

*Quantity used is one, unless otherwise indicated in parenthesis () following description of part.

MODEL 100 6A 100A 9656

*Denotes parts in Repair Gasket Kit, KT 85195.

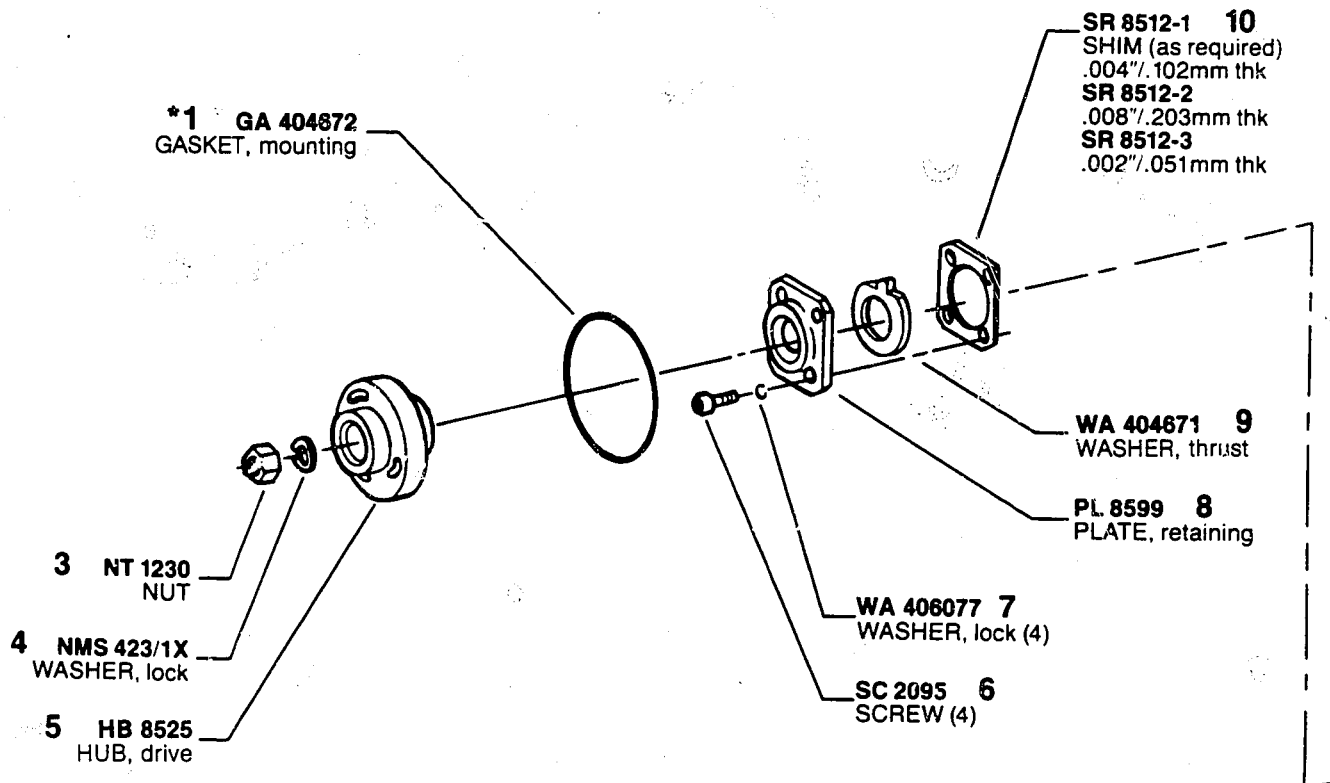

MODEL 100 6A 100A 9656

*Denotes parts in Repair Gasket Kit, KT 85195.

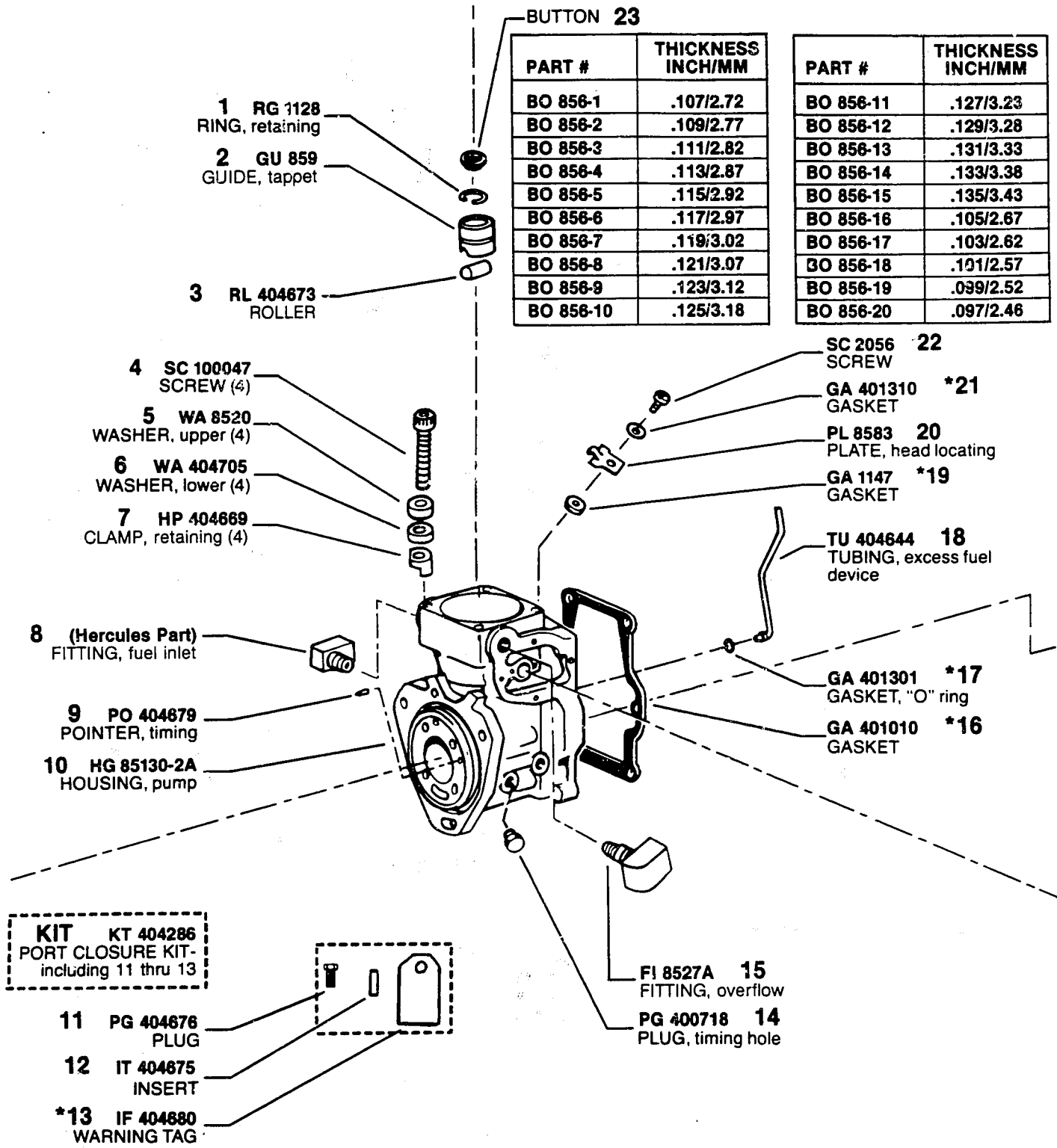

BUTTON 23

PART #	THICKNESS INCH/MM
BO 856-1	.107/2.72
BO 856-2	.109/2.77
BO 856-3	.111/2.82
BO 856-4	.113/2.87
BO 856-5	.115/2.92
BO 856-6	.117/2.97
BO 856-7	.119/3.02
BO 856-8	.121/3.07
BO 856-9	.123/3.12
BO 856-10	.125/3.18

PART #	THICKNESS INCH/MM
BO 856-11	.127/3.23
BO 856-12	.129/3.28
BO 856-13	.131/3.33
BO 856-14	.133/3.38
BO 856-15	.135/3.43
BO 856-16	.105/2.67
BO 856-17	.103/2.62
BO 856-18	.101/2.57
BO 856-19	.099/2.52
BO 856-20	.097/2.46

- 1 RG 1128 RING, retaining
- 2 GU 859 GUIDE, tappet
- 3 RL 404673 ROLLER
- 4 SC 100047 SCREW (4)
- 5 WA 8520 WASHER, upper (4)
- 6 WA 404705 WASHER, lower (4)
- 7 HP 404669 CLAMP, retaining (4)
- 8 (Hercules Part) FITTING, fuel inlet
- 9 PO 404679 POINTER, timing
- 10 HG 85130-2A HOUSING, pump
- KIT KT 404286**
PORT CLOSURE KIT-
including 11 thru 13
- 11 PG 404676 PLUG
- 12 IT 404675 INSERT
- *13 IF 404680 WARNING TAG

- SC 2056 22 SCREW
- GA 401310 *21 GASKET
- PL 8583 20 PLATE, head locating
- GA 1147 *19 GASKET
- TU 404644 18 TUBING, excess fuel device
- GA 401301 *17 GASKET, "O" ring
- GA 401010 *16 GASKET
- FI 8527A 15 FITTING, overflow
- PG 400718 14 PLUG, timing hole

MODEL 100 6A 100A 9656

*Denotes parts in Repair Gasket Kit, KT 85195.

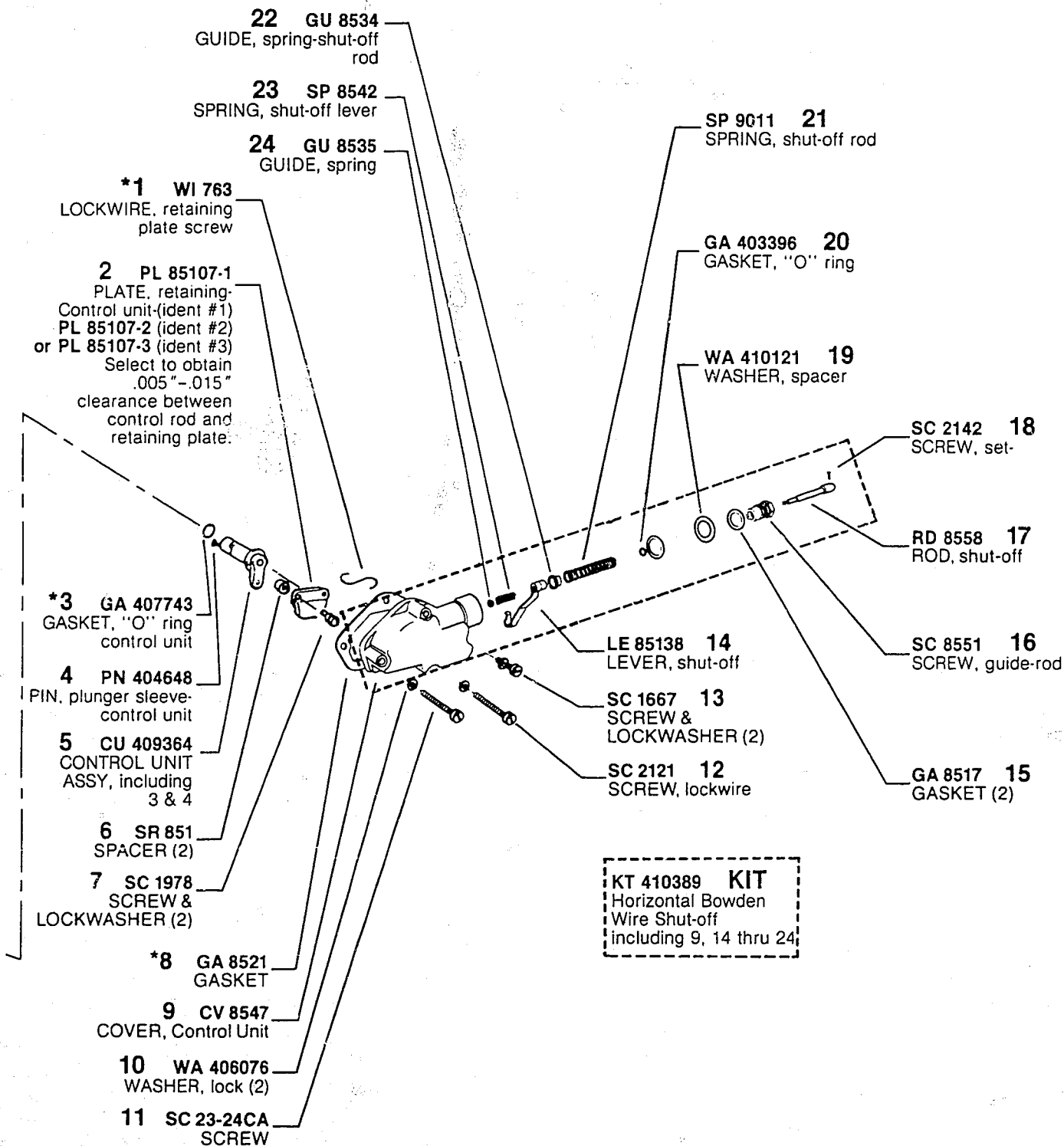

MODEL 100 6A 100A 9656

ASSY CT 85113A
INTRAVANCE
CAMSHAFT ASSY-
 including 1,2,4 thru 12
 & 15 thru 19

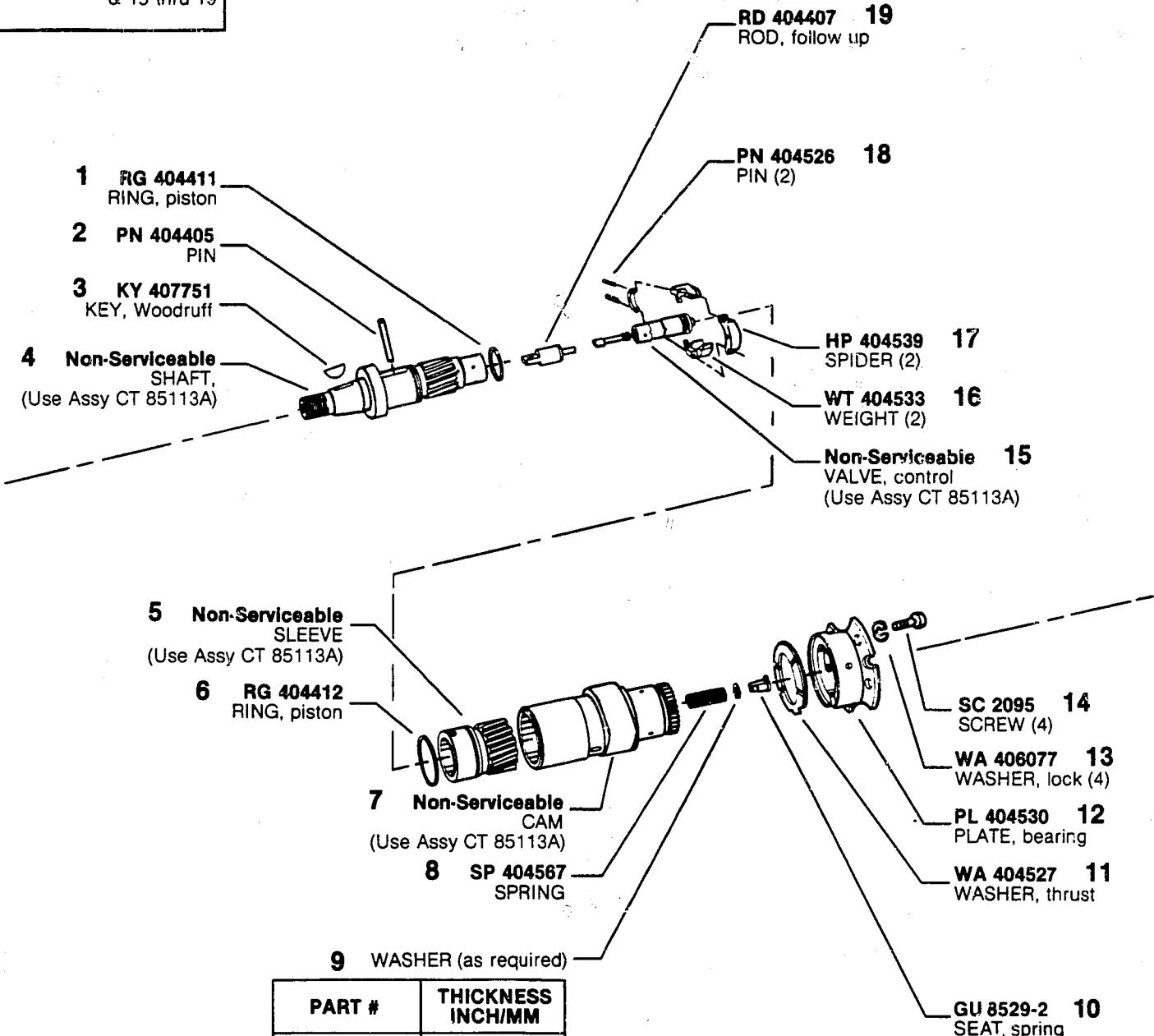

PART #	THICKNESS INCH/MM
WA 404540	.010/.254
WA 404541	.015/.381
WA 404542	.040/1.02
WA 404543	.060/1.52
WA 404544	.004/.102

MODEL 100 6A 100A 9656

ASSY WT 8535A
WEIGHT & SHAFT-
including 1, 5 thru 12 &
16 thru 21

ASSY WT 8531.AS
WEIGHT & SPIDER
ASSY, including 9 & 16
thru 19

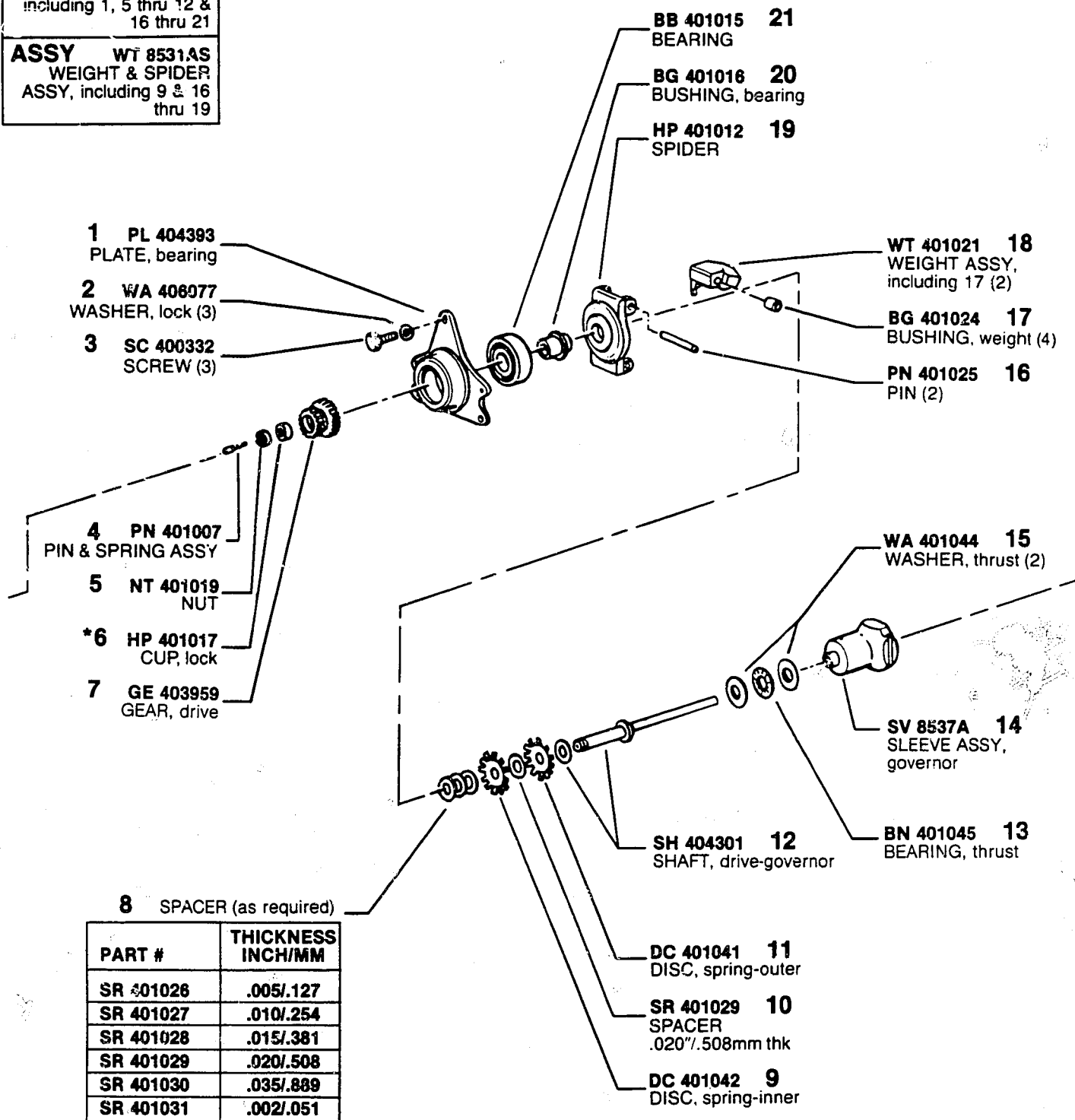

MODEL 100 6A 100A 9656

*Denotes parts in Repair Gasket Kit, KT 85195.

ASSY LE 85128-10A
LEVER & ROD,
 fulcrum-including 1 thru
 7, 15 thru 21 & 24

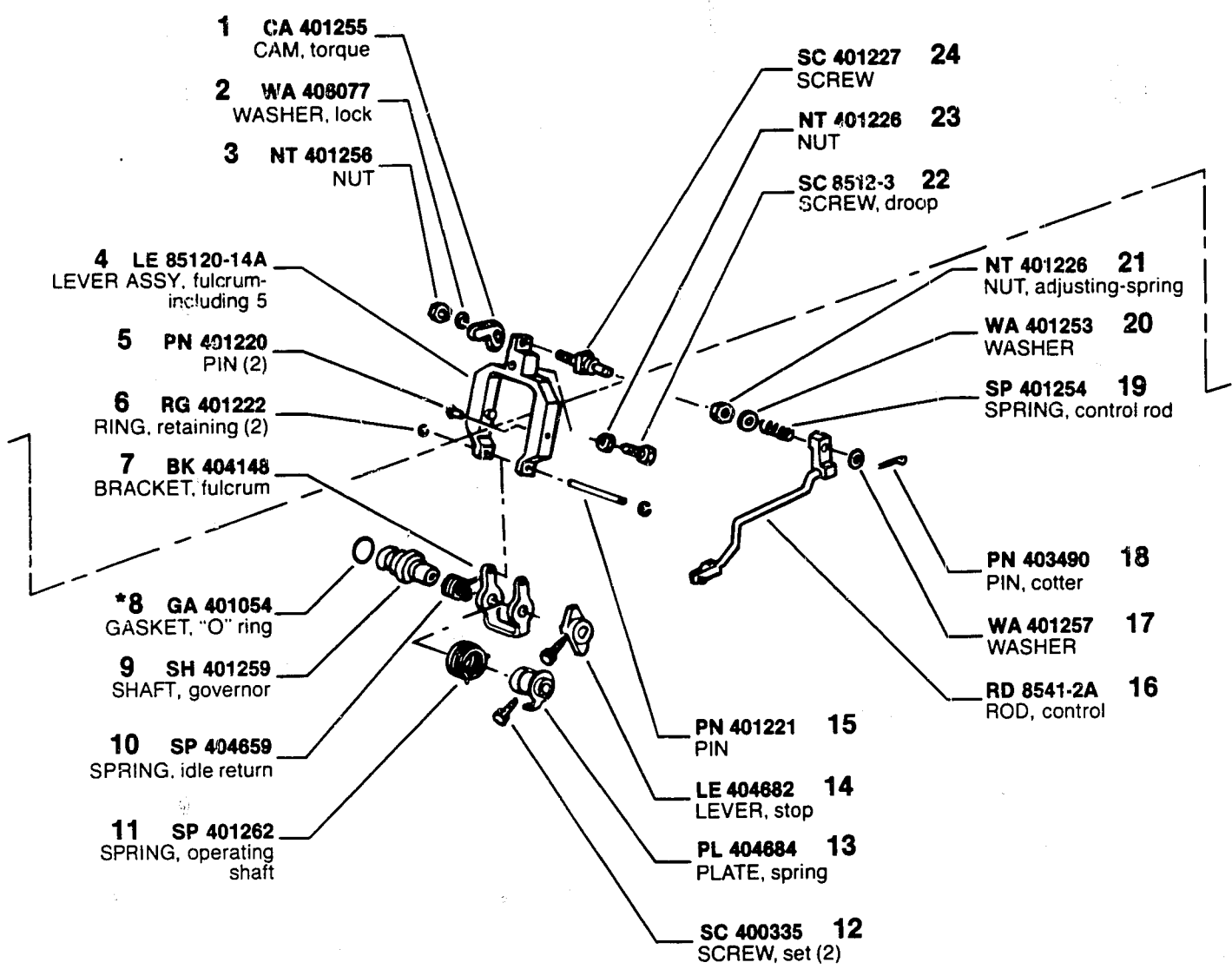

MODEL 100 6A 100A 9656

*Denotes parts in Repair Gasket Kit, KT 85195.

ASSY PL 401607
**EXCESS FUEL
 DEVICE ASSY-**
 including 4, 5, 8 thru
 10 & 12 thru 15

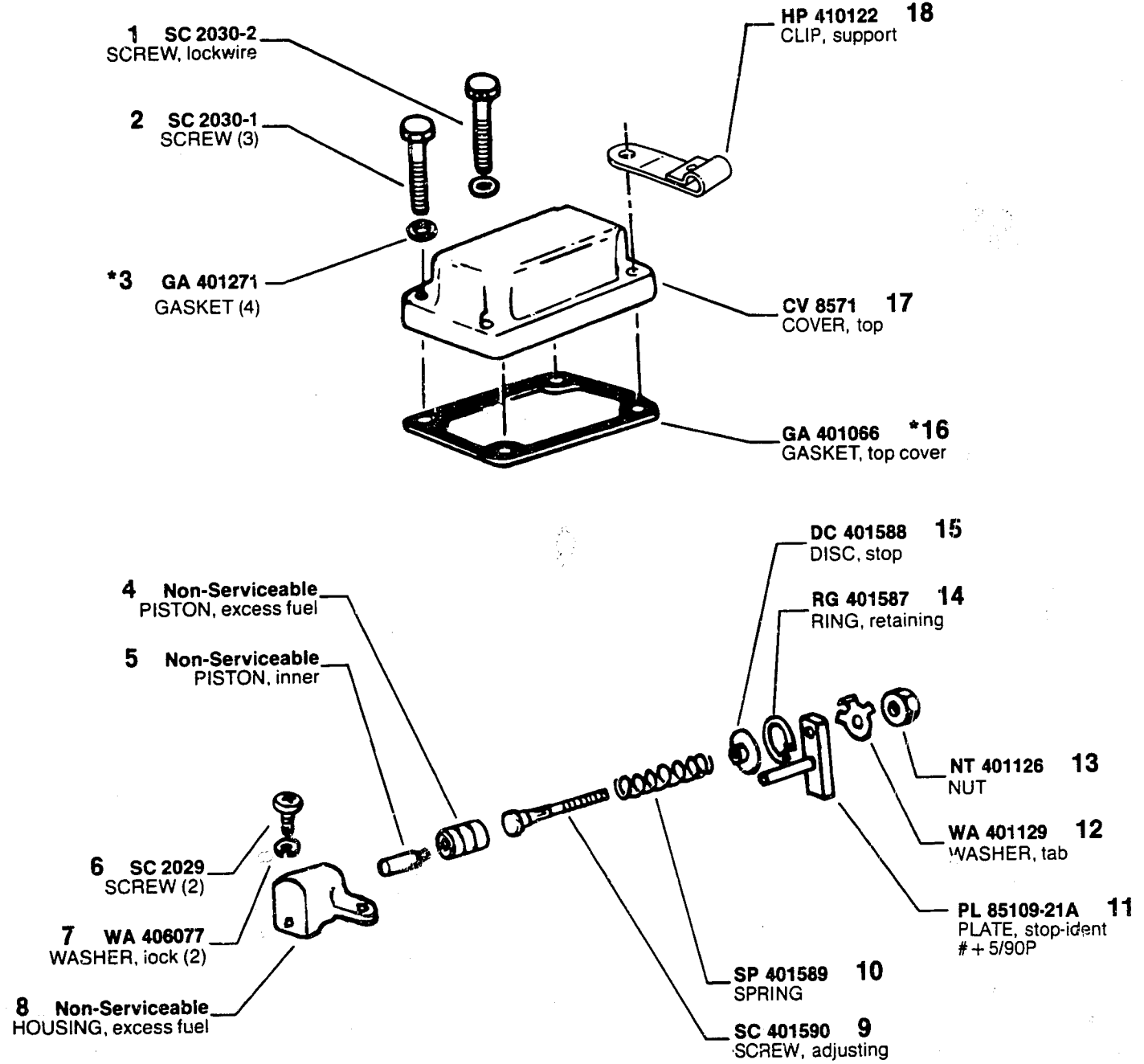

*Denotes parts in Repair Gasket Kit, KT 85195.

MODEL 100 6A 100A 9656

ASSY CV 8577A
COVER ASSY, supply pump-including 7 thru 9 & 22

ASSY SGF 15C-11
SUPPLY PUMP ASSY-including 4 thru 9, 16 thru 20, 22 & 29

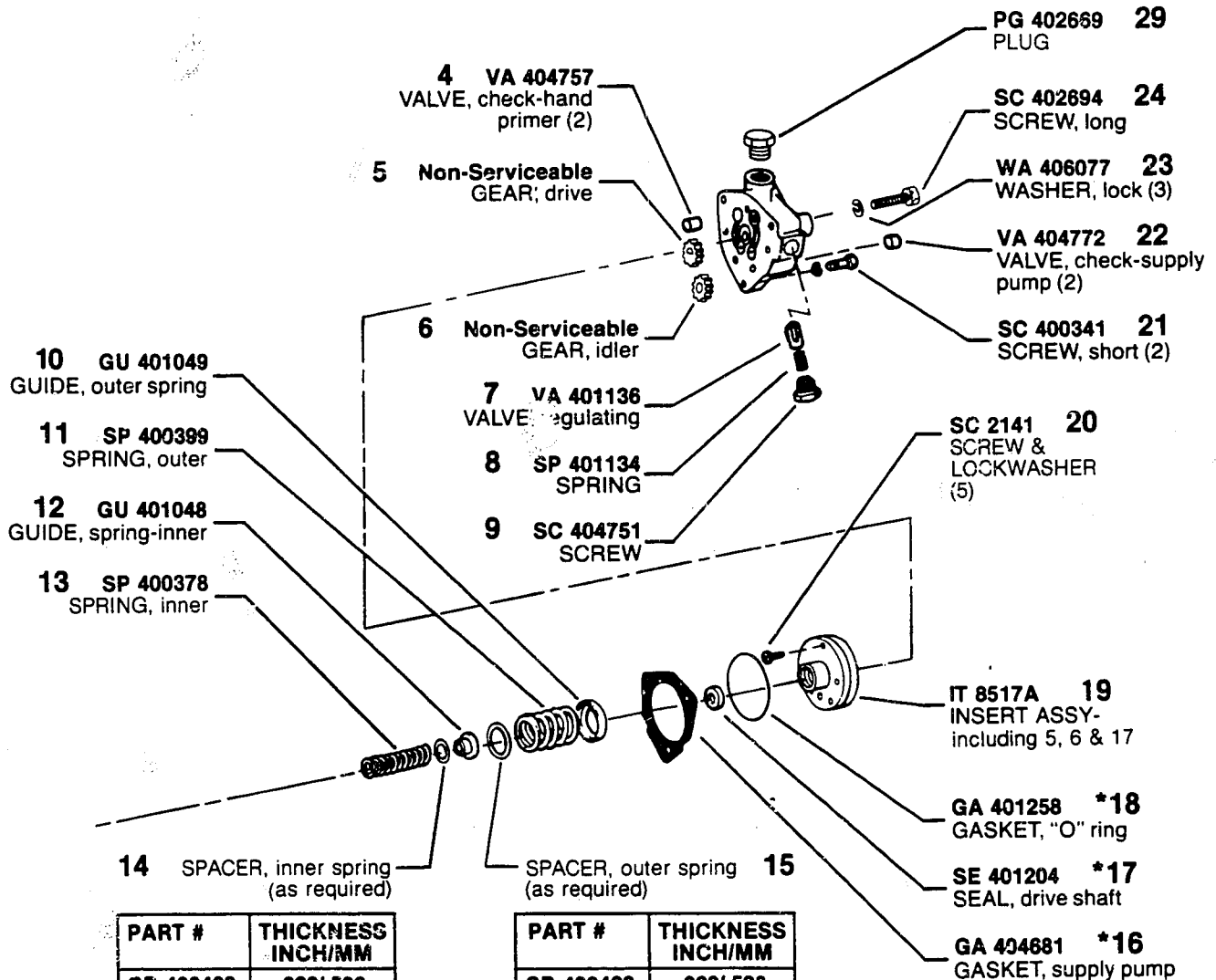

PART #	THICKNESS INCH/MM
SR 400409	.020/.508
SR 400410	.042/1.07
SR 400411	.058/1.47
SR 400412	.083/2.11
SR 400413	.177/4.50
SR 400414	.271/7.01
SR 400415	.365/9.254
SR 400416	.005/.127

PART #	THICKNESS INCH/MM
SR 400439	.020/.508
SR 400440	.042/1.07
SR 400441	.058/1.47
SR 400442	.083/2.11
SR 400443	.156/3.96
SR 400444	.030/.762
SR 400445	.010/.254

*Denotes parts in Repair Gasket Kit, KT 85195.

MODEL 100 6A 100A 9656

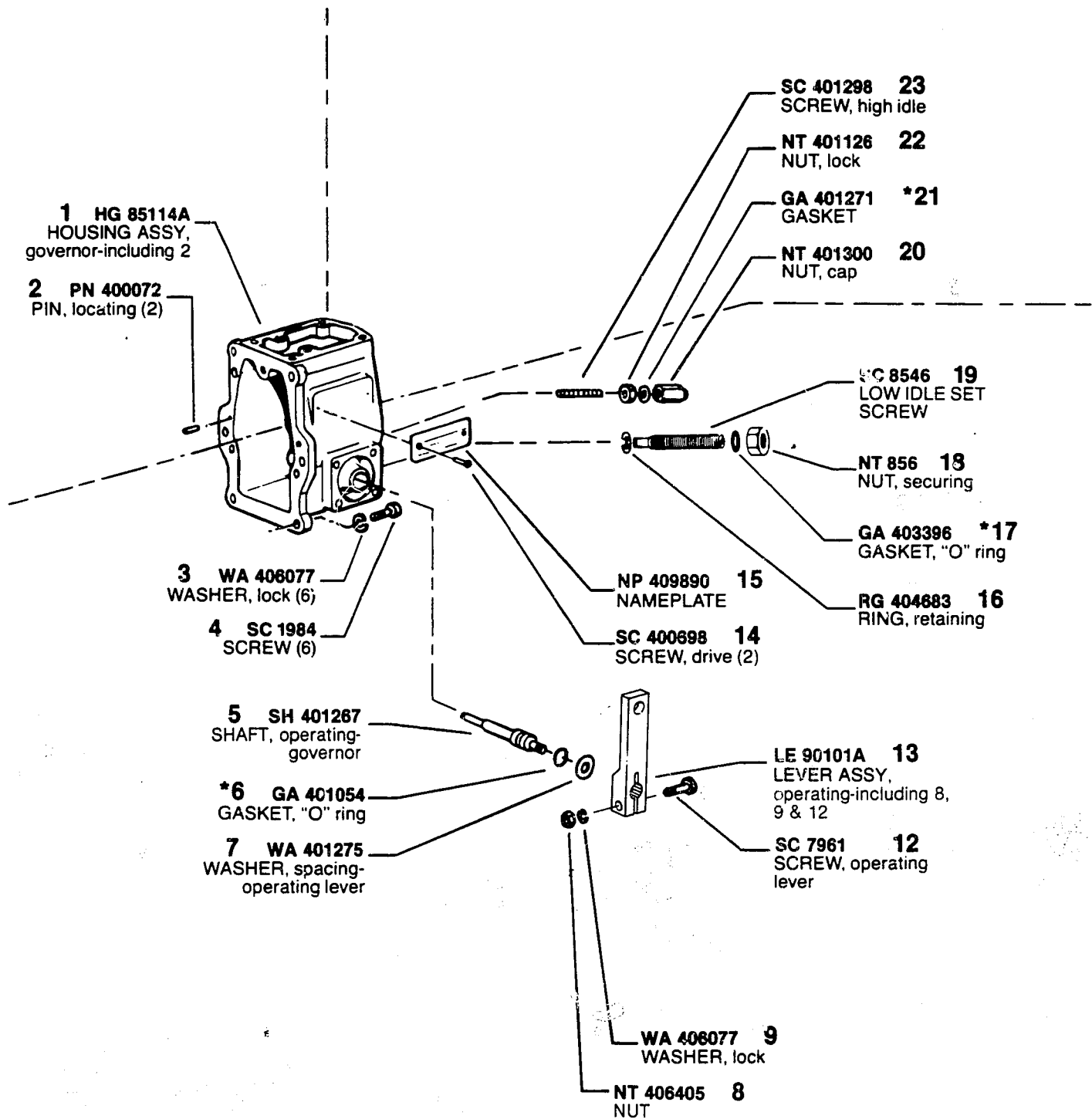

MODEL 100 6A 100A 9656

*Denotes parts in Repair Gasket Kit, KT 85195.

CALIBRATION SET-UP

Calibrating Unit	TSE 77107-5	Lube Oil Pressure	55 psi (380 KPa)
Supply Pump Pressure	40 psi (276 KPa)	Pump Rotation	Clockwise
Min at Full Load (Rated) Speed		Firing Order	1-5-3-6-2-4
High Pressure Tubing	1/4" OD x 0.062" ID	PROCEDURE	Refer to Service Instructions
	x 32" Long		and use figures below
Calibrating Oil	Viscor #1487 @ 100°-105°F		
	(38-41°C) at pump inlet		
Intravance® Camshaft Assy	CT 85113A		
	(Stamped Ident Code: 113)		
Advance	14° Total		
Start	1150-1350 rpm		
End	2400-2600 rpm		

9656A1 DATA

Customer No.	40-3850227	Lift to Port Closing Requirement	0.024" - 0.030"
Engine Model	D4800 (135 BHP)		(0.60-0.75 mm)
Application		Delivery Valve Opening Pressure	1150-1450 psi
Governor RPM	800/2600		(7.929-9.998 MPa)
Inner Spring Gap	3.25 ± 0.25 mm		
Outer Spring Precompression	1.75-2.25		
Cam Angle (Ref)	50°		

STEP	A	B	C	D
	Full Load	Peak Torque (from Actual A Delivery)	Cam Departure	High Speed Shut-Off
RPM DEL	2600 *36.5	Not Applicable	2675 —	3100 2 cc Max
STEP	E	F	G	
	Drop Screw	Low Idle	Starting Fuel Min Delivery	
RPM DEL	1400 *35.0	800 *12.0	150 10	

*Permissible tolerances: Service Check: ± 2.5 cc/500 str
 Recalibration: ± 0.5 cc/500 str
 STEP A: Max variation between cyl: 4.0 cc/500 str
 STEP A thru F: cc/500 str
 STEP G: cc/100 str